

QUANTITY	UNIT	ITEM
20	FOOT	ELECTRIC CABLE IN CONDUIT, SIGNAL, NO. 14, 5C
2	EACH	SIGNAL HEAD, POLYCARBONATE, LED, 1-FACE, 3-SECTION, MAST ARM MOUNTED
12	EACH	TRAFFIC SIGNAL BACKPLATE
2148	FOOT	DETECTOR LOOP, TYPE I

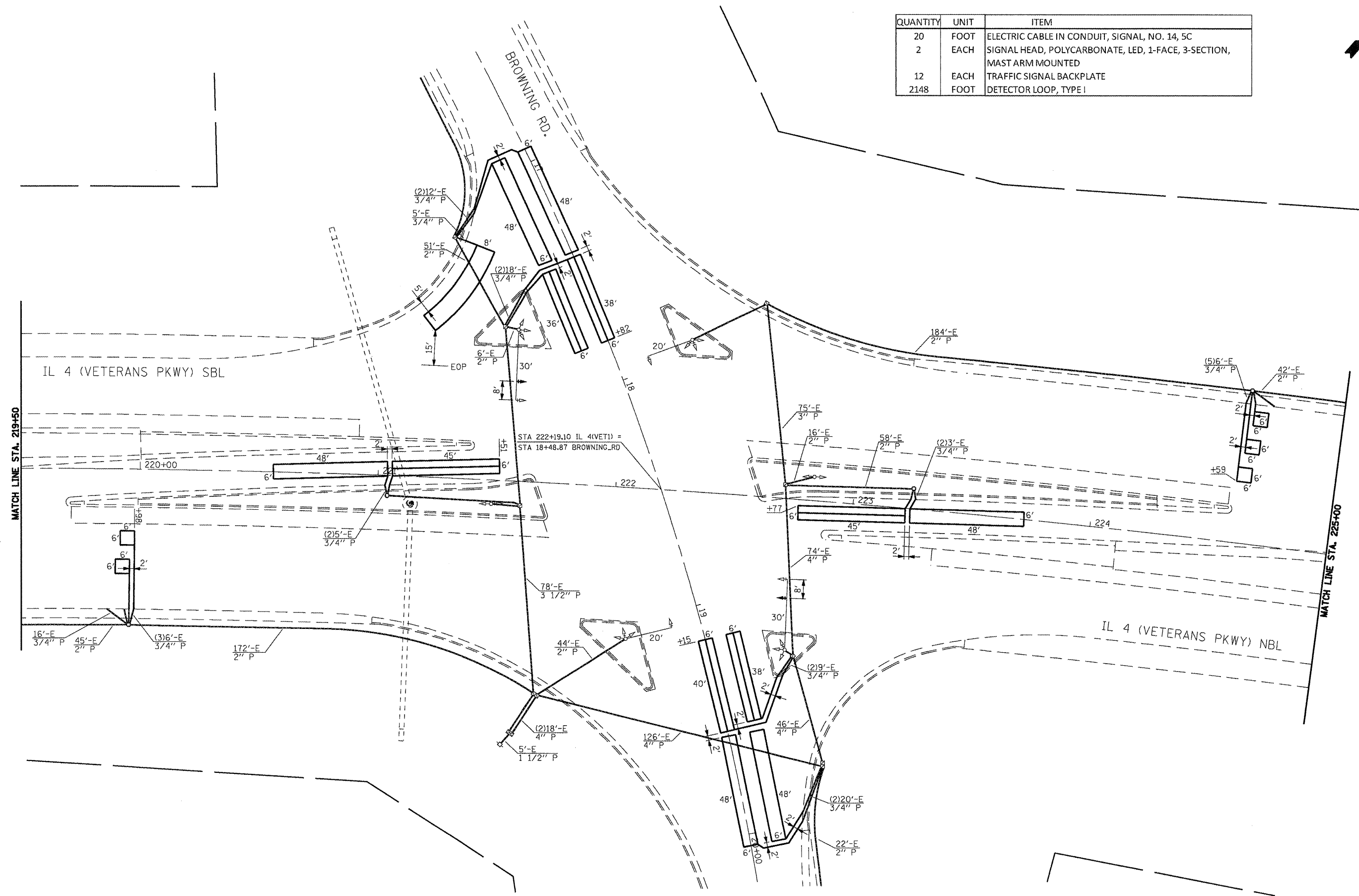

FILE NAME =	USER NAME = laughlinr1	DESIGNED -	REVISED -	<b>STATE OF ILLINOIS DEPARTMENT OF TRANSPORTATION</b>	<b>PROPOSED PLAN IL 4 (VETERANS PKWY.) &amp; BROWNING RD.</b>	F.A.P. RTE.	SECTION	COUNTY	TOTAL SHEETS	SHEET NO.
c:\pwork\pwork\WIDOT\LAUGHLINRL\0203328\672C35_sht.ta.12.dgn	PLOT SCALE = 40.0000' / IN.	DRAWN -	REVISED -			* 1-IRS-TS-1, 2TRS-6, 102RS-4	SANGAMON	206	178	
	PLOT DATE = Apr-29-2010 02:59:56PM	CHECKED -	REVISED -			* FAP 656 (IL-55), FAP 682 (IL 4)	CONTRACT NO. 72C35			
		DATE -	REVISED -			* FAP 658 (IL 29)	ILLINOIS FED. AID PROJECT			

SCALE: SHEET NO. 8 OF 33 SHEETS STA. TO STA.