

EXIST. CURVE 3
 PI STA. =26+41.78 e = ----
 $\Delta = 3^\circ 47' 46''$ (RT) T.R. = ----
 D =1° 53' 53" S.E. RUN = ----
 R =3,018.66' P.C. STA. =25+41.75
 T =100.04' P.T. STA. =27+41.75
 L =200.00'
 E =1.66'

PAVEMENT MARKING LEGEND

- ① PREFORMED PLASTIC PAVEMENT MARKING, TYPE B, INLAID - LINE 5"
- ② PREFORMED PLASTIC PAVEMENT MARKING, TYPE B, INLAID - LINE 6"
- ③ PREFORMED PLASTIC PAVEMENT MARKING, TYPE B, INLAID - LINE 6" (6' SKIP- 2' DASH)
- ④ PREFORMED PLASTIC PAVEMENT MARKING, TYPE B, INLAID - LINE 24"
- ⑤ THERMOPLASTIC PAVEMENT MARKING - LINE 5"
- ⑥ THERMOPLASTIC PAVEMENT MARKING - LINE 5" (DOUBLE YELLOW LINES @ 13" CENTERS)
- ⑦ THERMOPLASTIC PAVEMENT MARKING - LINE 6"
- ⑧ THERMOPLASTIC PAVEMENT MARKING - LINE 8"
- ⑨ THERMOPLASTIC PAVEMENT MARKING - LINE 12"
- ⑩ PAINT PAVEMENT MARKING - LINE 5"
- ↖ PREFORMED PLASTIC PAVEMENT MARKING, TYPE B, INLAID - LETTERS AND SYMBOLS (WHITE)
- ▶ RAISED REFLECTIVE PAVEMENT MARKER (ONE-WAY CRYSTAL)
- ▲ RAISED REFLECTIVE PAVEMENT MARKER (ONE -WAY AMBER)
- ◆ RAISED REFLECTIVE PAVEMENT MARKER (TWO -WAY AMBER)
- ⊗-W PAVEMENT MARKING, WHITE
- ⊗-Y PAVEMENT MARKING, YELLOW

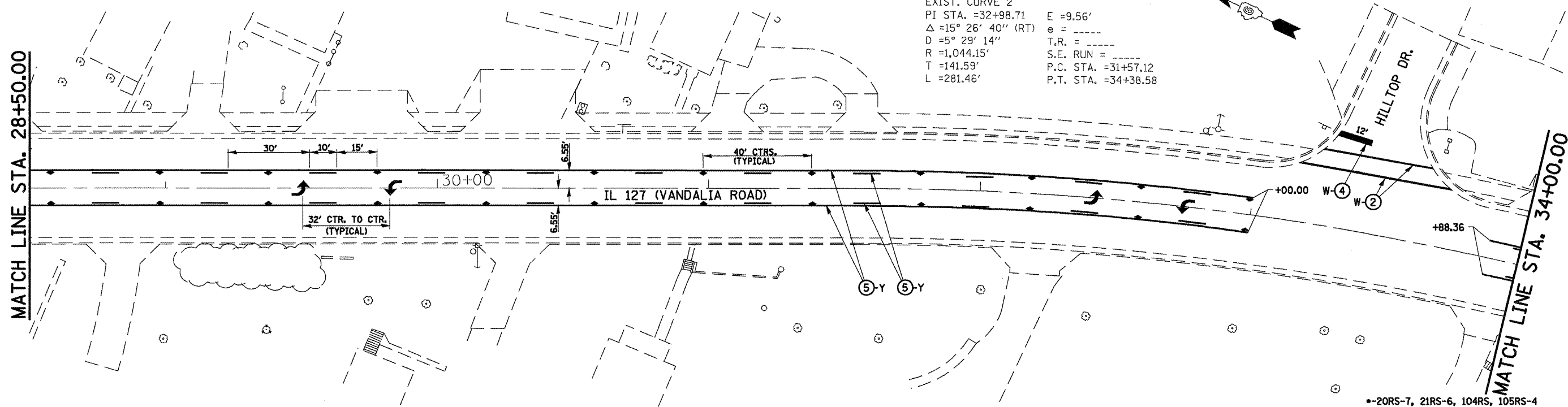

EXIST. CURVE 2
 PI STA. =32+98.71 E =9.56'
 $\Delta = 15^\circ 26' 40''$ (RT) e = ----
 D =5° 29' 14" T.R. = ----
 R =1,044.15' S.E. RUN = ----
 T =141.59' P.C. STA. =31+57.12
 L =281.46' P.T. STA. =34+38.58

FILE NAME =
 c:\pwork\pwi001\LAUGH\INRL\ad0105366\072052-shr-pmk.dgn

USER NAME = laughlinr1
 PLOT SCALE = 40.0000' / IN.
 PLOT DATE = Mar-26-2018 12:00:23PM

DESIGNED -	RTS	REVISED -	
DRAWN -	RTS	REVISED -	
CHECKED -	RTS	REVISED -	
DATE -	3-10-10	REVISED -	

**STATE OF ILLINOIS
 DEPARTMENT OF TRANSPORTATION**

PAVEMENT MARKING SHEET

SCALE: SHEET NO. 12 OF 15 SHEETS STA. TO STA.

F.A.P. RTE.	SECTION	COUNTY	TOTAL SHEETS	SHEET NO.
..	.	MONTGOMERY	60	48
CONTRACT NO. 72C52			ILLINOIS FED. AID PROJECT	

•-20RS-7, 21RS-6, 104RS, 105RS-4
 •-325, 42