

DATE	
BY	
SURVEYED	
PLOTTED	
NOTE BOOK	
AREAS CHECKED	

DATE	
BY	
SURVEYED	
PLOTTED	
NOTE BOOK	
AREAS CHECKED	

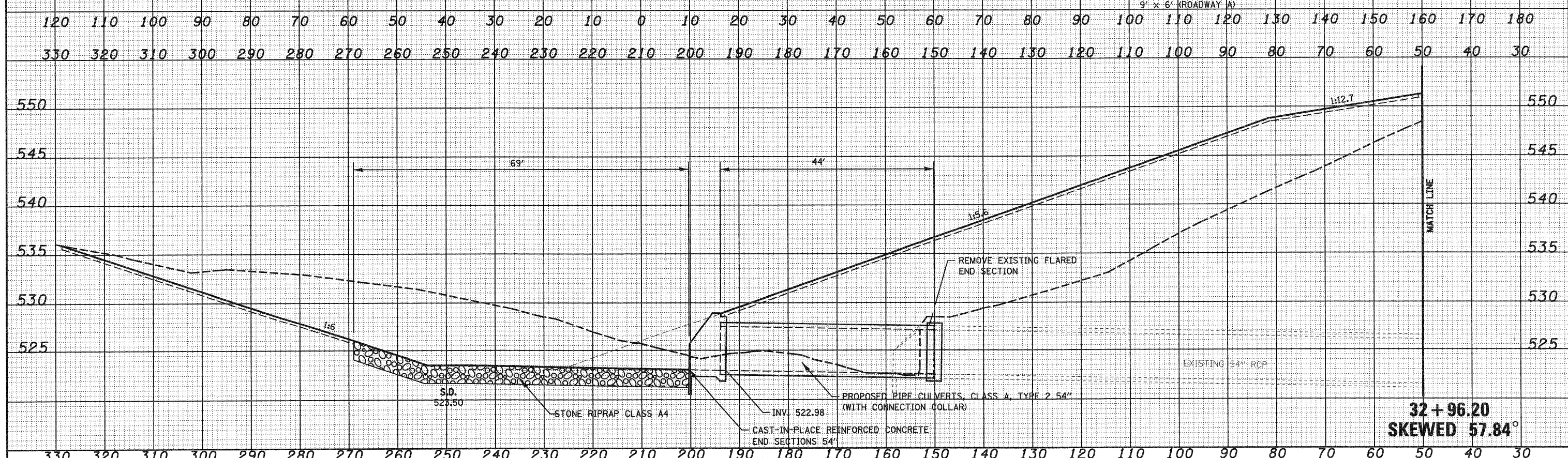
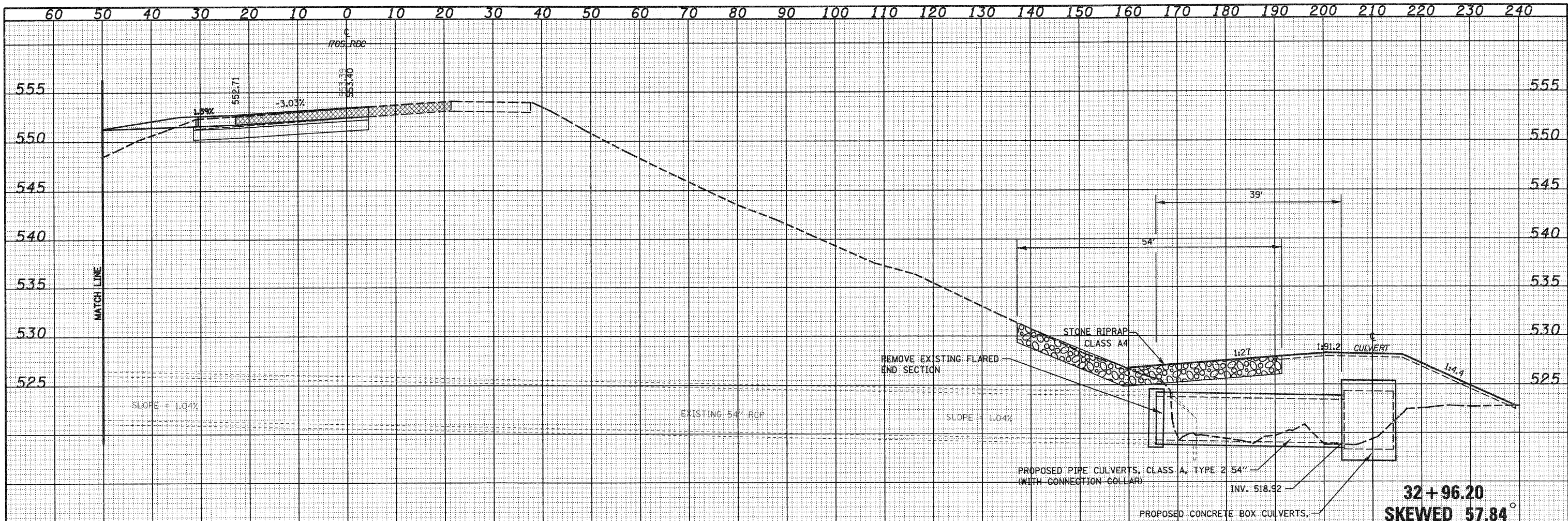

FILE NAME =	USER NAME = paul	DESIGNED - JWS	REVISED -	<b>STATE OF ILLINOIS</b> <b>DEPARTMENT OF TRANSPORTATION</b>	<b>CULVERT PROFILES, SOUTH TRI LEVEL ROADWAY C</b>	F.A.I. RTE. 57/70	SECTION (25-3)R	COUNTY EFFINGHAM	TOTAL SHEETS 1416	SHEET NO. 487	
SAProjects\43\0007257\Roadway C In\A\work\end\end\300.dwg	PLOT SCALE = 28,00000' / IN.	DRAWN - LEC	REVISED -			SCALE: 1"=10'	SHEET NO. 12 OF 17 SHEETS	STA. 32+96.20 TO STA. 32+96.20	CONTRACT NO. 74296		
	PLOT DATE = 2/11/2010	CHECKED - BRM	REVISED -			FED. ROAD DIST. NO. ILLINOIS FED. AID PROJECT					
		DATE - 2-25-08	REVISED -								