

STATE OF ILLINOIS
DEPARTMENT OF TRANSPORTATION

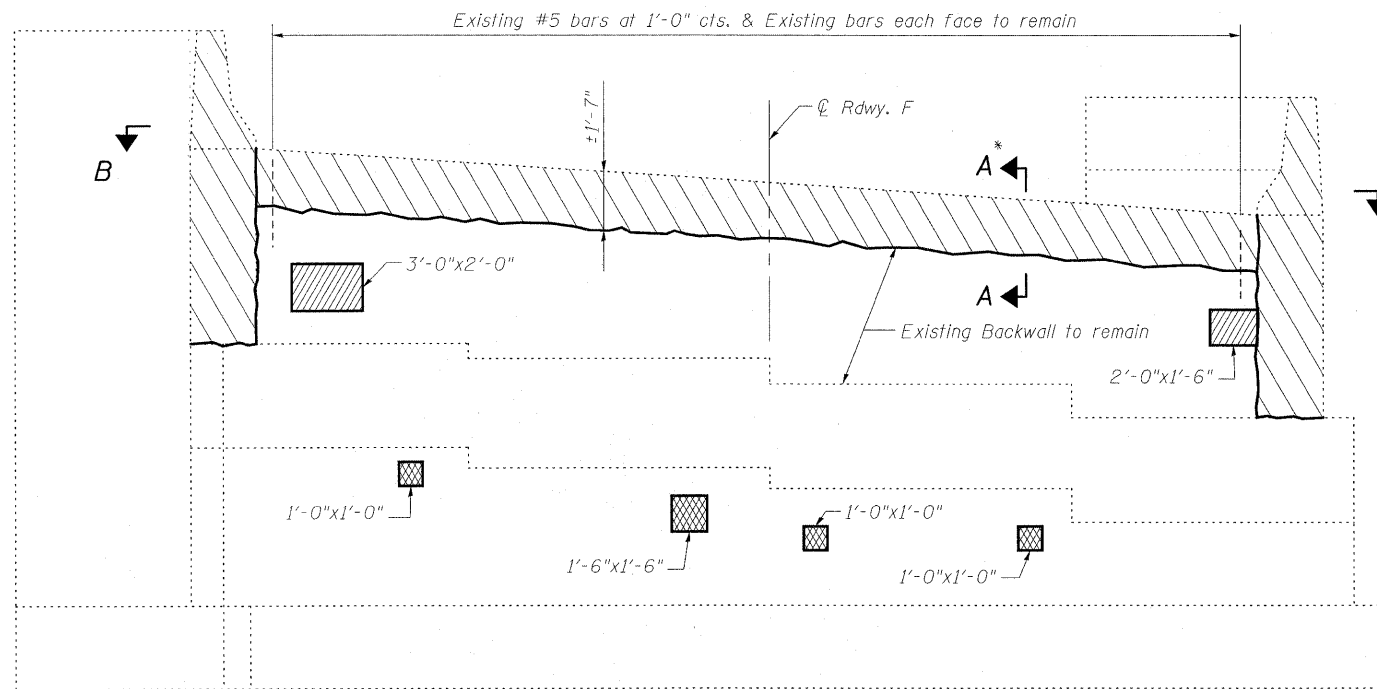

ELEVATION
Looking East

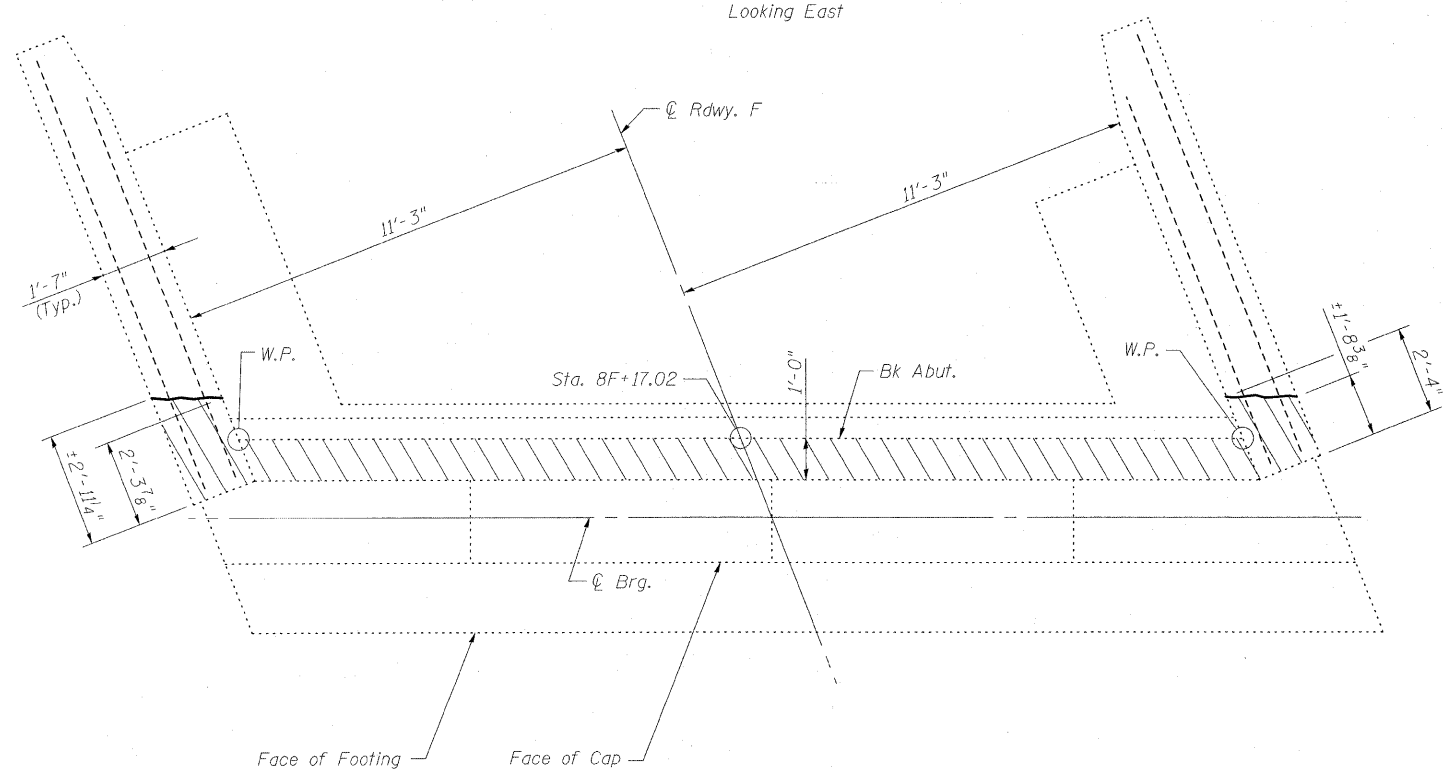

VIEW B-B
EAST ABUTMENT

* For Section A-A see
Sheet 4 of 36.

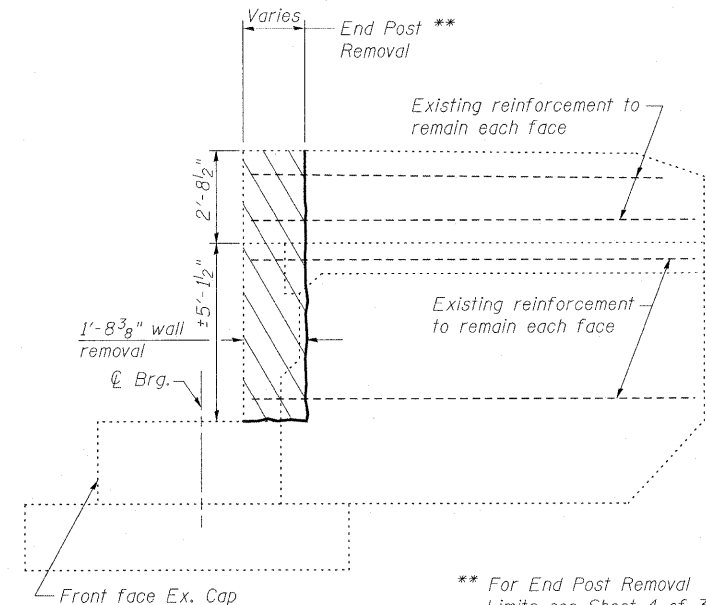

SOUTH WING WALL

** For End Post Removal
Limits see Sheet 4 of 36.

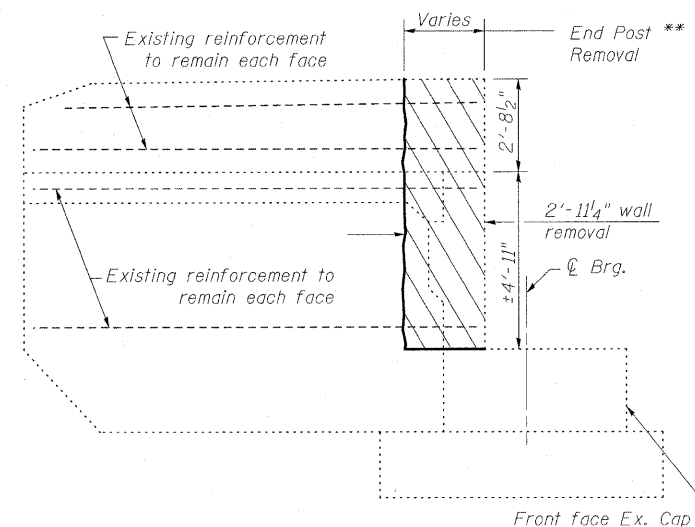

NORTH WING WALL

LEGEND

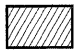
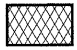
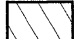
-  Indicates Structural Repair of Concrete
-  Indicates Unsound Concrete Removal
-  Indicates Concrete Removal

BILL OF MATERIAL

Item	Unit	Total
Concrete Removal	Cu. Yd.	3.1
Structural Repair of Concrete (Depth equal to or less than 5")	Sq. Ft.	9
Unsound Concrete Removal	Sq. Yd.	0.6

CONCRETE REMOVAL & REPAIR
EAST ABUTMENT
STRUCTURE NO. 025-0018

DESIGNED	B.B.
CHECKED	C.J.F.
DRAWN	W.J.S.
CHECKED	C.J.F. & B.B.



**BERNARDIN
LOCHMUELLER &
ASSOCIATES, INC.**

3 Oak Drive
Meryville, IL 62962-4635
Local (618) 288-4665
Fax 618-288-4666

SHEET NO. 17 36 SHEETS	F.A.I. RTE.	SECTION	COUNTY	TOTAL SHEETS	SHEET NO.
	57	(25-3HB)I-3	EFFINGHAM	1416	1398
SN 025-0018			CONTRACT NO. 74296		
FED. ROAD DIST. NO. 7 ILLINOIS FED. AID PROJECT					