

STATE OF ILLINOIS
DEPARTMENT OF TRANSPORTATION

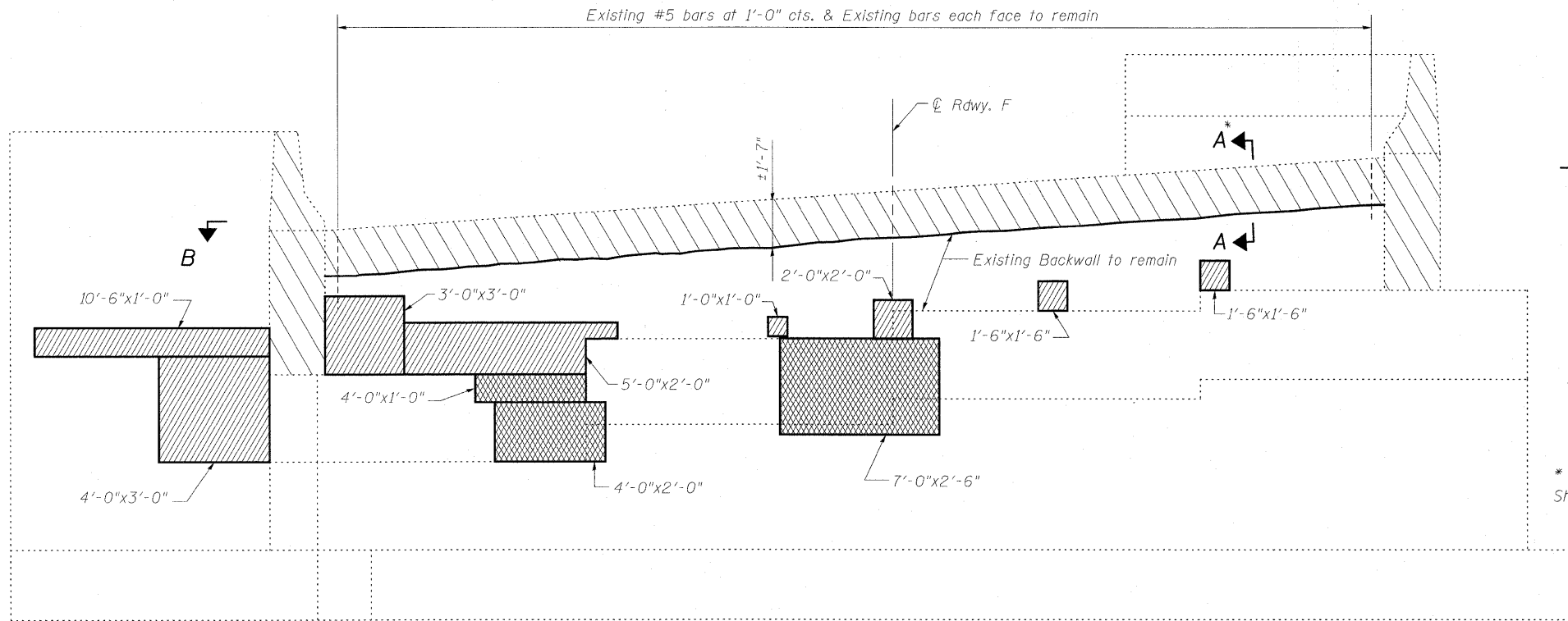

ELEVATION
Looking West

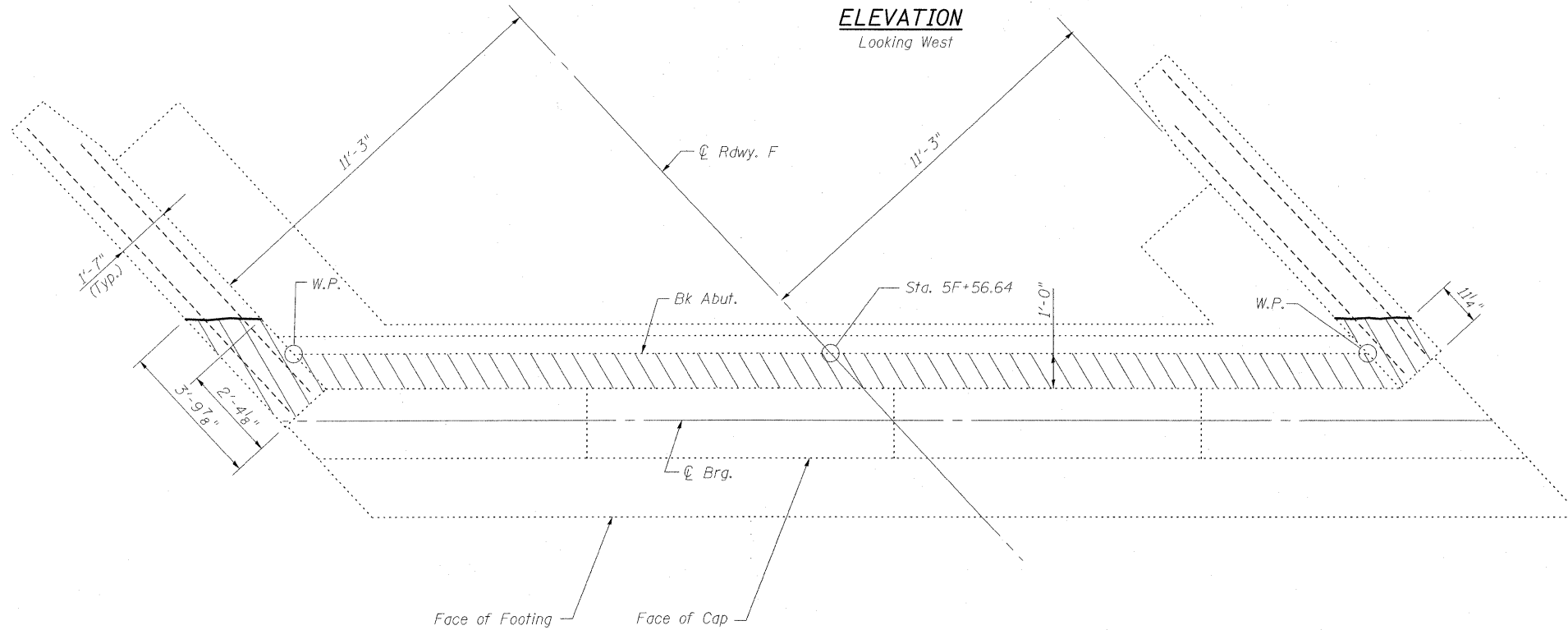

VIEW B-B
WEST ABUTMENT

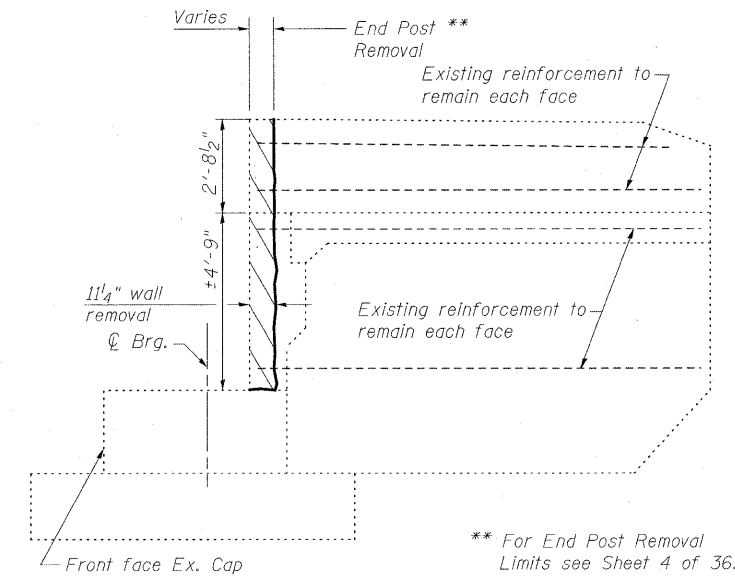

NORTH WING WALL

* For Section A-A see Sheet 4 of 36.

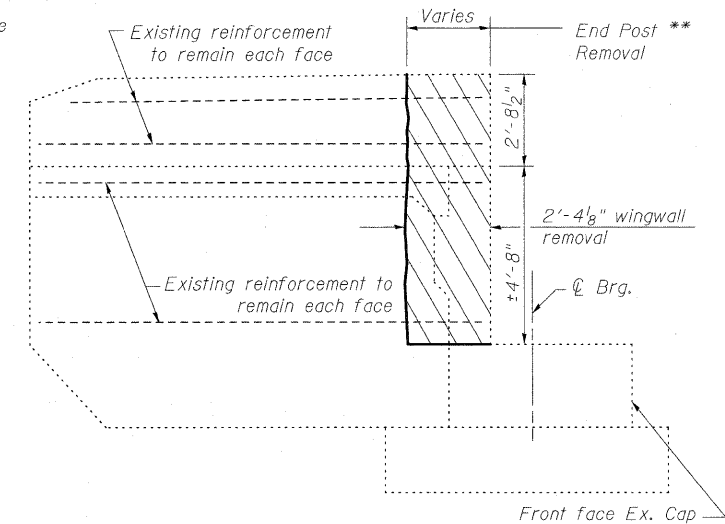

SOUTH WING WALL

LEGEND

- Indicates Structural Repair of Concrete
- Indicates Unsound Concrete Removal
- Indicates Concrete Removal

BILL OF MATERIAL

Item	Unit	Total
Concrete Removal	Cu. Yd.	3.3
Structural Repair of Concrete (Depth equal to or less than 5")	Sq. Ft.	51
Unsound Concrete Removal	Sq. Yd.	3.3

CONCRETE REMOVAL & REPAIR
WEST ABUTMENT
STRUCTURE NO. 025-0018

DESIGNED	B.B.
CHECKED	C.J.F.
DRAWN	W.J.S.
CHECKED	C.J.F. & B.B.



**BERNARDIN
LOCHMUELLER &
ASSOCIATES, INC.**

3 Oak Drive
Maryville, IL 62442-5655
Local (618) 398-4665
Fax 618-288-4666

SHEET NO. 20 36 SHEETS	F.A.I. RTE.	SECTION	COUNTY	TOTAL SHEETS	SHEET NO.
	57	(25-3HB)I-3	EFFINGHAM	1416	1401
SN 025-0018			CONTRACT NO. 74296		
FED. ROAD DIST. NO. 7 ILLINOIS FED. AID PROJECT					