

DATE	
BY	
REVISIONS	
PLANNED	
DESIGNED	
CHECKED	
IN CHARGE	
NO.	

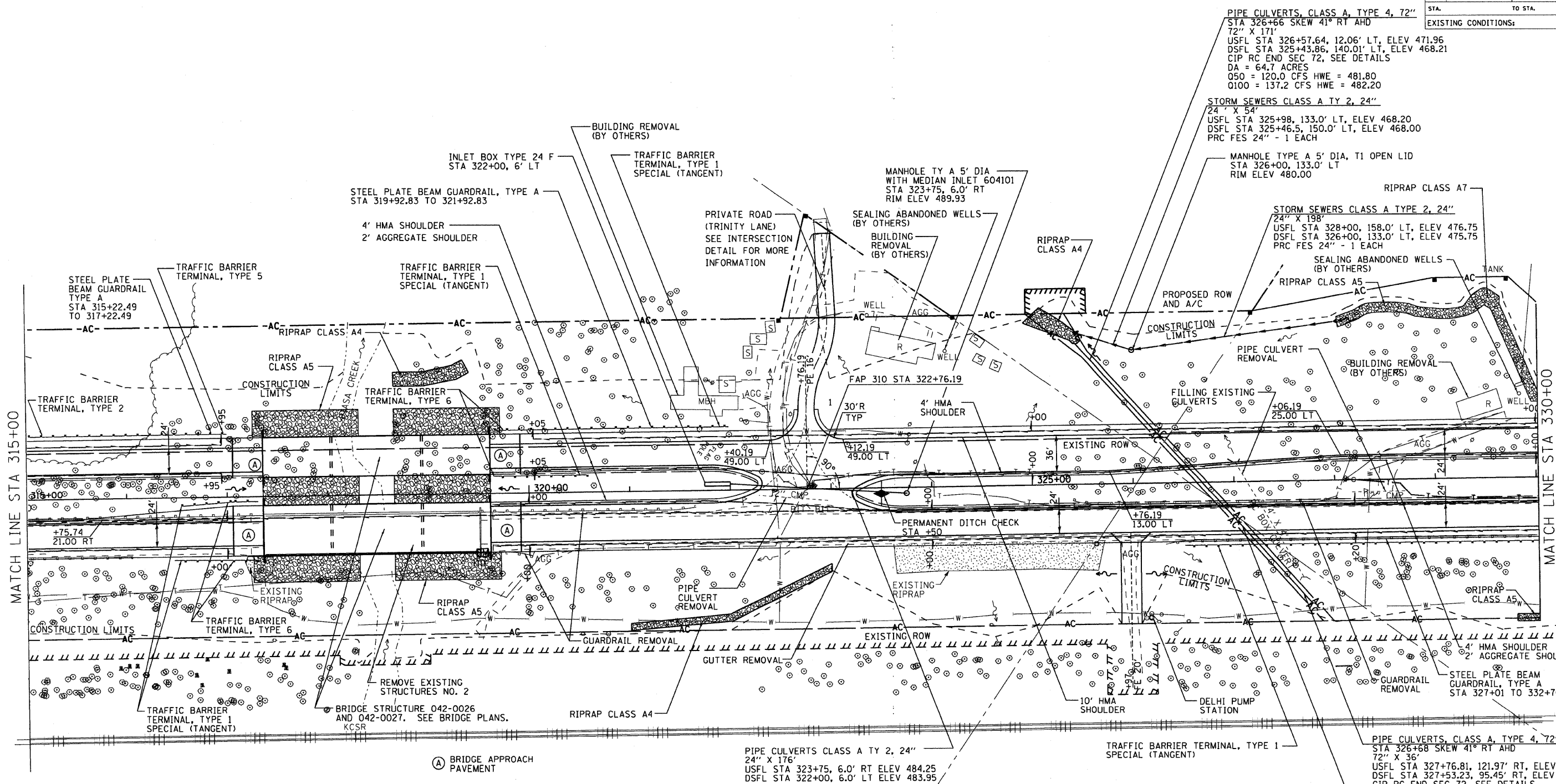

PIPE CULVERTS, CLASS A, TYPE 4, 72"
 STA 326+66 SKEW 41° RT AHD
 72" X 171'
 USFL STA 326+57.64, 12.06' LT, ELEV 471.96
 DSFL STA 325+43.86, 140.01' LT, ELEV 468.21
 CIP RC END SEC 72, SEE DETAILS
 DA = 64.7 ACRES
 Q50 = 120.0 CFS HWE = 481.80
 Q100 = 137.2 CFS HWE = 482.20

STORM SEWERS CLASS A TY 2, 24"
 24" X 54"
 USFL STA 325+98, 133.0' LT, ELEV 468.20
 DSFL STA 325+46.5, 150.0' LT, ELEV 468.00
 PRC FES 24" - 1 EACH

STORM SEWERS CLASS A TYPE 2, 24"
 24" X 198"
 USFL STA 328+00, 158.0' LT, ELEV 476.75
 DSFL STA 326+00, 133.0' LT, ELEV 475.75
 PRC FES 24" - 1 EACH

SEALING ABANDONED WELLS (BY OTHERS)
 RIPRAP CLASS A5
 AC

PIPE CULVERT REMOVAL
 FILLING EXISTING CULVERTS
 +06.19
 25.00 LT

PERMANENT DITCH CHECK
 STA +50
 +76.19
 13.00 LT

DELHI PUMP STATION
 GUARDRAIL REMOVAL
 4' HMA SHOULDER
 2' AGGREGATE SHOULDER

TRAFFIC BARRIER TERMINAL, TYPE 1 SPECIAL (TANGENT)
 PIPE CULVERTS, CLASS A, TYPE 4, 72"
 STA 326+68 SKEW 41° RT AHD
 72" X 36'
 USFL STA 327+76.81, 121.97' RT, ELEV 475.89
 DSFL STA 327+53.23, 95.45' RT, ELEV 475.11
 CIP RC END SEC 72, SEE DETAILS
 DA = 64.7 ACRES
 Q50 = 120.0 CFS HWE = 481.80
 Q100 = 137.2 CFS HWE = 482.20

PIPE CULVERTS, CLASS A, 72" (JACKED)
 STA 326+66 SKEW 41° RT AHD
 72" X 144'
 USFL STA 327+53.23, 95.45' RT, ELEV 475.11
 DSFL STA 326+57.64, 12.06' LT, ELEV 471.96
 DA = 64.7 ACRES
 Q50 = 120.0 CFS HWE = 481.80
 Q100 = 137.2 CFS HWE = 482.20

TRAFFIC BARRIER TERMINAL, TYPE 1 SPECIAL (TANGENT)
 BRIDGE STRUCTURE 042-0026 AND 042-0027, SEE BRIDGE PLANS, KCSR

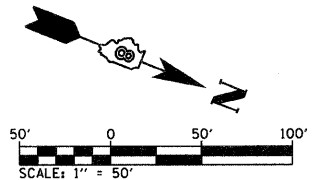

ILLINOIS DEPARTMENT OF TRANSPORTATION
ROADWAY PLAN STA 315+00 TO 330+00
 FAP ROUTE 310
 SECTION 60-16-1&1B,42-1&1B
 MADISON/JERSEY COUNTY
 DRAWN BY: EMR
 CHECKED BY: GLF

REVISIONS	
NAME	DATE

BM: 110 CHISLED "□" NE CORNER WINGWALL EAST SIDE RTE. 267 BRIDGE OVER PIASA CREEK STA 319+53, 59' RT ELEV. 475.07

(A) BRIDGE APPROACH PAVEMENT

PIPE CULVERTS CLASS A TY 2, 24"
 24" X 176'
 USFL STA 323+75, 6.0' RT ELEV 484.25
 DSFL STA 322+00, 6.0' LT ELEV 483.95

MATCH LINE STA 315+00

MATCH LINE STA 330+00