

FAP ROUTE	SECTION	COUNTY	TOTAL SHEETS	SHEET NO
310	60-16-1&1B,42-1&1B	MADISON/JERSEY	481	91
STA.	TO STA.			
EXISTING CONDITIONS:				

CONTRACT NO. 76318

PLAN	DATE
NO.	
BY	
CHECKED	
DATE	
NO.	
BY	
CHECKED	
DATE	
NO.	

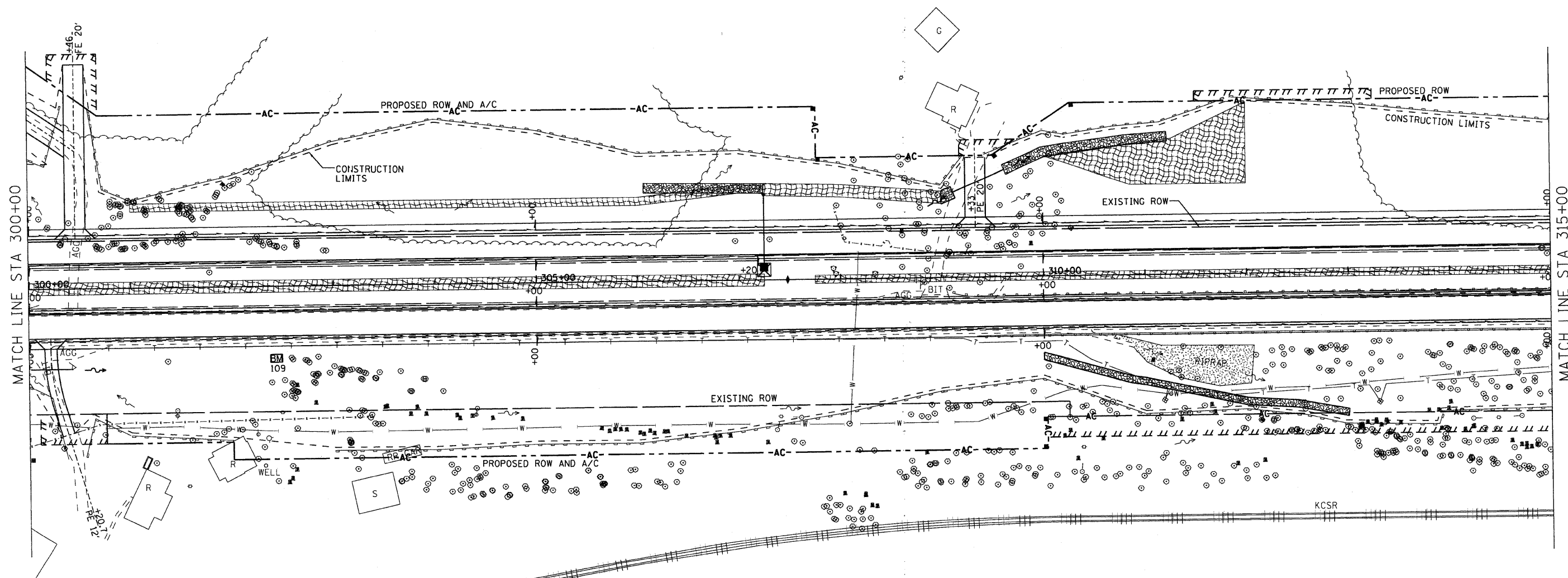

MATCH LINE STA 300+00

MATCH LINE STA 315+00

99+23, 61' RT.  
XX.XX

**EROSION AND SEDIMENT CONTROL  
STANDARD SYMBOLS**

- PERIMETER EROSION BARRIER - SILT FILTER FENCE OR OTHER AS APPROVED BY THE ENGINEER
- EROSION CONTROL BLANKET
- FLOW LINES
- INLET AND PIPE PROTECTION - STRAW BALES, FILTER FABRIC, AGGREGATES
- PERMANENT EARTH BERM DITCH CHECK
- RIPRAP

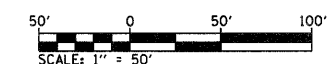

ILLINOIS DEPARTMENT OF TRANSPORTATION  
**EROSION CONTROL PLAN  
STA 300+00 TO 315+00**  
FAP ROUTE 310  
SECTION 60-16-1&1B,42-1&1B  
MADISON/JERSEY COUNTY  
DRAWN BY: EMR  
CHECKED BY: GLF

REVISIONS	
NAME	DATE