

FAP ROUTE	SECTION	COUNTY	TOTAL SHEETS	SHEET NO
310	60-16-1&18,42-1&18	MADISON/JERSEY	481	92
STA.		TO STA.		
EXISTING CONDITIONS:				

CONTRACT NO. 76318

PLAN	SURVEYED	DATE
NOTE BOOK NO.	PLOTTED	
	CHECKED	
	BY	
	FILE NAME	

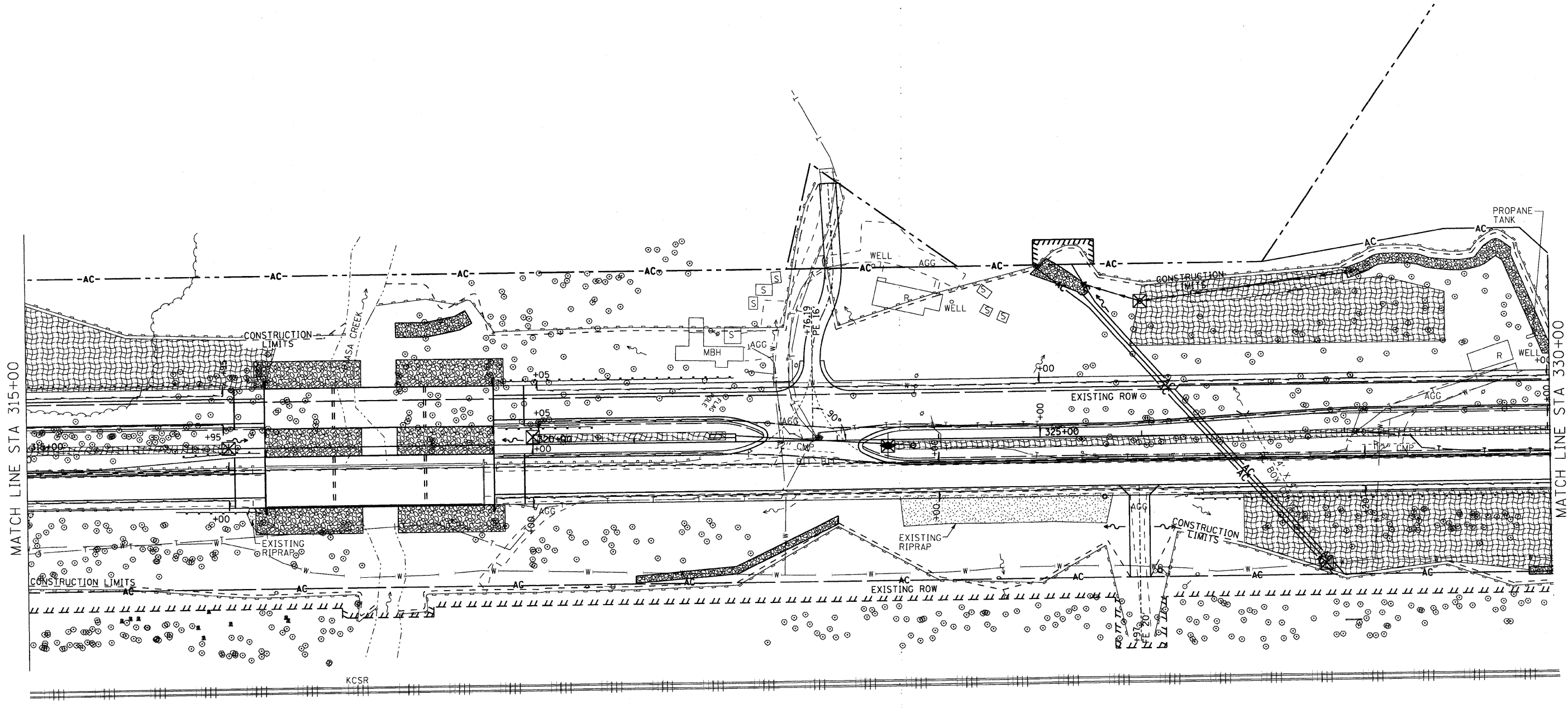

**EROSION AND SEDIMENT CONTROL
STANDARD SYMBOLS**

- PERIMETER EROSION BARRIER - SILT FILTER FENCE OR OTHER AS APPROVED BY THE ENGINEER
- EROSION CONTROL BLANKET
- FLOW LINES
- INLET AND PIPE PROTECTION - STRAW BALES, FILTER FABRIC, AGGREGATES
- PERMANENT EARTH BERM DITCH CHECK
- RIPRAP

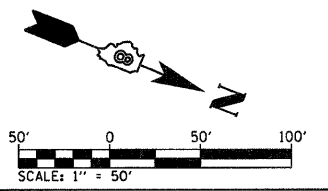

REVISIONS	
NAME	DATE

ILLINOIS DEPARTMENT OF TRANSPORTATION
**EROSION CONTROL PLAN
STA 315+00 TO 330+00**
FAP ROUTE 310
SECTION 60-16-1&18,42-1&18
MADISON/JERSEY COUNTY
DRAWN BY: EMR
CHECKED BY: GLF