

FAP ROUTE	SECTION	COUNTY	TOTAL SHEETS	SHEET NO.
310	60-16-1&1B,42-1&1B	MADISON AND JERSEY	481	131
STA	TO STA			
EXISTING CONDITIONS:				

CONTRACT NO. 76318

PLAN	DATE
SURVEYED	
PLOTTED	
REVISIONS	
NOTE BOOK	
NO.	

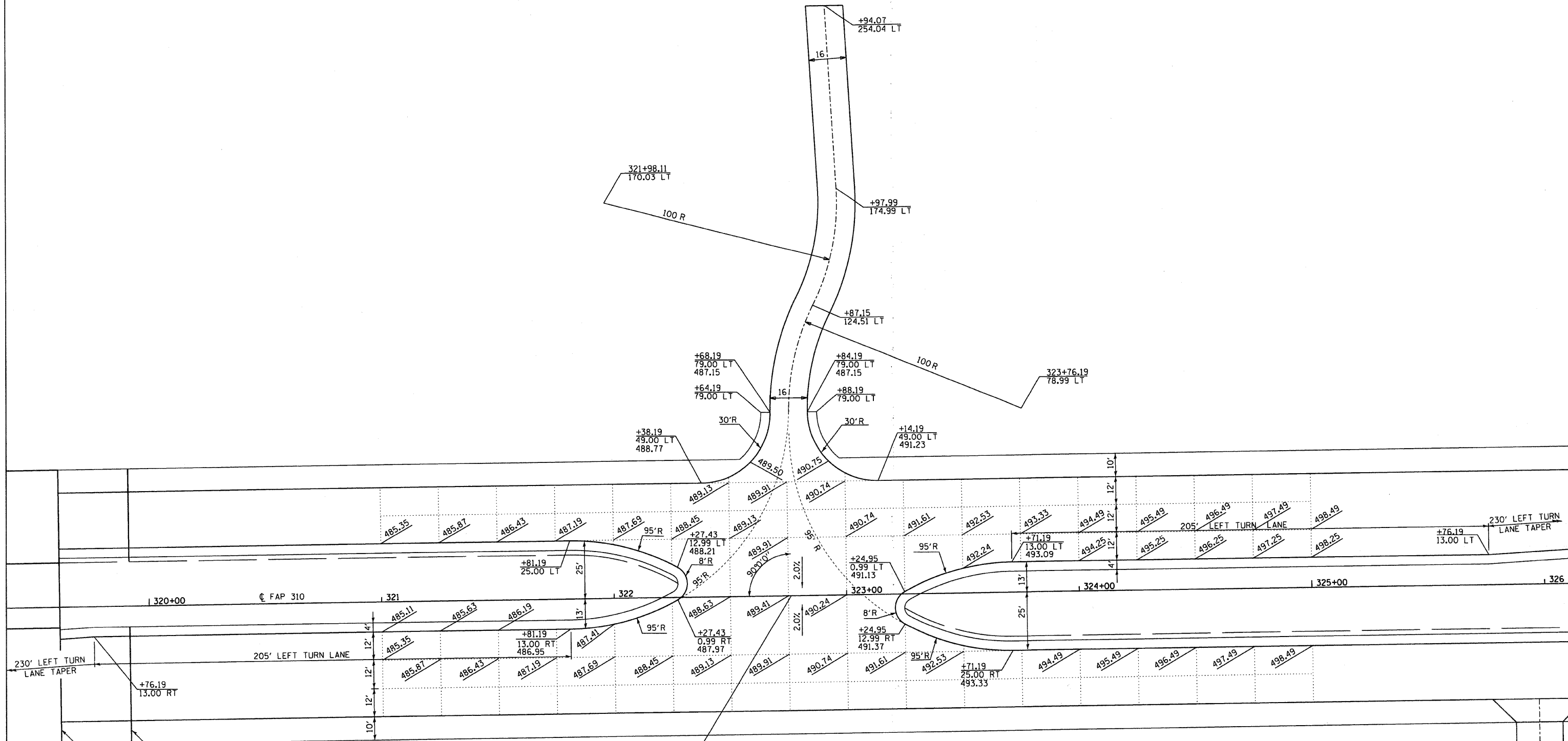

BRIDGE APPROACH PAVEMENT
 SN 042-0026 (PR SB)
 SN 042-0027 (PR NB)

STA 322+76.19 US 67 (FAP 310)
 STA 322+76.19 PRIVATE ENTRANCE

NOTE:
 MAINLINE IS TANGENT THROUGH INTERSECTION

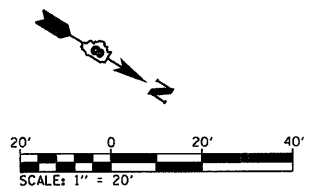

REVISIONS	
NAME	DATE

ILLINOIS DEPARTMENT OF TRANSPORTATION
INTERSECTION DETAILS
 PRIVATE ROAD - TRINITY LANE
 FAP ROUTE 310
 SECTION 60-16-1&1B,42-1&1B
 MADISON AND JERSEY COUNTY
 DRAWN BY: EMR
 CHECKED BY: GLF