

FAP ROUTE	SECTION	COUNTY	TOTAL SHEETS	SHEET NO.
310	60-16-1&1B,42-1&1B	MADISON AND JERSEY	481	132
EXISTING CONDITIONS:				

CONTRACT NO. 76318

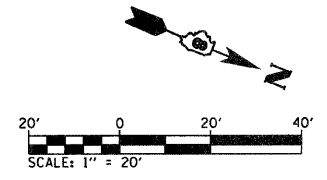

DATE	
BY	
REVISIONS	
PLANNED	
DESIGNED	
CHECKED	
IN CHARGE	
NOTE BOOK NO.	
FILE NAME	

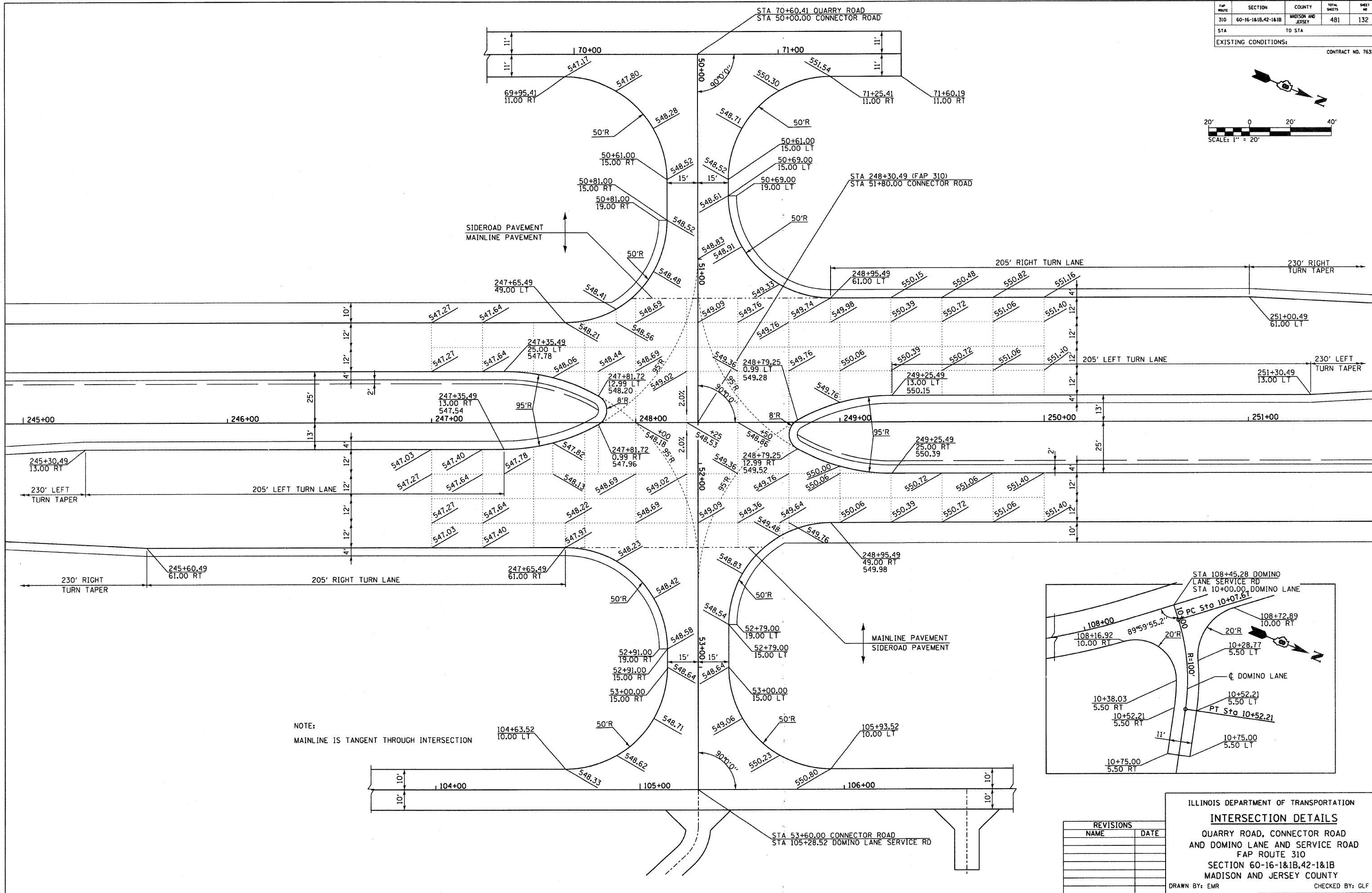

NOTE:
MAINLINE IS TANGENT THROUGH INTERSECTION

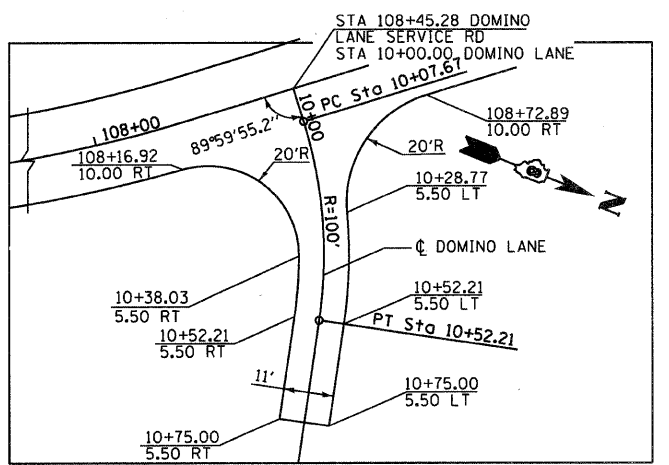

REVISIONS	
NAME	DATE

ILLINOIS DEPARTMENT OF TRANSPORTATION
INTERSECTION DETAILS
QUARRY ROAD, CONNECTOR ROAD
AND DOMINO LANE AND SERVICE ROAD
FAP ROUTE 310
SECTION 60-16-1&1B,42-1&1B
MADISON AND JERSEY COUNTY
DRAWN BY: EMR CHECKED BY: GLF