

FAP ROUTE	SECTION	COUNTY	TOTAL SHEETS	SHEET NO.
310	60-16-1&18,42-1&18	MADISON/JERSEY	481	142
STA. TO STA.		EXISTING CONDITIONS:		

CONTRACT NO. 76318

PLAN	SURVEYED	DATE
NO.	BY	
	NOTED	
	PLOTTED	
	CHECKED	
	DATE	
	FILE NAME	

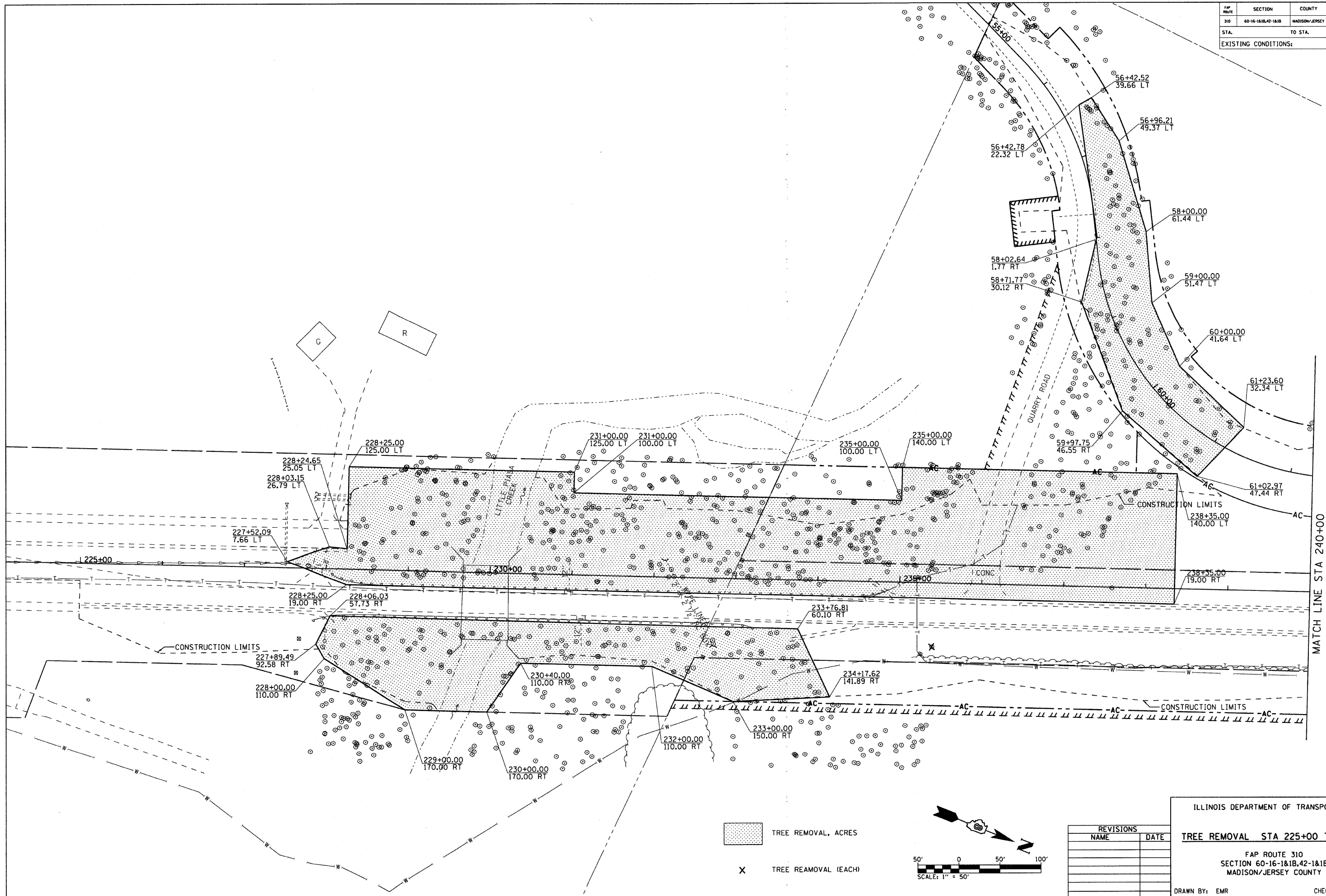

TREE REMOVAL, ACRES  
 TREE REMOVAL (EACH)

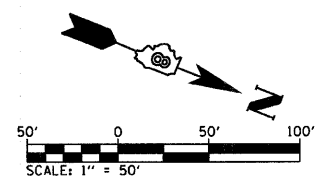

REVISIONS	
NAME	DATE

ILLINOIS DEPARTMENT OF TRANSPORTATION

**TREE REMOVAL STA 225+00 TO 240+00**

FAP ROUTE 310  
SECTION 60-16-1&18,42-1&18  
MADISON/JERSEY COUNTY

DRAWN BY: EMR      CHECKED BY: GLF

MATCH LINE STA 240+00