

FAP ROUTE	SECTION	COUNTY	TOTAL SHEETS	SHEET NO.
310	60-16-1&1B,42-1&1B	MADISON/JERSEY	481	143
STA. TO STA.		EXISTING CONDITIONS:		

CONTRACT NO. 76318

PLAN	NO. _____	DATE _____
BY	_____	_____
REVISIONS	_____	_____
ALIGNED	_____	_____
CHECKED	_____	_____
DATE	_____	_____
FILE NAME	_____	_____

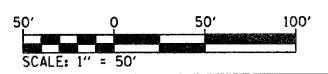
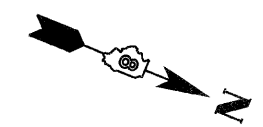
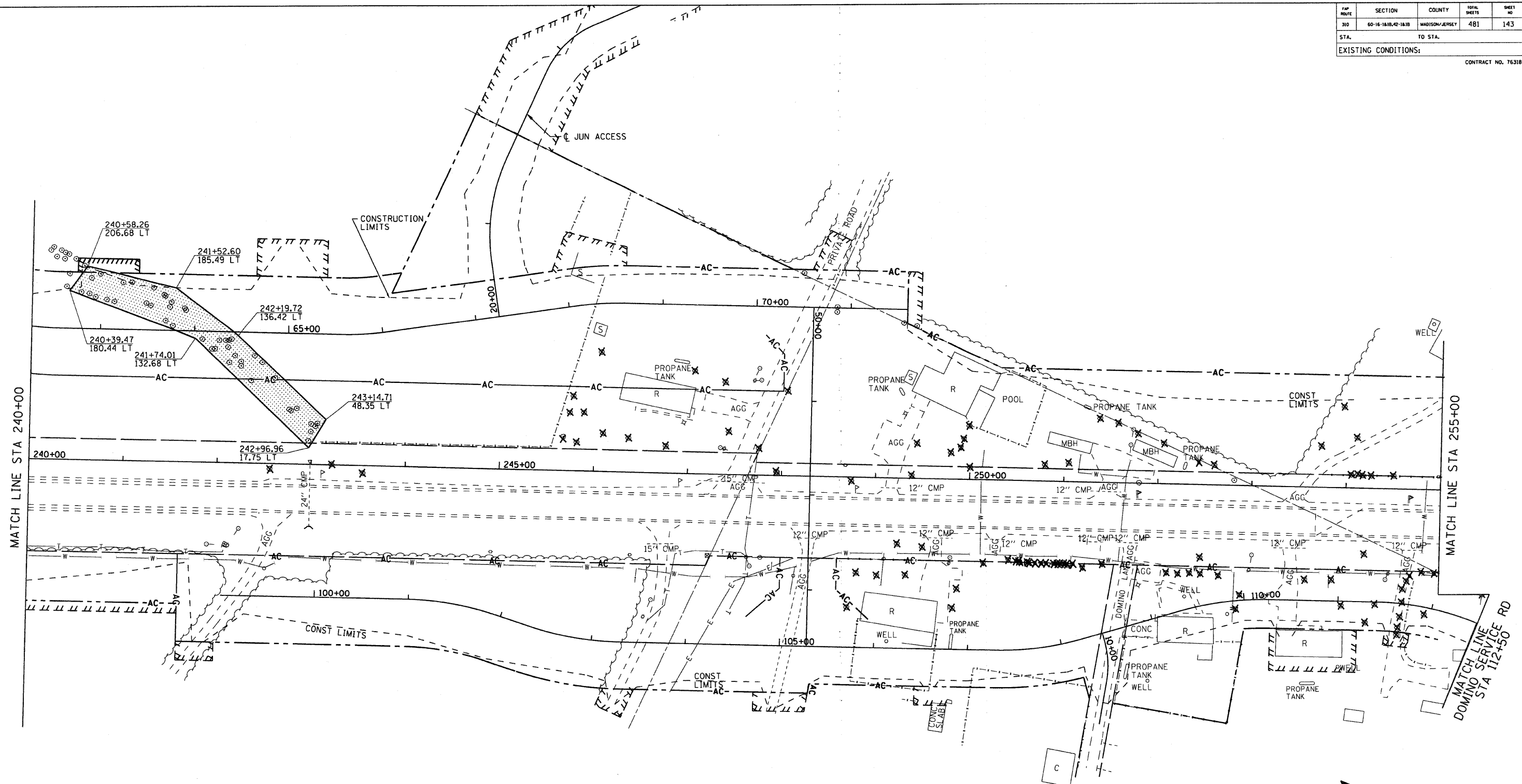

- TREE REMOVAL, ACRES
- TREE REMOVAL (EACH)

REVISIONS	
NAME	DATE

ILLINOIS DEPARTMENT OF TRANSPORTATION
TREE REMOVAL STA 240+00 TO 255+00
 FAP ROUTE 310
 SECTION 60-16-1&1B,42-1&1B
 MADISON/JERSEY COUNTY
 DRAWN BY: EMR CHECKED BY: GLF