

| FAP ROUTE | SECTION | COUNTY | TOTAL SHEETS | SHEET NO. |
|--------------|--------------------|----------------------|--------------|-----------|
| 310 | 60-16-1&1B,42-1&1B | MADISON/JERSEY | 481 | 149 |
| STA. TO STA. | | EXISTING CONDITIONS: | | |

CONTRACT NO. 76318

| | | |
|------|-----------|------|
| PLAN | REVISIONS | DATE |
| NO. | NO. | |
| NO. | NO. | |
| NO. | NO. | |
| NO. | NO. | |
| NO. | NO. | |

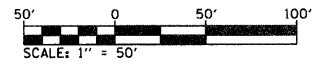
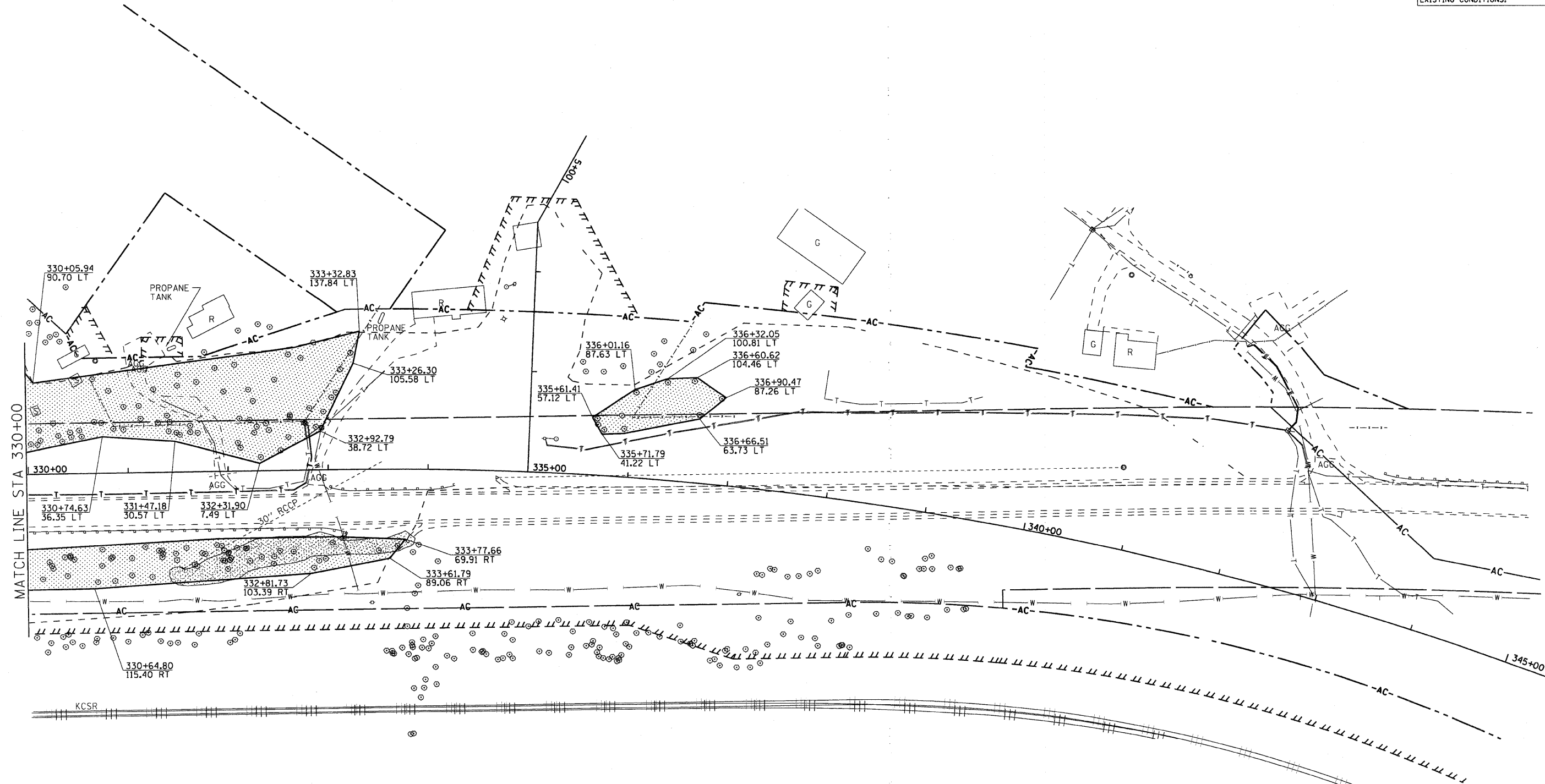

- TREE REMOVAL, ACRES
- TREE REAMOVAL (EACH)

| REVISIONS | |
|-----------|------|
| NAME | DATE |
| | |
| | |
| | |
| | |
| | |

ILLINOIS DEPARTMENT OF TRANSPORTATION

TREE REMOVAL STA 330+00 TO 337+00

FAP ROUTE 310
SECTION 60-16-1&1B,42-1&1B
MADISON/JERSEY COUNTY

DRAWN BY: EMR CHECKED BY: GLF