

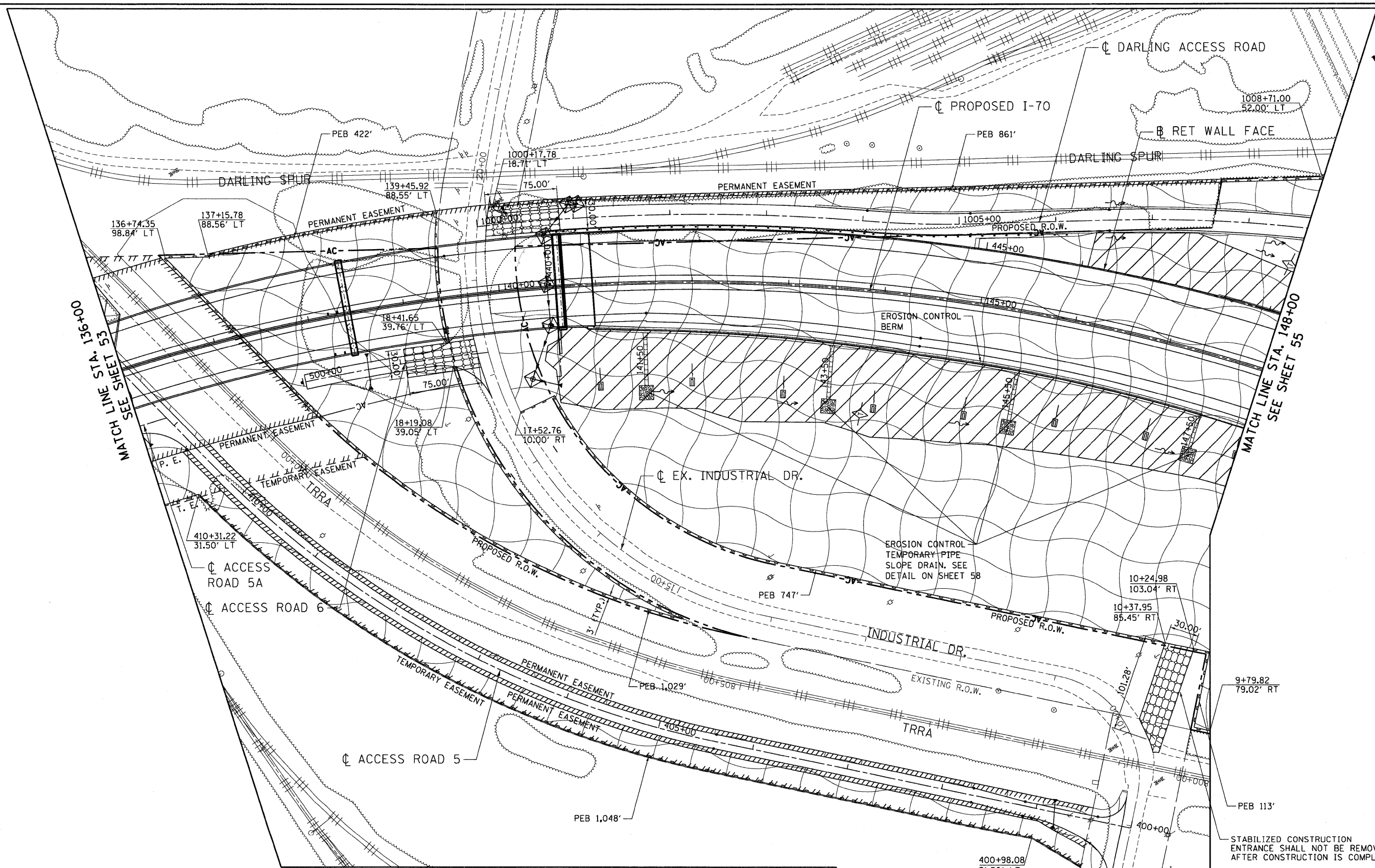







\DBCCONN-99-MOTIFL.DGN, \DBCCONN-95-LEGEND1.DGN, \DBCCONN-95-MOTIFL.DGN, \DBCCONN-95-BORDER.DGN, \DBCCONN-95-CONNSHEETS.CONNSHEETS.CONTRACT 06.DBCONN-95-SHT-EROSI-136800.DGN
 6-10-2010, 10:48:27 BONDHJJD \\FS-004\AMV\VAL.LD-TRANS.07-2202-2886B-001\CIVIL\CA0A\99 ALL CONTRACTS\CONNSHEETS.CONTRACT 06.DBCONN-95-SHT-EROSI-136800.DGN

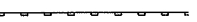

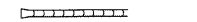
EROSION CONTROL LEGEND

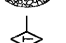
-  INLET FILTERS
-  STABILIZED CONSTRUCTION ENTRANCE
-  PERIMETER EROSION BARRIER (PEB)
-  TEMPORARY EROSION CONTROL SEEDING & MULCH, METHOD 2
-  TEMPORARY PIPE SLOPE DRAINS
-  STONE RIPRAP
-  AGGREGATE BERM
-  TEMPORARY DITCH CHECK
-  EROSION CONTROL BLANKET (MULCH NOT REQUIRED)

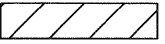
STATE OF ILLINOIS
DEPARTMENT OF TRANSPORTATION
 I-70 CONNECTION

PROPOSED I-70
EROSION CONTROL PLANS
STA. 136 + 00 TO STA. 148 + 00

F.A.P. RTE. 998	SECTION 82-2-1HVB	COUNTY ST. CLAIR	TOTAL SHEETS 285	SHEET NO. 54	CONTRACT NO. 76C44
FED. ROAD DIST. NO. ILLINOIS FED. AID PROJECT					

FILE NAME =
 #FILEL#

USER NAME = #USER#
 PLOT SCALE = #SCALE#
 PLOT DATE = #DATE#

DESIGNED - JB
 DRAWN - JB
 CHECKED - ACL
 DATE - 06/04/10

REVISED -
 REVISED -
 REVISED -
 REVISED -

SCALE: 1"=50' SHEET NO. OF SHEETS STA. TO STA.

STABILIZED CONSTRUCTION ENTRANCE SHALL NOT BE REMOVED AFTER CONSTRUCTION IS COMPLETE