

STATE OF ILLINOIS
DEPARTMENT OF TRANSPORTATION
DIVISION OF HIGHWAYS

**PROPOSED
HIGHWAY PLANS**

FAP ROUTE 331 (IL 13)
SECTION (6-1)RS-2(6-3,6-2,7-1,7-3)RS-1
PROJECT NO. *NHF-0331(052)*
3P MILLING AND RESURFACING
WILLIAMSON COUNTY

C-99-047-10

F.A.P. RTE.	SECTION	COUNTY	TOTAL SHEETS	SHEET NO.
331	*	WILLIAMSON	30	1
		ILLINOIS	CONTRACT NO. 78190	

* (6-1)RS-2(6-3,6-2,7-1,7-3)RS-1

D-99-047-10

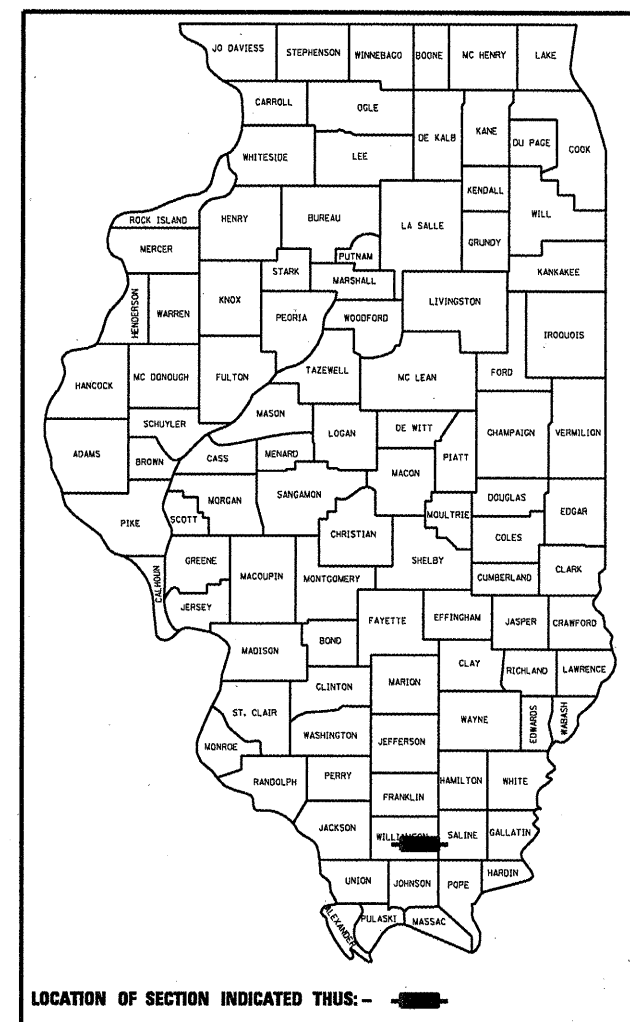

FOR INDEX OF SHEETS, SEE SHEET NO. ...

ADT (2010) 12,520
PV = 11,538
MU = 451
SU = 531
TRUCKS = 7.8%

EQUATION STATIONS:

EQ. STA. 158 + 99.52 (BK) = STA. 158 + 82.63 (AH)
EQ. STA. 187 + 35.71 (BK) = STA. 187 + 24.75 (AH)
EQ. STA. 207 + 07.46 (BK) = STA. 73 + 56.13 (AH)

TOWNSHIPS: CRAB ORCHARD, EAST MARION

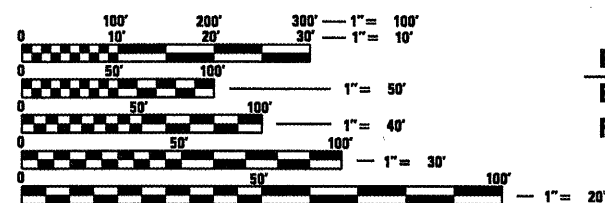

FULL SIZE PLANS HAVE BEEN PREPARED USING STANDARD ENGINEERING SCALES. REDUCED SIZED PLANS WILL NOT CONFORM TO STANDARD SCALES. IN MAKING MEASUREMENTS ON REDUCED PLANS, THE ABOVE SCALES MAY BE USED.

J.U.L.I.E.
JOINT UTILITY LOCATION INFORMATION FOR EXCAVATION
1-800-892-0123
OR 811

PROJECT ENGINEER CHARLES STEIN - (618)351-5210
PROJECT DESIGNER KATHI MCCORD - (618)351-5216

CONTRACT NO. 78190

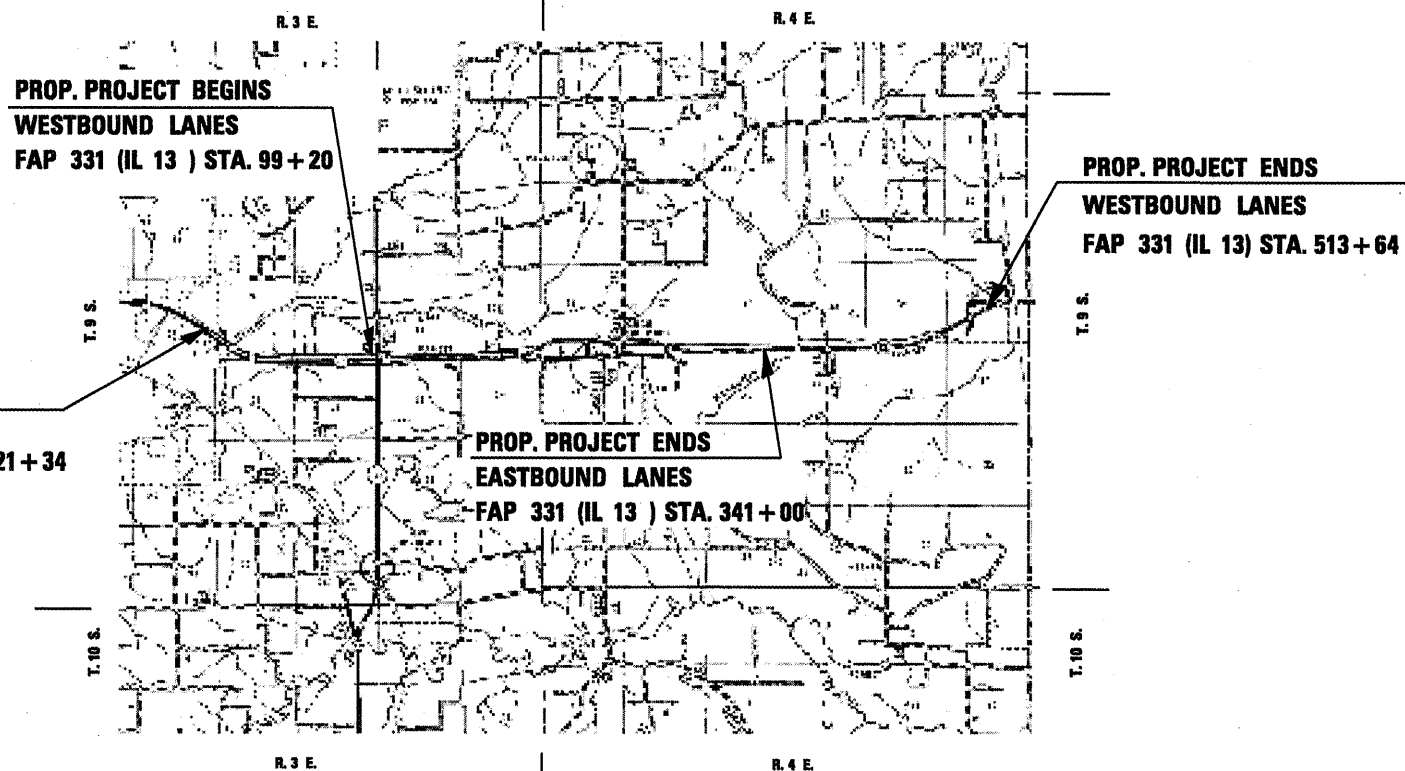

GROSS LENGTH = 77,789.18 FT. = 14.73 MILES
NET LENGTH = 77,473.18 FT. = 14.67 MILES

STATE OF ILLINOIS
DEPARTMENT OF TRANSPORTATION
DIVISION OF HIGHWAYS

SUBMITTED 5/4/10 20
[Signature]
DEPUTY DIRECTOR OF HIGHWAYS, REGION ENGINEER

June 05 2010
Scott E. Stitt P.E. /s/ acting ENGINEER OF DESIGN AND ENVIRONMENT

June 25 2010
Christine M. Reader /s/ DIRECTOR OF HIGHWAYS, CHIEF ENGINEER

**PRINTED BY THE AUTHORITY
OF THE STATE OF ILLINOIS**

Prepared By: *Joe Zdanewicz*
DISTRICT STUDIES & PLANS ENGINEER

Examined By: *Paula Emery*
DISTRICT LAND ACQUISITION ENGINEER

Examined By: *Carrie Nelson*
DISTRICT PROGRAM DEVELOPMENT ENGINEER

Examined By: *W. Kelly*
DISTRICT OPERATIONS ENGINEER

Examined By: *Jim Smothers*
DISTRICT CONSTRUCTION ENGINEER

Examined By: *Bruce Puckler*
DISTRICT MATERIALS ENGINEER

Examined By: *Jim Smothers*
DISTRICT PROJECT IMPLEMENTATION ENGINEER

Examined By: *Danny Clayton*
ASSISTANT REGIONAL ENGINEER

Approved By: *W. Chami*
DEPUTY DIRECTOR OF HIGHWAYS, REGION ENGINEER

May 4 2008
DATE

(6-11RS-216-3.6-2.7-1.7-31RS-1

FILE NAME =	USER NAME = mcoordkr	DESIGNED -	REVISED -
at\pwwork\PWIDOT\MCCORDKR\d0186822\78	98-shr-misc.dgn	DRAWN -	REVISED -
	PLOT SCALE = 100.0000 1 / IN.	CHECKED -	REVISED -
	PLOT DATE = 4/27/2010	DATE -	REVISED -

**STATE OF ILLINOIS
DEPARTMENT OF TRANSPORTATION**

-----SIGNATURE BLOCK-----

SCALE: _____ SHEET NO. _____ OF _____ SHEETS STA. _____ TO STA. _____

F.A.P. RTE.	SECTION	COUNTY	TOTAL SHEETS	SHEET NO.
331		WILLIAMS	30	2
CONTRACT NO. 79190				
ILLINOIS FED. AID PROJECT				

MIXTURE REQUIREMENTS SHALL BE PREPARED AS DIRECTED BELOW:

FAP 331 (IL 13)
MAINLINE SURFACE COURSE

Mixture Use(s):	Polymerized Hot-Mix Asphalt Surface Course, Mixture D, N90
AC/PG:	SBS PG76-22
RAP % (Max.):	0
Design Air Voids:	4.0%, 90 Gyraton Design
Mixture Composition: (Gradation Mixture)	IL-9.5mm or IL-12.5 mm
Friction Aggregate:	D Surface

MAINLINE LEVELING BINDER

Mixture Use(s):	Hot-Mix Asphalt Surface Course, Mixture C, N90
AC/PG:	PG64-22
RAP % (Max.):	10
Design Air Voids:	4.0%, 90 Gyraton Design
Mixture Composition: (Gradation Mixture)	IL-9.5mm or IL-12.5 mm
Friction Aggregate:	C Surface

INCIDENTAL HMA SURFACING

Mixture Use(s):	Hot-Mix Asphalt Surface Course, Mixture C, N90
AC/PG:	PG64-22
RAP % (Max.):	10
Design Air Voids:	4.0%, 90 Gyraton Design
Mixture Composition: (Gradation Mixture)	IL-9.5mm or IL-12.5 mm
Friction Aggregate:	C Surface

HOT-MIX ASPHALT SHOULDERS

Mixture Use(s):	Hot-Mix Asphalt Shoulders Top Lift
AC/PG:	PG64-22
RAP % (Max.):	10
Design Air Voids:	4.0%, 70 Gyraton Design
Mixture Composition: (Gradation Mixture)	IL-9.5mm or IL 12.5mm
Friction Aggregate:	C Surface

STRUCTURE RATINGS SCHEDULE

STRUCTURE NO.	STATION	INV. RATING	OPR. RATING	SUFF. RATING
SN 100-0022	EBL 136+13	18.8	31.3	79.5
SN 100-2000	EBL 142+50	31.5	52.4	76.3
SN 100-2010	WBL 249+70	22.9	38.2	70.0
SN 100-0068	WBL 478+25	27.1	49.9	96.3

MTD ALLOWANCES

- SN 100-0022 - Only an empty MTD will be allowed over this structure.
- SN 100-2000 - A loaded MTD will be allowed over this structure.
- SN 100-2010 - A loaded MTD will be allowed over this structure.
- SN 100-0068 - A loaded MTD will be allowed over this structure.

16-11RS-216-3,6-2,7-1,7-31RS-1

SUMMARY OF QUANTITIES

80% FED. / 20% STATE

SUMMARY OF QUANTITIES

RESURFACING	
WILLIAMSON COUNTY	
CONSTRUCTION TYPE CODE 1000	
FAP 331 (IL 13 WBL)	FAP 331 (IL 13 EBL)

CODE NUMBER	ITEM DESCRIPTION	UNIT	TOTAL QUANTITY	QUANTITY	QUANTITY
X0322729	MATERIAL TRANSFER DEVICE	TON	31643	17019	14624
Z0017100	DOWEL BARS	EACH	580		580
40600100	BITUMINOUS MATERIALS (PRIME COAT)	GALLON	51548.4	27930.3	23618.1
40600300	AGGREGATE (PRIME COAT)	TON	659.5	465.6	393.7
40600645	LEVELING BINDER (MACHINE METHOD), N90	TON	12645	6797	5848
40600982	HOT-MIX ASPHALT SURFACE REMOVAL - BUTT JOINT	SQ YD	3686	1588	2098
40600990	TEMPORARY RAMP	SQ YD	143	73	70
40603545	^{IZED} POLYMER-HOT-MIX ASPHALT SURFACE COURSE, MIXTURE 'D', N90	TON	18998	10222	8776
40800050	INCIDENTAL HOT-MIX ASPHALT SURFACING	TON	220	94	126
44000151	HOT-MIX ASPHALT SURFACE REMOVAL, 1/2"	SQ YD	184591	115782	68809
44200517	CLASS A PATCHES, TYPE II, 7 INCH	SQ YD	137		137
44200970	CLASS B PATCHES, TYPE II, 10 INCH	SQ YD	124		124
44212900	PAVEMENT PATCHING (PARTIAL DEPTH)	SQ YD	200		200
44213000	PATCHING REINFORCEMENT	SQ YD	137		137
44213200	SAW CUTS	FOOT	1106		1106
48102100	AGGREGATE WEDGE SHOULDER, TYPE B	TON	3979	2077	1902
48203100	HOT-MIX ASPHALT SHOULDERS	TON	14389	7872	6517
67000400	ENGINEER'S FIELD OFFICE, TYPE A	CAL MO	3	1.5	1.5
67100100	MOBILIZATION	L SUM	1	0.5	0.5
70100310	TRAFFIC CONTROL AND PROTECTION, STANDARD 701421	L SUM	1	0.5	0.5
70106800	CHANGEABLE MESSAGE SIGN	CAL MO	4	2	2
70300100	SHORT- TERM PAVEMENT MARKING	FOOT	15326	8429	6897

SUMMARY OF QUANTITIES

001.FED./201.STATE

RESURFACING WILLIAMSON COUNTY CONSTRUCTION TYPE CODE 1000					
			FAP 331 (IL 13 WBL)	FAP 331 (IL 13 EBL)	
CODE NUMBER	ITEM DESCRIPTION	UNIT	TOTAL QUANTITY	QUANTITY	QUANTITY
70300210	TEMPORARY PAVEMENT MARKING - LETTERS AND SYMBOLS	SO FT	837.2	400.4	436.8
70300220	TEMPORARY PAVEMENT MARKING-LINE 4"	FOOT	154650	84007	70643
70300230	TEMPORARY PAVEMENT MARKING-LINE 5"	FOOT	19111	10309	8802
70300280	TEMPORARY PAVEMENT MARKING-LINE 24"	FOOT	455	198	257
70301000	WORK ZONE PAVEMENT MARKING REMOVAL	SO FT	62664	33906	28758
* 78003100	PREFORMED PLASTIC PAVEMENT MARKING, TYPE B - LETTERS AND SYMBOLS	SO FT	837.2	400.4	436.8
* 78003110	PREFORMED PLASTIC PAVEMENT MARKING, TYPE B - LINE 4"	FOOT	154650	84007	70643
* 78003120	PREFORMED PLASTIC PAVEMENT MARKING, TYPE B - LINE 5"	FOOT	19111	10309	8802
* 78003180	PREFORMED PLASTIC PAVEMENT MARKING, TYPE B - LINE 24"	FOOT	455	198	257
* 78100100	RAISED REFLECTIVE PAVEMENT MARKER	EACH	460	223	237
78300200	RAISED REFLECTIVE PAVEMENT MARKER REMOVAL	EACH	460	223	237
* 88600100	DETECTOR LOOP, TYPE I	FOOT	473	240	233

**Specialty Items*

16-11RS-216-3,6-2,7-1,7-31RS-1

ILLINOIS FED. AID PROJECT

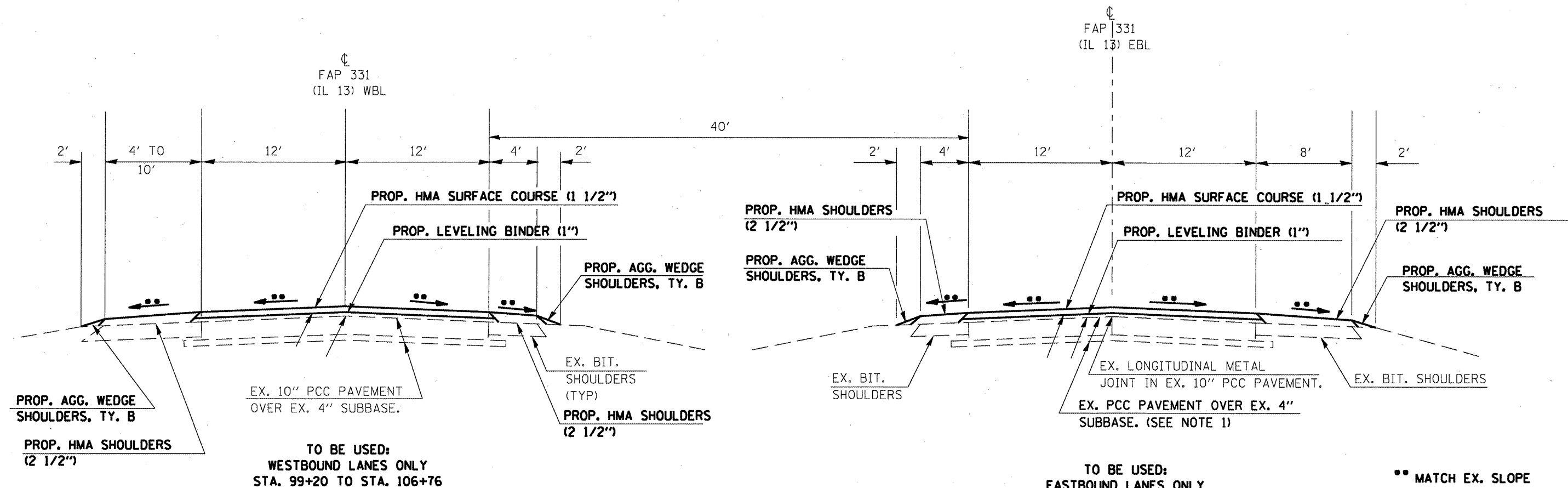

TO BE USED:
WESTBOUND LANES ONLY
STA. 99+20 TO STA. 106+76

TO BE USED:
EASTBOUND LANES ONLY
STA. 121+34 TO STA. 135+62
OMIT SN 100-0022
STA. 136+70 TO STA. 207+07.46
STA. 73+56.13 TO STA. 107+90

EQUATION STATIONS PRIOR TO IL 166:
STA. 158+99.52 (BK) = STA. 158+82.63 (AH)
STA. 187+35.71 (BK) = STA. 187+24.75 (AH)
STA. 207+07.46 (BK) = STA. 73+56.13 (AH)

NOTE 1:
EX. 10" PCC PAVEMENT IS FROM
STA. 121+34 TO STA. 137+10.
EX. 7" CONT. REINF. PCC PAVEMENT
IS FROM STA. 137+10 TO STA. 107+90
(SEE EQUATION STATIONS).
CLASS B PATCHING SHALL BE USED
THROUGHOUT THE 10" BARE PCC PAVEMENT
AND CLASS A PATCHING SHALL BE USED
THROUGHOUT THE 7" BARE CR PCC PAVEMENT
AND AT THE INTERSECTION OF IL 13 AND IL 166.

** MATCH EX. SLOPE

* (6-1)RS-2(6-3,6-2,7-1,7-3)RS-1

FILE NAME =	USER NAME = macordkr	DESIGNED -	REVISED -	STATE OF ILLINOIS DEPARTMENT OF TRANSPORTATION	TYPICAL SECTION EASTBOUND LANE	F.A.P. RTE. =	SECTION	COUNTY	TOTAL SHEETS	SHEET NO.	
c:\pwwork\pwsdot\macordkr\d0186822\781	0-shht-plen.dgn	DRAWN -	REVISED -			331	*	WILLIAMSON	30	7	
PLOT SCALE = 100.0000' / IN.	CHECKED -	REVISED -	SCALE: _____			SHEET NO. _____ OF _____ SHEETS	STA. 121+34 TO STA. 107+90	CONTRACT NO. 78190			
PLOT DATE = 5/5/2010	DATE -	REVISED -	ILLINOIS FED. AID PROJECT								

TYPICAL SECTION
FAP 331 (IL 13)
LOOKING EAST

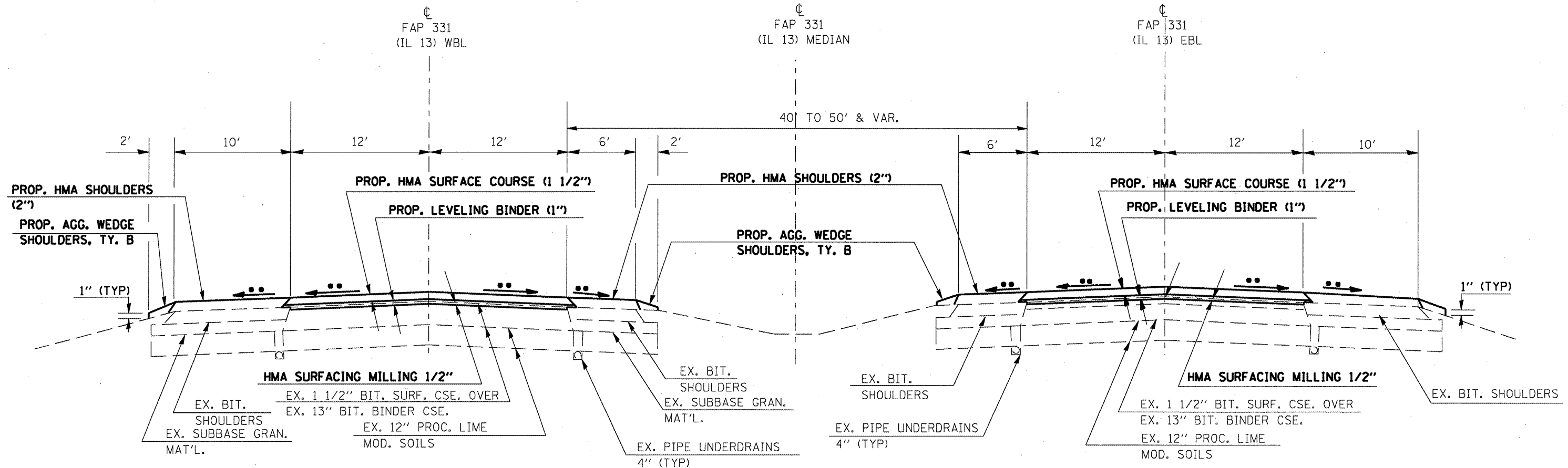

TO BE USED:
WESTBOUND LANES
STA. 106+76 (END OF BARE PCC PAVT.) TO
STA. 477+36 (WEST APPROACH SN 100-0068)
STA. 479+45 (EAST APPROACH SN 100-0068) TO
STA. 513+64 (PR. BUTT JT.)

TO BE USED:
EASTBOUND LANES
STA. 107+90 TO
STA. 341+00 (PR. BUTT JT.)

•• MATCH EX. SLOPE

* (6-1)RS-2(6-3,6-2,7-1,7-3)RS-1

FILE NAME =	USER NAME = mcoordkr	DESIGNED -	REVISED -	STATE OF ILLINOIS DEPARTMENT OF TRANSPORTATION	TYPICAL SECTIONS		F.A.P. RTE.	SECTION	COUNTY	TOTAL SHEETS	SHEET NO.
c:\pw_work\pwsdot\mcoordkr\ad8186822\781	0-shrt-plen.dgn	DRAWN -	REVISED -		EASTBOUND AND WESTBOUND		331	*	WILLIAMSON	30	8
	PLOT SCALE = 100.0000' / IN.	CHECKED -	REVISED -		SCALE: _____	SHEET NO. OF SHEETS	STA. 99+20	TO STA. 513+64	CONTRACT NO. 78190		
	PLOT DATE = 4/30/2010	DATE -	REVISED -		ILLINOIS FED. AID PROJECT						

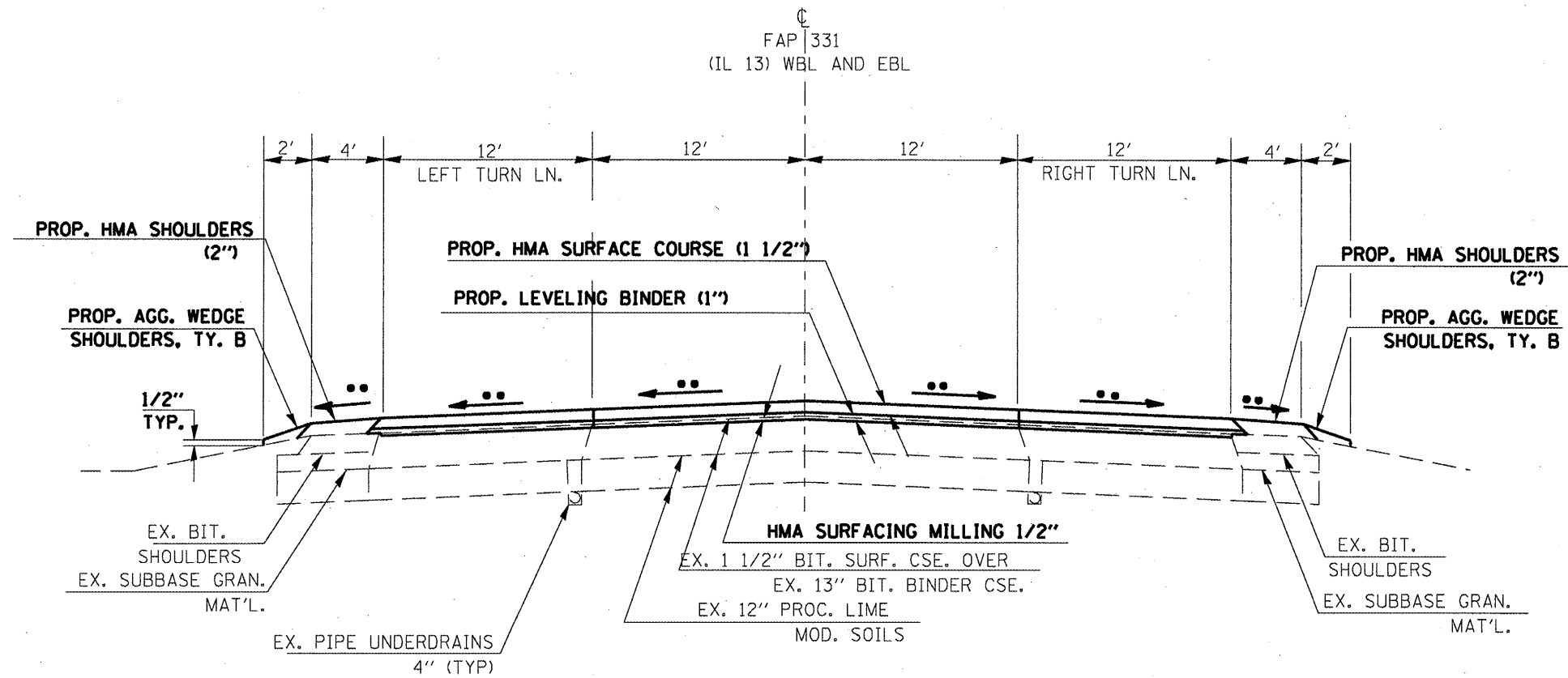

TO BE USED:
AT LEFT AND RIGHT TURN
LANES EAST OF IL. 166 INTERSECTION

•• MATCH EX. SLOPE

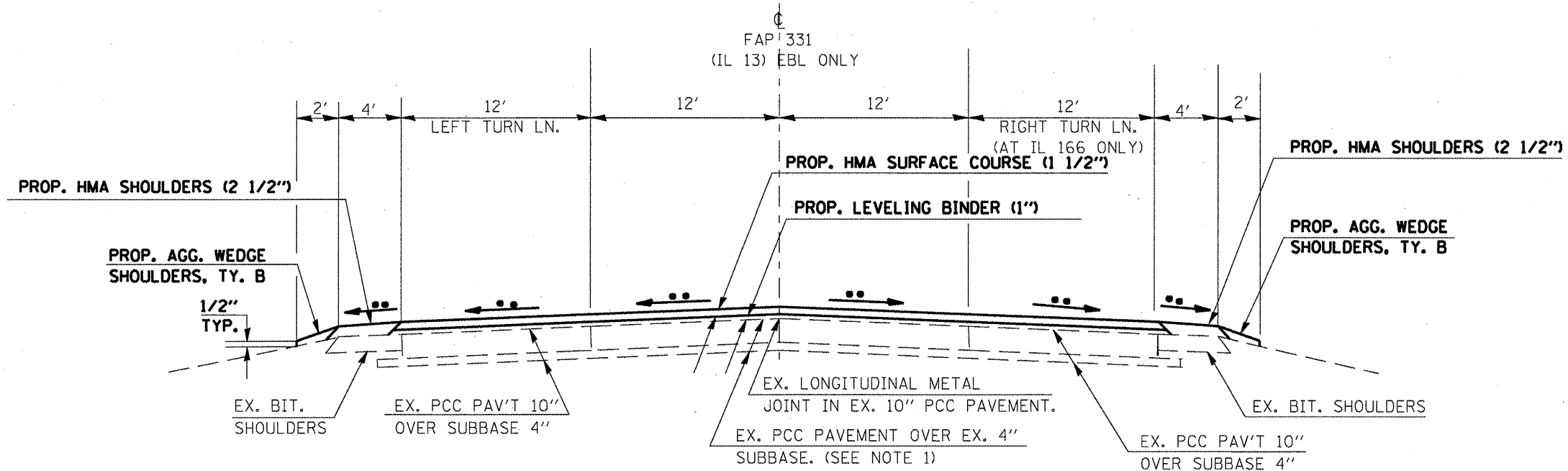

TO BE USED:
AT MOELLER RD., CRABTREE SCHOOL RD.
AND IL. 166 INTERSECTION

* (6-1)RS-2(6-3,6-2,7-1,7-3)RS-1

FILE NAME =
c:\pw_work\pwsdot\macordkr\d0186822\781

USER NAME = macordkr
0-shs-plan.dgn
PLOT SCALE = 100.0000 ' / IN.
PLOT DATE = 4/30/2010

DESIGNED -
DRAWN -
CHECKED -
DATE -

REVISED -
REVISED -
REVISED -
REVISED -

STATE OF ILLINOIS
DEPARTMENT OF TRANSPORTATION

TYPICAL SECTIONS
TURN LANE TREATMENTS
SCALE: SHEET NO. OF SHEETS STA. TO STA.

F.A.P. RTE.	SECTION	COUNTY	TOTAL SHEETS	SHEET NO.
331	*	WILLIAMSON	30	9
CONTRACT NO. 10190				
ILLINOIS FED. AID PROJECT				

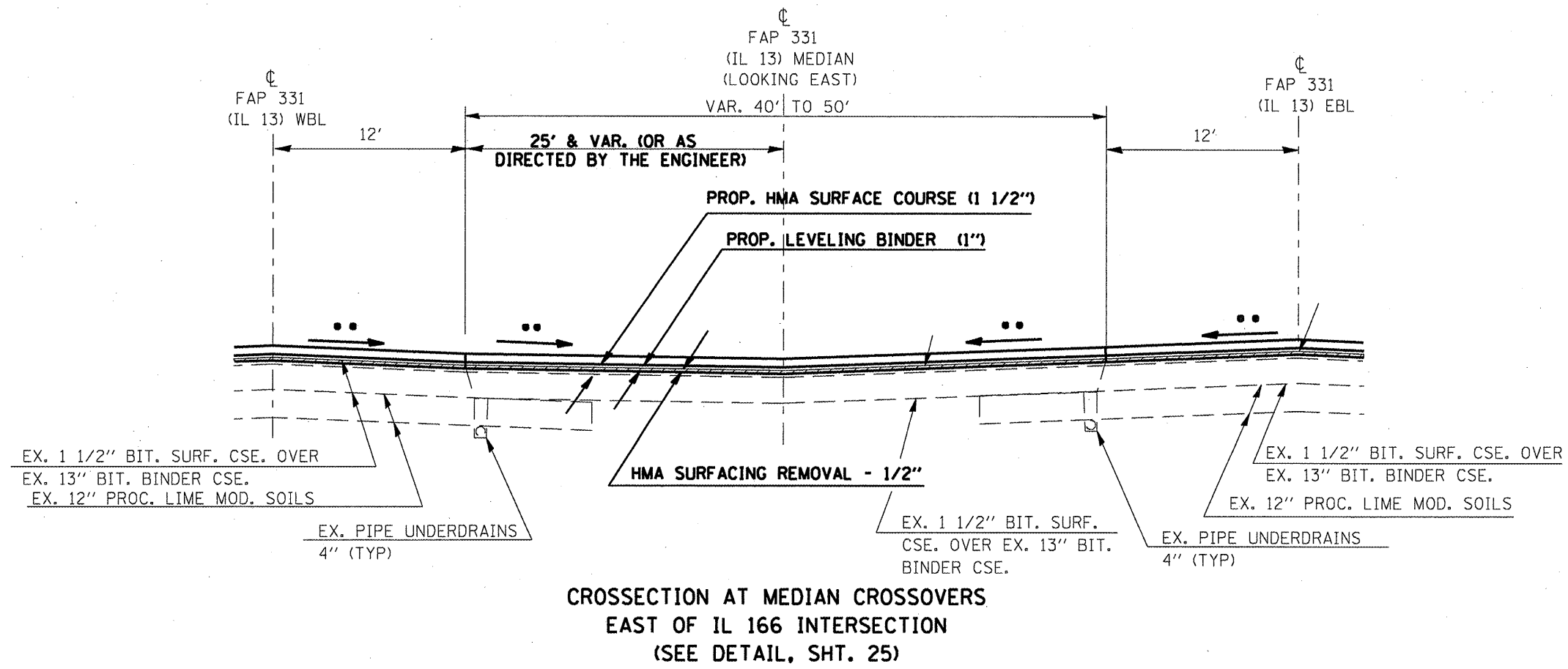

•• MATCH EX. SLOPE

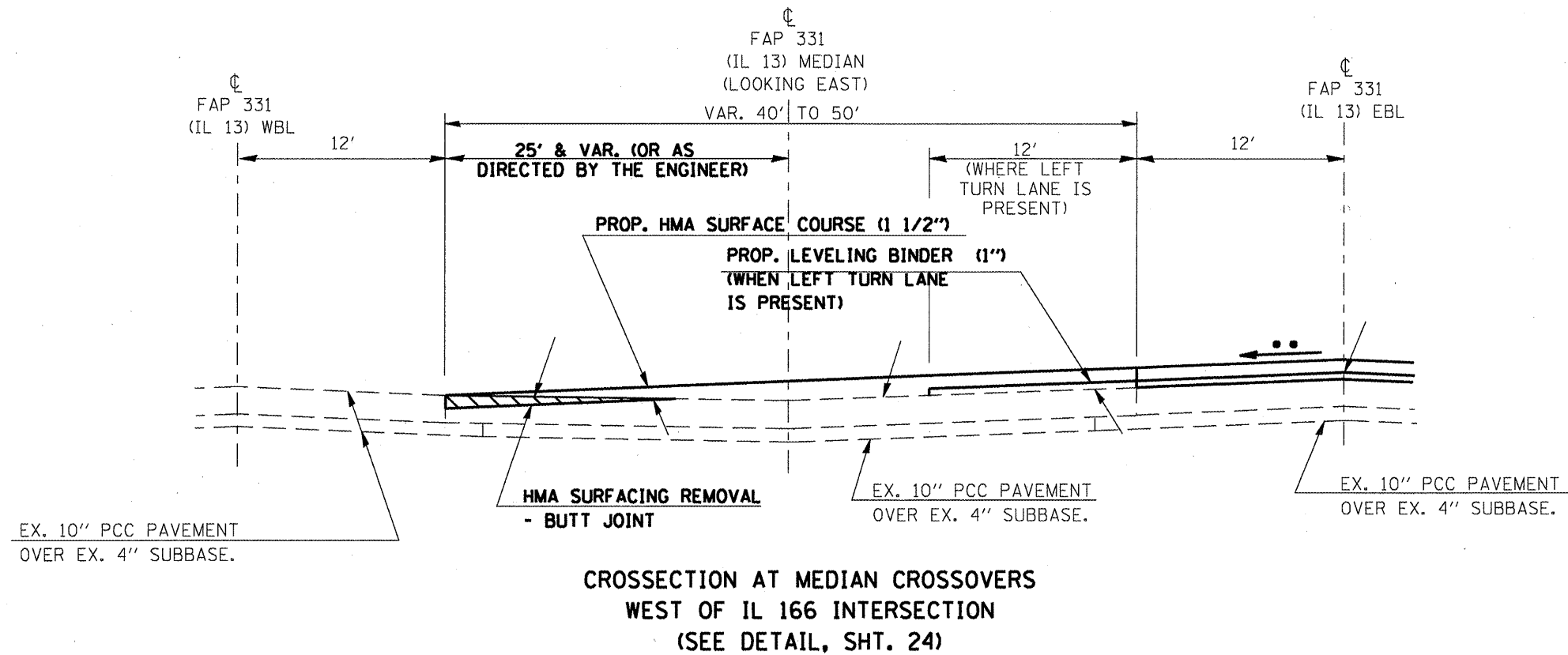

* (6-1)RS-2(6-3,6-2,7-1,7-3)RS-1

FILE NAME =	USER NAME = mcoordkr	DESIGNED -	REVISED -	STATE OF ILLINOIS DEPARTMENT OF TRANSPORTATION	MEDIAN CROSSOVER DETAILS	F.A.P. RTE. =	SECTION =	COUNTY =	TOTAL SHEETS =	SHEET NO. =	
ct:\pw_work\PW100T\MCCORDKR\d0186922\78	10-shr-plan.dgn	DRAWN -	REVISED -			331	*	WILLIAMSON	30	10	
	PLOT SCALE = 100.0000' / IN.	CHECKED -	REVISED -			CONTRACT NO. 70190					
	PLOT DATE = 5/3/2010	DATE -	REVISED -			ILLINOIS FED. AID PROJECT					
					SCALE: _____	SHEET NO. _____ OF _____ SHEETS		STA. _____ TO STA. _____			

IL 13 EASTBOUND LANES PAVEMENT RESURFACING SCHEDULE

LOCATION STATION TO STATION	LENGTH (FT)	ROADWAY WIDTH (FT)	LEFT BIT. SHOULDER WIDTH (FT)	RIGHT BIT. SHOULDER WIDTH (FT)	AGG. WEDGE SHOULDER WIDTH (FT)	ROADWAY AREA (SQ YD)	HOT-MIX ASP. SURF. REMOV. - BUTT JT. (SQ YD)	HOT-MIX ASP. SURF. REMOV. 1/2" (SQ YD)	TEMP RAMP (SQ YD)	POLY. HMA SUR. CSE., MIX D. N 90 (1 1/2") (TON)	LEVELING BINDER (MM) N90 (1") (TON)	BIT. MAT. (PRIME COAT) (GAL)	AGG. (PRIME COAT) (TON)	NOTES														
															FOR INFORMATIONAL PURPOSE ONLY													
															(FT)	(FT)	(FT)	(FT)	(FT)	(SQ YD)	(SQ YD)	(SQ YD)	(SQ YD)	(TON)	(TON)	(GAL)	(TON)	
FAP 331 (IL 13 EBL) - Sta. 121+34 to Sta. 107+90																												
Begin Ex. Bare Pcc Pavt.																												
121+34.00 TO 135+62.00	1428	24.0	4.0	8.0	2.0	3808	200		13	322	216	685.4	11.4															
135+62.00							200		13																			
Omit S.N. 100-0022 Sta. 135+62 to Sta. 136+70																												
136+70.00 TO 158+99.52	2230	24.0	4.0	8.0	2.0	5945	200		13	503	337	1070	17.8															
Eq. Sta. 158+99.52 (bk.) = Sta. 158+82.63 (ch.)																												
158+82.63 TO 187+35.71	2853	24.0	4.0	8.0	2.0	7608				643	431	1369	22.8															
Eq. Sta. 187+35.71 (bk.) = Sta. 187+24.75 (ch.)																												
187+24.75 TO 207+07.46	1983	24.0	4.0	8.0	2.0	5287				447	299	952	15.9															
Eq. Sta. 207+07.46 (bk.) = Sta. 73+56.13 (ch.)																												
73+56.13 TO 107+90.00	3434	24.0	4.0	8.0	2.0	9157				774	518	1648	27.5															
End Bare Pcc Pavt. / Begin Bit. Surf. Pavt.																												
107+90.00 TO 341+00.00	23310	24.0	6.0	10.0	2.0	62160	178	62160	13	5250	3489	11189	186.5															
Ex. Turn Lanes and Crossovers																												
Main St. 121+34.00 TO 127+60.00	626	12.0	4.0		2.0	1081				91	61	194.6	3.2	Left Turn Ln & Xover														
Main St. 127+48.00 TO 128+54.00	106	10.0				118				10	7	21.2	0.4	Along EP @ Island														
Main St. 128+54.00 TO 135+62.00	708	16.0		8.0	2.0	855				72	48	154.0	2.6	Rt. Ent. Ramp & Taper														
Moeller St. 147+22.00 TO 153+78.00	656	12.0	4.0		2.0	874				74	49	157.4	2.6	Left Turn Ln & Xover														
Crabtree Sch. Rd. 174+07.00 TO 180+45.00	638	12.0	4.0		2.0	1026				87	58	184.6	3.1	Left Turn Ln & Xover														
Median Crossover 75+00.00						163				14	10	29.3	0.5	Crossover only														
Left Turn Ln. IL 166 95+39.00 TO 100+12.00	473	12.0	4.0		2.0	478				41	27	86.0	1.4	Left Turn Ln														
Right Turn Ln. IL 166 94+12.00 TO 99+78.00	566	12.0		4.0	2.0	590				50	33	106.2	1.8	Right Turn Ln.														
Davis Prairie Rd. 149+17.00 TO 154+52.00	535	12.0		4.0	2.0	542		542		46	31	98	1.6	Right Turn Ln.														
Stilleys Mill Rd. 175+50.00 TO 180+20.00	470	12.0	4.0		2.0	473		474		40	27	85	1.4	Left Turn Ln & Xover														
W. Crab Orchard Rd. 197+01.00 TO 204+90.00	789	12.0		4.0	2.0	859		859		73	48	155	2.6	Right Turn Ln.														
Barbara Kay Rd. 235+43.00 TO 240+50.00	507	12.0		4.0	2.0	633		633		54	36	114	1.9	Right Turn Ln.														
Paulton Rd. 258+04.00 TO 266+23.00	819	12.0		4.0	2.0	709		667		60	40	128	2.1	Right Turn Ln.														
Paulton Rd. 258+58.00 TO 265+33.00	675	12.0	4.0		2.0	782		782		66	44	141	2.3	Left Turn Ln & Xover														
E. Crab Orchard Rd. 290+07.00 TO 296+43.00	636	12.0		4.0	2.0	692		692		59	39	125	2.1	Right Turn Ln.														
EASTBOUND LANE MAINLINE TOTALS							778	66,809	53	8776	5848	18608.2	310.1															

* (6-11RS-216-3,6-2,7-1,7-3)RS-1

FILE NAME =	USER NAME = mcoordkr	DESIGNED -	REVISED -
at:\pwork\p1dot\mcoordkr\10186822\781	0-shh-misc.dgn	DRAWN -	REVISED -
PLOT SCALE = 1/8" = 100.0000' / IN.	CHECKED -	REVISIONS -	REVISIONS -
PLOT DATE = 4/30/2010	DATE -	REVISIONS -	REVISIONS -

**STATE OF ILLINOIS
DEPARTMENT OF TRANSPORTATION**

SCALE: _____		SHEET NO. _____ OF _____ SHEETS		STA. _____ TO STA. _____	
--------------	--	---------------------------------	--	--------------------------	--

F.A.P. RTE. 331	SECTION	COUNTY	TOTAL SHEETS	SHEET NO.
		WILLIAMSON	30	11
CONTRACT NO. 78190				
ILLINOIS FED. AID PROJECT				

IL 13 WESTBOUND LANES PAVEMENT RESURFACING SCHEDULE

LOCATION STATION TO STATION	LENGTH (FT)	ROADWAY WIDTH (FT)	LEFT BIT. SHOULDER WIDTH (FT)	RIGHT BIT. SHOULDER WIDTH (FT)	AGG. WEDGE SHOULDER WIDTH (FT)	ROADWAY AREA (SQ YD)	HOT-MIX ASP. SURF. REMOV. - BUTT JT. (SQ YD)	HOT-MIX ASP. SURF. REMOV. 1/2" (SQ YD)	TEMP RAMP (SQ YD)	POLY. HMA SUR. CSE., MIX D, N 90 (1 1/2") (TON)	LEVELING BINDER (MM) N90 (1") (TON)	BIT. MAT. (PRIME COAT) (GAL)	AGG. (PRIME COAT) (TON)	NOTES														
															FOR INFORMATIONAL PURPOSE ONLY													
FAP 331 (IL 13 WBL) - Sta. 99+20 to Sta. 513+64																												
Begin Ex. Bare Pcc Pavt.																												
	99+20.00	TO	100+42.45	122.45	24.0	4.0	2.0	327	200	13	28	19	58.8	1.0														
	100+42.42	TO	106+76.00	634	24.0	4.0	2.0	1690			143	96	304	5.1														
End of Bare PCC Pvt. / Begin Bit. Surfaced Pvt. - Sta. 106+76																												
	106+76.00	TO	477+37.00	37061	24.0	10.0	6.0	2.0	98829	222	98829	13	8345	5547	17789.3	296.5												
Omission S.N. 100-0068 - Sta. 477+37 to Sta. 479+45																												
	479+45.00	TO	513+64.00	3419	24.0	10.0	6.0	2.0	9117	222	9117	27	770	512	1641.1	27.4												
Ex. Turn Lanes and Crossovers																												
IL 166 RTL	99+66.00	TO	106+76.00	710	12.0	4.0	2.0	1048			89	59	188.6	3.1	Right Turn Ln.													
IL 166 LTL	99+83.00	TO	106+76.00	693	12.0		4.0	830			70	47	149.4	2.5	Left Turn Ln & Xover													
Stallhut Lane	121+00.00							362		362	31	21	65.2	1.1	Crossover only													
Median Crossover	135+40.00							362		362	31	21	65.2	1.1	Crossover only													
Davis Prairie Rd.	149+17.00	TO	154+52.00	535	12.0		4.0	786		786	67	44	141.5	2.4	Left Turn Ln & Xover													
Stilleys Mill Rd.	180+00.00	TO	185+35.00	535				413		413	55	37	74.3	1.2	Right Turn Ln.													
Stilleys Mill Rd.	180+20.00	TO	180+80.00	60				362		362	31	21	65.2	1.1	Crossover only													
W. Crab Orchard Rd.	203+70.00	TO	211+70.00	800	12.0		4.0	945		945	80	53	170.1	2.8	Right Turn Ln.													
Median Crossover	218+07.00							362		362	31	21	65.2	1.1	Crossover only													
Barbara Kay Rd.	239+70.00	TO	245+22.00	552	12.0		4.0	720		720	61	41	129.6	2.2	Left Turn Ln & Xover													
Paulton Rd.	264+50.00	TO	272+08.00	758	12.0	4.0		480		480	80	53	86.4	1.4	Right Turn Ln.													
Paulton Rd.	265+00.00	TO	271+00.00	600	12.0		4.0	735		735	62	41	132.3	2.2	Left Turn Ln & Xover													
E. Crab Orchard Rd.	295+25.00	TO	301+00.00	575	12.0		4.0	775		775	66	44	139.5	2.3	Right Turn Ln.													
Angelville Rd.	400+90.00	TO	406+00.00	510	12.0		4.0	735		735	62	41	132.3	2.2	Left Turn Ln & Xover													
Angelville Rd.	400+40.00	TO	406+78.00	638				480		480	80	53	86.4	1.4	Right Turn Ln.													
Jordan's Curve Rd.	498+35.00							318		318	27	18	57.2	1.0	Crossover only													
Jordan's Curve Rd.	498+35.00							147.0		147	13	8	26.5	0.4	SRL													
WESTBOUND MAINLINE LANE TOTALS									644	115,929	53	10222	6797	21541.7	359.1													

SIDE ROAD SCHEDULE

LOCATION	EXIST. SURFACE	WIDTH AT EDGE OF PAVT. (FT)	WIDTH AT 15' OFFSET (FT)	ROADWAY AREA (SQ YD)	HOT-MIX ASP. SURF. REMOV. - BUTT JT. (SQ YD)	TEMP RAMP (SQ YD)	INCIDENTAL HMA SURFACING (TON)	BIT. MAT. (PRIME COAT) (GAL)	AGG. (PRIME COAT) (TON)									
										FOR INFORMATIONAL PURPOSE ONLY								
IL 13 Eastbound Lanes																		
Rt.	Main St.	127+25	Pcc	100.0	68.0	133	133	11	12.0	0.20								
Rt.	Moeller Rd.	153+12	Pcc	45.0	31.0	64	64	5	5.8	0.10								
Rt.	Crabtree School Rd.	180+11	Pcc	130.0	53.0	139	139	12	12.5	0.21								
Rt.	IL 166 (South Lanes)	100+44	Pcc	147.0	30.0	512	333	43	46.1	0.77								
Rt.	Davis Prairie Rd.	154+03	Bit.	60.0	35.0	78	78	7	7.0	0.12								
Rt.	W. Crab Orchard Rd.	204+40	Bit.	110.0	86.0	167	167	14	15.0	0.25								
Rt.	Barbara Kay Rd.	239+95	Bit.	64.0	34.0	75	75	6	6.8	0.11								
Rt.	Paulton Rd.	265+34	Bit.	110.0	86.0	164	164	14	14.8	0.25								
Rt.	E. Crab Orchard Rd.	295+50	Bit.	110.0	86.0	167	167	14	15.0	0.25								
IL 13 Westbound Lanes																		
Lt.	IL 166 (North Lanes)	100+42	Pcc	151.0	36.0	520	346	20	44	0.78								
Lt.	Stilleys Mill Rd.	180+50	Bit.	90.0	37.0	106	106	9	9.5	0.16								
Lt.	Paulton Rd.	265+34	Bit.	110.0	89.0	166	166	14	14.9	0.25								
Lt.	Angelville Rd.	401+25	Bit.	133.0	82.0	179	179	15	16.1	0.27								
Lt.	Jordan's Curve Rd.	498+35	Bit.	114.0	62.0	147	147	12	13.2	0.2								
PROJECT TOTALS							2,264	37	220	236	3.9							

* AT LOCATIONS WHERE TURN LANES ARE PRIOR TO SIDE ROADS, THE INCIDENTAL HMA SURFACE COURSE WILL START 12' FROM MAINLINE EP TO 15' BK FROM EDGE OF TURN LANE. IF NO TURN LANE IS PRESENT, MEASURE FROM THE EX. EDGE OF PAVEMENT.

* (6-11RS-216-3.6-2.7-1.7-31RS-1

FILE NAME =	USER NAME = mcoor-dkr	DESIGNED -	REVISED -
ct:\pwork\p\11DOT\MCCORDKR\d0186822\78	09-shr-misc-dgn	DRAWN -	REVISED -
	PLOT SCALE = 1/8" = 100.0000' / IN.	CHECKED -	REVISED -
	PLOT DATE = 5/3/2010	DATE -	REVISED -

**STATE OF ILLINOIS
DEPARTMENT OF TRANSPORTATION**

**IL 13 WESTBOUND MAINLINE AND
SIDE ROAD RESURFACING SCHEDULE**

F.A.P. RTE. -	SECTION -	COUNTY -	TOTAL SHEETS -	SHEET NO. -
-331-	-	WILLIAMSON	30	12
CONTRACT NO. 78190			(ILLINOIS) FED. AID PROJECT	

SCALE: _____ SHEET NO. ___ OF ___ SHEETS STA. _____ TO STA. _____

IL 13 EASTBOUND SHOULDER RESURFACING SCHEDULE

LOCATION STATION TO STATION			LENGTH	BIT. SHOULDER WIDTH	AGG. WEDGE SHOULDER WIDTH	HMA SHLD. AREA	BIT. MAT. (PRIME COAT)	AGG. (PRIME COAT)	HMA SHOULDERS	AGG. WEDGE SHLDRS., TY. B	
											FOR INFORMATIONAL PURPOSE ONLY
			(FT)	(FT)	(FT)	(SQ YD)	(GAL)	(TON)	(TON)	(TON)	
FAP 331 (IL 13 EBL) - STA. 121+34 to STA. 341+00											
Lt.	121+34.00	TO	135+62.00	1356	4.0	2.0	603	54.2	0.9	85	43
Rt.	121+34.00	TO	135+62.00	1203	8.0	2.0	1069	96.2	1.6	150	39
Omit S. N. 100-0022 Sta. 135+62 to Sta. 136+70											
Lt.	136+70.00	TO	158+99.52	2171	4.0	2.0	965	86.8	1.4	136	69
Rt.	136+70.00	TO	158+99.52	2199	8.0	2.0	1954	175.9	2.9	274	70
Eq. Sta. 158+99.52 (bk.) = Sta. 158+82.63 (ch.)											
Lt.	158+82.63	TO	187+35.71	2795	4.0	2.0	1242	111.8	1.9	174	89
Rt.	158+82.63	TO	187+35.71	2777	8.0	2.0	2469	222.2	3.7	346	88
Eq. Sta. 187+35.71 (bk.) = Sta. 187+24.75 (ch.)											
Lt.	187+24.75	TO	207+07.46	1983	4.0	2.0	881	79.3	1.3	124	63
Rt.	187+24.75	TO	207+07.46	1983	8.0	2.0	1762	158.6	2.6	247	63
Eq. Sta. 207+07.46 (bk.) = Sta. 73+56.13 (ch.)											
Lt.	73+56.13	TO	95+39.00	2149	4.0	2.0	955	86.0	1.4	134	68
Lt.	95+39.00	TO	100+12.00	473	4.0	2.0	210	18.9	0.3	30	15
Rt.	73+56.13	TO	94+12.00	2056	8.0	2.0	1827	164.5	2.7	256	66
Rt.	94+12.00	TO	99+78.00	566	4.0	2.0	252	22.6	0.4	36	18
INTERSECTION IL 166 - Sta. 100+44 (EBL)											
Lt.	100+73.00	TO	107+90.00	717	4.0	2.0	319	28.7	0.5	45	23
Rt.	100+73.00	TO	107+90.00	717	8.0	2.0	637	57.4	1.0	90	23
End of Bare PCC Pvt./ Begin Bit. Surf. Pvt. - Sta. 107+90											
Lt.	107+90.00	TO	121+22.00	1332	6.0	2.0	888	79.9	1.3	100	34
Lt.	121+22.00	TO	135+18.00	1396	6.0	2.0	931	83.8	1.4	105	36
Lt.	135+18.00	TO	153+75.00	1857	6.0	2.0	1238	111.4	1.9	139	48
Lt.	154+30.00	TO	175+50.00	2120	6.0	2.0	1413	127.2	2.1	159	54
Rt.	107+90.00	TO	153+57.00	4567	10.0	2.0	5074	456.7	7.6	570	116
Rt.	154+45.00	TO	197+00.00	4255	10.0	2.0	4728	425.5	7.1	531	108
Lt.	175+50.00	TO	180+20.00	470	4.0	2.0	209	18.8	0.3	24	12
Rt.	197+00.00	TO	203+10.00	610	4.0	2.0	271	24.4	0.4	31	16
Lt.	180+80.00	TO	203+70.00	2290	6.0	2.0	1527	137.4	2.3	172	59
Lt.	204+30.00	TO	239+70.00	3540	6.0	2.0	2360	212.4	3.5	265	90
Rt.	204+90.00	TO	236+58.00	3168	10.0	2.0	3520	316.8	5.3	396	81
Rt.	236+58.00	TO	239+68.00	310	4.0	2.0	138	12.4	0.2	16	8
Lt.	240+45.00	TO	260+08.00	1963	6.0	2.0	1309	117.8	2.0	147	50
Rt.	240+50.00	TO	259+54.00	1904	10.0	2.0	2116	190.4	3.2	238	49
Lt.	260+08.00	TO	265+00.00	492	4.0	2.0	219	19.7	0.3	25	13
Rt.	259+54.00	TO	264+40.00	486	4.0	2.0	216	19.4	0.3	25	13
Lt.	265+55.00	TO	295+25.00	2970	6.0	2.0	1980	178.2	3.0	223	76
Rt.	266+23.00	TO	291+23.00	2500	10.0	2.0	2778	250.0	4.2	312	64
Rt.	291+23.00	TO	294+57.00	334	4.0	2.0	148	13.4	0.2	17	9
Lt.	295+81.00	TO	341+00.00	4519	6.0	2.0	3013	271.1	4.5	339	115
Rt.	296+44.00	TO	341+00.00	4456	10.0	2.0	4951	445.6	7.4	556	114
Project Ends EBL - Sta. 341+00											
IL 13 EBL TOTALS								4875	81.3	6517	1902

* (6-11RS-216-3.6-2.7-1.7-31RS-1

FILE NAME =	USER NAME = mcardkr	DESIGNED -	REVISED -	STATE OF ILLINOIS DEPARTMENT OF TRANSPORTATION	SCHEDULE - IL 13 EBL HMA AND AGGREGATE SHOULDERS	F.A.P. RTE.	SECTION	COUNTY	TOTAL SHEETS	SHEET NO.	
es:\pwwork\VPWIDOT\MCCORDKR\j0186822\sh	plnprf.dgn	DRAWN -	REVISED -			331	*	WILLIAMSON	27	13	
PLOT SCALE = 100.0000' / IN.	CHECKED -	REVISED -	REVISED -			CONTRACT NO. 78190					
PLOT DATE = 4/15/2010	DATE -	REVISED -	REVISED -			ILLINOIS FED. AID PROJECT					

IL 13 WESTBOUND SHOULDER RESURFACING SCHEDULE

LOCATION STATION TO STATION				LENGTH	BIT. SHOULDER WIDTH	AGG. SHOULDER WIDTH	HMA SHLD. AREA	BIT. MAT. (PRIME COAT)	AGG. (PRIME COAT)	HMA SHOULDERS	AGG. WEDGE SHLDRS., TY. B								
												FOR INFORMATIONAL PURPOSE ONLY							
												(FT)	(FT)	(FT)	(SQ YD)	(GAL)	(TON)	(TON)	(TON)
FAP 331 (IL 13 WBL) - STA. 99+20 TO STA. 513+64																			
Lt.	100+80.00	TO	106+76.00	596	4.0	2.0	265	23.8	0.4	38	19								
Rt.	100+80.00	TO	106+76.00	596	4.0	2.0	265	23.8	0.4	38	19								
End of Bare PCC Pvt./ Begin Bit. Surf. Pvt. - Sta. 106+76																			
Lt.	106+76.00	TO	180+06.00	7330	10.0	2.0	8144	733.0	12.2	915	186								
Rt.	106+76.00	TO	120+78.00	1402	6.0	2.0	935	84.1	1.4	105	36								
Lt.	181+00.00	TO	185+25.00	425	4.0	2.0	189	17.0	0.3	22	11								
Rt.	121+22.00	TO	135+18.00	1396	6.0	2.0	931	83.8	1.4	105	36								
Rt.	135+62.00	TO	153+75.00	1813	6.0	2.0	1209	108.8	1.8	136	46								
Rt.	154+30.00	TO	159+03.00	473	4.0	2.0	210	18.9	0.3	24	12								
Rt.	159+03.00	TO	180+20.00	2117	6.0	2.0	1411	127.0	2.1	159	54								
Rt.	180+80.00	TO	203+70.00	2290	6.0	2.0	1527	137.4	2.3	172	59								
Lt.	185+25.00	TO	264+50.00	7925	10.0	2.0	8806	792.5	13.2	989	201								
Rt.	204+30.00	TO	211+70.00	740	4.0	2.0	329	29.6	0.5	37	19								
Rt.	211+70.00	TO	217+85.00	615	6.0	2.0	410	36.9	0.6	47	16								
Rt.	218+29.00	TO	239+70.00	2141	6.0	2.0	1427	128.5	2.1	161	55								
Rt.	240+45.00	TO	245+22.00	477	4.0	2.0	212	19.1	0.3	24	13								
Rt.	245+22.00	TO	265+00.00	1978	6.0	2.0	1319	118.7	2.0	148	51								
Rt.	265+55.00	TO	271+00.00	545	4.0	2.0	242	21.8	0.4	28	14								
Lt.	266+10.00	TO	271+52.00	542	4.0	2.0	241	21.7	0.4	28	14								
Lt.	271+52.00	TO	400+40.00	12888	10.0	2.0	14320	1288.8	21.5	1608	327								
Rt.	271+00.00	TO	295+25.00	2425	6.0	2.0	1617	145.5	2.4	182	62								
Rt.	295+81.00	TO	301+00.00	519	4.0	2.0	231	20.8	0.3	26	14								
Rt.	301+00.00	TO	400+90.00	9990	6.0	2.0	6660	599.4	10.0	748	254								
Lt.	401+97.00	TO	406+78.00	481	4.0	2.0	214	19.2	0.3	24	13								
Rt.	401+55.00	TO	405+45.00	390	4.0	2.0	173	15.6	0.3	20	10								
Lt.	406+78.00	TO	477+37.00	7059	10.0	2.0	7843	705.9	11.8	881	180								
Rt.	405+45.00	TO	477+37.00	7192	6.0	2.0	4795	431.5	7.2	539	183								
SN 100-0068 Omission - Sta. 477+37 to Sta. 479+45																			
Lt.	479+45.00	TO	498+00.00	1855	10.0	2.0	2061	185.5	3.1	232	48								
Rt.	479+45.00	TO	498+00.00	1855	6.0	2.0	1237	111.3	1.9	139	48								
Lt.	498+90.00	TO	513+64.00	1474	10.0	2.0	1638	147.4	2.5	184	38.0								
Rt.	498+55.00	TO	513+64.00	1509	6.0	2.0	1006	90.5	1.5	113	39.0								
Project Ends WBL - Sta. 513+64																			
IL 13 WBL TOTALS								6288	104.8	7872	2077								

HMA AND AGGREGATE SHOULDER TOTALS

PAY ITEMS	BIT. MAT. (PRIME COAT)	AGG. (PRIME COAT)	HMA SHOULDERS	AGG. WEDGE SHLDRS., TY. B
	(GAL)	(TON)	(TON)	(TON)
SHOULDER TOTALS	11,163	186.1	14,389	3,979

* (6-11RS-216-3.6-2.7-1.7-31RS-1

FILE NAME *	USER NAME = mccordkr	DESIGNED -	REVISED -	STATE OF ILLINOIS DEPARTMENT OF TRANSPORTATION	----- SCHEDULE -- IL 13 WBL ----- HMA AND AGGREGATE SHOULDERS	F.A.P. RTE.	SECTION	COUNTY	TOTAL SHEETS	SHEET NO.	
ca:\pw\work\PWIDOT\MCCORDKR\0186822\sh	plnprf.dgn	DRAWN -	REVISED -			.331	*	WILLIAMSON	21	14	
PLOT SCALE = 1/8" = 100.0000' / IN.	CHECKED -	REVISED -	REVISED -			CONTRACT NO. 78190					
PLOT DATE = 4/15/2010	DATE -	REVISED -	REVISED -			ILLINOIS FED. AID PROJECT					

IL 13 EASTBOUND PAVEMENT MARKING SCHEDULE

STATION TO STATION				PERFORMED PLASTIC PAVEMENT MARKING, TY. B					TEMPORARY PAVEMENT MARKING				SHORT-TERM	NOTES	
				LEFT 4 INCH YELLOW (EDGE LINE)	RIGHT 4 INCH WHITE (EDGE LINE)	4 INCH WHITE (TURN LANE)	5 INCH (SKIP-DASH)	24 INCH (STOP BAR)	LETTERS AND SYMBOLS	4 INCH	5 INCH	24 INCH	LETTERS AND SYMBOLS		5 INCH
				FOOT		FOOT	FOOT	FOOT	SO FT	FOOT	FOOT	FOOT	SO FT		FOOT
IL 13 EBL MAINLINE: Sta. 121+34 to Sta. 341+00															
LT	121+34.0	TO	126+95.0	561											
RT	121+34.0	TO	126+33.0		499								20	DIAGONALS ON SHLD. (SEE NOTE 1)	
LT	124+00.0	TO	126+95.0			295							35	LTL @ MAIN ST. ONLY	
LT	124+10.0									20.8			20.8		
LT	124+38.0									15.6			15.6	LEFT TURN ARROW	
	121+34.0	TO	127+25.0				148				148		71		
Main St. Intersection - Sta. 127+25															
LT	127+75.0	TO	135+62.0	787											
RT	127+50.0	TO	128+56.0		106									ISLAND	
RT	128+56.0	TO	135+62.0		706								28	ENT. RAMP TO IL 13 & DIAG. ON SHLD	
	127+25.0	TO	135+62.0				209				209		100		
SN 100-0022 Omission - Sta. 135+62 to Sta. 136+70															
LT	136+70.0	TO	152+98.0	1628							1,628				
LT	149+92.0	TO	152+98.0			306					306		37	LTL @ MOELLER RD. ONLY	
LT	150+02.0									20.8			20.8		
LT	150+30.0									15.6			15.6	LEFT TURN ARROW	
RT	136+70.0	TO	158+99.5		2230						2,230		89	DIAGONALS ON SHLD. (SEE NOTE 1)	
RT	153+27.0							15				15			
	136+70.0	TO	158+99.5				557				557		268		
Eq. Sta. 158+99.52 (bk.) = Sta. 158+82.63 (ch.)															
LT	158+82.6	TO	179+71.0	2088							2,088				
LT	176+77.0	TO	179+71.0			294					294		35	LTL @ CRABTREE SCH. RD. ONLY	
LT	176+87.0									20.8			20.8		
LT	177+15.0									15.6			15.6	LEFT TURN ARROW	
RT	158+82.6	TO	179+30.0		2047						2,047		82	DIAGONALS ON SHLD. (SEE NOTE 1)	
RT	180+11.0							15				15			
	158+82.6	TO	187+35.7				713				713		342		
Eq. Sta. 187+35.71 (bk.) = Sta. 187+24.75 (ch.)															
LT	187+24.8	TO	207+07.5	1983							1,983				
RT	187+24.8	TO	207+07.5		1983						1,983		79	DIAGONALS ON SHLD. (SEE NOTE 1)	
	187+24.8	TO	207+07.5				496				496		238		
Eq. Sta. 207+07.46 (bk.) = Sta. 73+56.13 (ch.)															
LT	73+56.1	TO	99+39.0	2583							2,583				
RT	73+56.1	TO	99+78.0		2622						2,622		105	DIAGONALS ON SHLD. (SEE NOTE 1)	
LT	97+41.0	TO	100+14.0			273					273		33	LTL @ IL 166 ONLY	
LT	98+04.0									20.8			20.8		
LT	98+32.0									15.6			15.6	LEFT TURN ARROW	
LT	100+14.0							12				12		LTL STOP BAR	
LT	100+00.0	TO	100+14.0			52					52			LEFT PAINTED ISLAND	
	100+14.0											28		THRU LANE STOP BAR	
RT	99+82.0	TO	100+14.0			130					130			RIGHT PAINTED ISLAND	
RT	100+14.0											16		RTL STOP BAR	
RT	96+82.0	TO	99+82.0			300					300		36	RTL @ IL 166 ONLY	
RT	96+92.0									20.8			20.8		
RT	97+20.0									15.6			15.6	RIGHT TURN ARROW	
	73+56.1	TO	100+14.0				664				664		319		
Intersection of IL 166 - Sta. 100+44															

NOTE 1: QUANTITY UNDER SHORT-TERM PAVEMENT MARKING.

* 16-URS-216-3.6-2.7-1.7-3RS-1

FILE NAME =	USER NAME = macordkr	DESIGNED -	REVISED -	STATE OF ILLINOIS DEPARTMENT OF TRANSPORTATION	SCHEDULE - IL 13 WBL HMA AND AGGREGATE SHOULDERS	F.A.P. RTE.	SECTION	COUNTY	TOTAL SHEETS	SHEET NO.	
c:\pwork\pwork\macordkr\d0186822\shht	plnpr.f.dgn	DRAWN -	REVISED -			.331	*	WILLIAMSON	27	15	
	PLOT SCALE = 100.0000' / IN.	CHECKED -	REVISED -			CONTRACT NO. 78190		ILLINOIS FED. AID PROJECT			
	PLOT DATE = 4/15/2010	DATE -	REVISED -			SCALE: _____	SHEET NO. _____ OF _____ SHEETS	STA. _____ TO STA. _____			

IL 13 EASTBOUND PAVEMENT MARKING SCHEDULE

(CONTINUED)

STATION TO STATION				PREFORMED PLASTIC PAVEMENT MARKING, TY. B					TEMPORARY PAVEMENT MARKING				SHORT-TERM	NOTES	
				LEFT 4 INCH YELLOW (EDGE LINE)	RIGHT 4 INCH WHITE (EDGE LINE)	4 INCH WHITE (TURN LANE)	5 INCH (SKIP-DASH)	24 INCH (STOP BAR)	LETTERS AND SYMBOLS	4 INCH	5 INCH	24 INCH	LETTERS AND SYMBOLS		5 INCH
				FOOT		FOOT	FOOT	FOOT	SO FT	FOOT	FOOT	FOOT	SO FT		FOOT
Intersection of IL 166 - Sta. 100+44															
	100+44.0	TO	341+00.0				6,014			6,014			2,887		
RT	100+44.0							12			12			STOP BAR	
RT	100+74.0							20			20			RTL STOP BAR	
LT	100+73.0	TO	153+75.0	5302					5,302				212	DIAGONALS ON SHLD. (SEE NOTE 1)	
RT	101+45.0	TO	157+57.0		5612				5,612				200	DIAGONALS ON SHLD. (SEE NOTE 1)	
RT	151+47.0	TO	157+57.0			610			610				73	RTL @ DAVIS PRAIRIE RD.	
RT	151+57.0							20.8			20.8			ONLY	
RT	151+85.0							15.6			15.6			RIGHT TURN ARROW	
RT	154+02.0									12					
LT	154+70.0	TO	180+20.0	2550					2,550				102	DIAGONALS ON SHLD. (SEE NOTE 1)	
RT	154+51.0	TO	203+10.0		4,859				4,859				185	DIAGONALS ON SHLD. (SEE NOTE 1)	
LT	177+80.0	TO	180+20.0			240			240				29	LTL @ STILLEY'S MILL RD.	
LT	177+90.0							20.8			20.8			ONLY	
LT	178+18.0							15.6			15.6			LEFT TURN ARROW	
LT	181+80.0	TO	203+24.0	2,144					2,144				86	DIAGONALS ON SHLD. (SEE NOTE 1)	
RT	199+97.0	TO	203+24.0			327			327				39	RTL @ W. CRAB ORCHARD RD.	
RT	200+00.0							20.8			20.8			ONLY	
RT	200+28.0							15.6			15.6			RIGHT TURN ARROW	
RT	204+00.0									12					
RT	204+30.0							20			20				
LT	204+70.0	TO	239+34.0	3,464					3,464				139	DIAGONALS ON SHLD. (SEE NOTE 1)	
RT	205+44.0	TO	239+78.0		3,434				3,434				129	DIAGONALS ON SHLD. (SEE NOTE 1)	
RT	237+73.0	TO	239+95.0			222			222				27	RTL @ BARBARA KAY RD.	
RT	237+83.0							20.8			20.8			ONLY	
RT	238+11.0							15.6			15.6			RIGHT TURN ARROW	
RT	240+00.0									27					
LT	240+97.0	TO	264+58.0	2,361					2,361				94	DIAGONALS ON SHLD. (SEE NOTE 1)	
RT	239+97.0	TO	264+30.0		2,433				2,433				82	DIAGONALS ON SHLD. (SEE NOTE 1)	
RT	261+04.0	TO	265+00.0			396			396				48	RTL @ PAULTON RD.	
RT	261+14.0							20.8			20.8			ONLY	
RT	261+42.0							15.6			15.6			RIGHT TURN ARROW	
LT	261+58.0	TO	265+00.0			342			342				41	LTL @ PAULTON RD.	
LT	261+68.0							20.8			20.8			ONLY	
LT	261+96.0							15.6			15.6			LEFT TURN ARROW	
RT	265+34.0									12					
RT	265+63.0							22			22				
LT	266+00.0	TO	294+75.0	2,875					2,875				115	DIAGONALS ON SHLD. (SEE NOTE 1)	
RT	266+80.0	TO	294+57.0		2,777				2,777				100	DIAGONALS ON SHLD. (SEE NOTE 1)	
RT	292+38.0	TO	295+30.0			292			292				35	RTL @ E. CRAB ORCHARD RD.	
RT	292+48.0							20.8			20.8			ONLY	
RT	292+76.0							15.6			15.6			RIGHT TURN ARROW	
RT	295+50.0									12					
RT	295+90.0							22			22				
LT	296+25.0	TO	341+00.0	4,475					4,475				179	DIAGONALS ON SHLD. (SEE NOTE 1)	
RT	296+44.0	TO	341+00.0		4,456				4,456				178	DIAGONALS ON SHLD. (SEE NOTE 1)	
SUBTOTALS				32,801	33,763	4079	8802	257	436.8	70,643	8,802	257	436.8	6,897	
IL 13 EBL TOTALS				70,643			8802	257	436.8	70,643	8,802	257	436.8	6,897	

NOTE 1: QUANTITY UNDER SHORT-TERM PAVEMENT MARKING.

* (6-1)RS-216-3,6-2,7-1,7-3)RS-1

FILE NAME #	USER NAME # macardkr	DESIGNED -	REVISED -	STATE OF ILLINOIS DEPARTMENT OF TRANSPORTATION	SCHEDULE - IL 13 WBL HMA AND AGGREGATE SHOULDERS	F.A.P. RTE. #	SECTION	COUNTY	TOTAL SHEETS	SHEET NO.
al\pv_work\pawdot\macardkr\d0186822\sh	plnpr.f.dgn	DRAWN -	REVISED -			331		WILLIAMSON	27	16
PLOT SCALE = 100.0000' / IN.		CHECKED -	REVISED -			CONTRACT NO. 78190				
PLOT DATE = 4/15/2018		DATE -	REVISED -			ILLINOIS FED. AID PROJECT				
SCALE: _____ SHEET NO. _____ OF _____ SHEETS STA. _____ TO STA. _____										

IL 13 WESTBOUND PAVEMENT MARKING SCHEDULE

STATION TO STATION				PERFORMED PLASTIC PAVEMENT MARKING, TY. B						TEMPORARY PAVEMENT MARKING				SHORT-TERM	NOTES
				LEFT 4 INCH WHITE (EDGE LINE)	RIGHT 4 INCH YELLOW (EDGE LINE)	4 INCH WHITE (TURN LANE)	5 INCH (SKIP-DASH)	24 INCH (STOP BAR)	LETTERS AND SYMBOLS	4 INCH	5 INCH	24 INCH	LETTERS AND SYMBOLS	5 INCH	
				FOOT		FOOT	FOOT	FOOT	SO FT	FOOT	FOOT	FOOT	SO FT	FOOT	
IL 13 WBL MAINLINE: Sta. 99+20 to Sta. 513+64															
LT	99+20.0	TO	99+30.0	10								10			
RT	99+20.0	TO	99+86.0		66							66		4	DIAGONALS ON SHLD. (NOTE 1)
LT	100+00.0							22							
LT	100+22.0							12							
LT	101+01.0	TO	180+00.0	7899								7899		316	DIAGONALS ON SHLD. (NOTE 1)
LT	101+61.0							12							RTL STOP BAR
LT	100+61.0	TO	101+01.0		130							130		12	LEFT PAINTED ISLAND
LT	101+01.0	TO	103+89.0		288							288		35	RTL @ IL 166
LT	103+43.0										15.6			15.6	RIGHT TURN ARROW
LT	103+71.0										20.8			20.8	ONLY
	100+61.0							28						28	THRU LANE STOP BAR
	99+20.0	TO	477+37.0				9454						9454		4538
RT	100+61.0							12						12	LTL STOP BAR
RT	100+61.0	TO	100+93.0		52							52		4	RIGHT PAINTED ISLAND
RT	100+93.0	TO	103+96.0		303							303		36	LTL @ IL 166
RT	103+50.0										15.6			15.6	LEFT TURN ARROW
RT	103+78.0										20.8			20.8	ONLY
RT	100+93.0	TO	153+28.0		5235							5,235		209	DIAGONALS ON SHLD. (NOTE 1)
RT	154+70.0	TO	156+73.0		203							203		24	LTL @ DAVIS PRAIRIE RD.
RT	156+27.0										15.6			15.6	LEFT TURN ARROW
RT	156+55.0										20.8			20.8	ONLY
RT	154+70.0	TO	179+75.0		2505							2,505		100	DIAGONALS ON SHLD. (NOTE 1)
LT	180+50.0							22						22	
LT	181+00.0	TO	264+50.0	8,350								8,350		334	DIAGONALS ON SHLD. (NOTE 1)
LT	181+00.0	TO	183+05.0		205							205		25	RTL @ STILLEY'S MILL RD.
LT	182+59.0										15.6			15.6	RIGHT TURN ARROW
LT	182+87.0										20.8			20.8	ONLY
RT	181+25.0	TO	203+26.0		2201							2,201		88	DIAGONALS ON SHLD. (NOTE 1)
RT	204+30.0	TO	207+73.0		343							343		41	LTL @ W. CRAB ORCHARD RD.
RT	207+27.0										15.6			15.6	LEFT TURN ARROW
RT	207+55.0										20.8			20.8	ONLY
RT	204+77.0	TO	239+16.0		3439							3,439		138	DIAGONALS ON SHLD. (NOTE 1)
RT	240+40.0	TO	242+92.0		252							252		30	LTL @ BARBARA KAY RD.
RT	242+44.0										15.6			15.6	LEFT TURN ARROW
RT	242+72.0										20.8			20.8	ONLY
RT	240+45.0	TO	264+70.0		2425							2,425		97	DIAGONALS ON SHLD. (NOTE 1)
LT	264+90.0							22						22	
LT	265+33.0							12						12	
LT	265+60.0	TO	269+48.0		388							388		47	RTL @ PAULTON RD.
LT	269+02.0										15.6			15.6	RIGHT TURN ARROW
LT	269+30.0										20.8			20.8	ONLY
LT	266+10.0	TO	400+40.0	13430								13,430		537	DIAGONALS ON SHLD. (NOTE 1)

NOTE 1: QUANTITY UNDER SHORT-TERM PAVEMENT MARKING.

* (6-1)RS-216-3,6-2,7-1,7-3IRS-1

FILE NAME =	USER NAME = mcoordkr	DESIGNED -	REVISD -	STATE OF ILLINOIS DEPARTMENT OF TRANSPORTATION	SCHEDULE - IL 13 WBL HMA AND AGGREGATE SHOULDERS	F.A.R. RTE.	SECTION	COUNTY	TOTAL SHEETS	SHEET NO.
ca:\pw\work\VPWIDOT\MCCORDKR\08186822\shp\lprf.dgn	PLOT SCALE = 100.0000' / IN.	DRAWN -	REVISD -			.331	*	WILLIAMSON	.27	.17
PLOT DATE = 4/15/2018	DATE	CHECKED -	REVISD -			SCALE: SHEET NO. OF SHEETS STA. TO STA.		ILLINOIS FED. AID PROJECT		
								CONTRACT NO. 78190		

IL 13 WESTBOUND PAVEMENT MARKING SCHEDULE

(CONTINUED)

STATION TO STATION				PERFORMED PLASTIC PAVEMENT MARKING, TY. B					TEMPORARY PAVEMENT MARKING				SHORT-TERM	NOTES	
				LEFT 4 INCH WHITE (EDGE LINE)	RIGHT 4 INCH YELLOW (EDGE LINE)	4 INCH WHITE (TURN LANE)	5 INCH (SKIP-DASH)	24 INCH (STOP BAR)	LETTERS AND SYMBOLS	4 INCH	5 INCH	24 INCH	LETTERS AND SYMBOLS		5 INCH
				FOOT		FOOT	FOOT	FOOT	SO FT	FOOT	FOOT	FOOT	SO FT		FOOT
IL 13 WBL MAINLINE: Sta. 99+20 to Sta. 513+64															
LT	400+90.0									22					
LT	401+25.0									12					
LT	401+52.0	TO	404+33.0			281									
LT	400+87.0							15.6				15.6		34	
LT	401+15.0							20.8				20.8		RTL @ ANGELVILLE RD. RIGHT TURN ARROW ONLY	
LT	401+97.0	TO	477+37.0	7540					7,540					302	
RT	401+55.0	TO	403+95.0			240			240					29	
RT	403+49.0							15.6				15.6		LTL @ ANGELVILLE RD. LEFT TURN ARROW ONLY	
RT	403+77.0							20.8				20.8			
RT	401+55.0	TO	477+37.0			7582			7,582					303	
														DIAGONALS ON SHLD. (NOTE 1)	
SN 100-0068 Omission - Sta. 477+37 to Sta. 479+45															
LT	479+45.0	TO	498+00.0	1855					1,855					74	
RT	479+45.0	TO	497+65.0			1820			1,820					73	
LT	498+34.0									22					
LT	498+90.0	TO	513+64.0	1474					1,474					59	
RT	498+55.0	TO	513+64.0			1509			1,509					60	
	479+45.0	TO	513+64.0					855		855				274	
SUBTOTALS															
				40,558	40,171	3278	10,309	198	400.4	84,007	10,309	198	400.4	8,429	
IL 13 WBL TOTALS					84,007		10,309	198	400.4	84,007	10,309	198	400.4	8,429	

NOTE 1: QUANTITY UNDER SHORT-TERM PAVEMENT MARKING.

*16-11RS-216-3.6-2.7-1.7-31RS-1

NOT TO SCALE

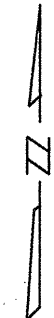
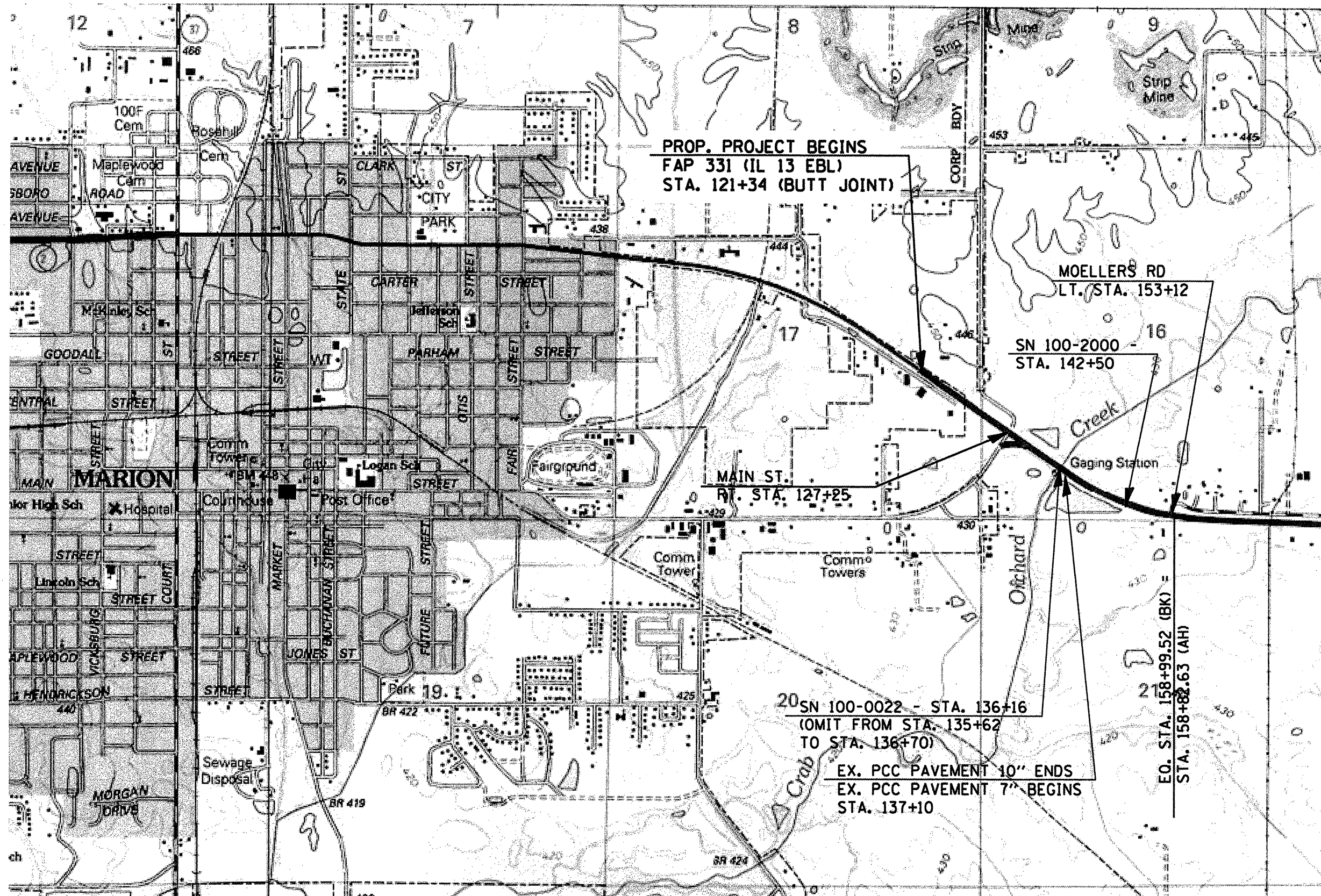

16-URS-216-3.6-2.7-1.7-3RS-1

FILE NAME =	USER NAME = mccordk	DESIGNED -	REVISED -
ca:\pwwork\PMIDOT\MCCORDK\16186822\7810-shc-plan.dgn		DRAWN -	REVISED -
PLOT SCALE = 200.0000' / IN.		CHECKED -	REVISED -
PLOT DATE = 4/27/2010		DATE -	REVISED -

**STATE OF ILLINOIS
DEPARTMENT OF TRANSPORTATION**

----- **PLAN LAYOUT** -----

SCALE: _____ SHEET NO. ____ OF _____ SHEETS STA. 121+34 TO STA. 170+00

F.A.P. RTE. -	SECTION	COUNTY	TOTAL SHEETS	SHEET NO.
331		WILLIAMSON	30	19
CONTRACT NO. 78190			ILLINOIS FED. AID PROJECT	

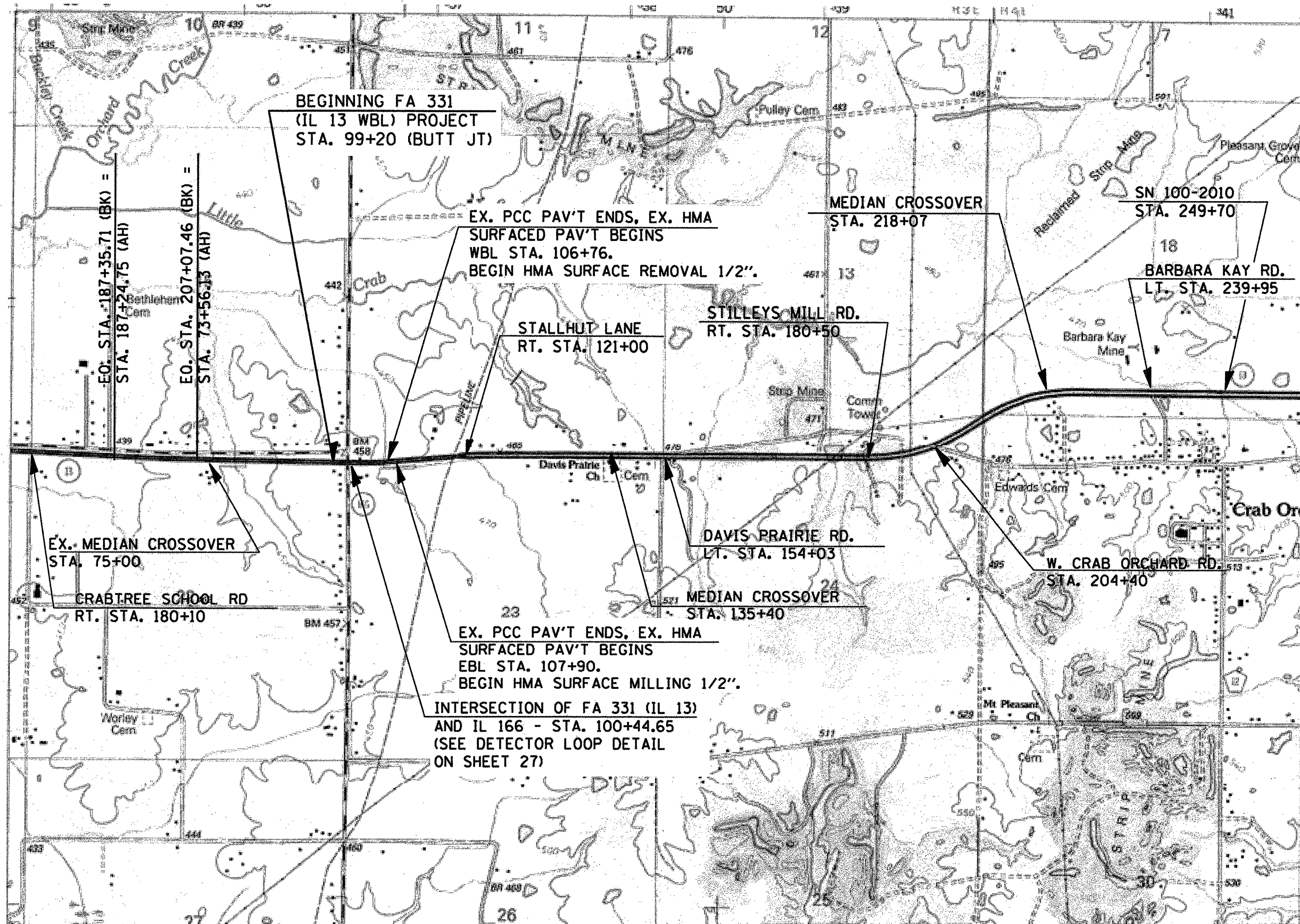

N

NOT TO SCALE

(6-1)RS-2(6-3,6-2,7-1,7-3)RS-1

FILE NAME =	USER NAME = mcoordkr	DESIGNED -	REVISED -
at:\p\work\PIWIDOT\MCCORDKR\0186822178	99-shr-pln.dgn	DRAWN -	REVISED -
	PLOT SCALE = 200.0000 "/> <td>CHECKED -</td> <td>REVISED -</td>	CHECKED -	REVISED -
	PLOT DATE = 5/5/2010	DATE -	REVISED -

STATE OF ILLINOIS
DEPARTMENT OF TRANSPORTATION

----- **PLAN LAYOUT** -----

SCALE: SHEET NO. OF SHEETS STA. 170+00 TO STA. 257+00

F.A.P. RTE.	SECTION	COUNTY	TOTAL SHEETS	SHEET NO.
331		WILLIAMSON	30	20
CONTRACT NO. 78190				
ILLINOIS FED. AID PROJECT				

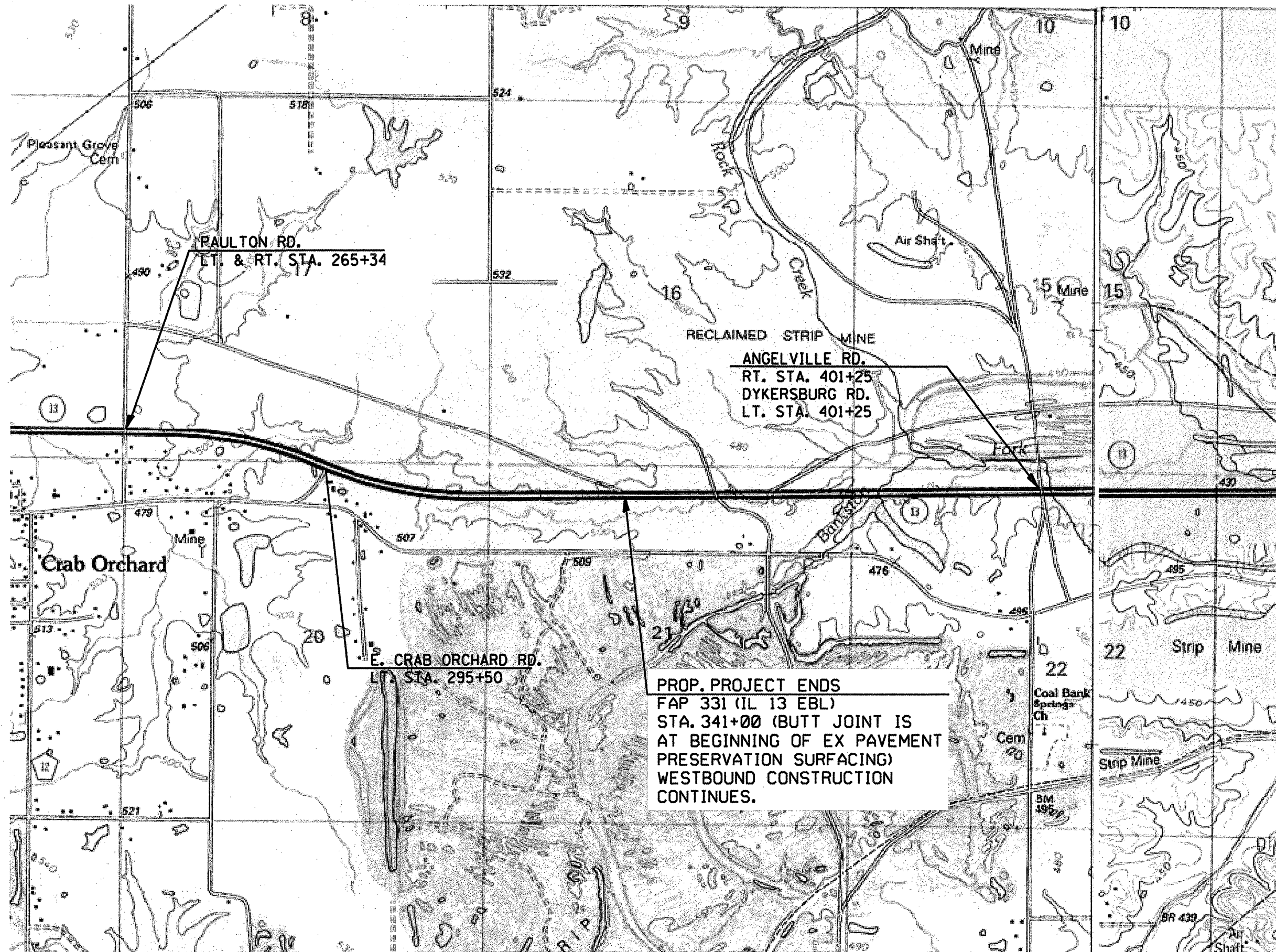

NOT TO SCALE

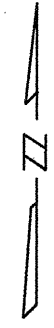

PROP. PROJECT ENDS
 FAP 331 (IL 13 EBL)
 STA. 341+00 (BUTT JOINT IS
 AT BEGINNING OF EX PAVEMENT
 PRESERVATION SURFACING)
 WESTBOUND CONSTRUCTION
 CONTINUES.

6-11RS-216-3.6-2.7-1.7-31RS-1

FILE NAME =
 G:\pwork\PIWIDOT\MCCORDR\816622\78

USER NAME = mcoordr
 10-shc-pln.dgn
 PLOT SCALE = 200.0000 "/> IN.
 PLOT DATE = 4/27/2010

DESIGNED -	---	REVISED -	-----
DRAWN -	---	REVISED -	-----
CHECKED -	---	REVISED -	-----
DATE -	-----	REVISED -	-----

**STATE OF ILLINOIS
 DEPARTMENT OF TRANSPORTATION**

----- **PLAN LAYOUT** -----

SCALE: _____ SHEET NO. _____ OF _____ SHEETS STA. 257+00 TO STA. 427+65

F.A.P. RTE.	SECTION	COUNTY	TOTAL SHEETS	SHEET NO.
331		WILLIAMSON	30	21
CONTRACT NO. 78190			ILLINOIS FED. AID PROJECT	

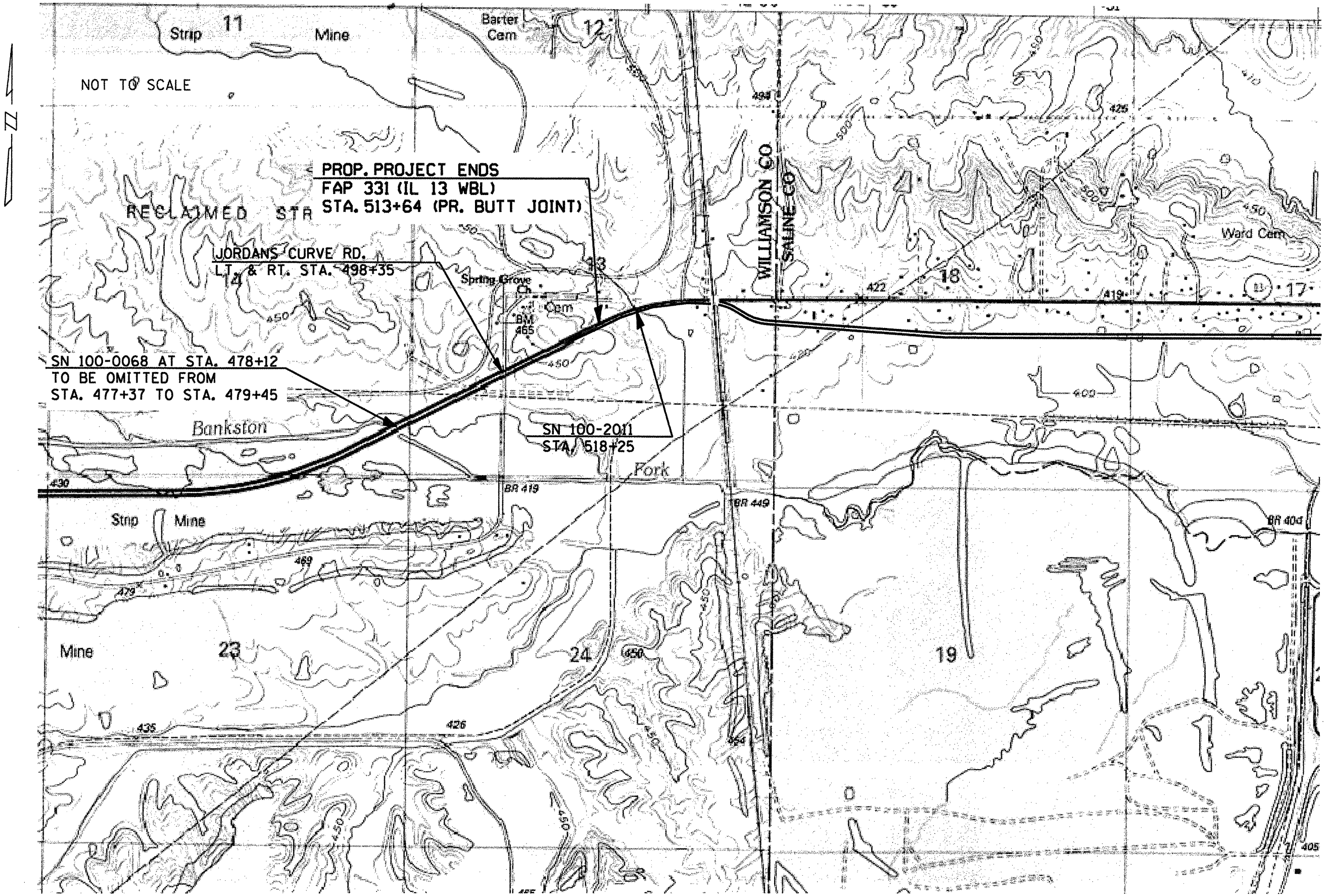

NOT TO SCALE

PROP. PROJECT ENDS
FAP 331 (IL 13 WBL)
STA. 513+64 (PR. BUTT JOINT)

JORDANS CURVE RD.
LT. & RT. STA. 498+35

SN 100-0068 AT STA. 478+12
TO BE OMITTED FROM
STA. 477+37 TO STA. 479+45

SN 100-201
STA. 518+25

FILE NAME =	USER NAME = mccordkr	DESIGNED -	REVISED -
at:\p\work\PWIDOT\MCCORDKR\08186822\78	10-sht-plan.dgn	DRAWN -	REVISED -
	PLOT SCALE = 200.0000 "/> IN.	CHECKED -	REVISED -
	PLOT DATE = 4/27/2010	DATE -	REVISED -

STATE OF ILLINOIS
DEPARTMENT OF TRANSPORTATION

----- PLAN LAYOUT -----			
SCALE:	SHEET NO. OF SHEETS	STA. 427+65 TO STA. 513+64	

(6-1)RS-216-3,6-2,7-1,7-3)RS-1				
F.A.P. RTE.	SECTION	COUNTY	TOTAL SHEETS	SHEET NO.
331		WILLIAMSON	30	22
CONTRACT NO. 70190			ILLINOIS FED. AID PROJECT	

PROP. BUTT JOINT
DETAIL

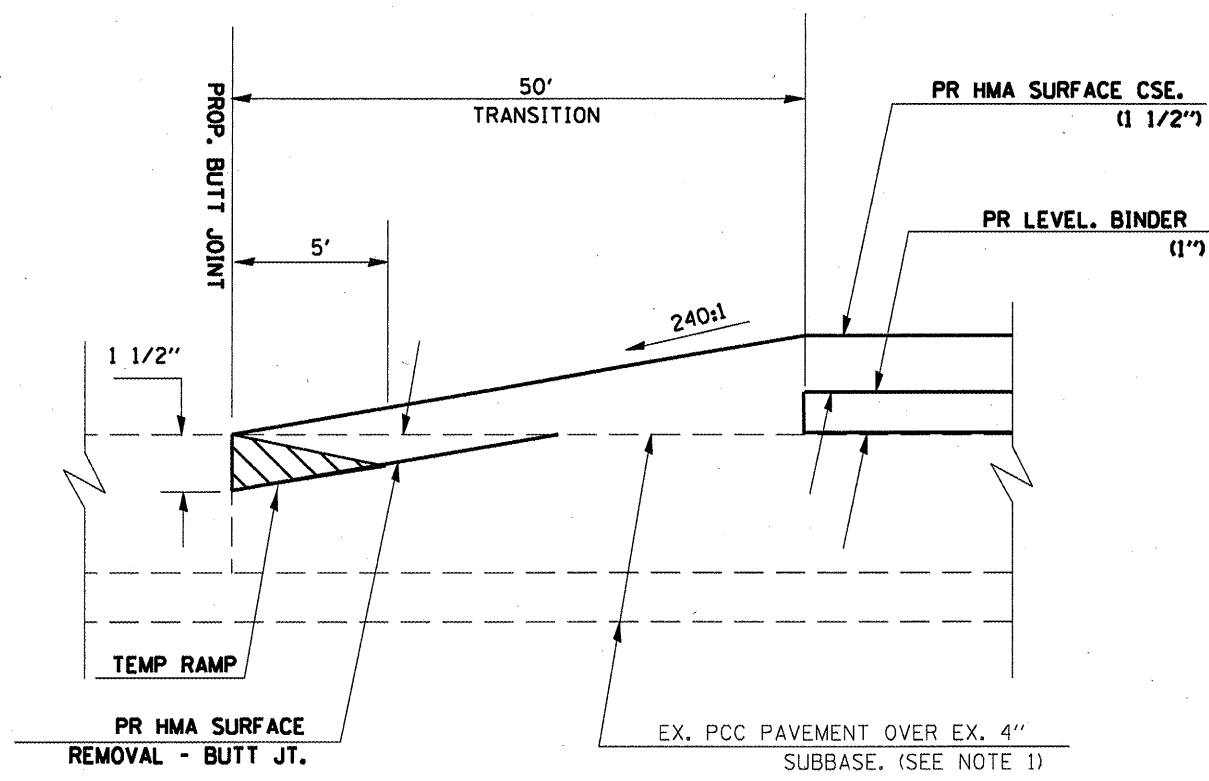

TO BE USED:
 STA. 121+34 (BEGINNING OF PROJECT EBL)
 STA. 99+20 (BEGINNING OF PROJECT WBL)
 STA. 135+62 (WEST ABUT. SN 100-0022)
 STA. 136+70 (EAST ABUT. SN 100-0022)

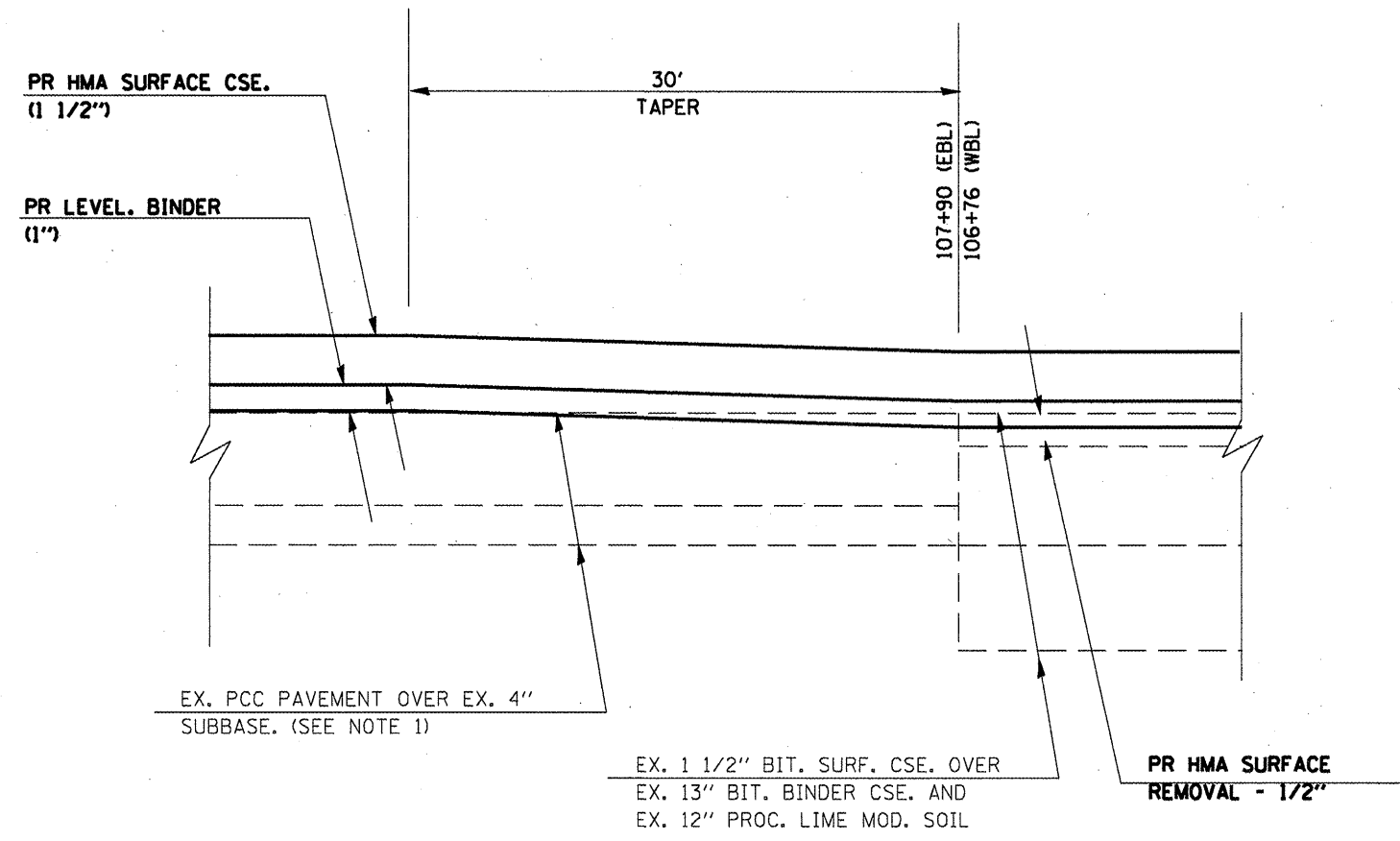

TO BE USED:
 STA. 107+60 TO STA. 107+90 (EBL)
 STA. 106+46 TO STA. 106+76 (WBL)

* (6-1)RS-2(6-3,6-2,7-1,7-3)RS-1

FILE NAME =	USER NAME = mcardkr	DESIGNED -	REVISD -	STATE OF ILLINOIS DEPARTMENT OF TRANSPORTATION	DETAIL - BEGINNING OF PROJECT BUTT JOINT AND TRANSITION ARE	F.A.P. RTE.	SECTION	COUNTY	TOTAL SHEETS	SHEET NO.	
c:\pw_work\PW1001\MCCORDKR\d0186822\78	90-shr-plan.dgn	DRAWN -	REVISD -			.331		WILLIAMSON	.30	.23	
	PLOT SCALE = 200.0000' / IN.	CHECKED -	REVISD -			CONTRACT NO. 78190					
	PLOT DATE = 4/27/2010	DATE -	REVISD -			ILLINOIS FED. AID PROJECT					

PROP. BUTT JOINT
DETAIL

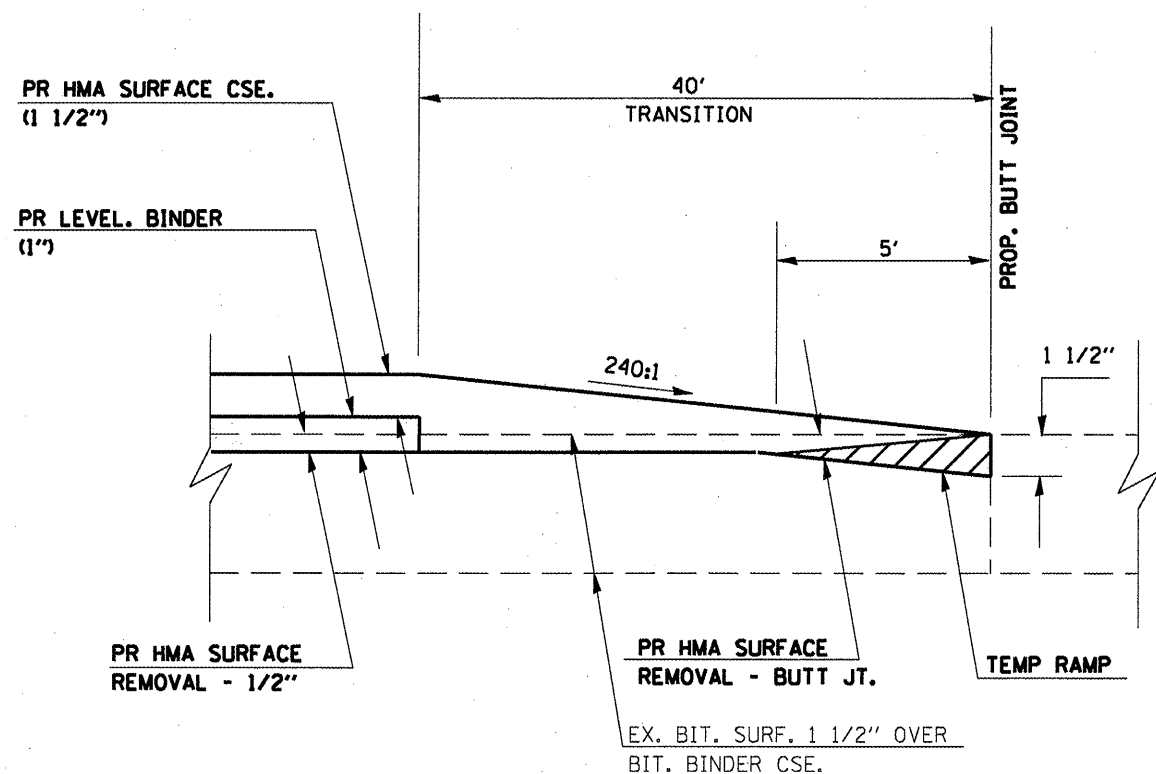

TO BE USED:
 WBL STA. 513+64 (END OF PROJECT WBL)
 WBL STA. 477+36 (WEST APPROACH SN 100-0068)
 WBL STA. 479+45 (EAST APPROACH SN 100-0068)
 EBL STA. 341+00 (END OF PROJECT EBL)

* (6-1)RS-2(6-3,6-2,7-1,7-3)RS-1

FILE NAME =
 c:\pwork\pwidot\mccordkr\d8186822\78

USER NAME = mccordkr
 98-shs-plendgn
 PLOT SCALE = 200.0000 / IN.
 PLOT DATE = 4/27/2010

DESIGNED -	---	REVISED -	-----
DRAWN -	---	REVISED -	-----
CHECKED -	---	REVISED -	-----
DATE -	-----	REVISED -	-----

STATE OF ILLINOIS
 DEPARTMENT OF TRANSPORTATION

-----DETAIL-- END OF PROJECT--
BUTT JOINT

 SCALE: _____ SHEET NO. ____ OF ____ SHEETS STA. _____ TO STA. _____

F.A.P. RTE.	SECTION	COUNTY	TOTAL SHEETS	SHEET NO.
331	6	WILLIAMSON	30	24
CONTRACT NO. 78190				
ILLINOIS FED. AID PROJECT				

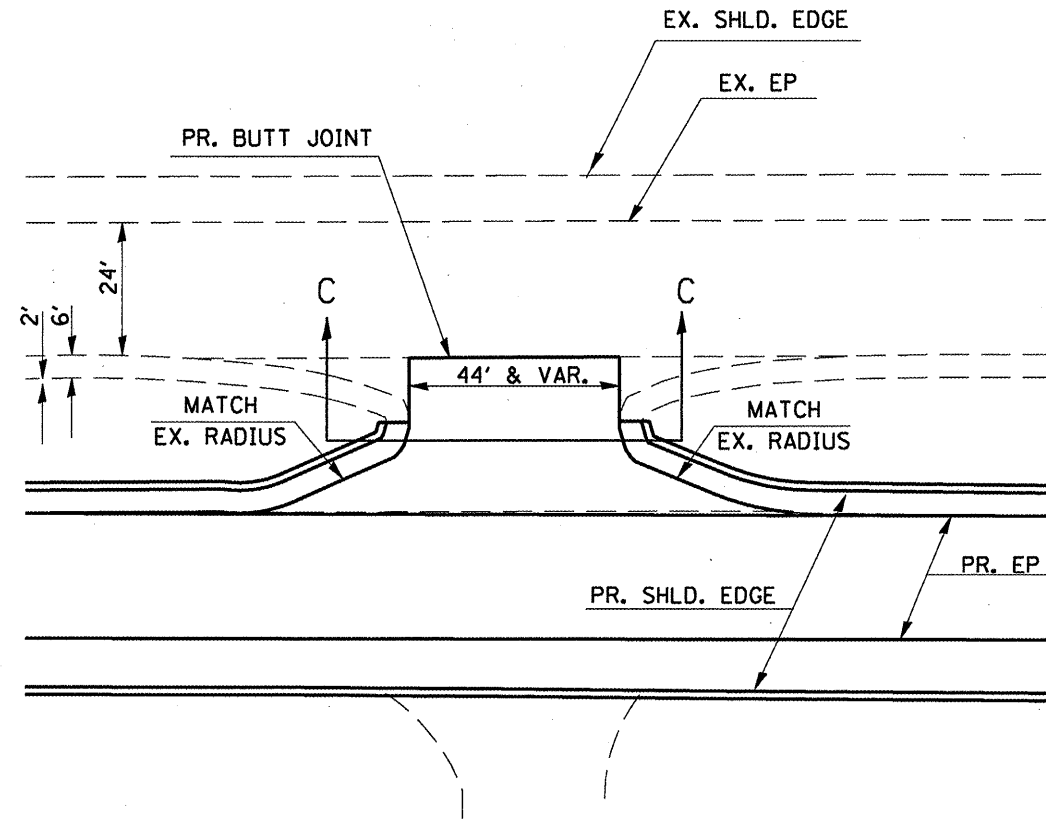

DETAIL FOR
 MEDIAN CROSSOVER
 WEST OF IL 166 INTERSECTION
 (SEE TYPICAL SECTION, SHT. 10)

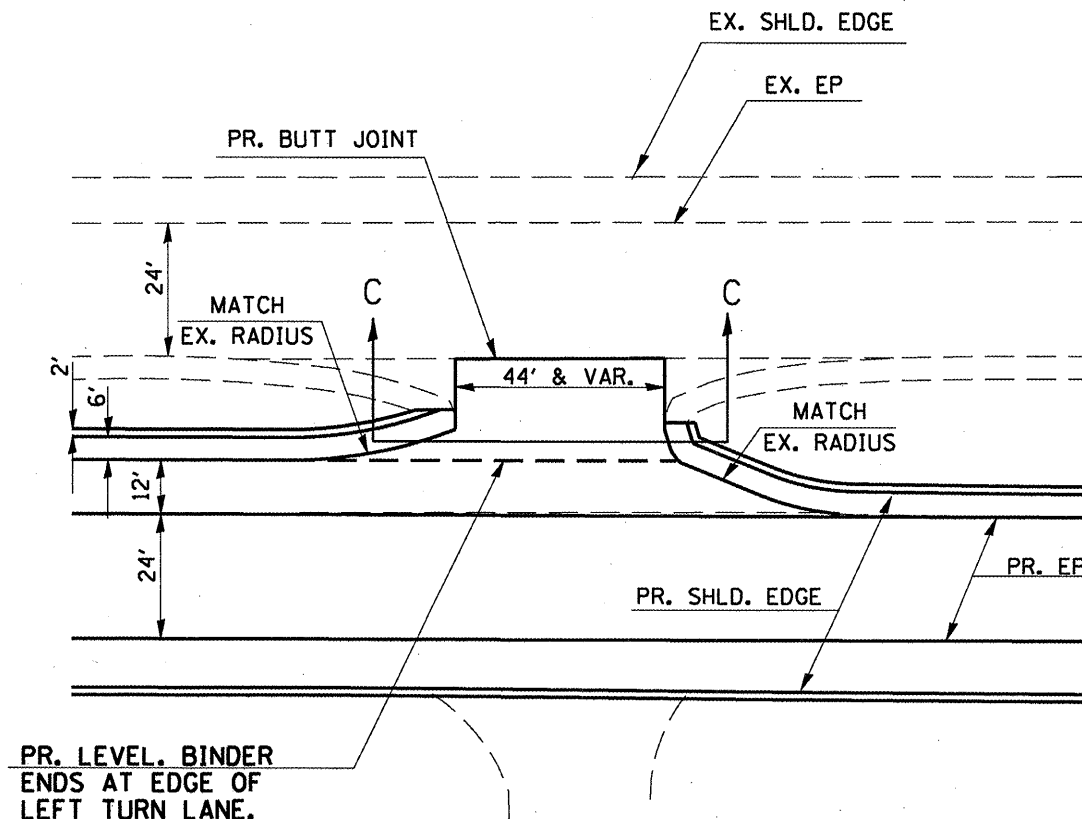

DETAIL FOR
 MEDIAN CROSSOVER WHERE
 LEFT TURN LANE IS PRESENT
 WEST OF IL 166 INTERSECTION
 (SEE TYPICAL SECTION, SHT. 10)

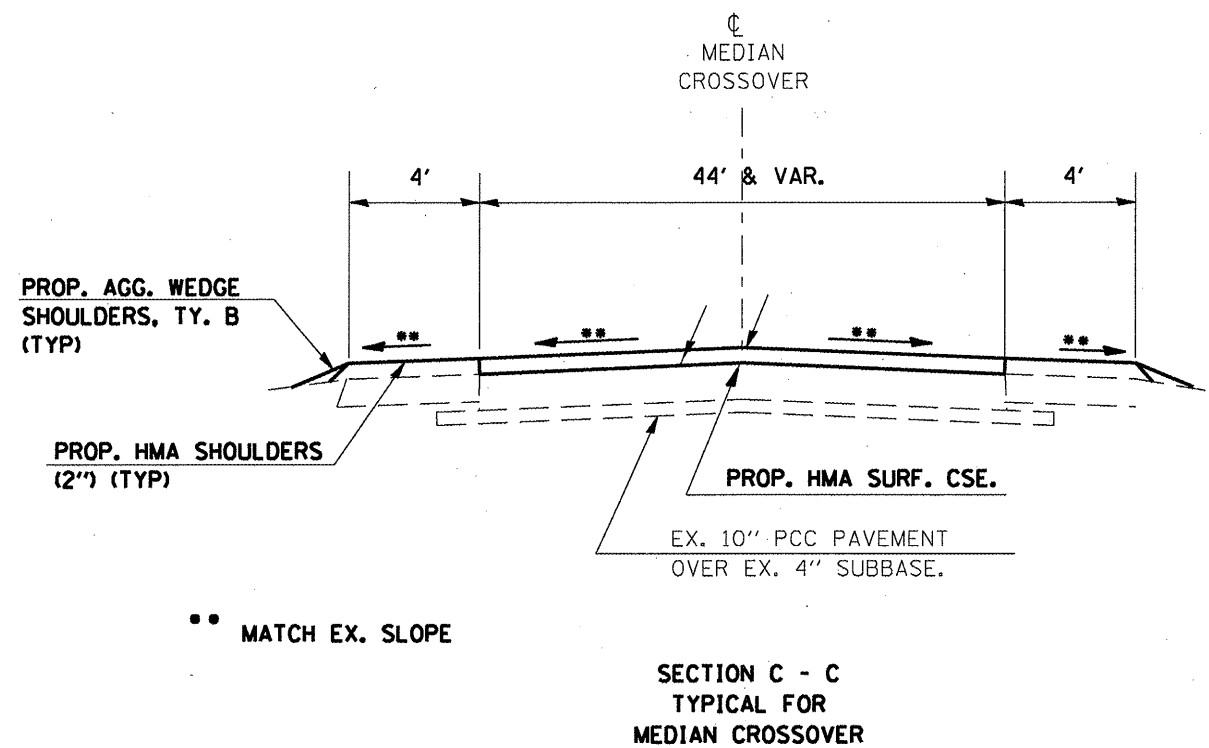

*(6-1)RS-216-3,6-2,7-1,7-3)RS-1

FILE NAME =
 c:\p\work\p1dot\mccardkr\ad186822\7810-sht-plan.dgn

USER NAME = mcardkr
 PLOT SCALE = 100.0000' / IN.
 PLOT DATE = 4/30/2010

DESIGNED - ---
 DRAWN - ---
 CHECKED - ---
 DATE - ---

REVISED - ---
 REVISED - ---
 REVISED - ---
 REVISED - ---

STATE OF ILLINOIS
 DEPARTMENT OF TRANSPORTATION

DETAIL MEDIAN CROSSOVER
 THRU PCC PAVT LOCATION
 SCALE: SHEET NO. OF SHEETS STA. TO STA.

F.A.P. RTE.	SECTION	COUNTY	TOTAL SHEETS	SHEET NO.
331	*	WILLIAMSON	30	25
CONTRACT NO. 78190				
ILLINOIS FED. AID PROJECT				

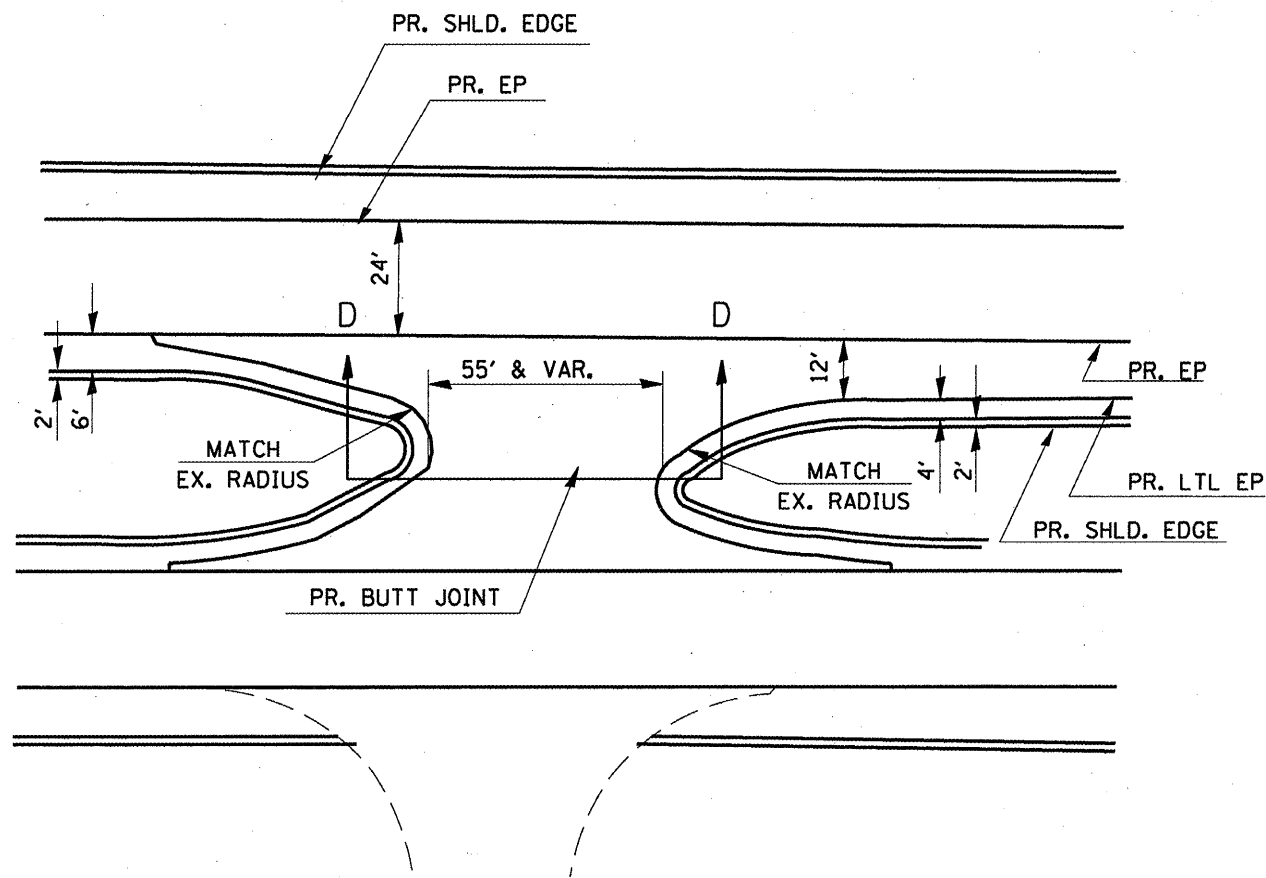

DETAIL FOR MEDIAN CROSSOVER
WITH OR WITHOUT TURN LANE PRESENT
EAST OF IL 166 INTERSECTION
(SEE TYPICAL SECTION, SHT. 10)

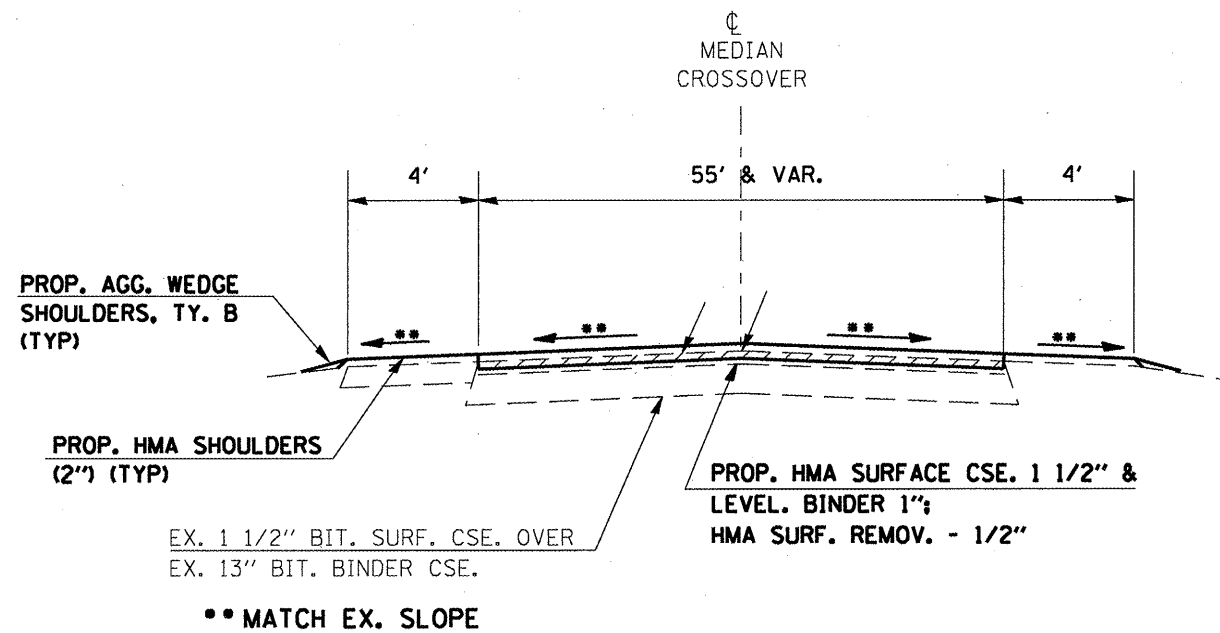

*(6-1)RS-2(6-3,6-2,7-1,7-3)RS-1

FILE NAME =
c:\p\work\p\dot\mccordkr\d0186822\781

USER NAME = mccordkr
sht-plen.dgn
PLOT SCALE = 100.0000' / IN.
PLOT DATE = 4/30/2018

DESIGNED -	---	REVISED -	-----
DRAWN -	---	REVISED -	-----
CHECKED -	---	REVISED -	-----
DATE -	-----	REVISED -	-----

STATE OF ILLINOIS
DEPARTMENT OF TRANSPORTATION

SCALE: _____ SHEET NO. ____ OF ____ SHEETS STA. _____ TO STA. _____

F.A.P. RTE. 331	SECTION *	COUNTY WILLIAMSON	TOTAL SHEETS 30	SHEET NO. 26
CONTRACT NO. 78190			ILLINOIS FED. AID PROJECT	

DETECTOR LOOPS DETAIL



STA. 100+42.45 (INTERSECTION
OF FA 331 (IL 13 WBL) AND IL 166

DETECTOR LOOP, TY. I
4 - 6'x6' - 156 FT.
DETECTOR LOOP, TY. I
2 - 6'x10' - 77 FT.

PROP. FAP 331 (IL 13 WESTBOUND)
BEGIN PROJECT - STA. 99+20

END OF BARE PCC PAV'T.
BEGIN EX. HMA SURFACED PAV'T.
WBL STA. 106+76

50' TAPER TO
PR. BUTT JOINT

50' TAPER TO
PR. BUTT JOINT

STA. 100+44.65 (INTERSECTION
OF FA 331 (IL 13 EBL) AND IL 166

DETECTOR LOOP, TY. I
2 - 6'x10' - 77 FT.
DETECTOR LOOP, TY. I
4 - 6'x6' - 156 FT.

END OF BARE PCC PAV'T.
BEGIN EX. HMA SURFACED PAV'T.
EBL STA. 107+90

PR. BUTT JOINT DETAIL
AT IL. 166 (NORTH & SOUTH)

LEGEND



**HOT-MIX ASPHALT SURFACE
REMOVAL - BUTT JOINT**

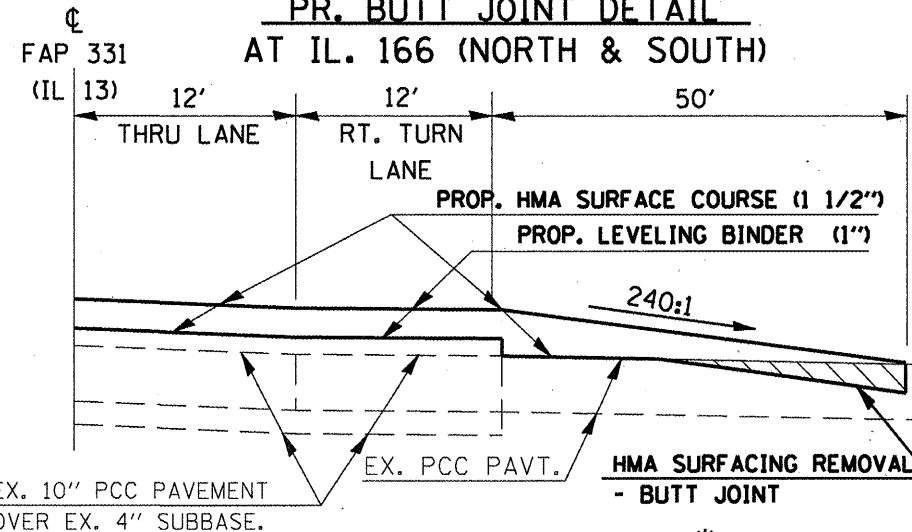

* (6-1)RS-2(6-3,6-2,7-1,7-3)RS-1

FILE NAME #	USER NAME = mccordkr	DESIGNED -	REVISED -	STATE OF ILLINOIS DEPARTMENT OF TRANSPORTATION	DETAIL DETECTOR LOOPS		F.A.P. RTE. #	SECTION	COUNTY	TOTAL SHEETS	SHEET NO.	
at:\pwork\pwork\DOT\MCCORDKR\d0186822\78	90-sht-plan.dgn	DRAWN -	REVISED -		SCALE: _____	SHEET NO. _____ OF _____ SHEETS	STA. _____ TO STA. _____	331	*	WILLIAMSON	30	27
	PLOT SCALE = 100.0000' / IN.	CHECKED -	REVISED -									
	PLOT DATE = 5/3/2010	DATE -	REVISED -									
ILLINOIS FED. AID PROJECT												

SIDEROAD AND ENTRANCE DETAILS

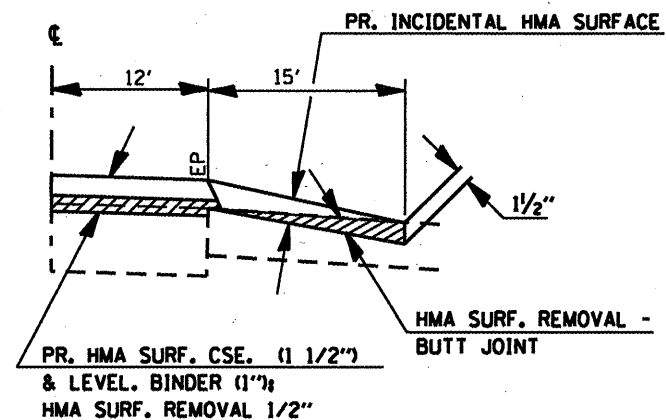

SIDE ROAD EAST OF IL 166
SEC. A-A
EX. BIT. OR CONC. SURFACE
WITH NO TURN LANE

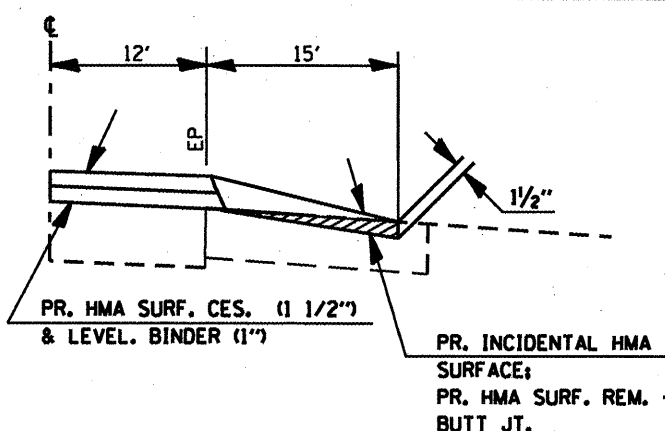

SIDE ROAD WEST OF IL 166
SEC. A-A
EX. BIT. OR CONC. SURFACE
WITH NO TURN LANE

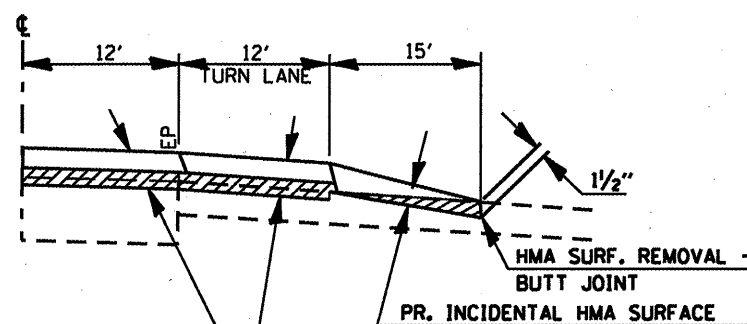

PR. HMA SURF. CSE. (1 1/2")
& LEVEL. BINDER (1")
HMA SURF. REMOVAL 1/2"

SIDE ROAD EAST OF IL 166
SEC. B-B
EX. BIT. OR CONC. SURFACE
WITH TURN LANE

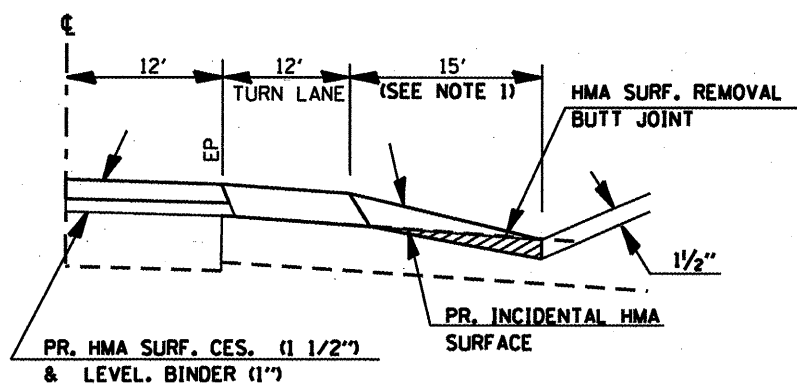

SIDE ROAD WEST OF IL 166
SEC. B-B
EX. BIT. OR CONC. SURFACE
WITH TURN LANE

NOTE 1: THE TAPER LENGTH
AT IL. 166 NORTH & SOUTH
SHALL BE 50'. SEE DETAIL,
SHT. 27.

ENTRANCE SCHEDULE
(SEE NOTE 1)

TYPE	NUMBER OF ENTRANCES
P.E.	4
C.E.	0
F.E.	2

NOTE 1:
ALL ENTRANCES ARE BEHIND HMA SHOULDER.
THEREFORE NO TREATMENT IS REQUIRED.

DETAIL FOR SIDE ROAD
WITH NO TURN LANE

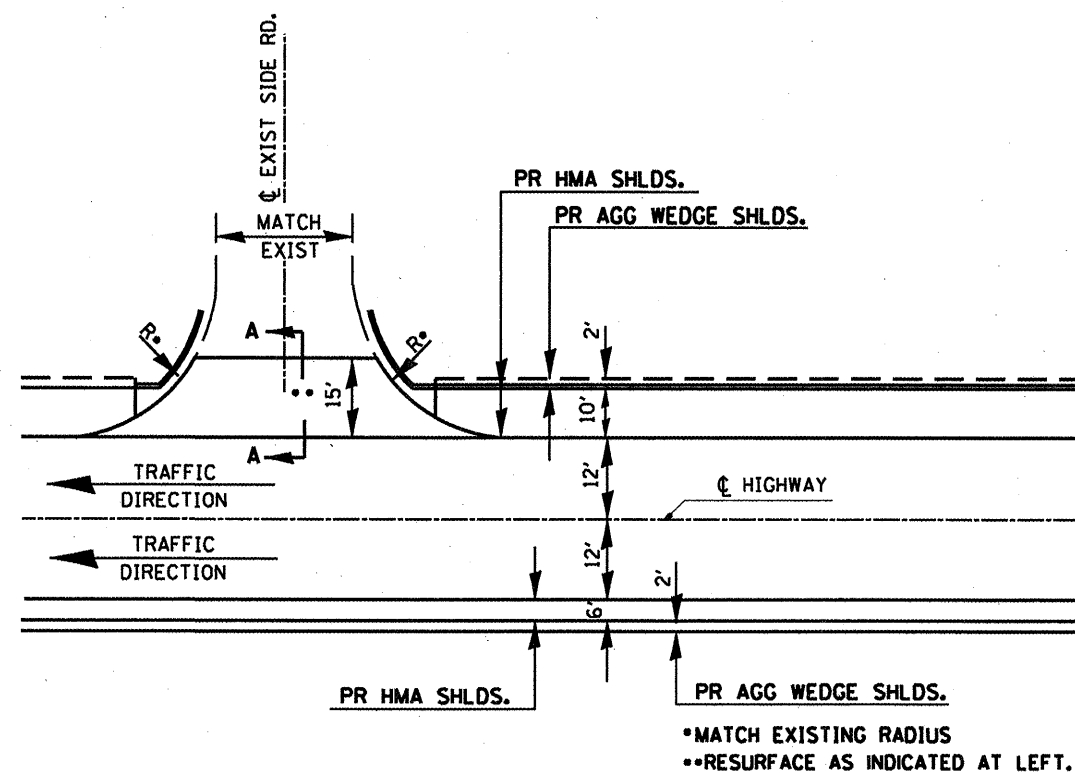

*MATCH EXISTING RADIUS
**RESURFACE AS INDICATED AT LEFT.

DETAIL FOR SIDE ROAD
WITH TURN LANE

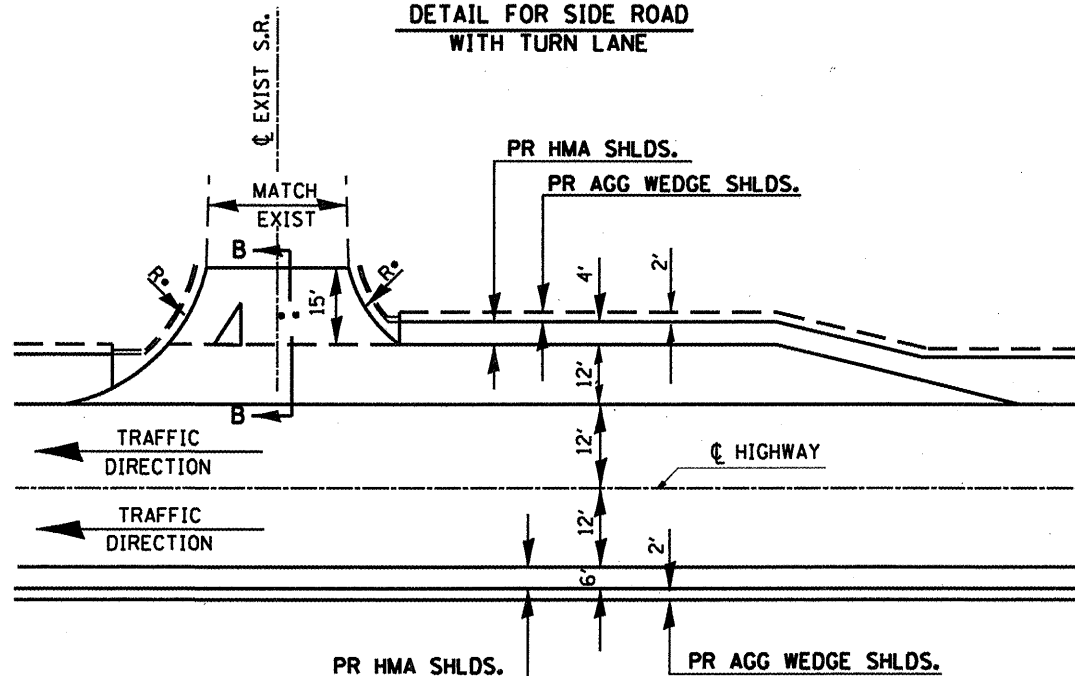

*MATCH EXISTING RADIUS
**RESURFACE AS INDICATED AT LEFT.

* (6-1)RS-2(6-3,6-2,7-1,7-3)RS-1

FILE NAME =	USER NAME = mcoordkr	DESIGNED -	REVISED -
or\pwwork\PIWIDOT\MCCORDKR\08186822\7818-sht-plan.dgn		DRAWN -	REVISED -
PLOT SCALE = 200.0000' / IN.		CHECKED -	REVISED -
PLOT DATE = 5/3/2010		DATE -	REVISED -

STATE OF ILLINOIS
DEPARTMENT OF TRANSPORTATION

DETAIL - LOC. 1 SIDE ROADS
AND ENTRANCES

SCALE: SHEET NO. OF SHEETS STA. TO STA.

F.A.P. RTE.	SECTION	COUNTY	TOTAL SHEETS	SHEET NO.
331		WILLIAMSON	30	28
CONTRACT NO. 78190				
FED. ROAD DIST. NO. ILLINOIS FED. AID PROJECT				

TEMPORARY HOT-MIX ASPHALT TRANSITIONS

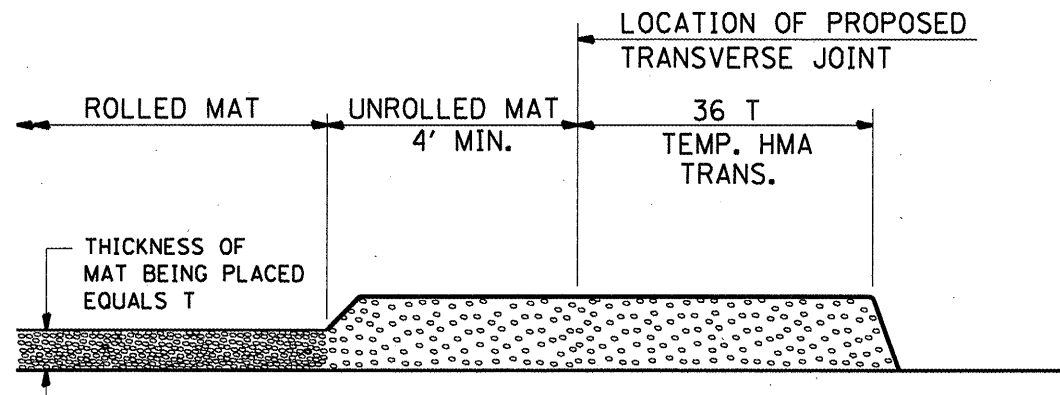

STEP I

1. PLACE HOT-MIX ASPHALT MAT, LENGTH 36 TIMES THE THICKNESS OF THE MAT BEING PLACED PAST THE PROPOSED TRANSVERSE JOINT LOCATION USING NORMAL OPERATING PROCEDURES.
2. EXTREME CARE SHOULD BE TAKEN TO MAINTAIN ENOUGH MATERIAL IN FRONT OF THE SCREED TO MAINTAIN REQUIRED PAVING DEPTH.

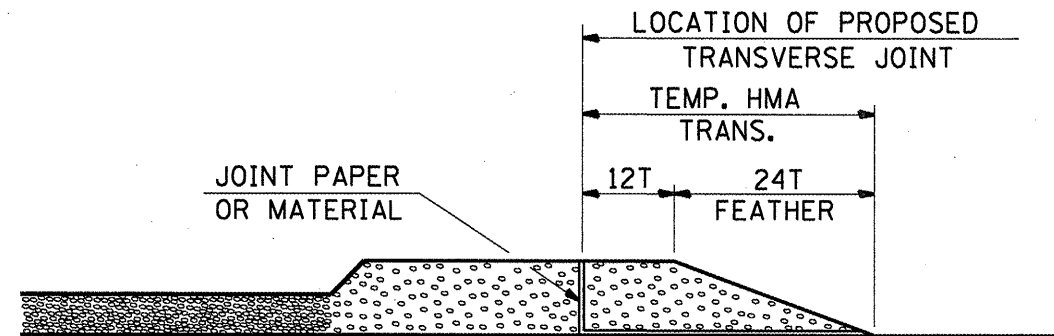

STEP III

1. JOINT PAPER OR OTHER PRESELECTED JOINT MATERIAL IS THEN PLACED IN THE CLEARED AREA AND THE EXCESS ASPHALT USED TO HAND FORM A TRANSITION TO THE DIMENSIONS SHOWN ABOVE.
2. NOTE THAT IN CONSTRUCTING THE TRANSITION, THE MAT DEPTH IS CONTINUED AS PART OF THE TRANSITION BEFORE FORMING THE FEATHER.

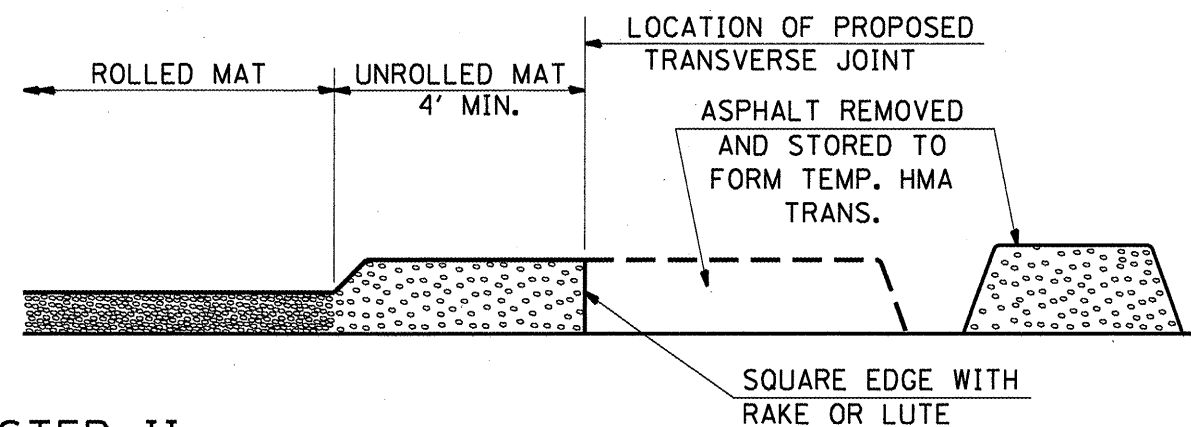

STEP II

1. MOVE THE PAVER OUT OF THE WAY AND REMOVE THE ASPHALT FROM THE AREA OF THE PROPOSED TEMPORARY HOT-MIX ASPHALT TRANSITION.
2. SQUARE UP THE END OF THE MAT WITH A RAKE OR LUTE.
3. NOTE THAT THE MAT WITHIN 4' OF THE END OF JOINT IS NOT TO BE ROLLED AT THIS TIME.

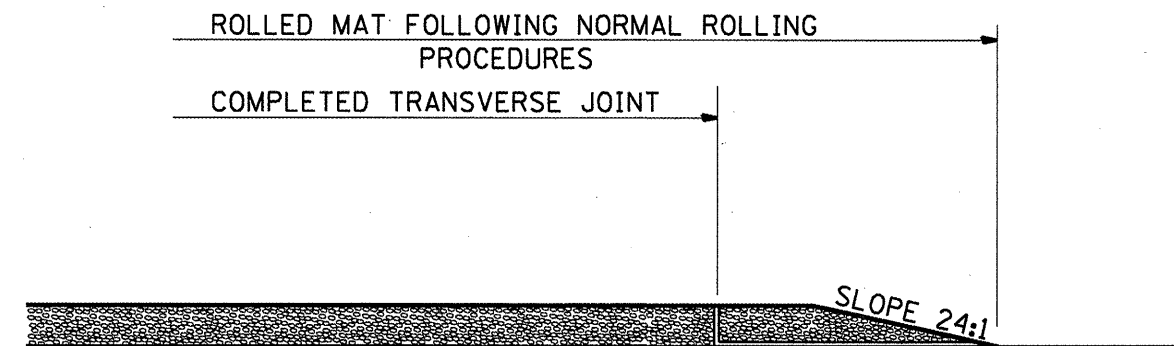

STEP IV

1. COMPLETE TEMPORARY TRANSITION BY ROLLING.
2. TO RESUME PAVING, AT THE JOINT, REMOVE TEMPORARY TRANSITION AND DISPOSE OF THE MATERIAL ACCORDING TO ART. 202.03 OF THE STD. SPECS. (COST INCLUDED IN THE CONTRACT).
3. CONSTRUCTING THE TEMPORARY TRANSITIONS WILL NOT BE PAID FOR SEPARATELY IN ACCORDANCE WITH ARTICLE 406.14 OF THE STANDARD SPECIFICATIONS.

REVISIONS	
REDRAWN	2-15-89
REVISED	8-16-94
REVISED	01-09-07
REVISED	

STD. 9-26

* (6-1)RS-2(6-3,6-2,7-1,7-3)RS-1

FILE NAME =	USER NAME = mccordkr	DESIGNED -	REVISED -	STATE OF ILLINOIS DEPARTMENT OF TRANSPORTATION	TEMP. HOT-MIX ASPHALT TRANSITIONS	F.A.P. RTE.	SECTION	COUNTY	TOTAL SHEETS	SHEET NO.	
o:\pwwork\PW100T\MCCORDKR\d0186822\78	10-shit-plen.dgn	DRAWN -	REVISED -			331		WILLIAMSON	30	29	
PLOT SCALE = 200.0000' / IN.		CHECKED -	REVISED -			CONTRACT NO. 70190					
PLOT DATE = 4/27/2010		DATE -	REVISED -			ILLINOIS FED. AID PROJECT					

UNEVEN LANES SIGN
WB-11 (48" x 48")

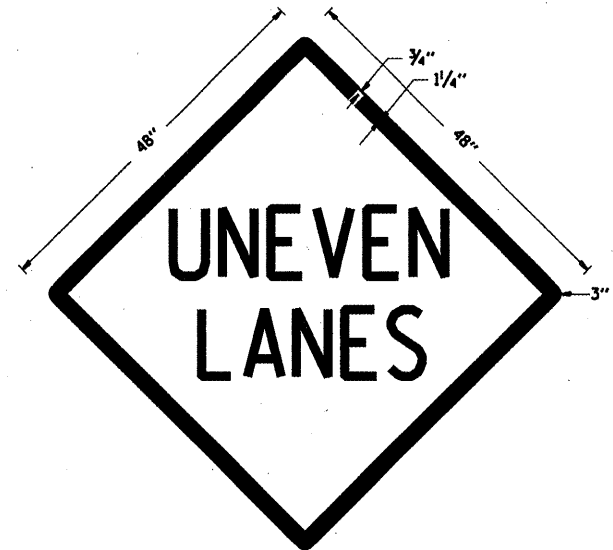

COLORS:
LEGEND AND BORDER - BLACK NON-REFLECTORIZED
BACKGROUND - ORANGE REFLECTORIZED

NOTE: PRIOR TO ALLOWING TRAFFIC ON ANY PORTION OF THE ROADWAY THAT HAS BEEN COLDMILLED OR BEFORE RESURFACING OPERATIONS BEGIN, THE CONTRACTOR SHALL HAVE ERECTED "UNEVEN PAVEMENT" SIGNS THAT CONFORM TO THE ABOVE DETAILS. A MINIMUM OF ONE SIGN AT EACH END OF THE IMPROVEMENT WILL BE REQUIRED. THE CONTRACTOR SHALL MAINTAIN THE "UNEVEN PAVEMENT" SIGNS UNTIL THE RESURFACING OPERATIONS ARE COMPLETED.

IF AT ANY TIME THE SIGNS ARE IN PLACE BUT NOT APPLICABLE, THEY SHALL BE TURNED FROM THE VIEW OF MOTORISTS OR COVERED AS DIRECTED BY THE ENGINEER.

THE COST OF FURNISHING, ERECTING, MAINTAINING, AND REMOVING THE REQUIRED SIGNS SHALL BE INCLUDED IN THE CONTRACT.

REVISIONS	
NO.	DESCRIPTION

STD. 9-41

* (6-1)RS-2(6-3,6-2,7-1,7-3)RS-1

FILE NAME *	USER NAME = mcoordkr	DESIGNED -	REVISOR -
at\pwork\PWIDOT\MCCORDKR\0186822\7810-shit-plendgn		DRAWN -	REVISOR -
PLOT SCALE = 200.0000' / IN.		CHECKED -	REVISOR -
PLOT DATE = 4/27/2010		DATE -	REVISOR -

STATE OF ILLINOIS
DEPARTMENT OF TRANSPORTATION

--- **DETAIL: UNEVEN LANES SIGN** ---

SCALE: _____	SHEET NO. ____ OF ____ SHEETS	STA. _____ TO STA. _____
--------------	-------------------------------	--------------------------

F.A.P. RTE.	SECTION	COUNTY	TOTAL SHEETS	SHEET NO.
331		WILLIAMSON	30	30
CONTRACT NO. 78190				
ILLINOIS FED. AID PROJECT				