

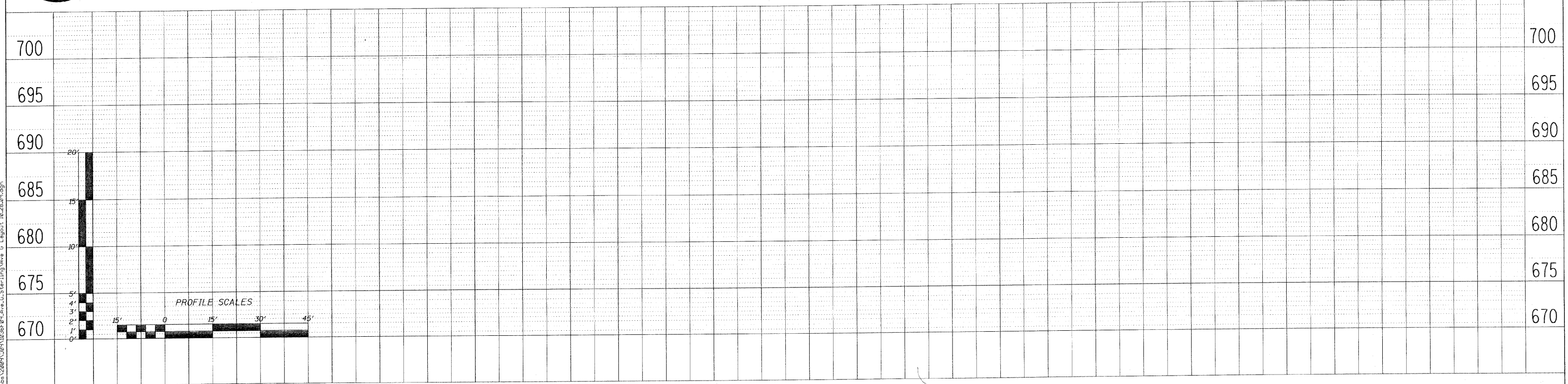

INDICATES LIMIT OF HOT MIX ASPHALT SURFACE REMOVAL - 2 3/4". REMOVE FULL WIDTH OF AVENUE G AND AT INTERSECTING STREETS AS SHOWN.

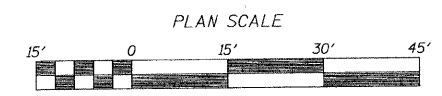
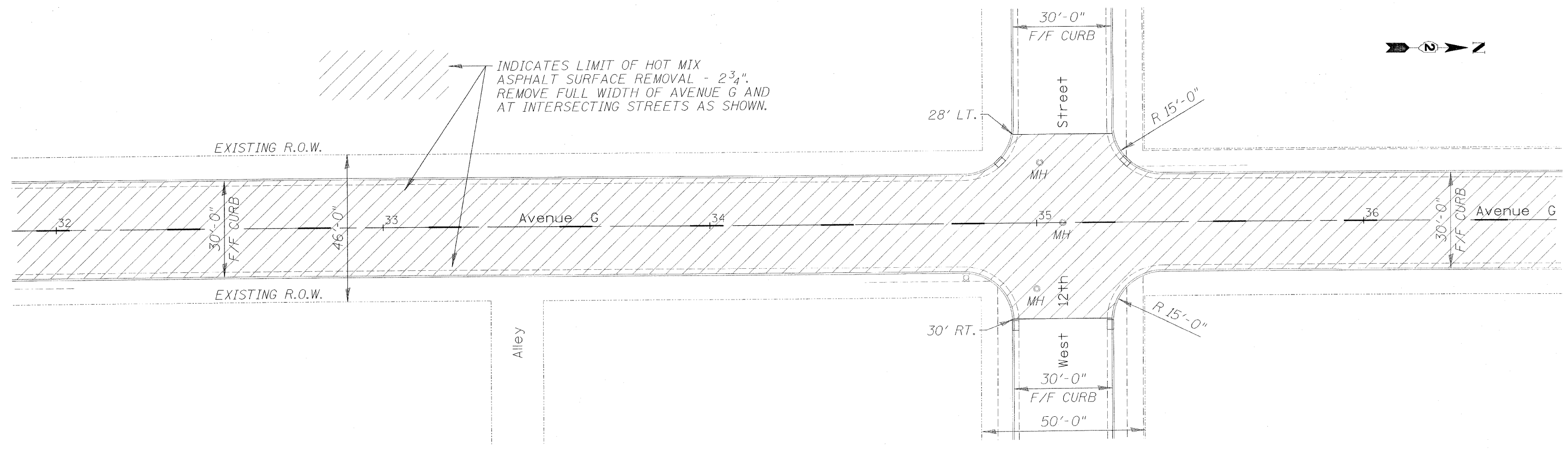

FILE NAME : L:\Jobs\2009\09\10\06\09_Ave.G_Sterling\Ave G Layout 10.26.09.dgn

WILLET, HOFMANN & ASSOCIATES, INC.
CONSULTING ENGINEERS
809 East Second Street Dixon, IL 61021
Phone 815.284.3381 Fax 815.284.3385
Design Firm #194-00918
www.willettthofmann.com

DESIGNED - BDF	REVISED -
DRAWN - JDH	REVISED -
CHECKED - BDF	REVISED -
DATE -	REVISED -

CITY OF STERLING, ILLINOIS AVENUE G - 5TH STREET TO LE FEVRE RD.

AVENUE G PLAN & PROFILE

SCALE: SHEET NO. 13 OF 31 SHEETS

F.A. RTE.	SECTION	COUNTY	TOTAL SHEETS	SHEET NO.
	09-00147-00-RS	WHITESIDE	31	13
CONTRACT NO. 85495				
FED. ROAD DIST. NO. - ILLINOIS FED. AID PROJECT				