

COMPANY NAME: SEC GROUP, INC.
 PROJECT CONTACT: Robert G. Davies
 CLIENT: City of Rockford
 DATE PLOTTED: 1/26/2010 10:27 AM
 PLOT NAME: 09-00557-00-BR
 PLOT DRIVER: pdfplot
 PEN TABLE: standard-trans.tbl

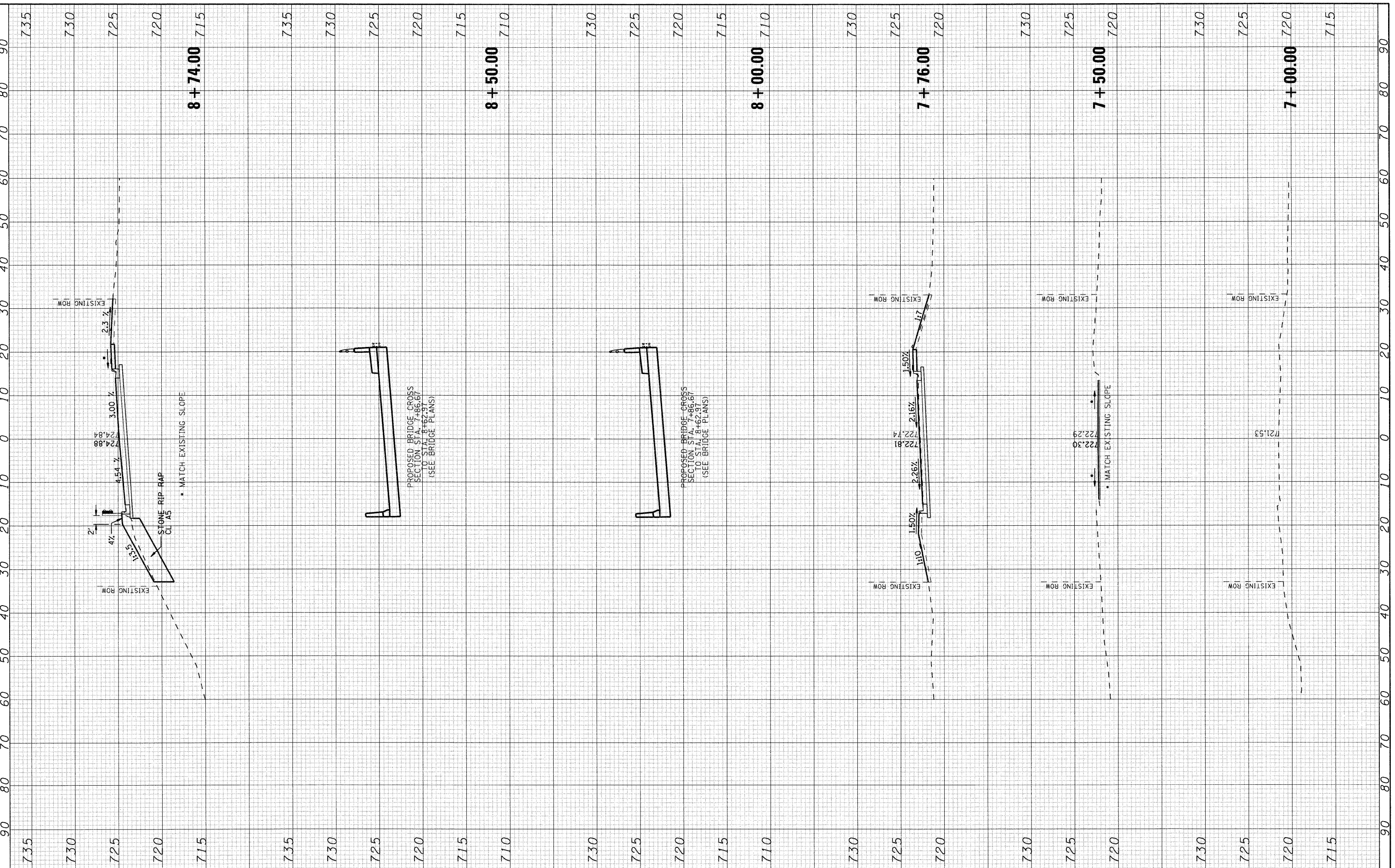

SEC Group, Inc.
 An IRI Group Company
 4024 First Bank
 Moline, IL 61201-2138
 315.385.1778 • 315.385.1781
 www.secgroupinc.com
 *McHenry, IL • Rockville, IL • New Laramie, IL • Chicago, IL

USER NAME = whood	DESIGNED - KMA	REVISED -
FILE NAME = 09-00557-00-BR.dgn	DRAWN - WJH	REVISED -
PLOT SCALE =	CHECKED - TH	REVISED -
PLOT DATE = 1/26/2010	DATE - 1/26/2010	REVISED -

CITY OF ROCKFORD

**CENTRAL AVENUE OVER THE SOUTH BRANCH OF KENT CREEK
 CROSS SECTIONS**

SCALE: 10H:5V SHEET NO. 1 OF 2 SHEETS STA. 7+00.00 TO STA. 8+74.00

F.A.U. RTE.	SECTION	COUNTY	TOTAL SHEETS	SHEET NO.
5102	09-00557-00-BR	Winnebago	18	17
FED. ROAD DIST. NO. 2 ILLINOIS FED. AID PROJECT			CONTRACT NO. 85508	