

PROP. CURVE SW1
PI STA. = 83+18.99
Δ = 43° 02' 55" (LT)
D = 38° 11' 50"
R = 150.00'
T = 59.16'
L = 112.70'
E = 11.24'
N = 6,905.5464
E = 4,169.2671

PROP. CURVE SW4
PI STA. = 89+15.17
Δ = 16° 03' 40" (LT)
D = 9° 32' 57"
R = 600.00'
T = 84.65'
L = 168.19'
E = 5.94'
N = 7,238.5286
E = 4,668.0504

PROP. CURVE SW6
PI STA. = 100+30.57
Δ = 5° 17' 01" (RT)
D = 22° 55' 06"
R = 250.00'
T = 11.53'
L = 23.05'
E = 0.27'
N = 7,393.4065
E = 4,871.4654

PROP. CURVE SW2
PI STA. = 85+64.22
Δ = 14° 58' 04" (RT)
D = 5° 43' 46"
R = 1,000.00'
T = 131.37'
L = 261.24'
E = 8.59'
N = 7,068.4291
E = 4,360.0468

PROP. CURVE SW5
PI STA. = 90+78.20
Δ = 49° 34' 28" (RT)
D = 114° 35' 30"
R = 50.00'
T = 23.09'
L = 43.26'
E = 5.07'
N = 7,363.1421
E = 4,774.8838

PROP. CURVE SW3
PI STA. = 87+62.35
Δ = 7° 48' 35" (LT)
D = 5° 43' 46"
R = 1,000.00'
T = 68.26'
L = 136.30'
E = 2.33'
N = 7,154.4389
E = 4,540.1910

ALIGN THE CONCRETE SIDEWALK JOINTS TO THE PORTLAND CONCRETE SIDEWALK 4" SPECIAL.

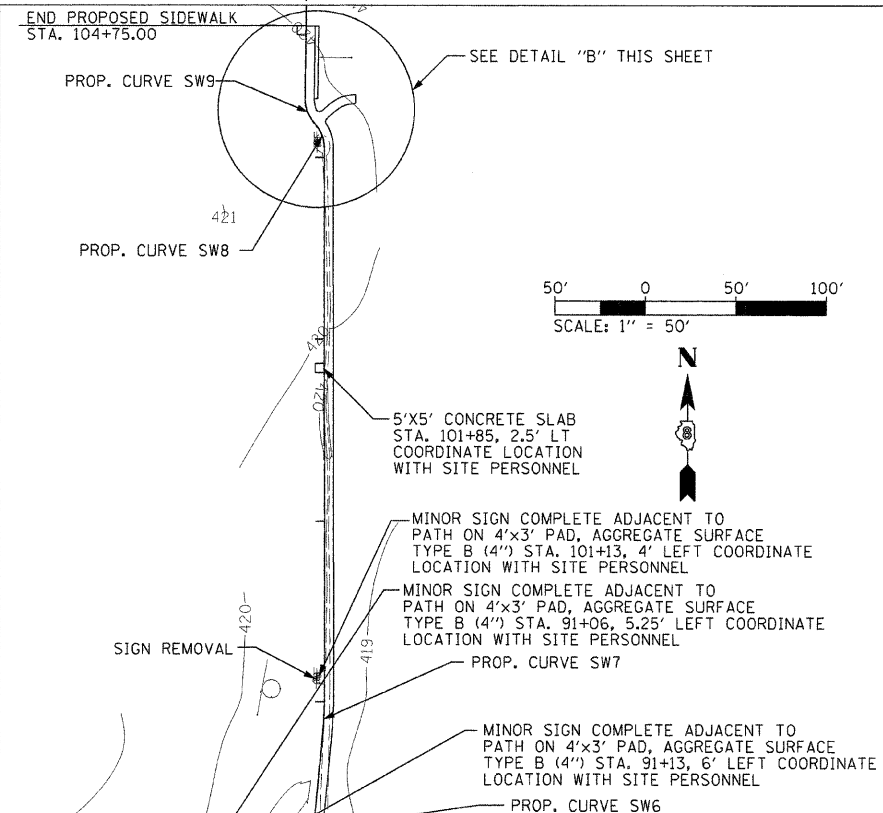
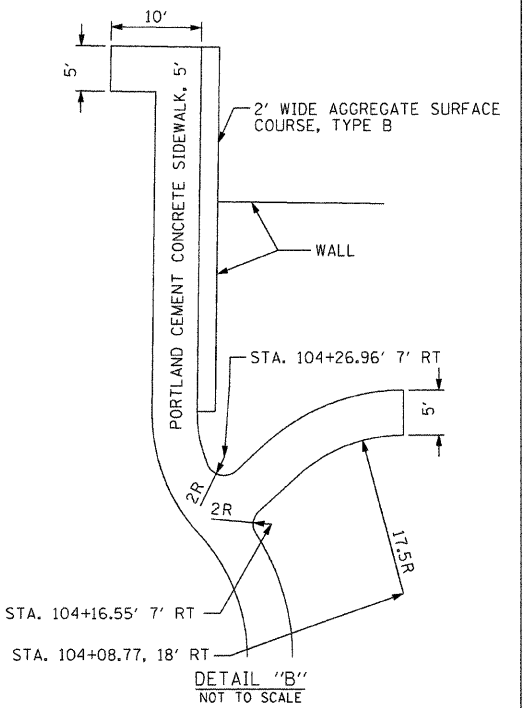
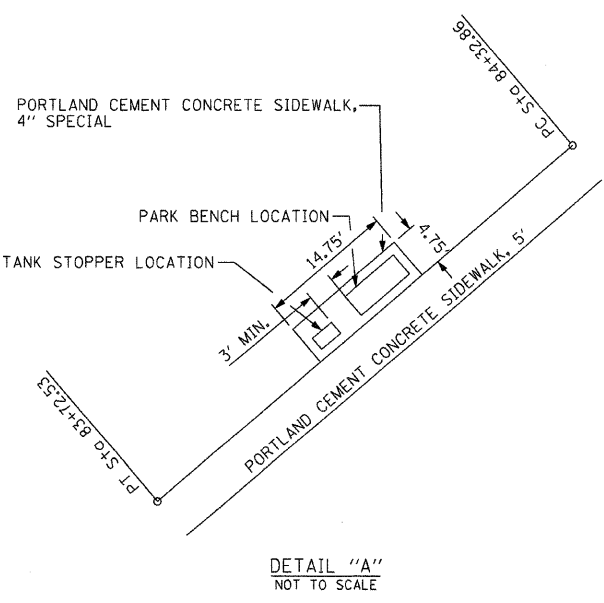

PROP. CURVE SW7
PI STA. = 100+93.06
Δ = 5° 30' 46" (LT)
D = 22° 55' 06"
R = 250.00'
T = 12.04'
L = 24.05'
E = 0.29'
N = 7,455.6332
E = 4,877.4159

PROP. CURVE SW8
PI STA. = 104+12.84
Δ = 42° 29' 51" (LT)
D = 286° 28' 44"
R = 20.00'
T = 7.78'
L = 14.83'
E = 1.46'
N = 7,775.4239
E = 4,877.1346

PROP. CURVE SW9
PI STA. = 104+27.81
Δ = 43° 10' 41" (RT)
D = 286° 28' 44"
R = 20.00'
T = 7.91'
L = 15.07'
E = 1.51'
N = 7,786.9840
E = 4,866.5240

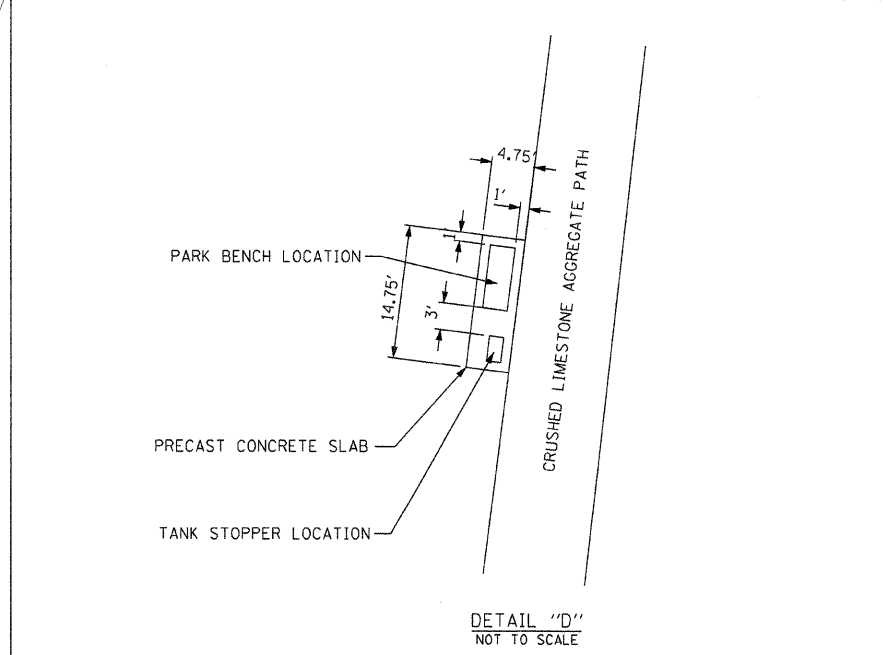
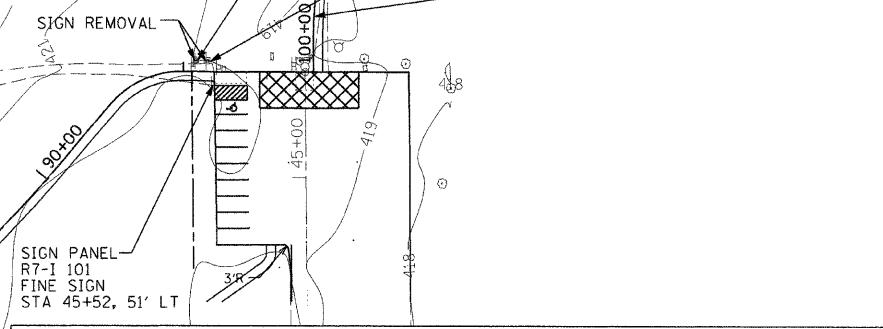
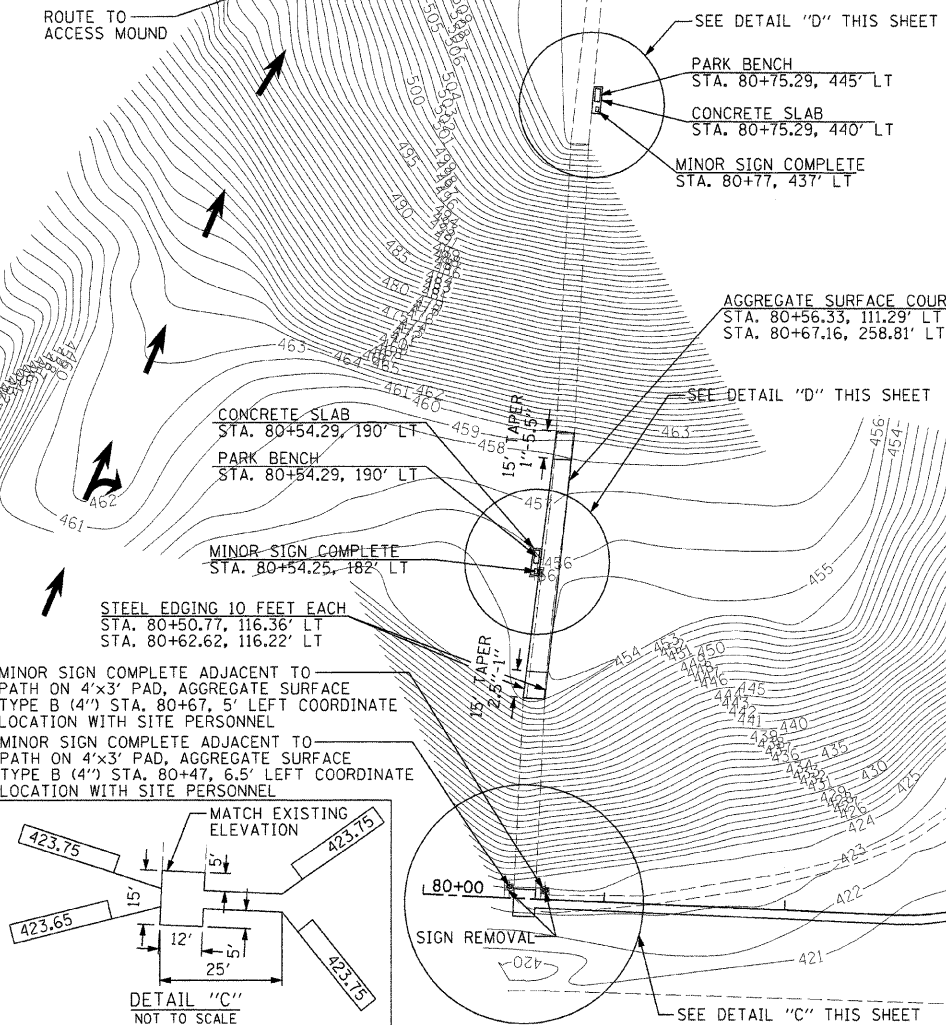

FILE NAME = *FILEL#*	USER NAME = *USER#*	DESIGNED - T.T.P.	REVISED -
		DRAWN - S.D.K.	REVISED -
		CHECKED - R.H.D.	REVISED -
		DATE - 5/8/09	REVISED -

STATE OF ILLINOIS
DEPARTMENT OF TRANSPORTATION

MONKS MOUND AND WALL SIDEWALK
CAHOKIA MOUNDS STATE HISTORIC SITE

SCALE: 1" = 50'	SHEET NO. 7 OF 12 SHEETS	STA. TO STA.	FED. ROAD DIST. NO.	ILLINOIS FED. AID PROJECT
-----------------	--------------------------	--------------	---------------------	---------------------------

F.A. RTE.	SECTION	COUNTY	TOTAL SHEETS	SHEET NO.
		ST. CLAIR	12	7
CONTRACT NO. 46060				