

F.A.I. RTE.	SECTION	COUNTY	TOTAL SHEETS	SHEET NO.
94	2005-030 I	COOK	29	7
STA. 2212+06.2		TO STA. 2338+58.7		
FED. ROAD DIST. NO.		ILLINOIS FED. AID PROJECT		

60A01

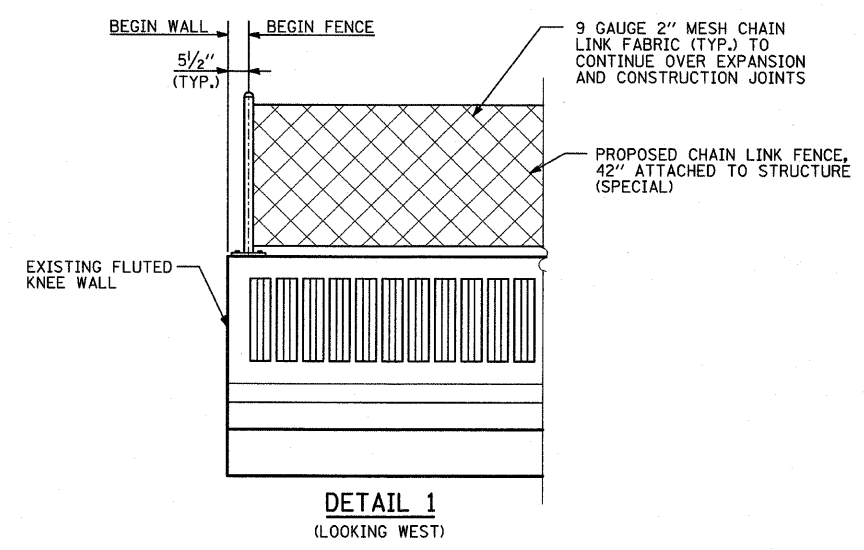

LEGEND:

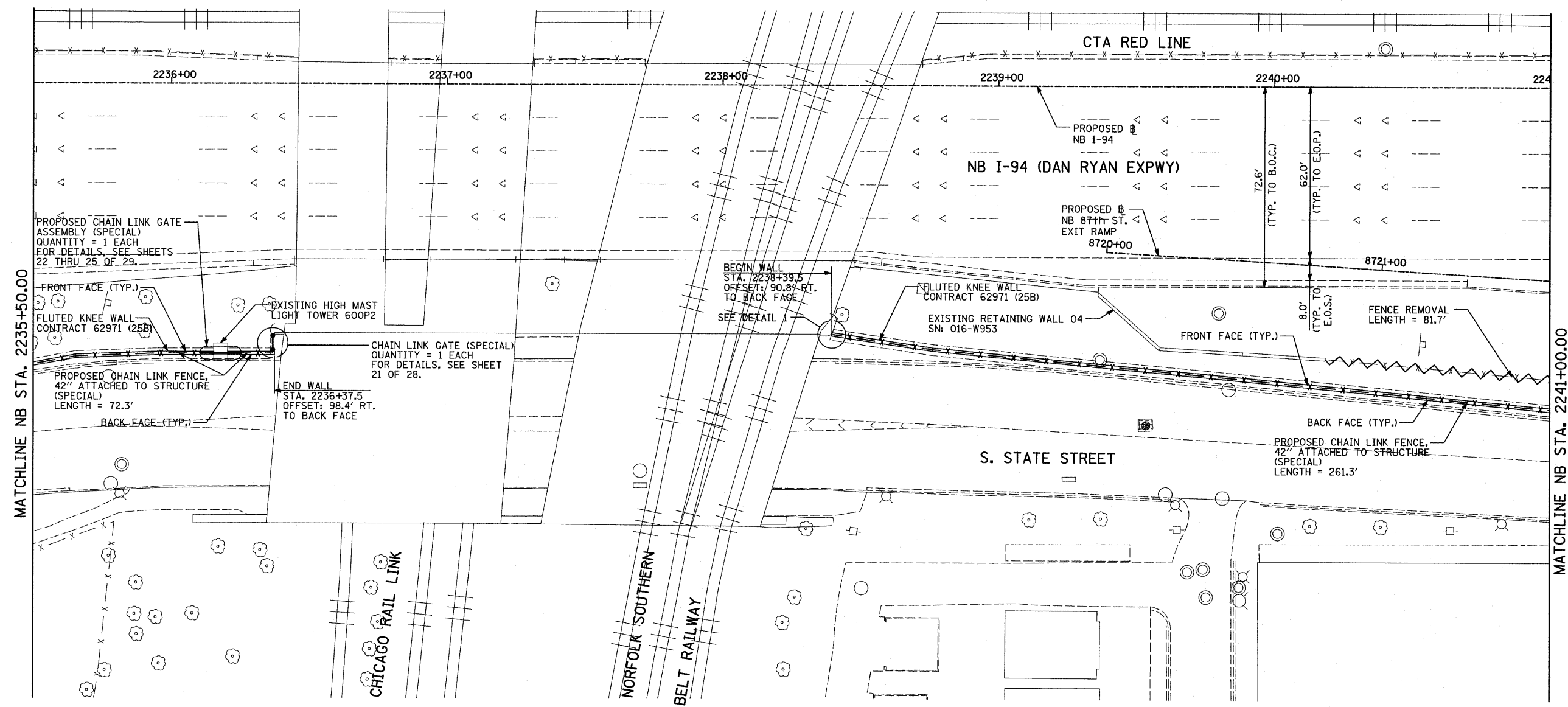
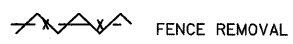

NOTES:

1. FOR CHAIN LINK FENCE, 42" ATTACHED TO STRUCTURE (SPECIAL), SEE SHEET 19 OF 29.
2. FOR CHAIN LINK GATE ASSEMBLY (SPECIAL), SEE SHEETS 22 THRU 25 OF 29.

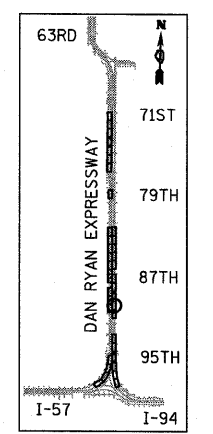

LOCATION MAP

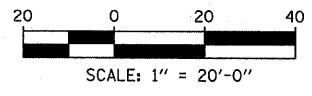

REVISIONS	
NAME	DATE

ILLINOIS DEPARTMENT OF TRANSPORTATION
F.A.I. 94 (DAN RYAN EXPRESSWAY)
PROPOSED PLAN
NB I-94 (DAN RYAN EXPRESSWAY)
STA. 2235+50.00 TO STA. 2241+00.00
CONTRACT 25B LOCATION

SCALE: 1"=20'
 DATE: FEBRUARY 13, 2009
 DRAWN BY: MAF
 CHECKED BY: TGB, MI

TYLIN INTERNATIONAL

3/19/2009 10:53:14 AM