

F.A.I. RTE.	SECTION	COUNTY	TOTAL SHEETS	SHEET NO.
94	2005-031 I	COOK	29	10
STA. 1216+88.4		TO STA. 1347+14.0		
FED. ROAD DIST. NO.	ILLINOIS	FED. AID PROJECT		

60A02

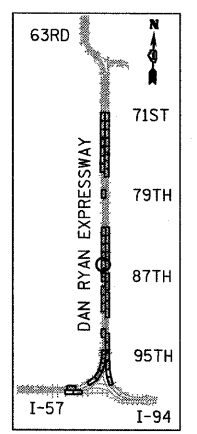

LOCATION MAP

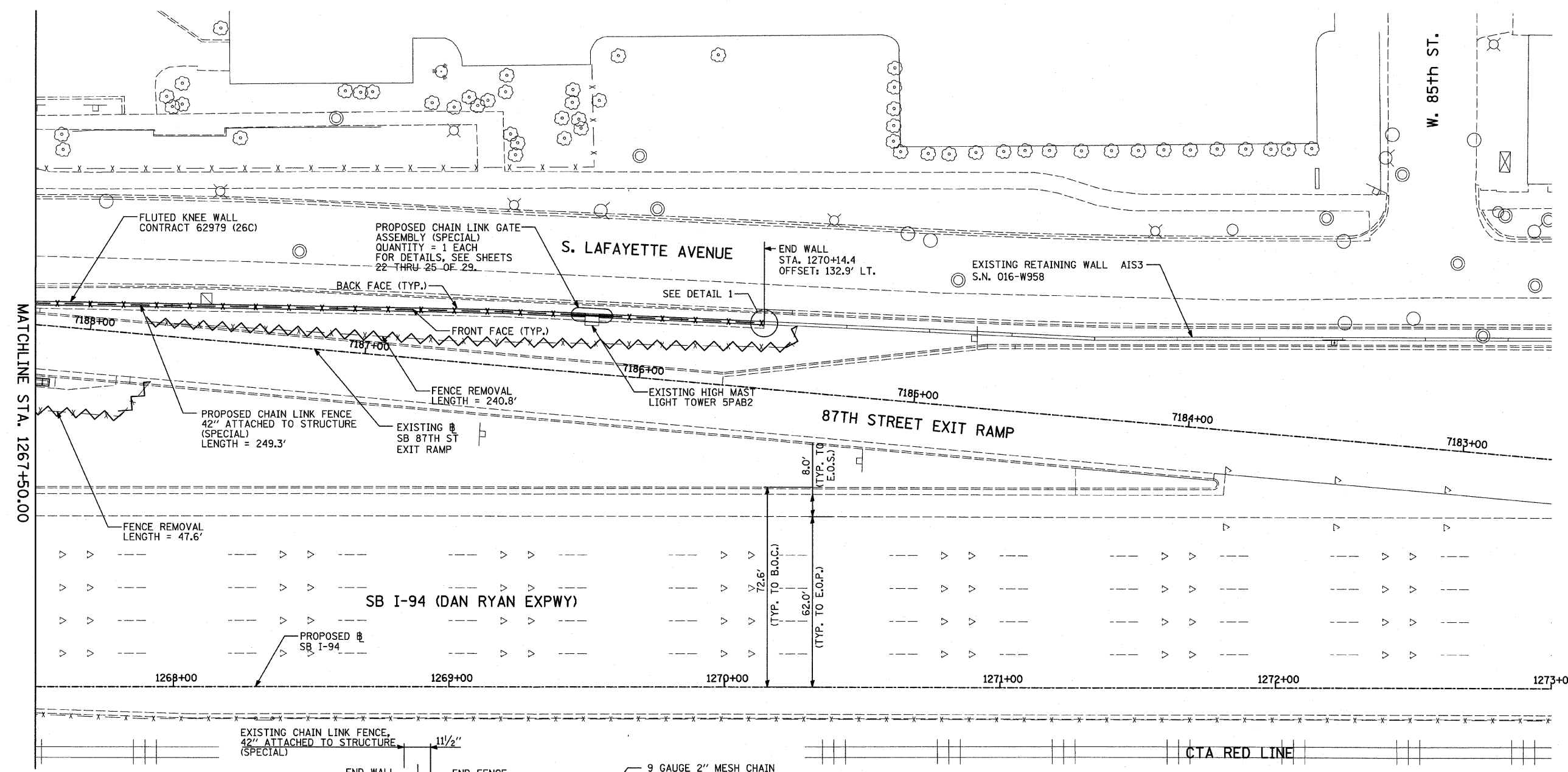
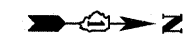
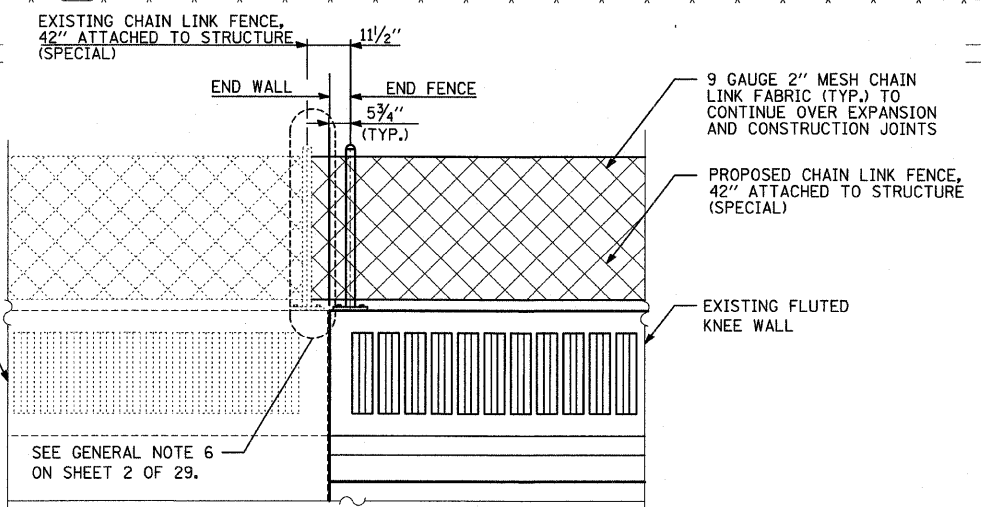
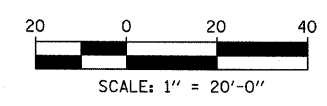

DETAIL 1
(LOOKING EAST)

LEGEND:
 FENCE REMOVAL

- NOTES:**
1. FOR CHAIN LINK FENCE, 42" ATTACHED TO STRUCTURE (SPECIAL), SEE SHEET 19 OF 29.
 2. FOR CHAIN LINK GATE ASSEMBLY (SPECIAL), SEE SHEETS 22 THRU 25 OF 29.

REVISIONS	
NAME	DATE

ILLINOIS DEPARTMENT OF TRANSPORTATION
**F.A.I. 94 (DAN RYAN EXPRESSWAY)
 PROPOSED PLAN**
 SB I-94 (DAN RYAN EXPRESSWAY)
 STA. 1267+00.00 TO STA. 1273+00.00
 CONTRACT 26C LOCATION

SCALE: 1"=20'
 DATE: FEBRUARY 13, 2009
 DRAWN BY: MAF
 CHECKED BY: TGB, MI

TYLIN INTERNATIONAL

P:\0227 2V\road\c3\A\p26cst10.3.dwg
 3/19/2009 10:35:43 AM