

F.A.I. RTE.	SECTION	COUNTY	TOTAL SHEETS	SHEET NO.
55	99 (I&2) I-11	WILL	176	85
STA.		TO STA.		
FED. ROAD DIST. NO.		ILLINOIS FED. AID PROJECT		

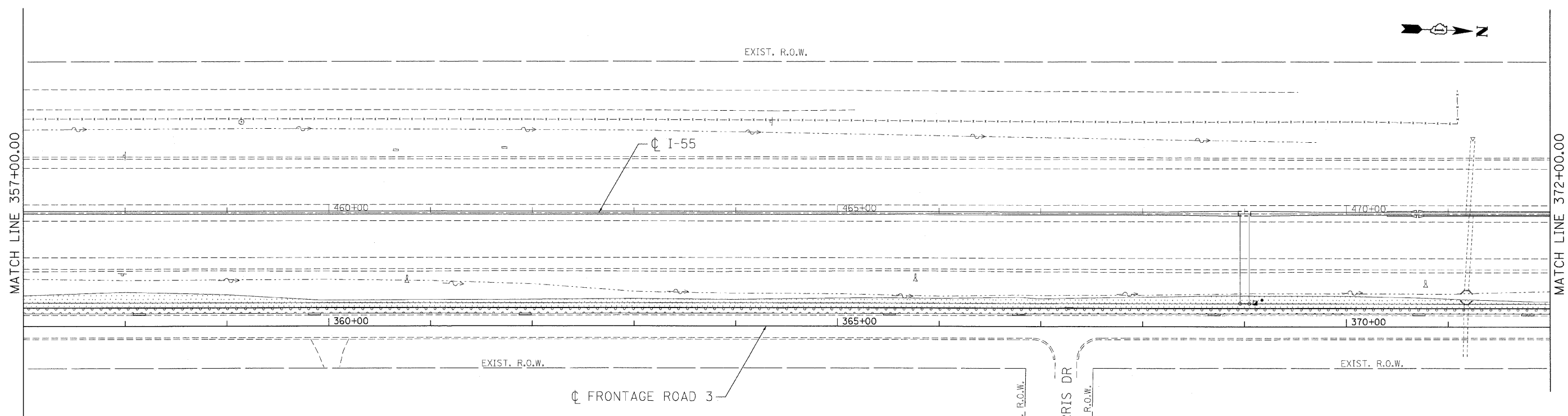
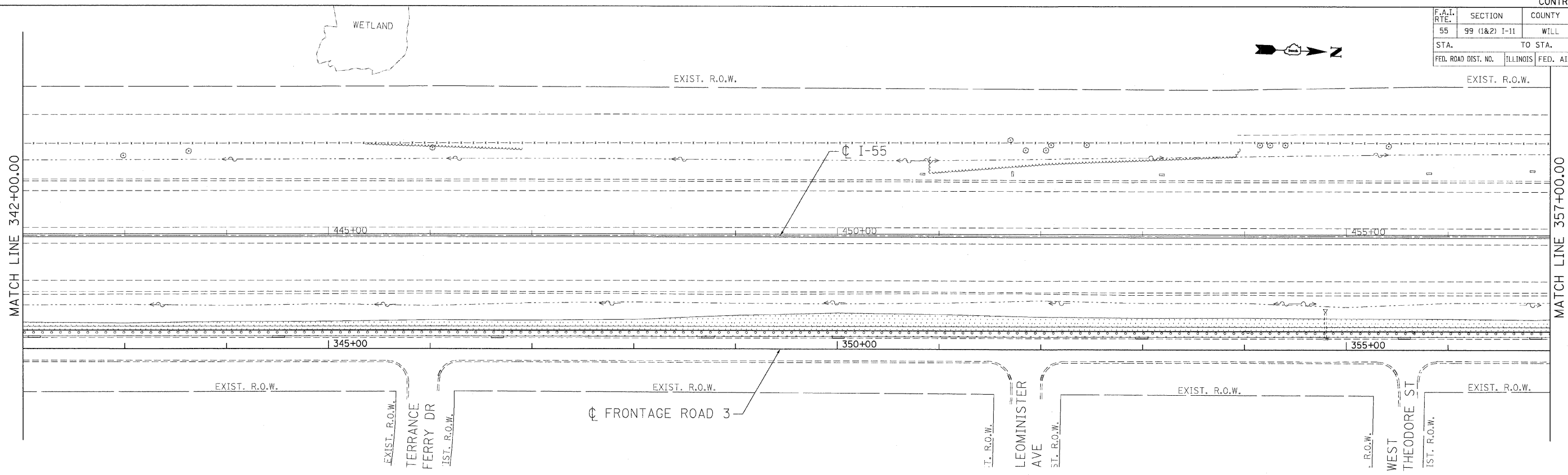

LEGEND

- SEEDING, CLASS 2A WITH TOPSOIL FURNISH AND PLACE, 6" AND EROSION CONTROL BLANKET
- SEEDING, CLASS 4 WITH TOPSOIL FURNISH AND PLACE, 6" AND EROSION CONTROL BLANKET

NOTE

SEE TYPICAL SECTION DETAILS SHEET 10 FOR LOCATION AND DETAILS OF COMPOST FURNISH AND PLACE AND VINES.

REVISIONS	
NAME	DATE

ILLINOIS DEPARTMENT OF TRANSPORTATION
 FAI ROUTE 55 (BLACK ROAD TO U.S. ROUTE 30)
 NOISE ABATEMENT WALLS

LANDSCAPING PLAN
FAI 55 - NOISE WALL 3
STA. 342+00.00 TO STA. 372+00.00

SCALE: 1"=50'
 DATE 02/06/09
 DRAWN BY JFS
 CHECKED BY DDH

TENG
 TENG & ASSOCIATES, INC.
 ENGINEERS/ARCHITECTS/PLANNERS
 CHICAGO, ILLINOIS

PLOT DATE = #DATE#
 FILE NAME = #FILE#
 USER NAME = #USER#
 \\NLS14801.DGN, \\NLS14802.DGN, \\NLS14803.DGN, \\NLS14804.DGN, \\NLS14805.DGN, \\NLS14806.DGN, \\NLS14807.DGN, \\NLS14808.DGN, \\NLS14809.DGN, \\NLS14810.DGN, \\NLS14811.DGN, \\NLS14812.DGN, \\NLS14813.DGN, \\NLS14814.DGN, \\NLS14815.DGN, \\NLS14816.DGN, \\NLS14817.DGN, \\NLS14818.DGN, \\NLS14819.DGN, \\NLS14820.DGN, \\NLS14821.DGN, \\NLS14822.DGN, \\NLS14823.DGN, \\NLS14824.DGN, \\NLS14825.DGN, \\NLS14826.DGN, \\NLS14827.DGN, \\NLS14828.DGN, \\NLS14829.DGN, \\NLS14830.DGN, \\NLS14831.DGN, \\NLS14832.DGN, \\NLS14833.DGN, \\NLS14834.DGN, \\NLS14835.DGN, \\NLS14836.DGN, \\NLS14837.DGN, \\NLS14838.DGN, \\NLS14839.DGN, \\NLS14840.DGN, \\NLS14841.DGN, \\NLS14842.DGN, \\NLS14843.DGN, \\NLS14844.DGN, \\NLS14845.DGN, \\NLS14846.DGN, \\NLS14847.DGN, \\NLS14848.DGN, \\NLS14849.DGN, \\NLS14850.DGN, \\NLS14851.DGN, \\NLS14852.DGN, \\NLS14853.DGN, \\NLS14854.DGN, \\NLS14855.DGN, \\NLS14856.DGN, \\NLS14857.DGN, \\NLS14858.DGN, \\NLS14859.DGN, \\NLS14860.DGN, \\NLS14861.DGN, \\NLS14862.DGN, \\NLS14863.DGN, \\NLS14864.DGN, \\NLS14865.DGN, \\NLS14866.DGN, \\NLS14867.DGN, \\NLS14868.DGN, \\NLS14869.DGN, \\NLS14870.DGN, \\NLS14871.DGN, \\NLS14872.DGN, \\NLS14873.DGN, \\NLS14874.DGN, \\NLS14875.DGN, \\NLS14876.DGN, \\NLS14877.DGN, \\NLS14878.DGN, \\NLS14879.DGN, \\NLS14880.DGN, \\NLS14881.DGN, \\NLS14882.DGN, \\NLS14883.DGN, \\NLS14884.DGN, \\NLS14885.DGN, \\NLS14886.DGN, \\NLS14887.DGN, \\NLS14888.DGN, \\NLS14889.DGN, \\NLS14890.DGN, \\NLS14891.DGN, \\NLS14892.DGN, \\NLS14893.DGN, \\NLS14894.DGN, \\NLS14895.DGN, \\NLS14896.DGN, \\NLS14897.DGN, \\NLS14898.DGN, \\NLS14899.DGN, \\NLS14900.DGN, \\NLS14901.DGN, \\NLS14902.DGN, \\NLS14903.DGN, \\NLS14904.DGN, \\NLS14905.DGN, \\NLS14906.DGN, \\NLS14907.DGN, \\NLS14908.DGN, \\NLS14909.DGN, \\NLS14910.DGN, \\NLS14911.DGN, \\NLS14912.DGN, \\NLS14913.DGN, \\NLS14914.DGN, \\NLS14915.DGN, \\NLS14916.DGN, \\NLS14917.DGN, \\NLS14918.DGN, \\NLS14919.DGN, \\NLS14920.DGN, \\NLS14921.DGN, \\NLS14922.DGN, \\NLS14923.DGN, \\NLS14924.DGN, \\NLS14925.DGN, \\NLS14926.DGN, \\NLS14927.DGN, \\NLS14928.DGN, \\NLS14929.DGN, \\NLS14930.DGN, \\NLS14931.DGN, \\NLS14932.DGN, \\NLS14933.DGN, \\NLS14934.DGN, \\NLS14935.DGN, \\NLS14936.DGN, \\NLS14937.DGN, \\NLS14938.DGN, \\NLS14939.DGN, \\NLS14940.DGN, \\NLS14941.DGN, \\NLS14942.DGN, \\NLS14943.DGN, \\NLS14944.DGN, \\NLS14945.DGN, \\NLS14946.DGN, \\NLS14947.DGN, \\NLS14948.DGN, \\NLS14949.DGN, \\NLS14950.DGN, \\NLS14951.DGN, \\NLS14952.DGN, \\NLS14953.DGN, \\NLS14954.DGN, \\NLS14955.DGN, \\NLS14956.DGN, \\NLS14957.DGN, \\NLS14958.DGN, \\NLS14959.DGN, \\NLS14960.DGN, \\NLS14961.DGN, \\NLS14962.DGN, \\NLS14963.DGN, \\NLS14964.DGN, \\NLS14965.DGN, \\NLS14966.DGN, \\NLS14967.DGN, \\NLS14968.DGN, \\NLS14969.DGN, \\NLS14970.DGN, \\NLS14971.DGN, \\NLS14972.DGN, \\NLS14973.DGN, \\NLS14974.DGN, \\NLS14975.DGN, \\NLS14976.DGN, \\NLS14977.DGN, \\NLS14978.DGN, \\NLS14979.DGN, \\NLS14980.DGN, \\NLS14981.DGN, \\NLS14982.DGN, \\NLS14983.DGN, \\NLS14984.DGN, \\NLS14985.DGN, \\NLS14986.DGN, \\NLS14987.DGN, \\NLS14988.DGN, \\NLS14989.DGN, \\NLS14990.DGN, \\NLS14991.DGN, \\NLS14992.DGN, \\NLS14993.DGN, \\NLS14994.DGN, \\NLS14995.DGN, \\NLS14996.DGN, \\NLS14997.DGN, \\NLS14998.DGN, \\NLS14999.DGN, \\NLS15000.DGN