

PRE-STAGE (IL ROUTE 394):

1. REMOVE EXISTING SHOULDER RUMBLE STRIPS, CONFLICTING EXISTING PAVEMENT MARKINGS, AND EXISTING RAISED REFLECTIVE PAVEMENT MARKER LENSES FROM STA. 285+84 TO STA. 302+32 AS SHOWN IN THE PLANS, AND PLACE TEMPORARY PAVEMENT MARKINGS IN ACCORDANCE WITH HIGHWAY STANDARD 701400 & 701406.
2. PROVIDE MULTI-LANE WEAVE IN ACCORDANCE WITH HIGHWAY STANDARD TC-09 AND AS SHOWN BELOW.
3. IL ROUTE 394 TEMPORARY TRAFFIC CONFIGURATION TO REMAIN IN PLACE THROUGHOUT DURATION OF CONSTRUCTION.
4. UPON COMPLETION OF CONSTRUCTION AND REMOVAL OF TRAFFIC CONTROL, PROVIDE PROPOSED PAVEMENT MARKINGS AND REFLECTOR LENSES TO REVERT TO EXISTING MARKINGS CONFIGURATION, AND REPLACE SHOULDER RUMBLE STRIPS AT PREVIOUS EXISTING DIMENSIONS IN ACCORDANCE WITH HIGHWAY STANDARDS 701400 AND 701406.
5. THIS WORK SHALL BE INCLUDED IN THE COST PER LUMP SUM FOR TRAFFIC CONTROL AND PROTECTION (EXPRESSWAYS).

NB STA. SB STA.

ROAD CONSTRUCTION 1 MILE
W20-I103(O)-48
354+32 233+84

HIT A WORKER
\$ 10,000 FINE
14 YRS JAIL
344+32 243+84

W24-1
WORK ZONE
SPEED LIMIT
55
BEGINS
S375 FINE MINIMUM
W2-I115(O)-3618
R2-1-3648
W2-I113(O)-3612
R2-I106-3618
334+32 253+84

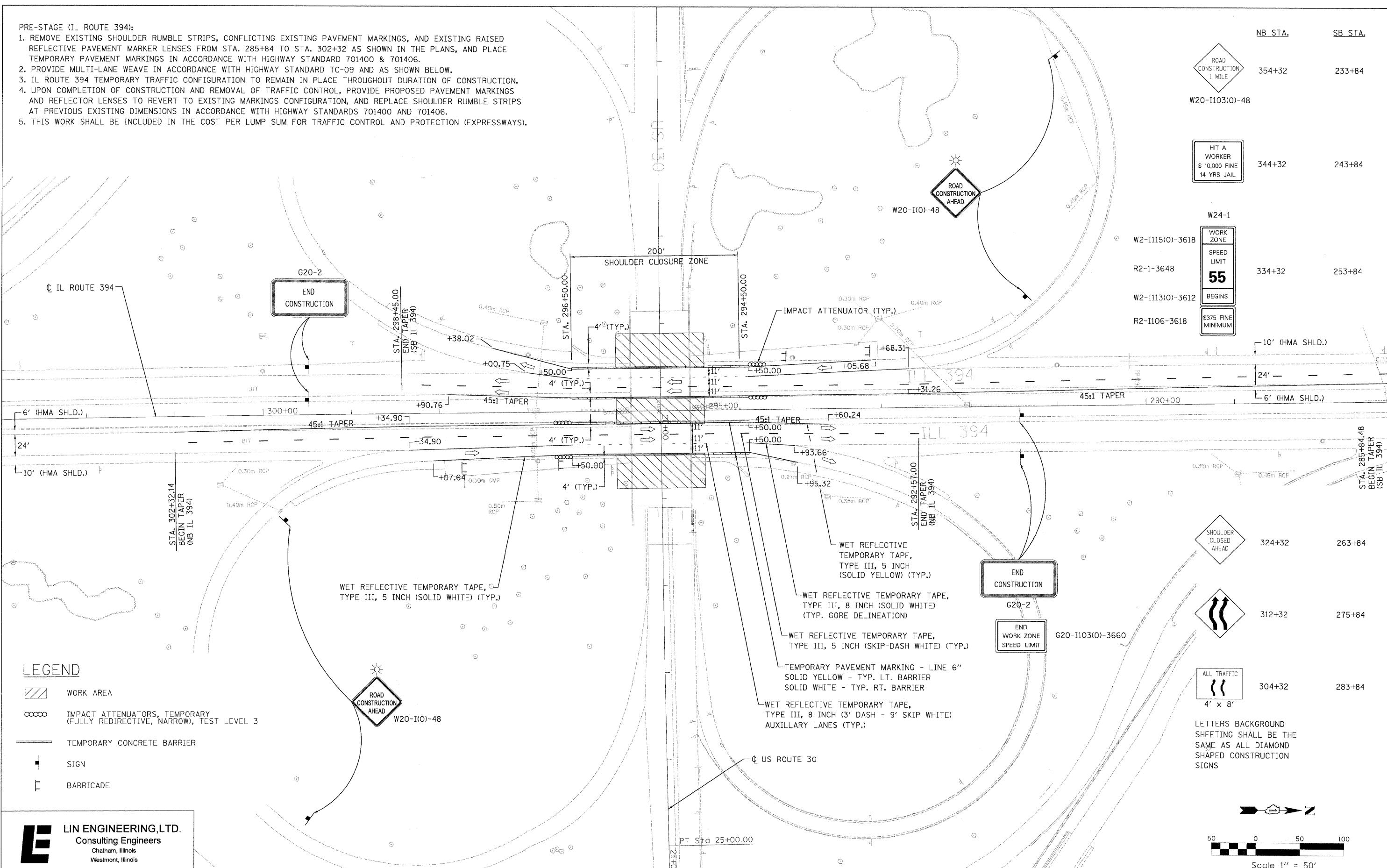

LEGEND

- WORK AREA
- IMPACT ATTENUATORS, TEMPORARY (FULLY REDIRECTIVE, NARROW), TEST LEVEL 3
- TEMPORARY CONCRETE BARRIER
- SIGN
- BARRICADE

LIN ENGINEERING, LTD.
Consulting Engineers
Chatham, Illinois
Westmont, Illinois

SHOULDER CLOSED AHEAD
324+32 263+84
ROAD CONSTRUCTION AHEAD
312+32 275+84
ALL TRAFFIC
4' x 8'
304+32 283+84

LETTERS BACKGROUND SHEETING SHALL BE THE SAME AS ALL DIAMOND SHAPED CONSTRUCTION SIGNS

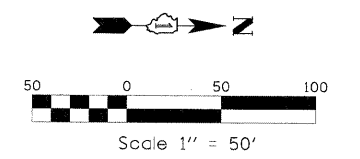

FILE NAME = ...NDIG005-SHT-Stage-Prestage2.dgn	USER NAME = Plotted by Administrator	DESIGNED - ST	REVISED -	STATE OF ILLINOIS DEPARTMENT OF TRANSPORTATION	MAINTENANCE OF TRAFFIC - IL ROUTE 394 US ROUTE 30 OVER IL ROUTE 394			F.A.P. RTE. 0353	SECTION 0303.1B-1	COUNTY COOK	TOTAL SHEETS 91	SHEET NO. 14			
PLOT SCALE = 50.00' / IN.	CHECKED - FML	REVISED -	REVISED -					SCALE: 1" = 50'	SHEET NO. OF SHEETS	STA. TO STA.	CONTRACT NO. 60C05				
PLOT DATE = 5/5/2009	DATE - 05/2009	REVISED -	REVISED -					FED. ROAD DIST. NO. ILLINOIS FED. AID PROJECT							