

ROUTE	SECTION	COUNTY	TOTAL SHEETS	SHEET NUMBER
VARIOUS	2008-053 BP	VARIOUS	54	9

CONTRACT NO. 60F04

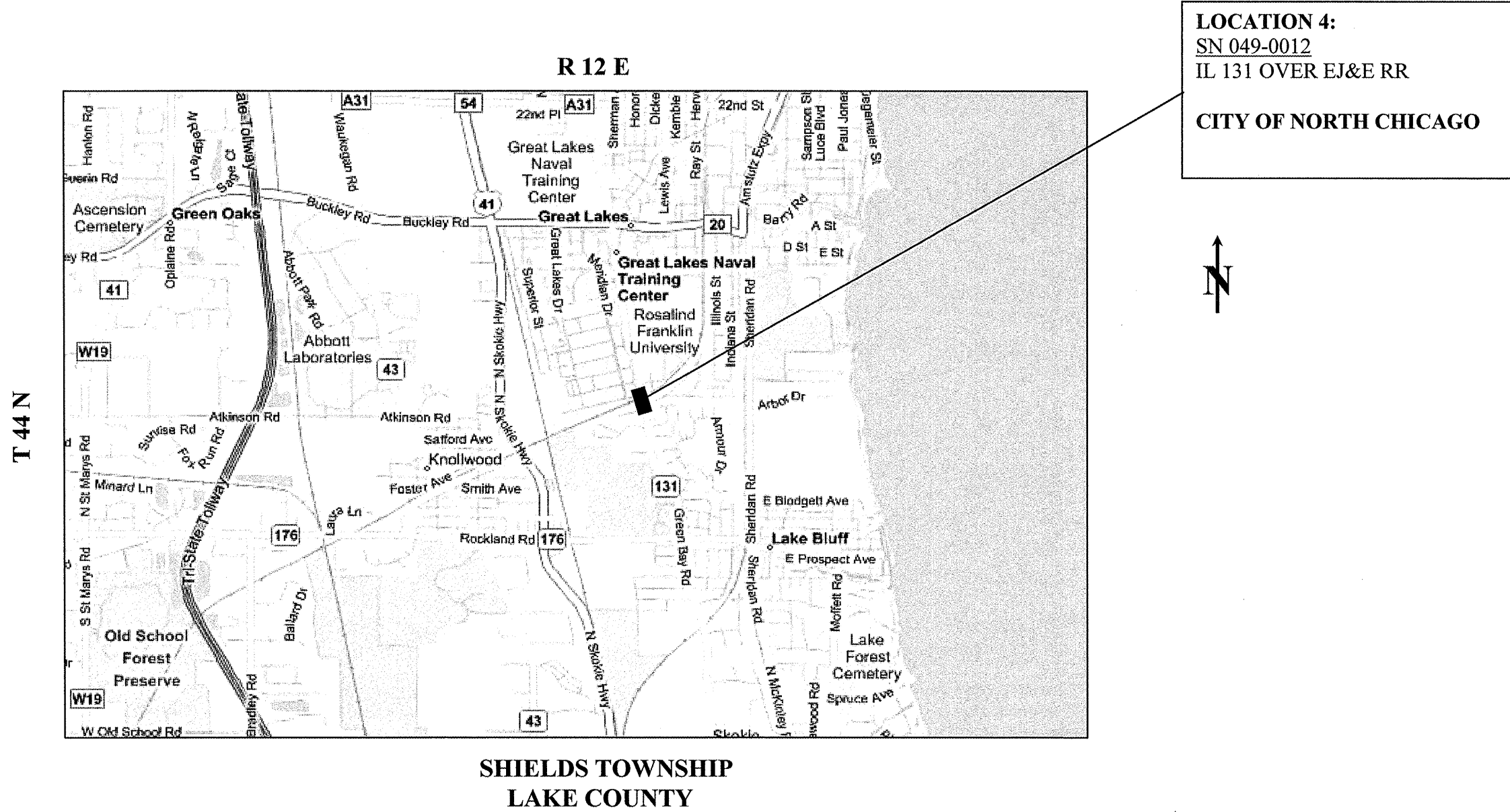

<b>TRAFFIC DATA: IL 131</b>	
2007 ADT	= 11,800
POSTED SPEED LIMIT	= 40 MPH

ILLINOIS DEPARTMENT OF TRANSPORTATION

**LOCATION MAPS**

LOCATION 4: IL 131 OVER EJ&E RR