

ROUTE	SECTION	COUNTY	TOTAL SHEETS	SHEET NUMBER
VARIOUS	2008-053 BP	VARIOUS	54	16

CONTRACT NO. 60F04

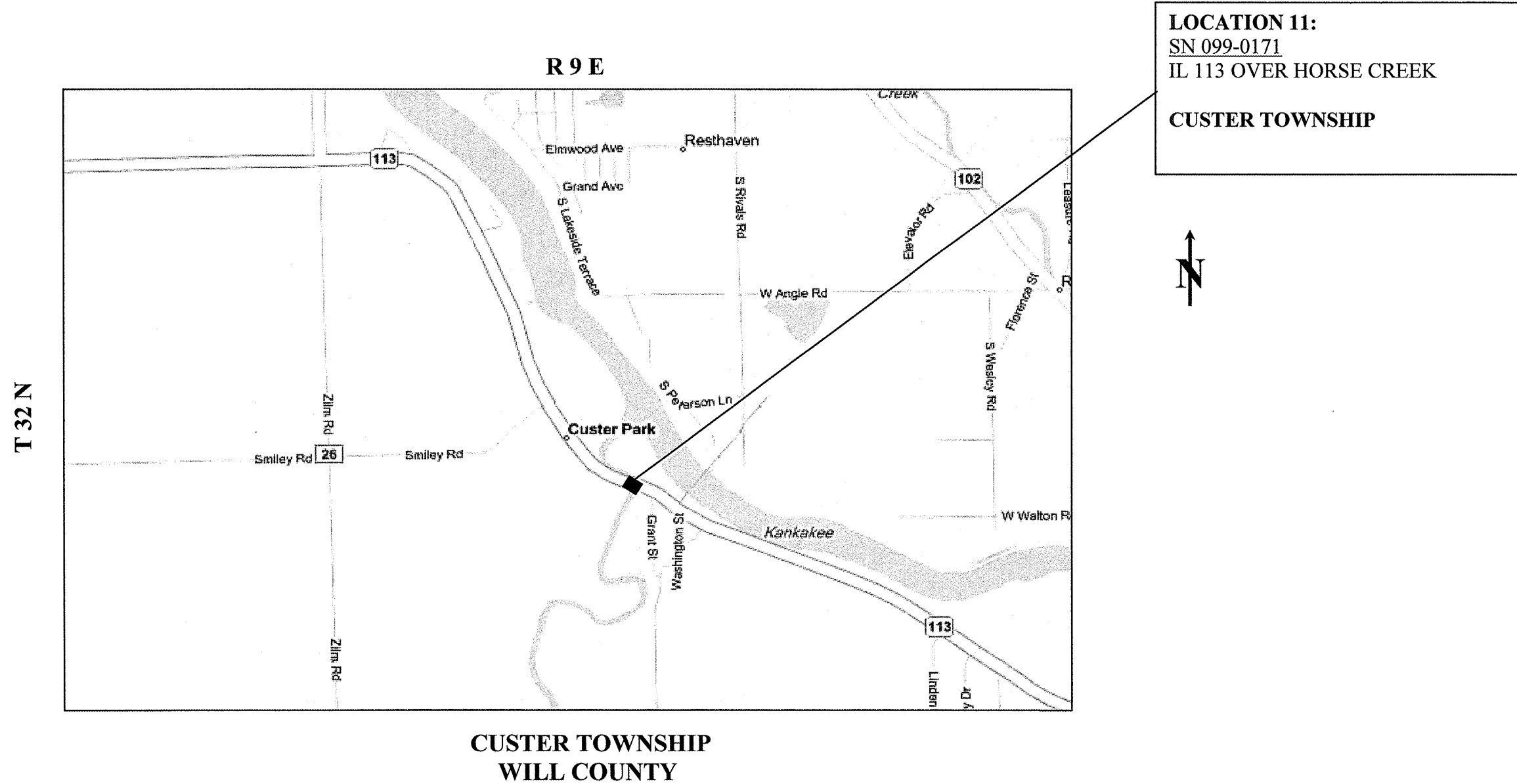

LOCATION 11:
SN 099-0171
 IL 113 OVER HORSE CREEK
CUSTER TOWNSHIP



TRAFFIC DATA: IL 113
 2007 ADT = 3,700
 POSTED SPEED LIMIT = 55 MPH

ILLINOIS DEPARTMENT OF TRANSPORTATION
LOCATION MAPS
 LOCATION 11: IL 113 OVER HORSE CREEK