

ROUTE	SECTION	COUNTY	TOTAL SHEETS	SHEET NUMBER
VARIOUS	2008-053 BP	VARIOUS	54	28

CONTRACT NO. 60F04

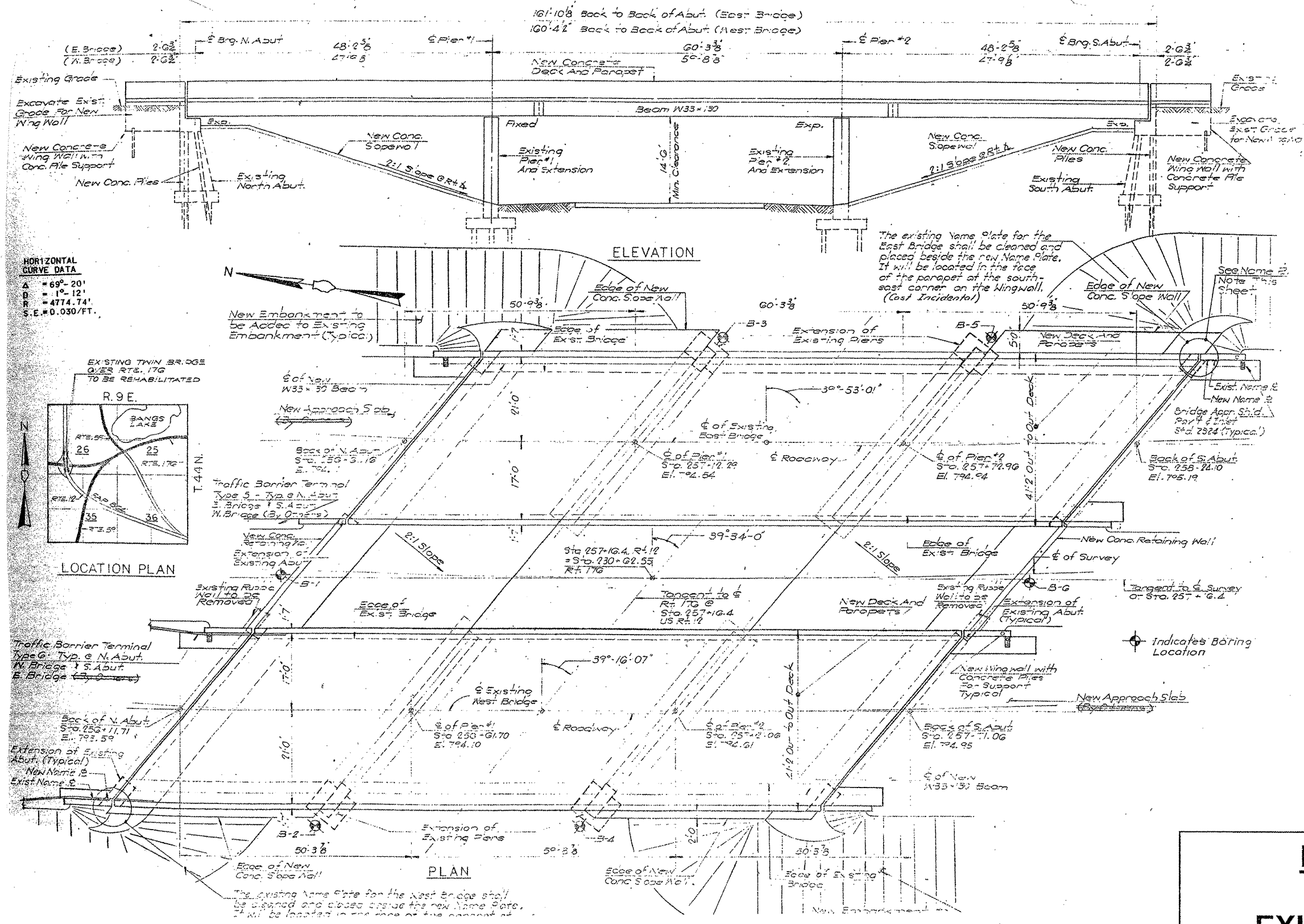

HORIZONTAL CURVE DATA
 Δ = 69°-20'
 D = 1°-12'
 R = 4774.74'
 S.E. = 0.030/FT.

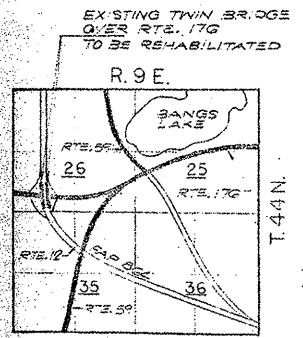

LOCATION NO. 5

EXIST. BRIDGE PLANS
US 12 NB & SB OVER IL 176
SN'S 049-0022, 049-0023