

F.A.U. RTE.	SECTION	COUNTY	TOTAL SHEETS	SHEET NO.
1467	3245 RS-4	COOK	35	1
FED. ROAD DIST. NO. 1		ILLINOIS	CONTRACT NO. 60F51	

STATE OF ILLINOIS
DEPARTMENT OF TRANSPORTATION
DIVISION OF HIGHWAYS

**PROPOSED
HIGHWAY PLANS**

F.A.U. ROUTE 1467 /31ST STREET
WOLF ROAD TO IL 171
SECTION: 3245 RS-4
RESURFACING (3P)
PROJECT: *ESP-1467(007)*
COOK COUNTY
C-91-082-09

FOR INDEX OF SHEETS, SEE SHEET NO. 2

D-91-082-09



PROJECT IS LOCATED IN THE VILLAGES OF
WESTCHESTER, BROOKFIELD & LAGRANGE PARK

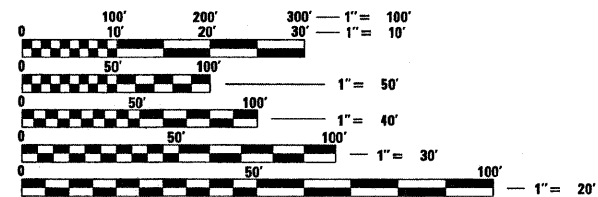

FULL SIZE PLANS HAVE BEEN PREPARED USING STANDARD ENGINEERING SCALES. REDUCED SIZED PLANS WILL NOT CONFORM TO STANDARD SCALES. IN MAKING MEASUREMENTS ON REDUCED PLANS, THE ABOVE SCALES MAY BE USED.

J.U.L.I.E.
JOINT UTILITY LOCATION INFORMATION FOR EXCAVATION
1-800-892-0123
OR 811

PROJECT BEGINS STA. 96+88

PROJECT ENDS STA. 291+23

OMISSION:
FROM STA. 142+92 TO STA. 144+37
FROM STA. 193+20 TO STA. 193+54
FROM STA. 252+86 TO STA. 255+04

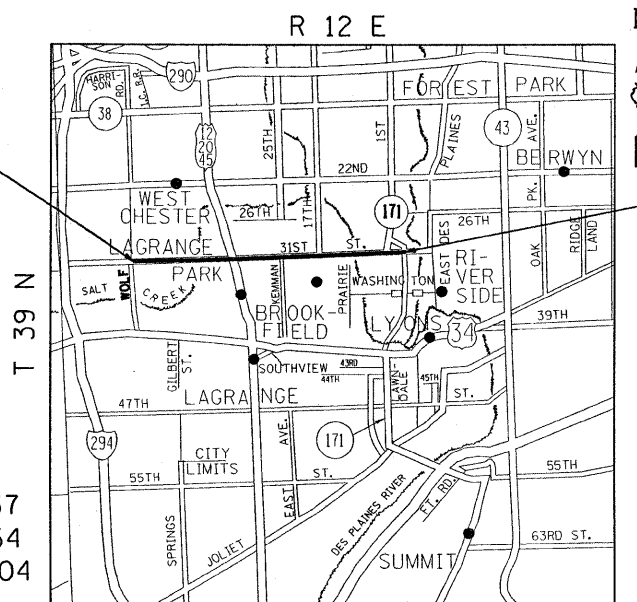

TRAFFIC DATA
SPEED LIMIT: 30MPH & 35 MPH
2006 ADT: 14,500

PROJECT ENGINEER: DAN WILGREEN (847) 705-4240
PROJECT MANAGER: KEN ENG

CONTRACT NO. 60F51

PROVISO & RIVERSIDE TOWNSHIP

GROSS LENGTH OF PROJECT = 19,435 FEET (3.68 MILES)
NET LENGTH OF PROJECT = 19,038 FEET (3.61 MILES)

STATE OF ILLINOIS
DEPARTMENT OF TRANSPORTATION
DIVISION OF HIGHWAYS

SUBMITTED MAY 5, 2009

Diana M. O'Keefe
DEPUTY DIRECTOR OF HIGHWAYS, REGION ENGINEER

June 26, 2009
Charles J. Ingersoll
ENGINEER OF DESIGN AND ENVIRONMENT

June 26, 2009
Christine M. Reed
DIRECTOR OF HIGHWAYS, CHIEF ENGINEER

**PRINTED BY THE AUTHORITY
OF THE STATE OF ILLINOIS**