

SHEET SA2 of SA110

F.A.U. RTE.	SECTION	COUNTY	TOTAL SHEETS	SHEET NO.
3578	15 VB-1-F	COOK	62	4
STA.	TO STA.			
FED. ROAD DIST. NO.	ILLINOIS	FED. AID PROJECT		
CONTRACT NO. 60H54				

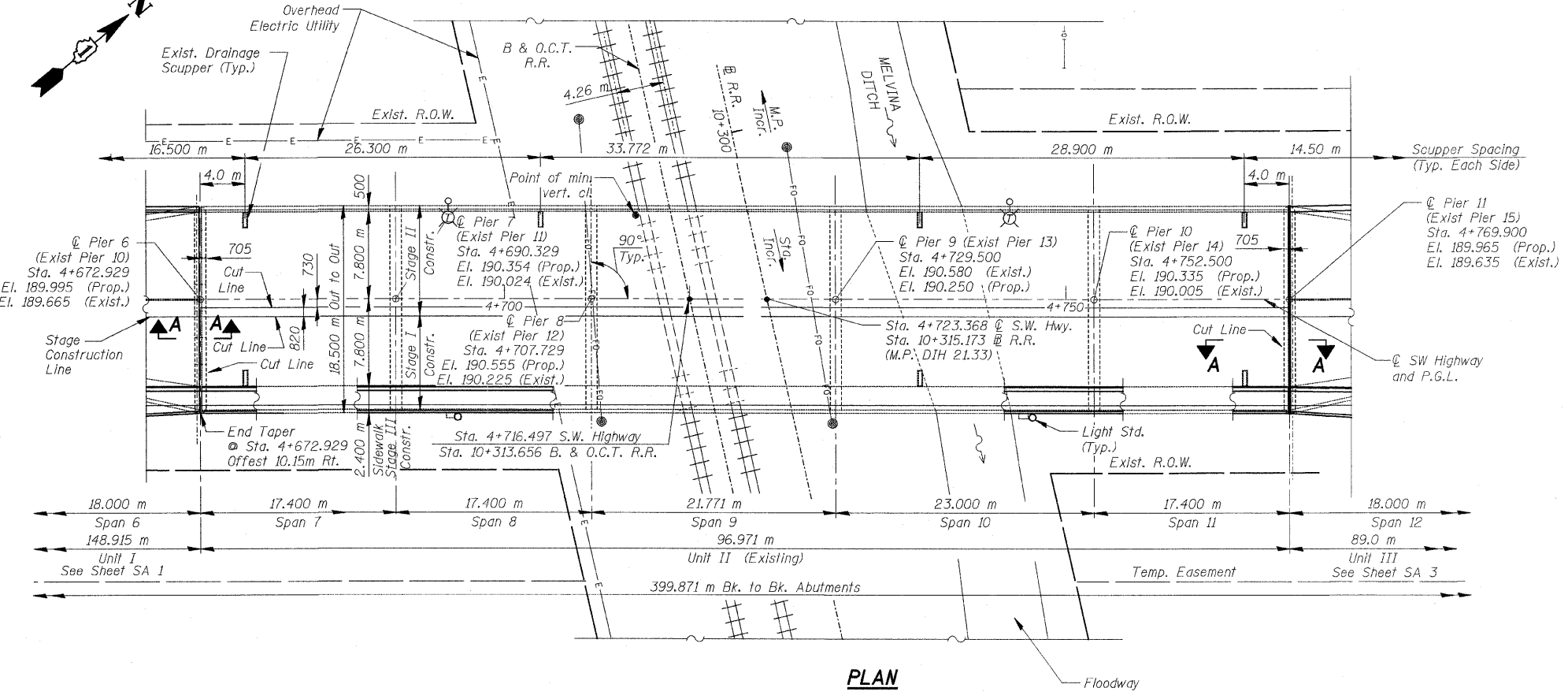

J:\vermillion\rdwy_lisle\5/29/2009 10:51:02 PM q:\dort\9856_cad\draw\ings\struc\yfabr\location_plans\02_FAB_page2.dgn

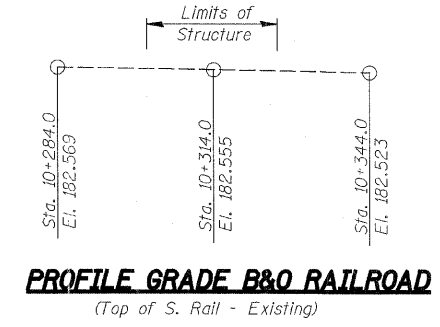
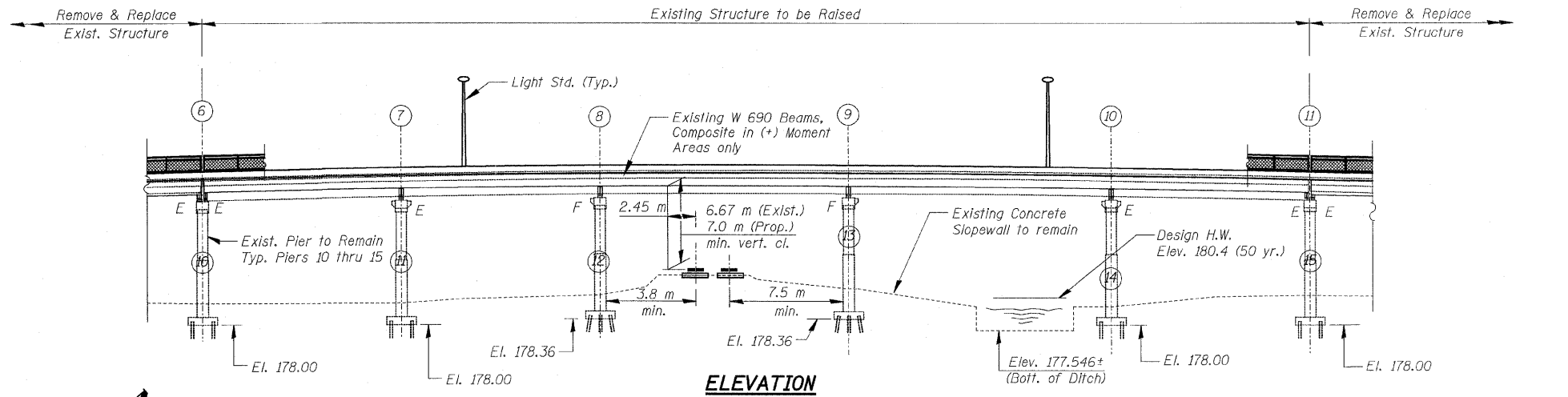

REVISIONS		ILLINOIS DEPARTMENT OF TRANSPORTATION GENERAL PLAN AND ELEVATION UNIT II SOUTHWEST HIGHWAY OVER B&O RAILROAD AND STONY CREEK FAU 3578 SECTION 15 VB-1-F STRUCTURE NUMBER 016-2771 COOK COUNTY STATION 4+716.497
NAME	DATE	

SCALE: NONE DATE: MAY 22, 2009
DRAWN BY: E. Mroczek
CHECKED BY: G. Hatlestad