

SECTION	COUNTY	TOTAL SHEETS	SHEET NO.
352 (EMD) B-4	LAKE	41	18
STA. TO STA.		FED. ROAD DIST. NO. 1	
		FED. AID PROJECT	

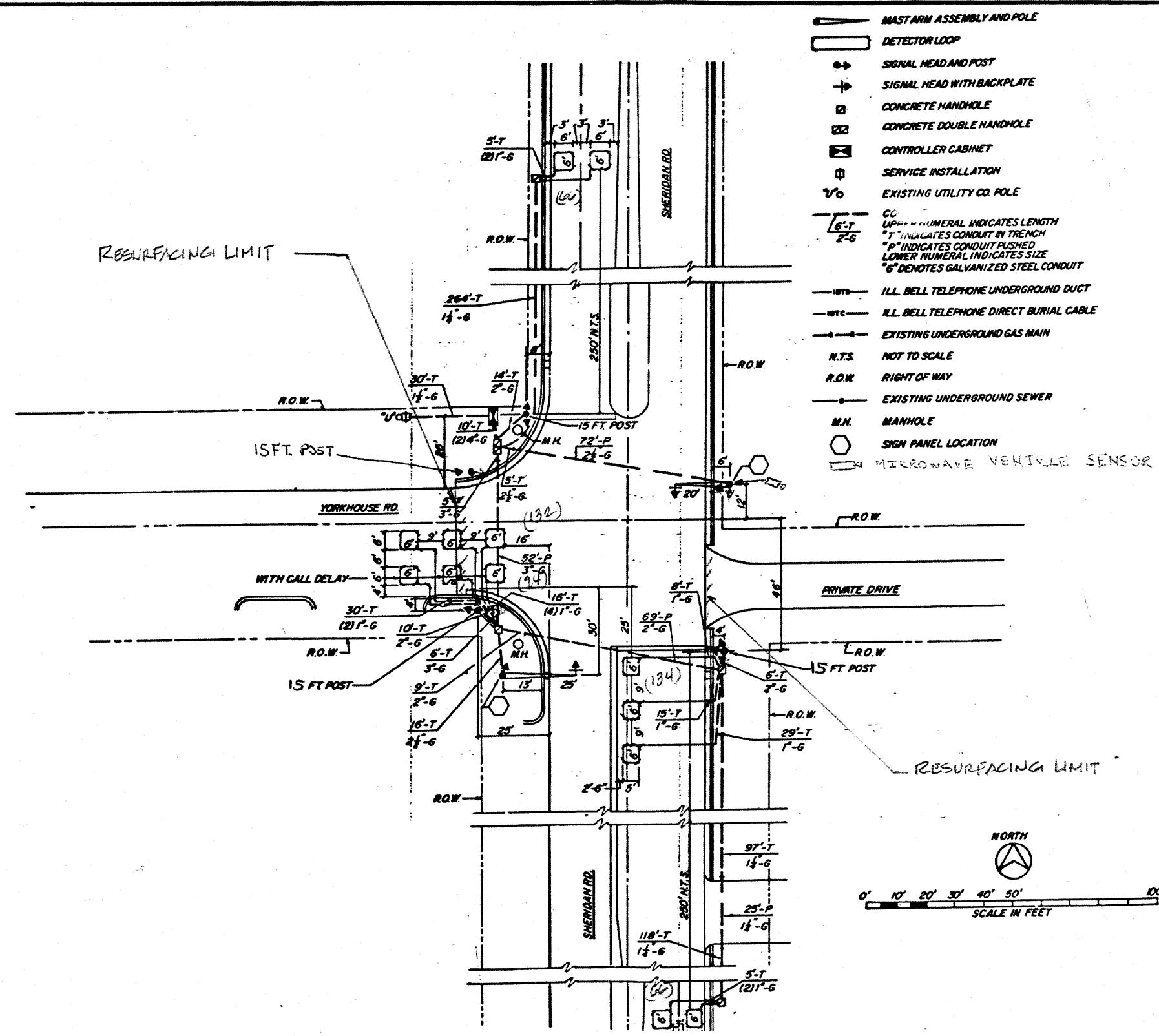

- MAST ARM ASSEMBLY AND POLE
- DETECTOR LOOP
- SIGNAL HEAD AND POST
- SIGNAL HEAD WITH BACKPLATE
- CONCRETE HANDHOLE
- CONCRETE DOUBLE HANDHOLE
- CONTROLLER CABINET
- SERVICE INSTALLATION
- EXISTING UTILITY CO. POLE
- CO. NUMERAL INDICATES LENGTH  
"T" INDICATES CONDUIT IN TRENCH  
"P" INDICATES CONDUIT PUSHED  
LOWER NUMERAL INDICATES SIZE  
"G" DENOTES GALVANIZED STEEL CONDUIT
- ILL. BELL TELEPHONE UNDERGROUND DUCT
- ILL. BELL TELEPHONE DIRECT BURIAL CABLE
- EXISTING UNDERGROUND GAS MAIN
- N.T.S. NOT TO SCALE
- R.O.W. RIGHT OF WAY
- EXISTING UNDERGROUND SEWER
- M.H. MANHOLE
- SIGN PANEL LOCATION
- MICROWAVE VEHICLE SENSOR

**REPLACE ALL DETECTOR LOOPS AS SHOWN**

(WITHIN THE RESURFACING LIMITS)

CODE NO.	QUANTITY	UNIT	ITEM
86600600	492	Foot	Detector Loop Replacement

REVISIONS	
NAME	DATE

**NOTE:**  
THIS PLAN IS FOR THE PURPOSE OF REPLACING THE DETECTOR LOOPS ONLY. ALL OTHER INFORMATION SHOWN IS NOT RELATED AND WILL BE DISREGARDED.

ILLINOIS DEPARTMENT OF TRANSPORTATION  
**DETECTOR LOOP REPLACEMENT**  
SHERIDAN RD. @ YORKHOUSE RD.  
SCALE: NONE  
DATE: JAN. 2007  
DRAWN BY: JHE.  
DESIGNED BY: JHE.  
CHECKED BY: DAD.