

PROFILE	SURVEYED	BY	DATE
NOTE BOOK	GRADES CHECKED		
NO.	DATE		

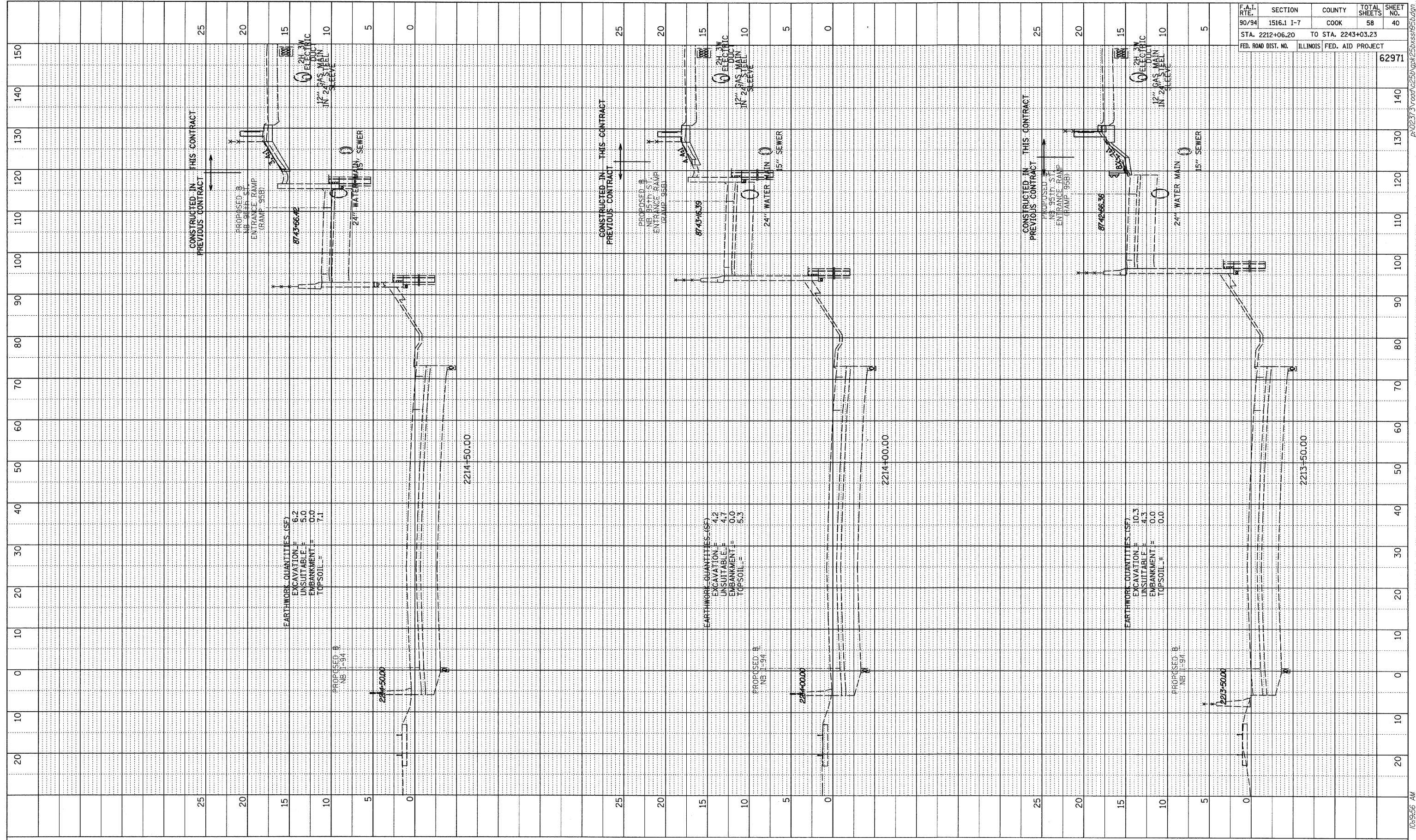

F.A.I. RTE.	SECTION	COUNTY	TOTAL SHEETS	SHEET NO.
90/94	1516.1 I-7	COOK	58	40
STA. 2212+06.20		TO STA. 2243+03.23		
FED. ROAD DIST. NO.	ILLINOIS	FED. AID PROJECT	62971	

TYLIN INTERNATIONAL

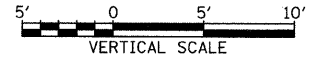
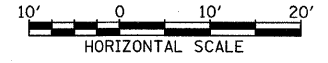

NB I-94 (DAN RYAN EXPRESSWAY)
STA. 2213+50 TO STA. 2214+50

10/17/2008 10:56 AM P:\0237\3\road\255\gpk25\Drawn\95.dwg