

F.A.I. RTE.	SECTION	COUNTY	TOTAL SHEETS	SHEET NO.
94	1717 I-6	COOK	60	17
STA. 2265+32.63 TO STA. 2287+21.27				
FED. ROAD DIST. NO.		ILLINOIS FED. AID PROJECT		

62973

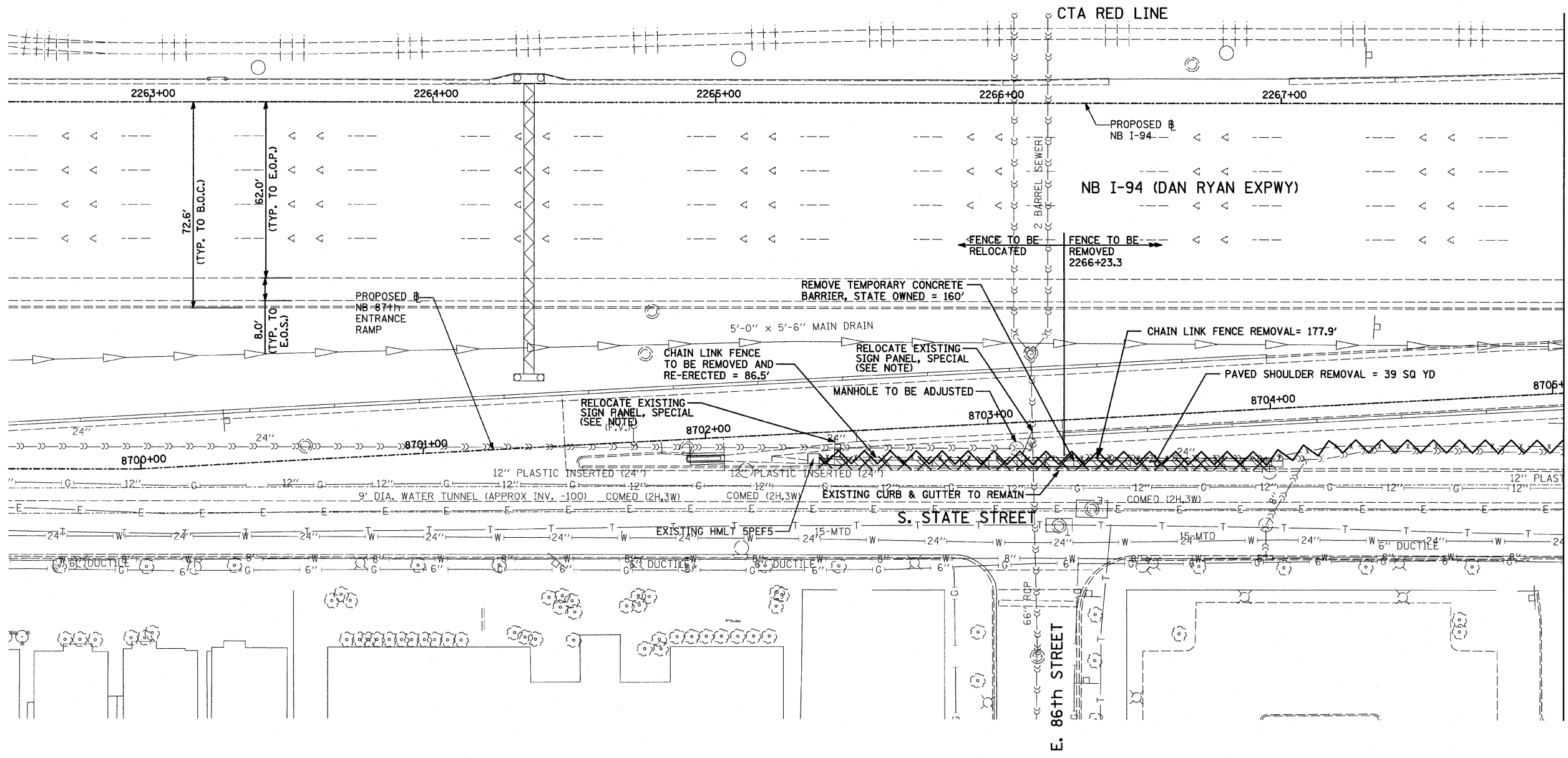

MATCHLINE NB STA. 2268+00.00

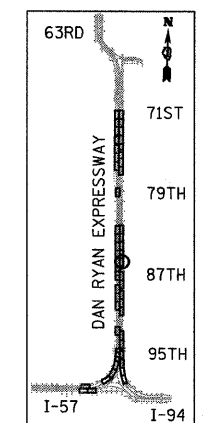

LOCATION MAP

LEGEND:

- PAVED SHOULDER REMOVAL
- CHAIN LINK FENCE REMOVAL
- CONCRETE BARRIER/GUARDRAIL REMOVAL
- TREE REMOVAL (UNITS) (NO UNIT SHOWN = 6)
- COMB CONC CURB & GUTTER REMOVAL

NOTE:

SIGNS SHALL BE RELOCATED AT A MINIMUM OF 3 FEET FROM THE FRONT FACE OF THE PROPOSED KNEE WALL. EXACT PLACEMENT SHALL BE DETERMINED BY THE ENGINEER. PAID FOR AS "RELOCATE EXISTING SIGN PANEL, SPECIAL".

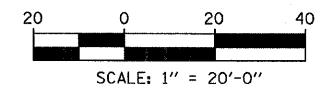

REVISIONS	
NAME	DATE

ILLINOIS DEPARTMENT OF TRANSPORTATION
 F.A.I. 94 (DAN RYAN EXPRESSWAY)
REMOVAL PLAN
 NB I-94 (DAN RYAN EXPRESSWAY)
 STA. 2262+50.00 TO 2268+00.00

SCALE: 1"=20'
 DATE: OCTOBER 17, 2008

DRAWN BY: AMB, MAF, TB
 CHECKED BY: TGB, MI

TYLIN INTERNATIONAL

P:\0237\3\road\250\p250.dwg 10/17/2008 1:28:45 AM