

F.A.I. RTE.	SECTION	COUNTY	TOTAL SHEETS	SHEET NO.
94	1818 I-6	COOK	42	20
STA. 2327+79.39 TO STA. 2338+67.22		ILLINOIS FED. AID PROJECT		
FED. ROAD DIST. NO.		62974		

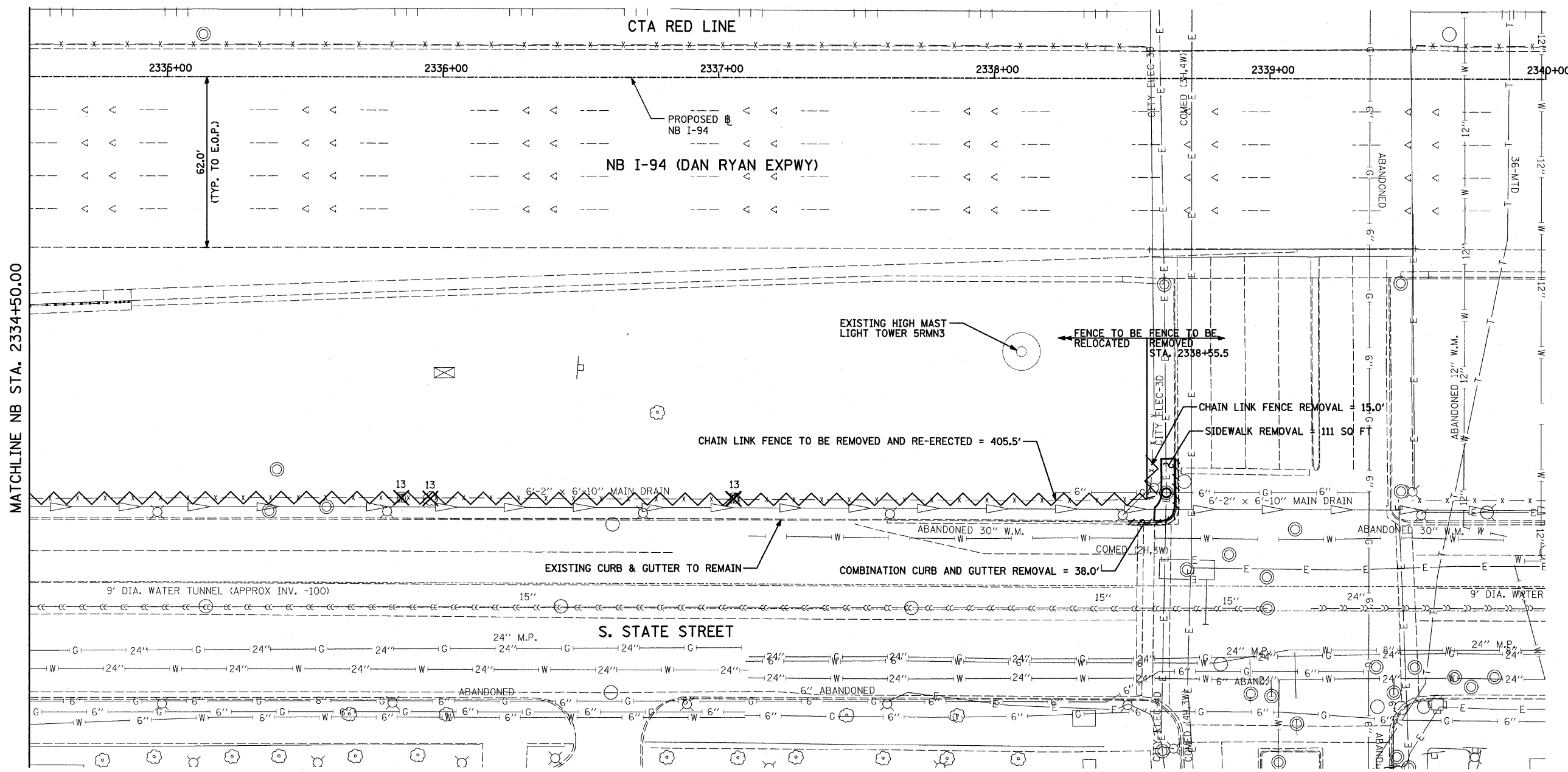

MATCHLINE NB STA. 2334+50.00

W. 75TH STREET

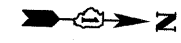
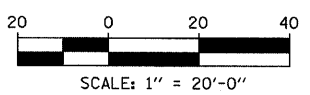
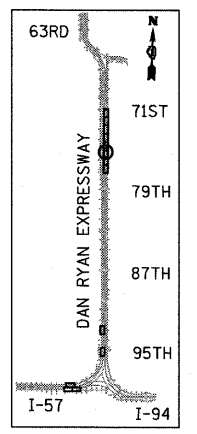

**LEGEND:**

- PAVED SHOULDER REMOVAL
- COMB CONC CURB & GUTTER REMOVAL
- CHAIN LINK FENCE REMOVAL
- CONCRETE BARRIER/GUARDRAIL REMOVAL
- TREE REMOVAL (UNITS) (NO UNIT SHOWN = 6)

**NOTE:**

SIGNS SHALL BE RELOCATED AT A MINIMUM OF 3 FEET FROM THE FRONT FACE OF THE PROPOSED KNEE WALL OR MOUNTED TO THE FRONT FACE OF THE RECONSTRUCTED PARAPET. EXACT PLACEMENT SHALL BE DETERMINED BY THE ENGINEER. PAID FOR AS "RELOCATED EXISTING SIGN PANEL, SPECIAL".

**TYLIN** INTERNATIONAL

REVISIONS	
NAME	DATE

ILLINOIS DEPARTMENT OF TRANSPORTATION  
**F.A.I. 94 (DAN RYAN EXPRESSWAY)**  
**REMOVAL PLAN**  
**NB I-94 (DAN RYAN EXPRESSWAY)**  
**STA. 2334+50.00 TO STA. 2340+00.00**  
 SCALE: 1"=20'  
 DATE: FEBRUARY 13, 2009  
 DRAWN BY: AMB, MAF  
 CHECKED BY: TGB, MI

P:\023731\road\235e\lpr2\sheet05.dgn 3/19/2009 12:28:58 PM