

|                     |          |                    |              |           |
|---------------------|----------|--------------------|--------------|-----------|
| F.A.I. RTE.         | SECTION  | COUNTY             | TOTAL SHEETS | SHEET NO. |
| 94                  | 1818 I-7 | COOK               | 58           | 17        |
| STA. 2339+42.81     |          | TO STA. 2364+99.12 |              |           |
| FED. ROAD DIST. NO. | ILLINOIS | FED. AID PROJECT   |              |           |

62975

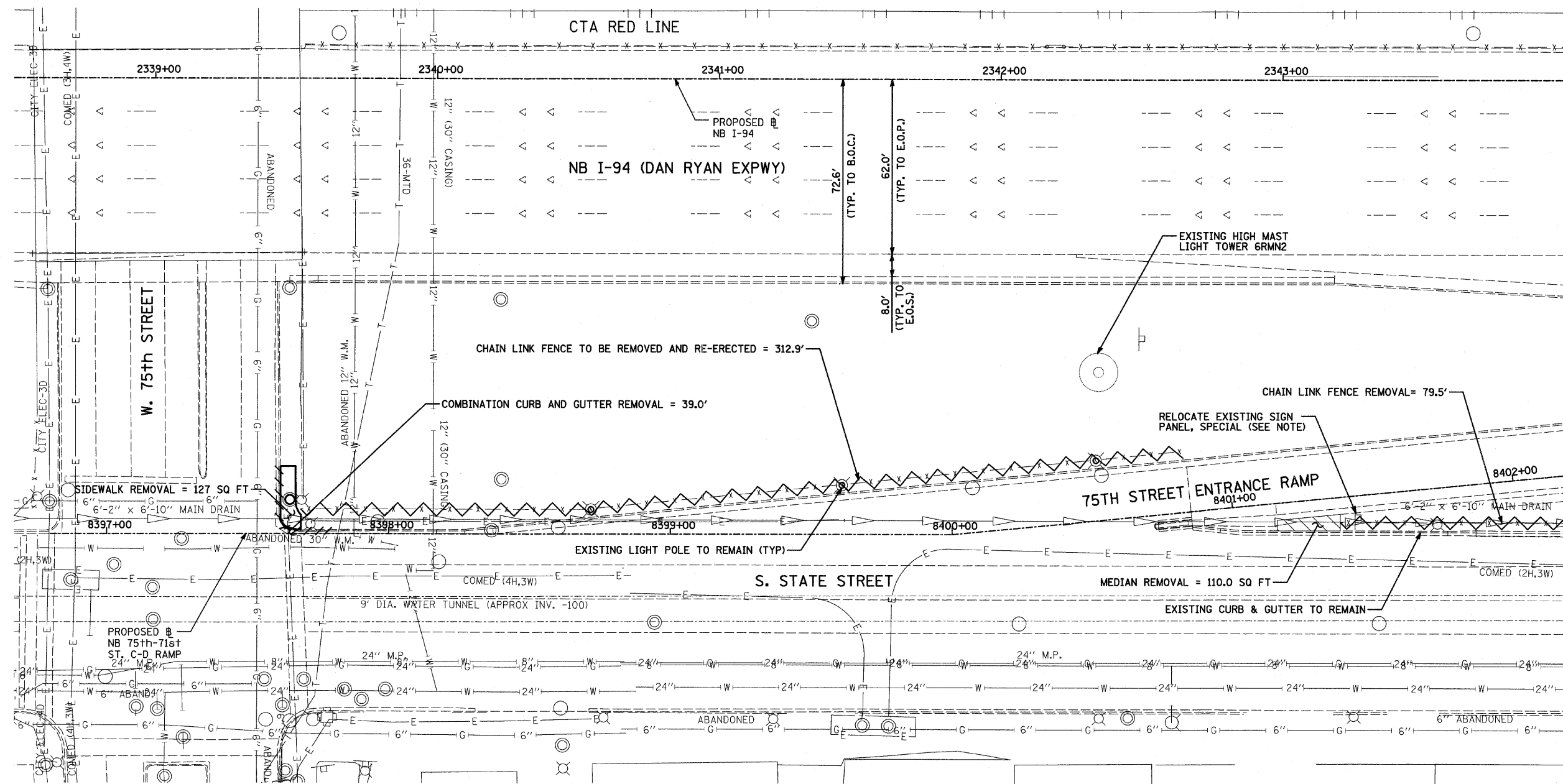

MATCHLINE NB STA. 2344+00.00

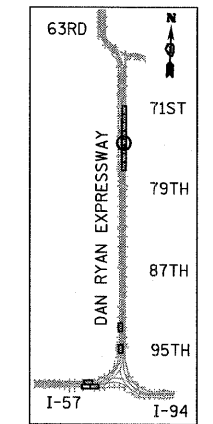

LOCATION MAP

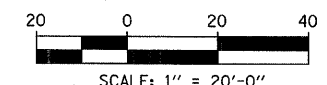

- LEGEND:**
- PAVED SHOULDER/ MEDIAN REMOVAL
  - COMB CONC CURB & GUTTER REMOVAL
  - CHAIN LINK FENCE REMOVAL
  - CONCRETE BARRIER/ GUARDRAIL REMOVAL
  - TREE REMOVAL (UNITS) (NO UNIT SHOWN = <6)

**NOTE:**  
SIGNS SHALL BE RELOCATED AT A MINIMUM OF 3 FEET FROM THE FRONT FACE OF THE PROPOSED KNEE WALL. EXACT PLACEMENT SHALL BE DETERMINED BY THE ENGINEER. PAID FOR AS "RELOCATE EXISTING SIGN PANEL, SPECIAL".

**TYLIN** INTERNATIONAL

| REVISIONS |      |
|-----------|------|
| NAME      | DATE |
|           |      |
|           |      |
|           |      |
|           |      |
|           |      |
|           |      |
|           |      |
|           |      |
|           |      |
|           |      |

ILLINOIS DEPARTMENT OF TRANSPORTATION  
**F.A.I. 94 (DAN RYAN EXPRESSWAY)**  
**REMOVAL PLAN**  
**NB I-94 (DAN RYAN EXPRESSWAY)**  
**STA. 2338+50.00 TO 2344+00.00**  
 SCALE: 1"=20'  
 DATE: FEBRUARY 13, 2009  
 DRAWN BY: AMB, MAF, TB  
 CHECKED BY: TGB, MI

DATE PLOTTED: 3/19/2009 2:14:44 PM