

PROFILE SURVEYED BY DATE
 (DATE) (BY) (DATE)
 NOTE BOOK NO. CHECKED
 (NO.) (NO.) (NO.)
 STRUCTURE NOTATIONS CHFD

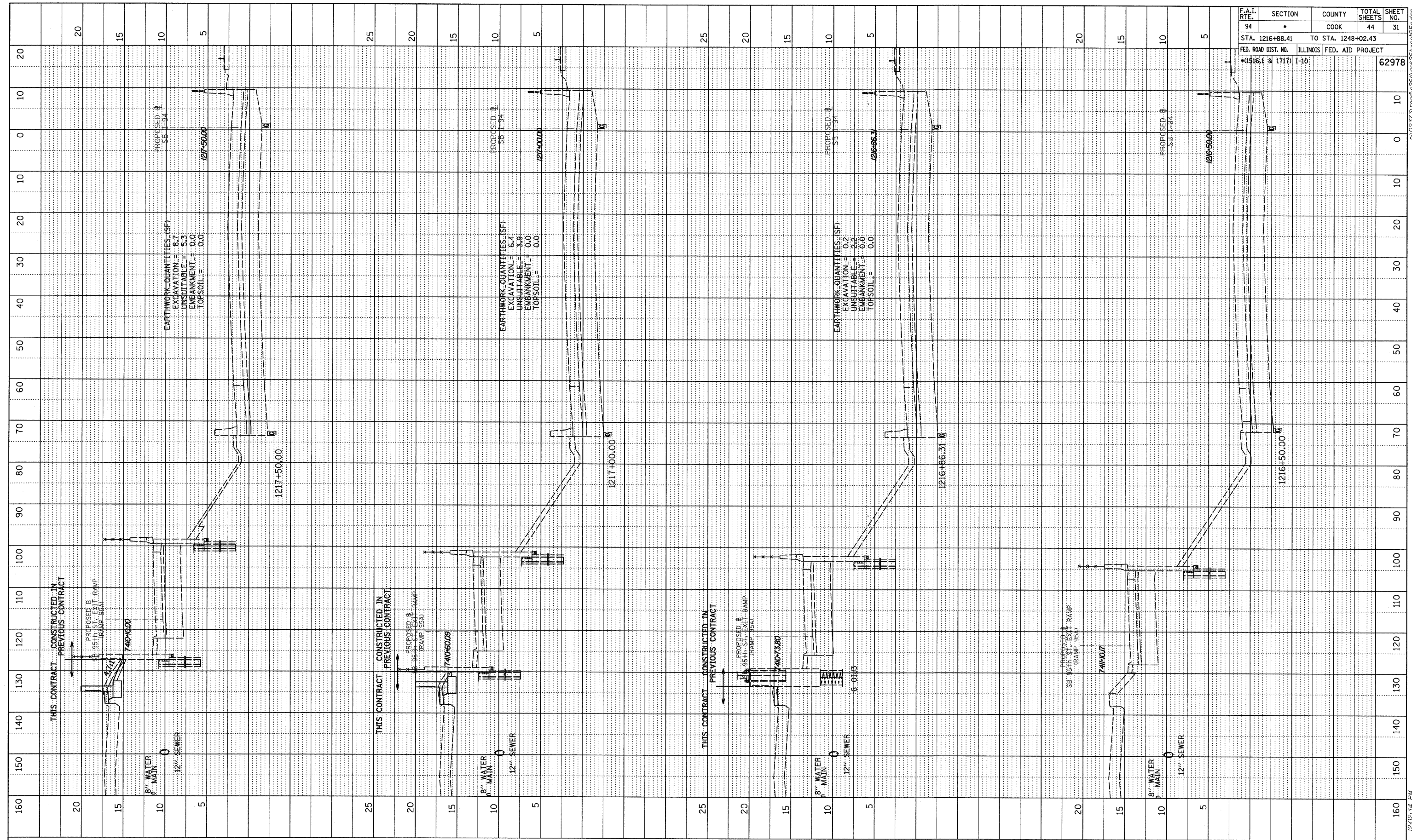

F.A.I. RTE.	SECTION	COUNTY	TOTAL SHEETS	SHEET NO.
94	*	COOK	44	31
STA. 1216+88.41		TO STA. 1248+02.43		
FED. ROAD DIST. NO. ILLINOIS		FED. AID PROJECT		
*(1516.1 & 1717)		1-10		62978

TYLIN INTERNATIONAL

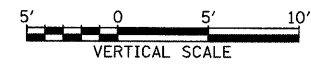
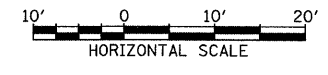

SB I-94 (DAN RYAN EXPRESSWAY)
 STA. 1216+50 TO STA. 1217+00

12/15/2009 12:22:34 PM