

PROFILE SUBMITTED BY DATE
 DESIGNED BY
 CHECKED BY
 NOTE BOOK NO.
 STRUCTURE NOTATIONS CHRD

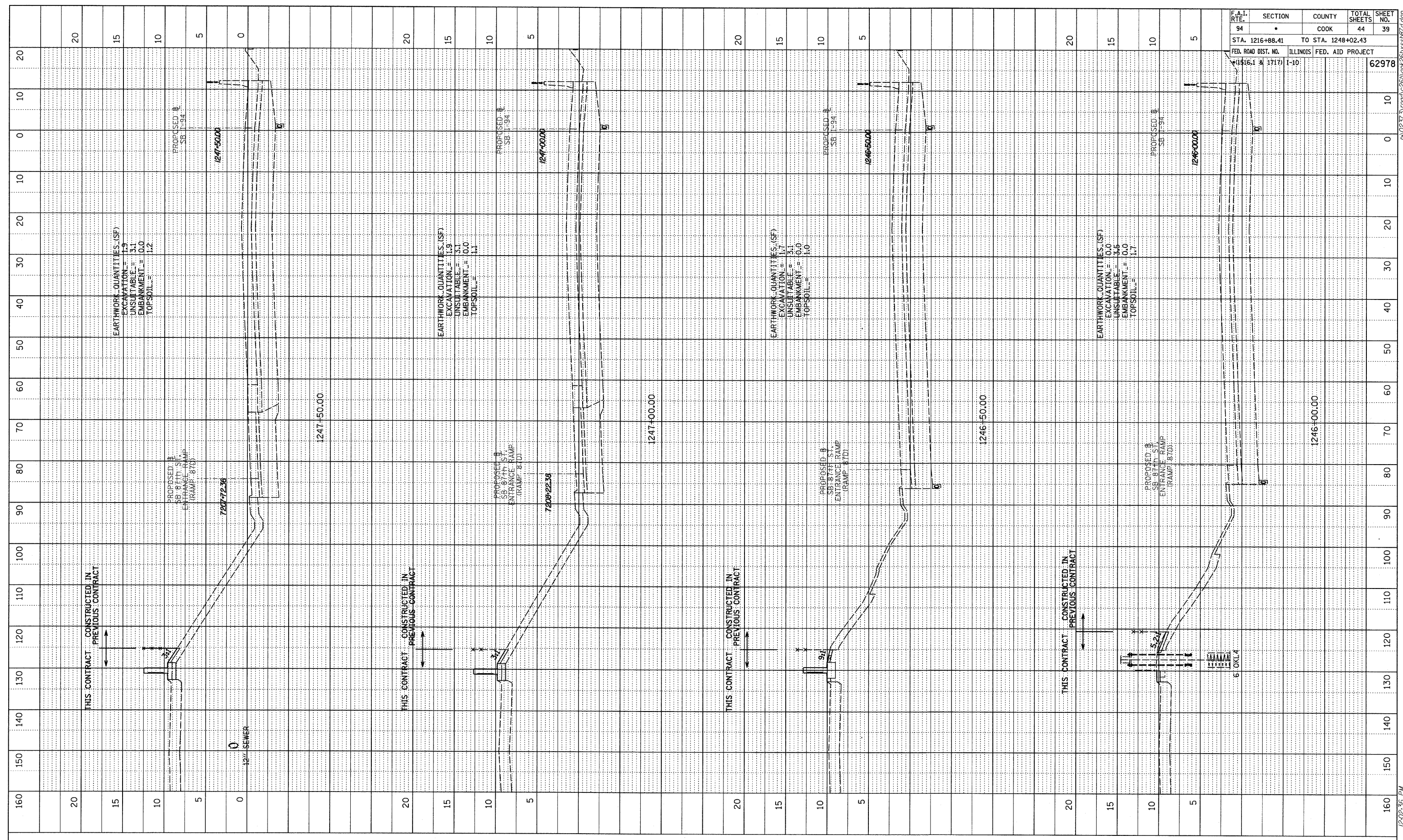

F.A.I. RTE.	SECTION	COUNTY	TOTAL SHEETS	SHEET NO.
94	*	COOK	44	39
STA. 1216+88.41		TO STA. 1248+02.43		
FED. ROAD DIST. NO.		ILLINOIS FED. AID PROJECT		
(1516.1 & 1717)		I-10		62978

TYLIN INTERNATIONAL

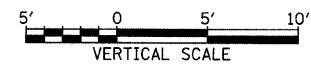
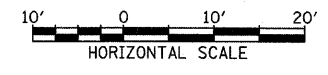

SB I-94 (DAN RYAN EXPRESSWAY)
 STA. 1246+00 TO STA. 1247+50

1/15/2009 12:02:36 PM \\p02373\work\260\gpr\260\ssst\87.dgn