

PROFILE	SURVEYED	BY	DATE
NOTE BOOK	PROFILES CHECKED		
NO.	DATE NOTED		
	STRUCTURE NOTATION	DRWD	

F.A.I. RTE.	SECTION	COUNTY	TOTAL SHEETS	SHEET NO.
90/94	1717 I-9	COOK	48	33
STA. 1273+74.31		TO STA. 1289+11.91		
FED. ROAD DIST. NO.	ILLINOIS FED. AID PROJECT		62980	

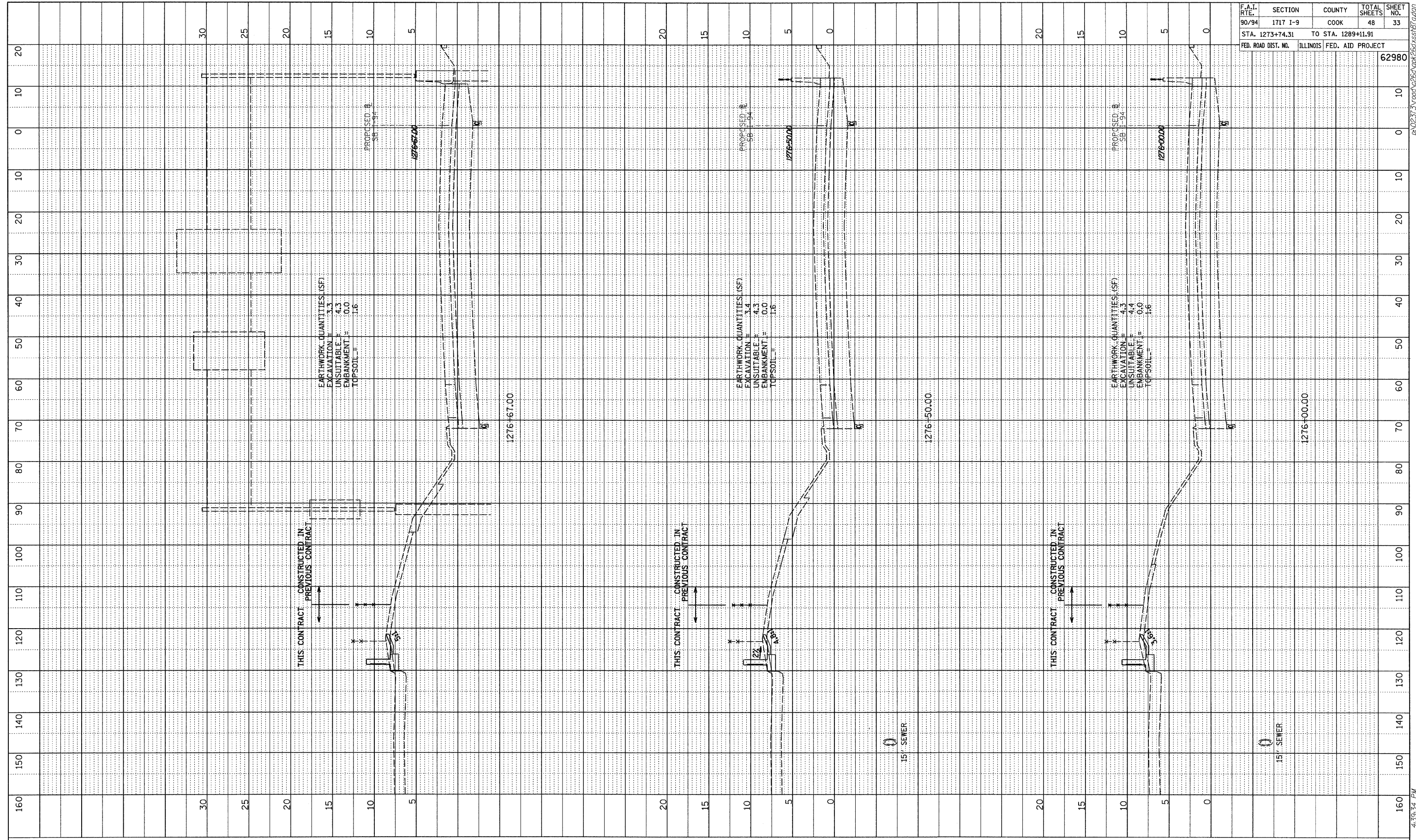

TYLIN INTERNATIONAL

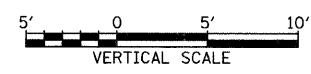
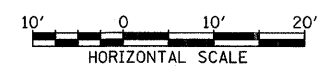

SB I-94 (DAN RYAN EXPRESSWAY)
STA. 1276+00 TO STA. 1276+67

10/16/2008 4:39:34 PM