

PROFILE	SURVEYED	BY	DATE
NOTE BOOK	PLANNED		
NO.	NO.		
	NO.		
	NO.		

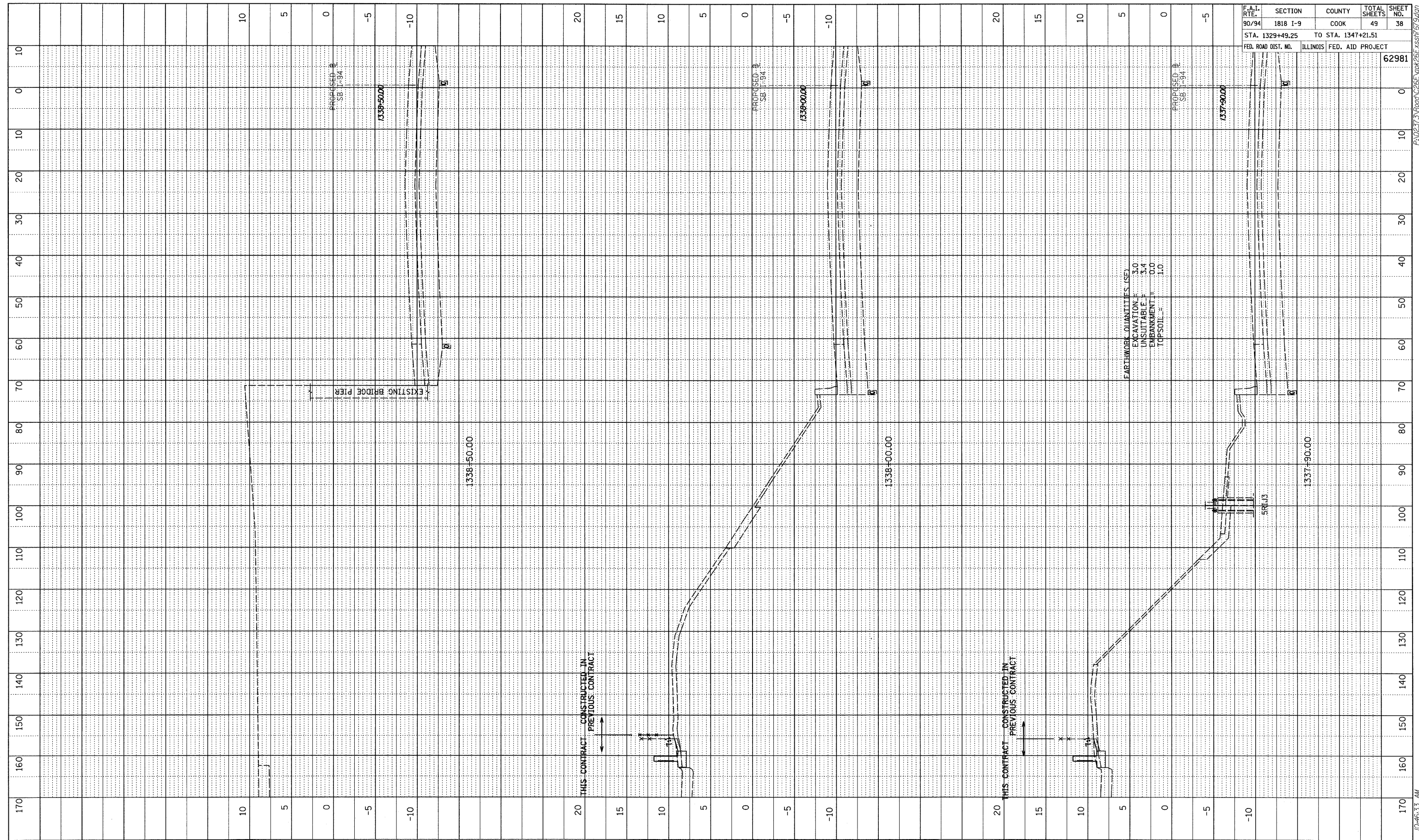

F.A.I. RTE.	SECTION	COUNTY	TOTAL SHEETS	SHEET NO.
90/94	1818 I-9	COOK	49	38
STA. 1329+49.25		TO STA. 1347+21.51		
FED. ROAD DIST. NO.	ILLINOIS FED. AID PROJECT		62981	

EARTHWORK QUANTITIES (SE)
 EXCAVATION = 3.0
 UNSUITABLE = 3.4
 EMBANKMENT = 0.0
 TOPSOIL = 1.0

TYLIN INTERNATIONAL

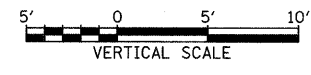
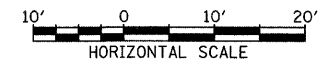

SB I-94 (DAN RYAN EXPRESSWAY)
 STA. 1337+90 TO STA. 1338+50

10/17/2008 10:46:33 AM P:\02\7\A\road\0266\gpk266\ssst1519.dwg