

PROFILE	SURVEYED	BY	DATE
NOTE BOOK	BOOKS CHECKED		
NO.	S.A.M. NOTED		
	STRUCTURE NOTATIONS CHRD		

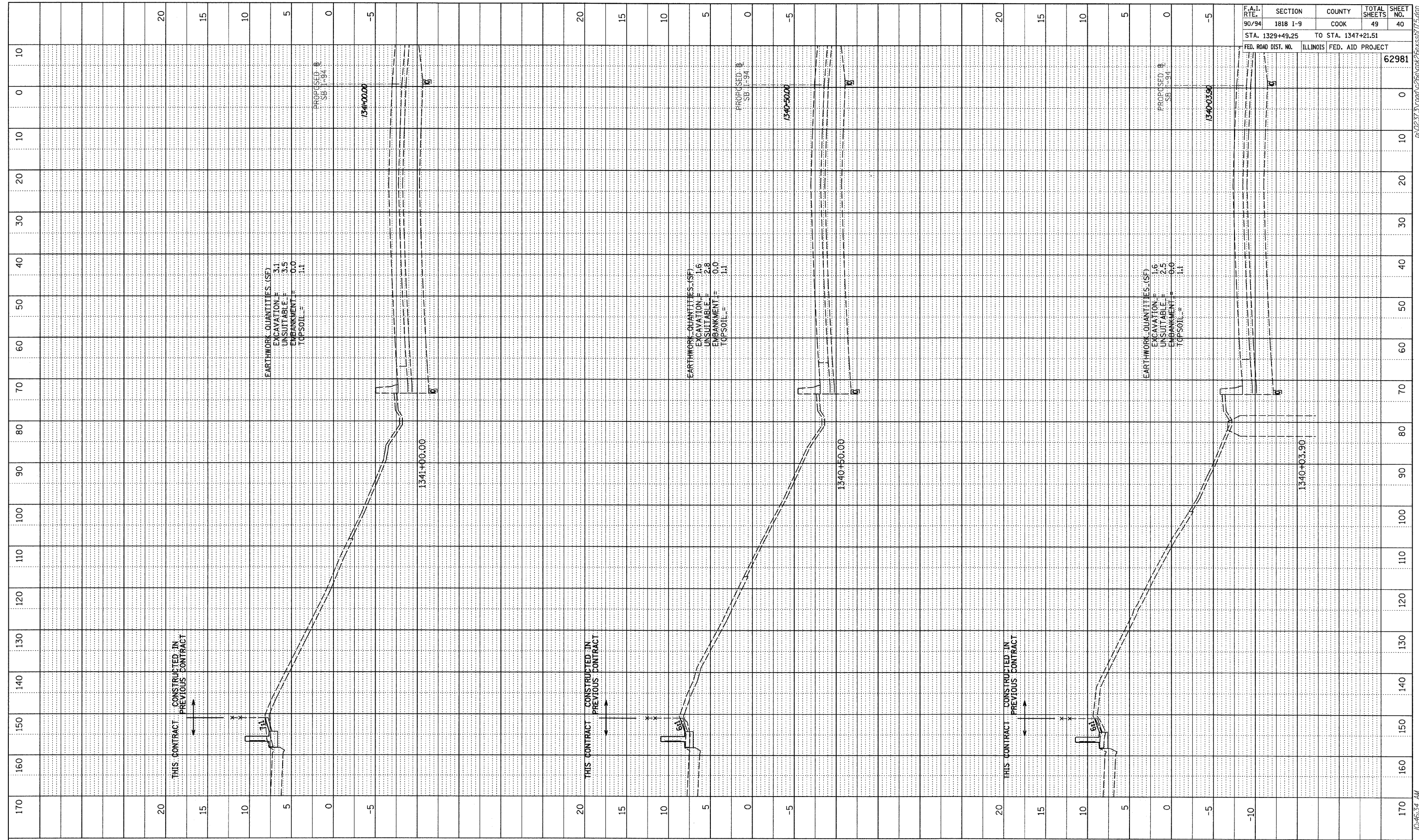

F.A.I. RTE.	SECTION	COUNTY	TOTAL SHEETS	SHEET NO.
90/94	1818 I-9	COOK	49	40
STA. 1329+49.25		TO STA. 1347+21.51		
FED. ROAD DIST. NO.		ILLINOIS FED. AID PROJECT		62981

TYLINT INTERNATIONAL

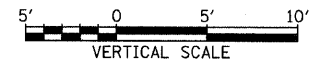

SB I-94 (DAN RYAN EXPRESSWAY)  
 STA. 1340+03 TO STA. 1341+00

10/17/2008 10:46:34 AM P:\0231\road\269426\94\269426.dwg