

PROFILE SURVEYED BY DATE  
 NOTES CHECKED BY  
 NOTE BOOK NO. NOTED BY  
 NO. STRUCTURE NOTATIONS CORD

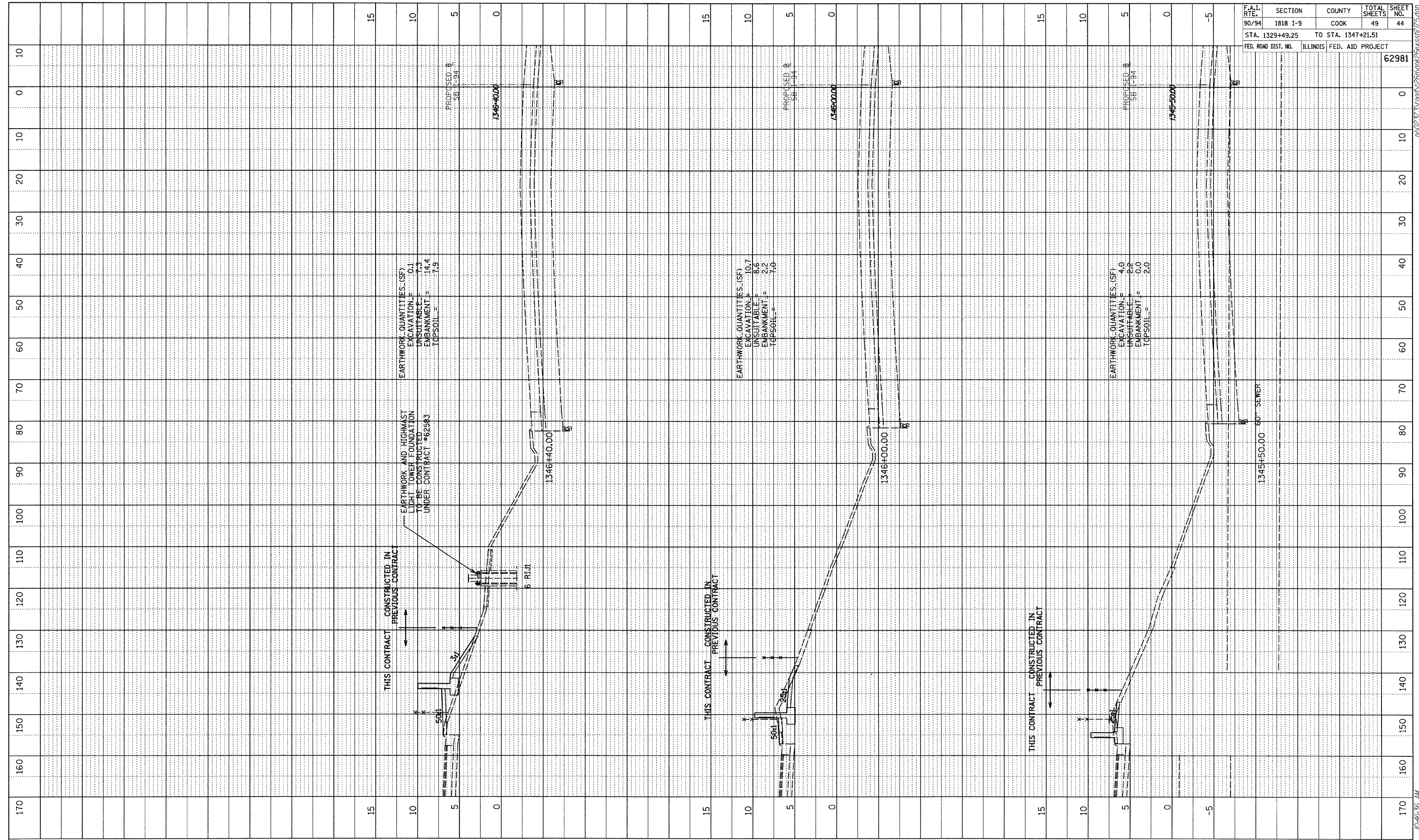

F.A.I. RTE.	SECTION	COUNTY	TOTAL SHEETS	SHEET NO.
90/94	1818 I-9	COOK	49	44
STA. 1329+49.25		TO STA. 1347+21.51		
FED. ROAD DIST. NO.		ILLINOIS FED. AID PROJECT		62981

TYLIN INTERNATIONAL

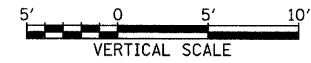

SB I-94 (DAN RYAN EXPRESSWAY)  
 STA. 1345+50 TO STA. 1346+40

P:\0227\3\road\2008\94\62981.dwg  
 10/17/2008 10:46:36 AM