

F.A. RTE.	SECTION	COUNTY	TOTAL SHEETS	SHEET NO.
1503	08-00260-01-PV	KANE	176	31
STA. 604+00		TO STA. 610+00		
FED. ROAD DIST. NO.	ILLINOIS FED. AID PROJECT			

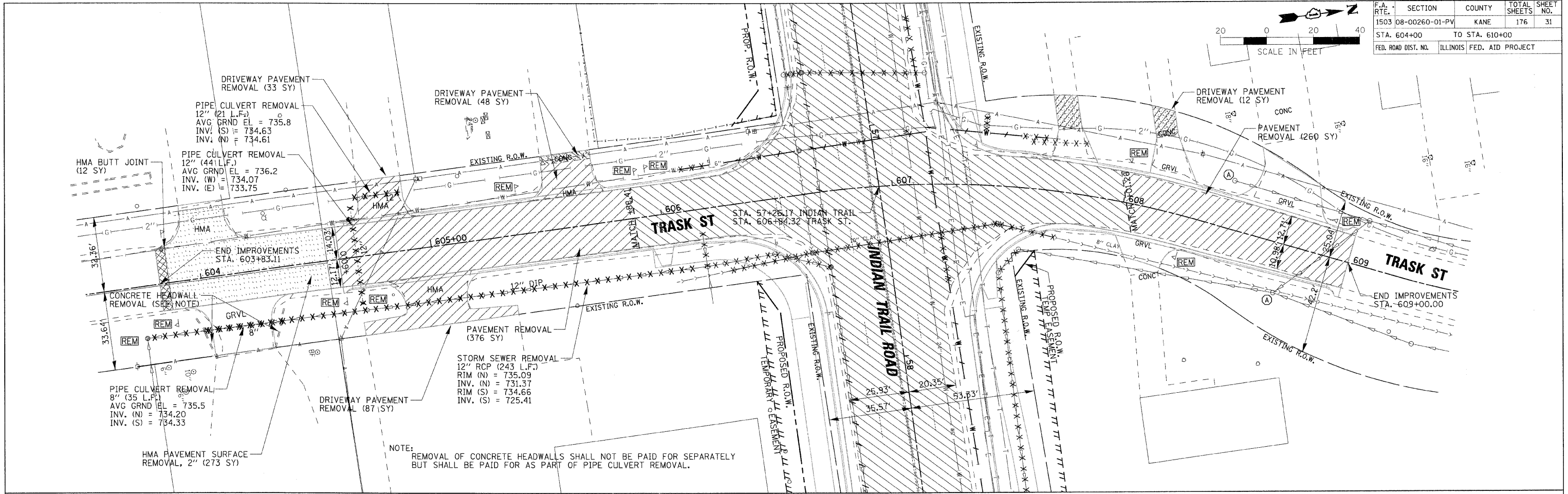
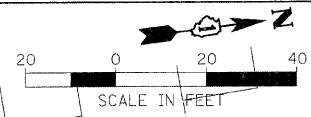

NOTE: REMOVAL OF CONCRETE HEADWALLS SHALL NOT BE PAID FOR SEPARATELY BUT SHALL BE PAID FOR AS PART OF PIPE CULVERT REMOVAL.

PLOT DATE = 1/9/2009
 FILE NAME = H:\auroora\220095_1\plots\trask\REK_TR_L.dgn
 USER NAME = JUSER

REVISIONS	
NAME	DATE

ILLINOIS DEPARTMENT OF TRANSPORTATION

REMOVAL PLANS
 TRASK STREET
 SHEET 6 OF 6

SCALE: VERT. 1" = 20'
 HORIZ. 1" = 20'
 DATE 1/7/09

DRAWN BY AWH
 CHECKED BY TC/SBP

RHAA

Robert H. Anderson & Associates, Inc.
 Consulting Engineers & Land Surveyors
 License No. 184-005281
 Phone No. 630-584-3530