

F.A. RTE.	SECTION	COUNTY	TOTAL SHEETS	SHEET NO.
1503	08-00260-01-PV	KANE	176	39
STA. 74+00		TO STA. 80+00		
FED. ROAD DIST. NO.	ILLINOIS	FED. AID PROJECT		

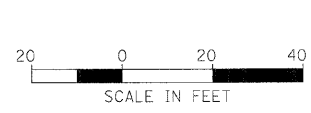

PLAN	REVISION	DATE

PROFILE	REVISION	DATE

PLOT DATE = 1/6/2009  
 FILE NAME = I:\source\120089\_1\p\1\aviv\Sh\c\NP\_IT\_13.dgn  
 USER NAME = JUSER

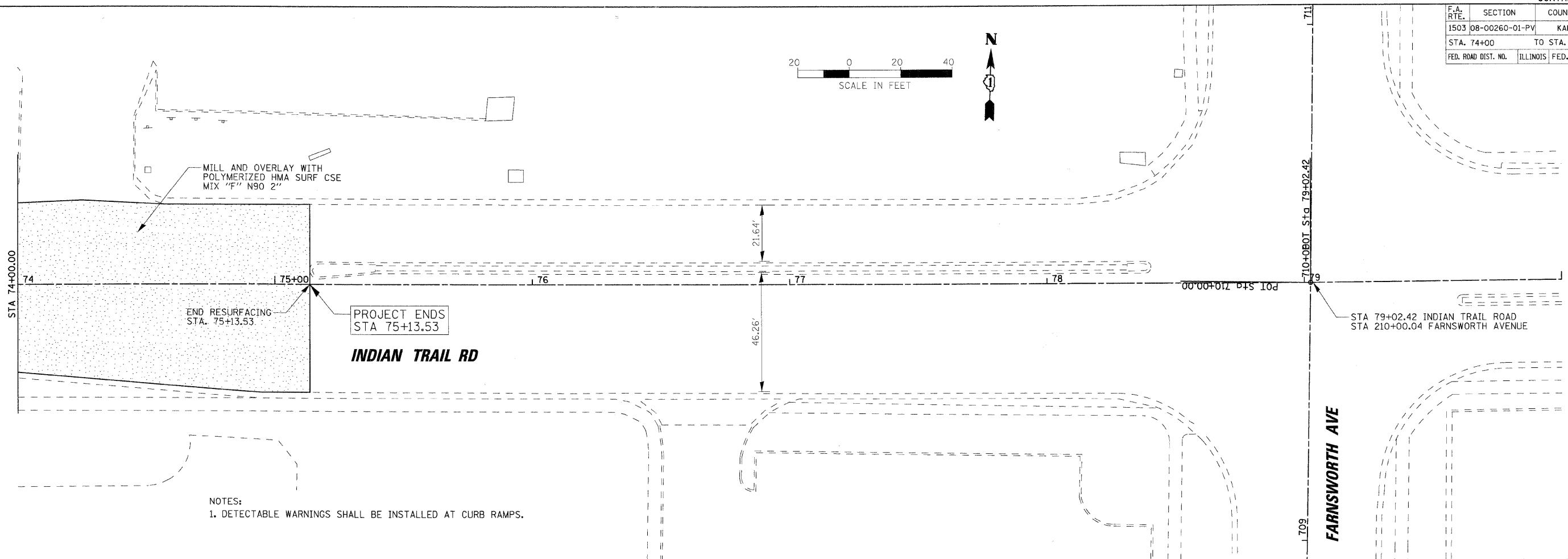

NOTES:  
 1. DETECTABLE WARNINGS SHALL BE INSTALLED AT CURB RAMPS.

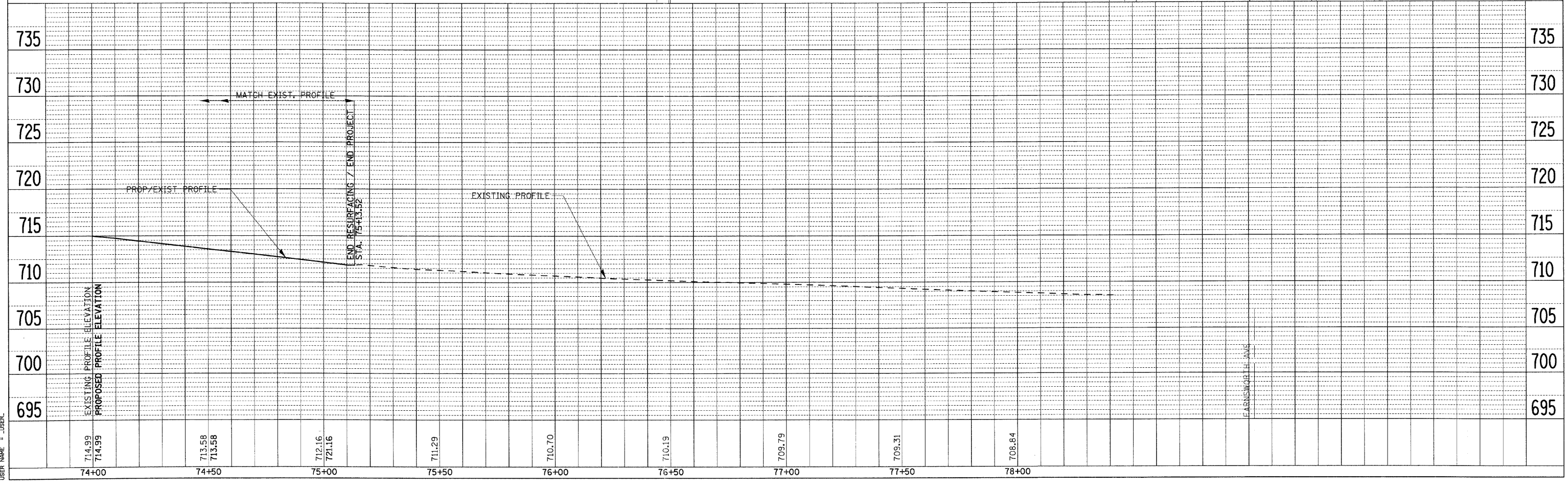

714.99	713.58	712.16	711.29	710.70	710.19	709.79	709.31	708.84
74+00	74+50	75+00	75+50	76+00	76+50	77+00	77+50	78+00