

F.A. RTE.	SECTION	COUNTY	TOTAL SHEETS	SHEET NO.
1503	08-00260-01-PV	KANE	176	84
STA. 604+00		TO STA. 610+00		
FED. ROAD DIST. NO.	ILLINOIS	FED. AID PROJECT		

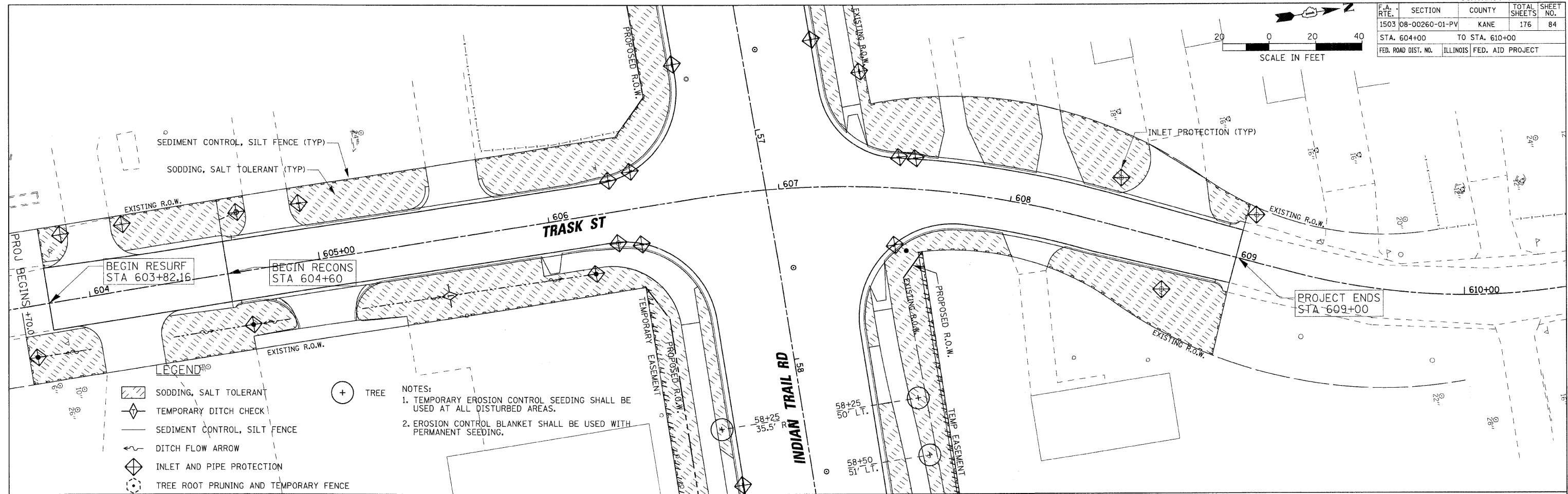
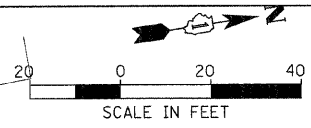

**LEGEND**

- SODDING, SALT TOLERANT
- TEMPORARY DITCH CHECK
- SEDIMENT CONTROL, SILT FENCE
- DITCH FLOW ARROW
- INLET AND PIPE PROTECTION
- TREE ROOT PRUNING AND TEMPORARY FENCE
- TREE

**NOTES:**

- TEMPORARY EROSION CONTROL SEEDING SHALL BE USED AT ALL DISTURBED AREAS.
- EROSION CONTROL BLANKET SHALL BE USED WITH PERMANENT SEEDING.

PLOT DATE = 1/5/2009  
 FILE NAME = H:\Users\j1208951\Public\Gw11\Shalander05.TR.L.dgn  
 PLOT SCALE = 1"=20'  
 USER NAME = USER



REVISIONS	
NAME	DATE

ILLINOIS DEPARTMENT OF TRANSPORTATION

LANDSCAPING AND EROSION CONTROL  
 TRASK STREET  
 SHEET 5 OF 5

SCALE: VERT. 1"=20'  
 HORIZ. 1"=20'  
 DATE 1/7/09

DRAWN BY TC  
 CHECKED BY TC/SBP