

NOTES:

1. SANITARY SEWER SERVICE LATERALS AND DRAINAGE STRUCTURE LATERALS SHALL BE CONNECTED TO THE ASSOCIATED SEWER AT MANHOLE STRUCTURES, OR AT WYE OR TEE CONNECTIONS. THE EXACT LOCATION OF EACH SEWER SERVICE LATERAL SHALL BE CONFIRMED IN THE FIELD.
2. UNLESS OTHERWISE NOTED:
SEWER LENGTHS LISTED CENTER OF STRUCTURE TO CENTER OF STRUCTURE.
SEWER SLOPES CALCULATED END OF PIPE TO END OF PIPE.

NOTES:

3. ALL COMBINATION/SANITARY MANHOLES TO HAVE RESILIENT CONNECTORS CONFORMING TO ASTM C-923.
4. CONTRACTOR SHALL PROVIDE, AS REQUIRED, SHEETING SHORING, AND/OR BRACING AS CALLED FOR IN ARTICLE 552 OF THE STANDARD SPECIFICATIONS (INCIDENTAL).

HEUER AND ASSOCIATES		F.A.U. RTE.	SECTION	COUNTY	TOTAL SHEETS	SHEET No.
Consulting Engineers		1004	08-00079-02-FP	COOK	32	24
2315 Enterprise Drive • Suite 102 Westchester, IL 60154-5811 708-492-1000		STA. 76+50	TO STA. 82+50		82+50	
BLUFF AVE. IMPROVEMENTS - STAGE 2		DATE: 02/27/2009		FED. ROAD DIST. NO. 1 ILLINOIS FED. AID PROJECT		
				DRAINAGE AND UTILITY IMPROVEMENTS		
CONTRACT No. 63149						



PLAN	DESIGNED	DATE
	BY	
	CHECKED	
	DATE	
	NO.	

PROFILE	DESIGNED	DATE
	BY	
	CHECKED	
	DATE	
	NO.	

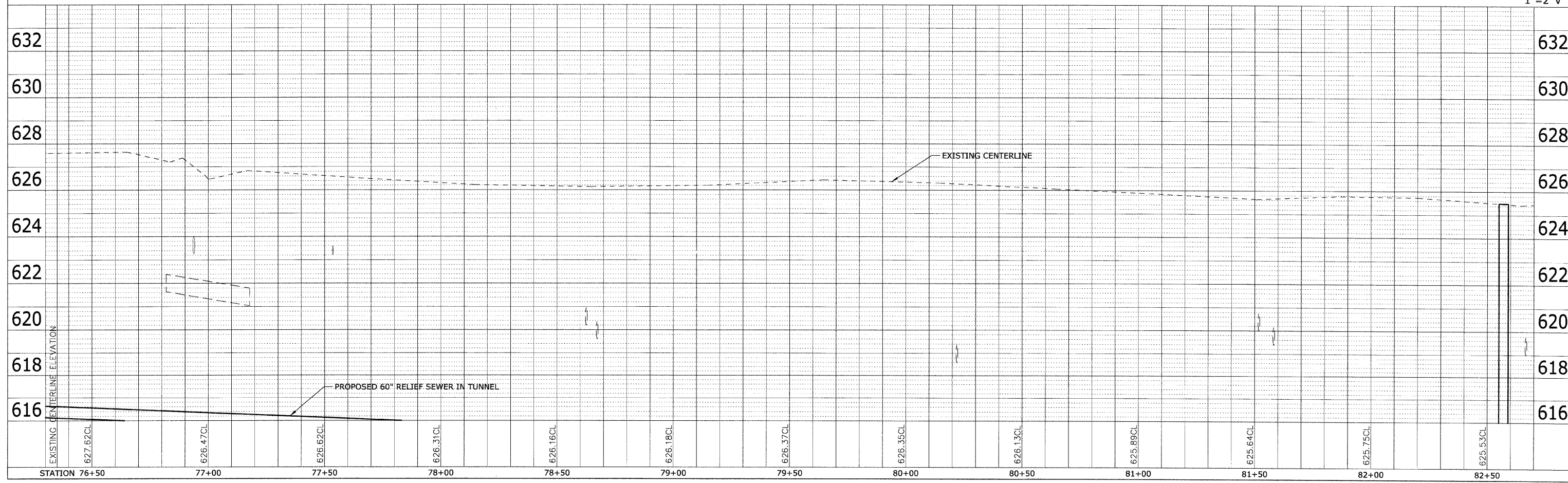
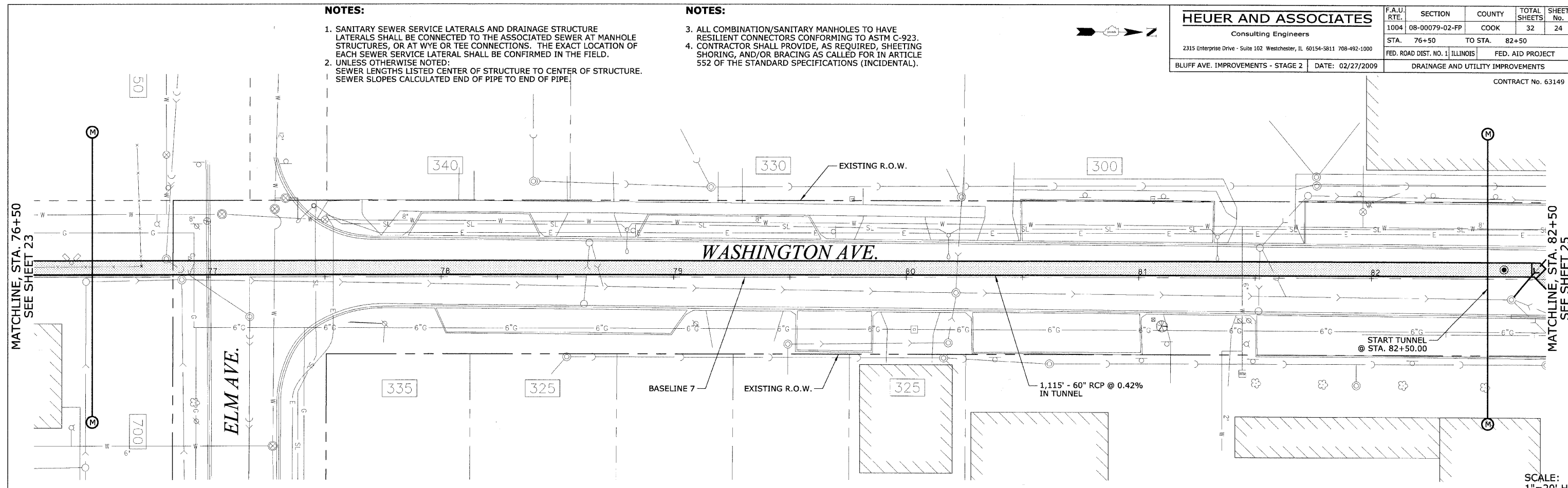

SCALE:
1"=20' H
1"=2' V