

FAU RTE	SECTION	COUNTY	TOTAL SHEETS	SHEET NO.
VARIOUS	06-00080-00-BT	COOK	16	6
F.H.W.A. REG.	ILLINOIS	PROJECT	HPP-3463(004)	

CONTRACT NO. 63220

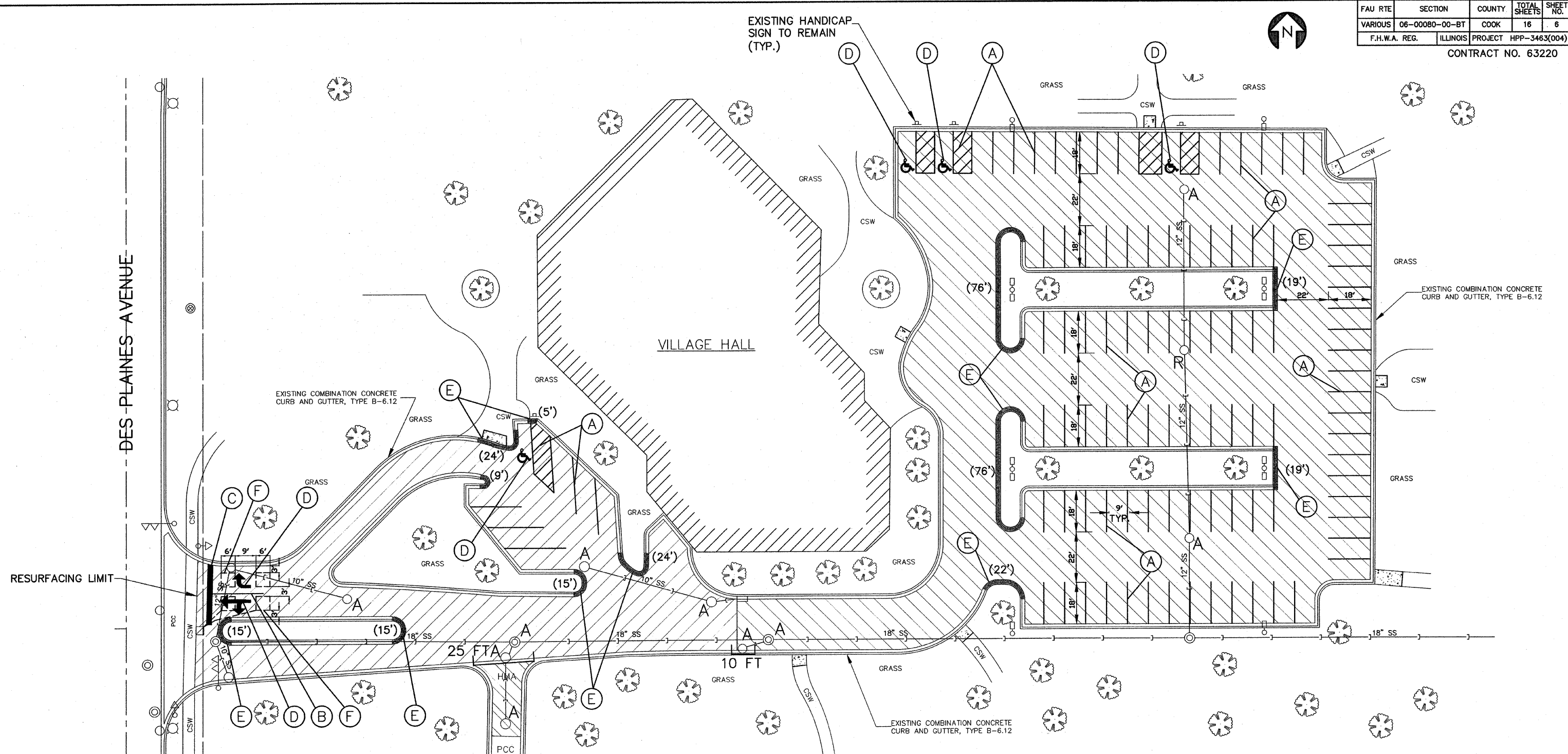

EXISTING HANDICAP SIGN TO REMAIN (TYP.)



PAINTED STRIPING CODE

- (A) PROPOSED SOLID YELLOW PAINTED PAVEMENT MARKING - LINE 4" (STALL LINE)
- (B) PROPOSED SOLID WHITE PAINTED PAVEMENT MARKING - LINE 6" (LANE LINE)
- (C) PROPOSED SOLID WHITE PAINTED PAVEMENT MARKING - LINE 24" (STOP BAR)
- (D) PROPOSED SOLID WHITE PAINTED PAVEMENT MARKING - LETTERS & SYMBOLS

CURB PAINTING

- (E) PROPOSED SOLID YELLOW PAINTED CURB & GUTTER MARKING (LENGTH AS NOTED)

DETECTOR LOOPS

- (F) PROPOSED DETECTOR LOOP REPLACEMENT

NOTE:
ALL "ARROWS" AND "ONLYS" SHALL BE 8" IN HEIGHT.

PROPOSED HOT-MIX ASPHALT SURFACE REMOVAL, VARIABLE DEPTH

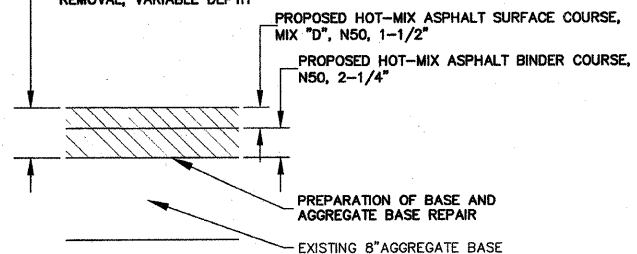

TYPICAL CROSS SECTION

HOT-MIX ASPHALT SURFACE REMOVAL, VARIABLE DEPTH, PREPARATION OF BASE AND AGGREGATE BASE REPAIR
HOT-MIX ASPHALT BINDER COURSE, N50, 2-1/4"
AND HOT-MIX ASPHALT SURFACE COURSE, MIX "D", N50, 1-1/2"

PROPOSED HOT-MIX ASPHALT SURFACE REMOVAL, 1-1/2", AND HOT-MIX ASPHALT SURFACE COURSE, MIX "D", N50, 1-1/2"

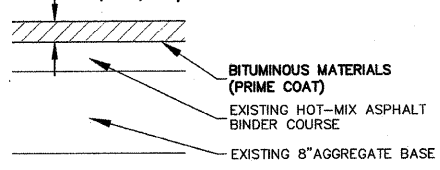

TYPICAL CROSS SECTION

DENOTES HOT-MIX ASPHALT SURFACE REMOVAL, 1-1/2", AND HOT-MIX ASPHALT SURFACE COURSE, MIX "D", N50, 1-1/2"

LEGEND

- DENOTES HOT-MIX ASPHALT SURFACE REMOVAL, VARIABLE DEPTH, PREPARATION OF BASE, HOT-MIX ASPHALT BINDER COURSE, N50, 2-1/4" AND HOT-MIX ASPHALT SURFACE COURSE, MIX "D", N50, 1-1/2"
- DENOTES HOT-MIX ASPHALT SURFACE REMOVAL, 1-1/2", AND HOT-MIX ASPHALT SURFACE COURSE, MIX "D", N50, 1-1/2"
- DENOTES PAVEMENT REMOVAL AND PC CONCRETE PAVEMENT, 8"
- DENOTES SIDEWALK REMOVAL AND P.C. CONCRETE SIDEWALK, 5 INCH. DETECTABLE WARNING TO BE INSTALLED AS REQUIRED.
- "A" DENOTES VALVE VAULTS, VALVE BOXES, INLETS, CATCH BASINS, MANHOLES, AND HANDHOLES, TO BE ADJUSTED
- "R" DENOTES DRAINAGE & UTILITY STRUCTURES TO BE RECONSTRUCTED
- (10') DENOTES SOLID YELLOW PAINTED CURB MARKING
- 8 FT DENOTES COMBINATION CONCRETE CURB & GUTTER REMOVAL AND REPLACEMENT, DEPRESS CURB ADJACENT TO CURB RAMPS FOR SIDEWALKS AS REQUIRED.

NOTE:
1 ALL EXISTING FRAMES AND LIDS THAT ARE TO BE REPLACED (AS DIRECTED BY THE ENGINEER) SHALL BE SALVAGED TO THE CONTRACTOR.
2 ALL SAW CUTS SHALL BE CONSIDERED INCIDENTAL TO THE CONTRACT.

IMPORTANT!
FULL SIZE PLANS HAVE BEEN PREPARED USING STANDARD ENGINEERING SCALES. REDUCED SIZED PLANS WILL NOT CONFORM TO STANDARD SCALES INDICATED IN TITLE BLOCK.

Frank Novotny & Associates, Inc.
Civil Engineers/
Municipal Consultants
825 Midway Drive • Willowbrook, IL • 60527 • Telephone: (630) 887-8640 • Fax: (630) 887-0132
Illinois Professional Design Firm No. 184-000928

PROJECT **VILLAGE OF NORTH RIVERSIDE, ILLINOIS**
VILLAGE WIDE BIKE PATH - STAGE 1
26TH STREET RESURFACING (1ST AVENUE TO DES PLAINES AVENUE)
& VILLAGE COMMONS COMPLEX PARKING REHABILITATION
M.F.T. SECTION NO. 06-00080-00-BT

REVISIONS			
NO.	BY	DATE	DESCRIPTION

PLAN SHEET: VILLAGE COMMONS
(RESURFACING & PAVEMENT MARKING)
VILLAGE HALL PARKING LOT &
ROADWAY RESURFACING

PROJECT NO. 03049	SCALE NONE	SHEET 6 OF 16 SHEETS
DRAWN/DESIGNED JEP/AMS	DATE APRIL, 2009	
CHECKED/APPROVED JFP/JEF	FIELD BOOK NO. FILE	