

PLAN	SUPERVIEWED	DATE
	PLOTTED	
	ALIGNED	
	CHECKED	
	CAAD FILE NAME	
NOTE BOOK NO.		

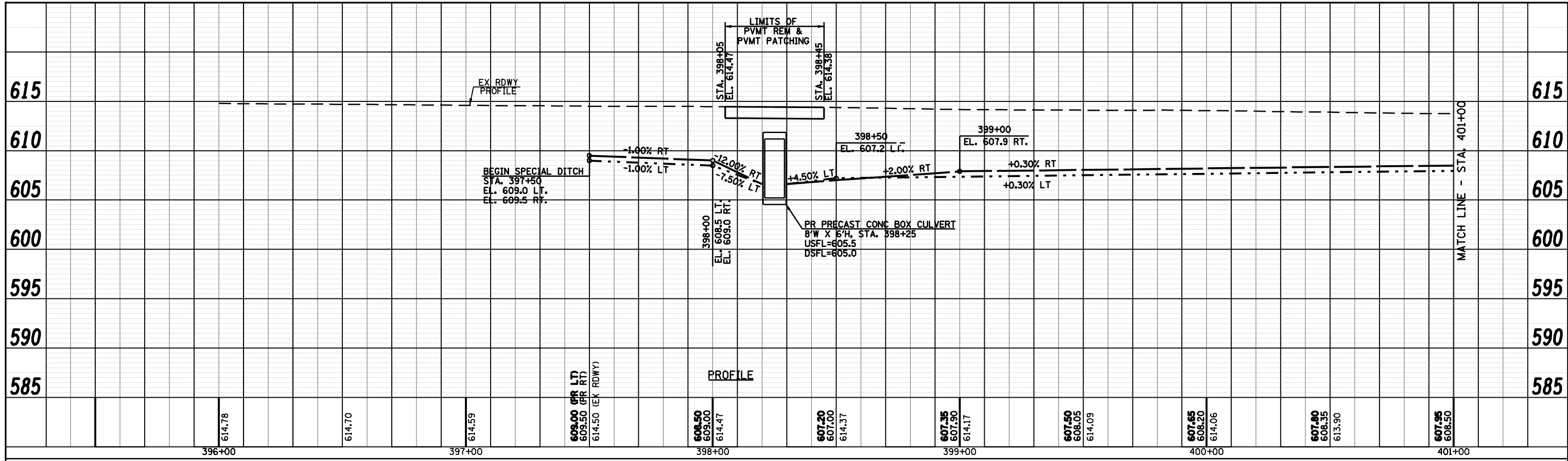

PROFILE	SUPERVIEWED	DATE
	PLOTTED	
	GRADES CHECKED	
	STRUCTURE NOTATIONS OK'D	
NOTE BOOK NO.		

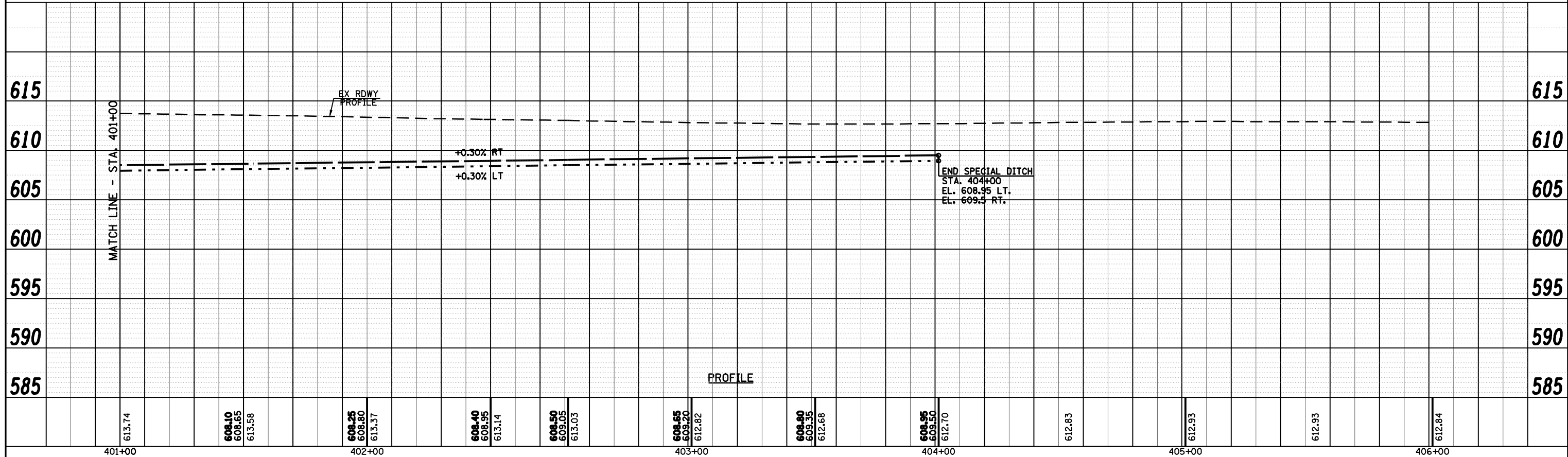

FILE NAME = c:\pwwork\pwwid001\LAUGHLIN\rd0143507\062\2002-shr-profile-wabash_ditch.dgn	USER NAME = laughlinr1	DESIGNED -	REVISED -	Allen Henderson & Associates, Inc. Civil and Structural Engineers Springfield, IL 62703 Phone: (217)544-8033 IL Design Firm No. 184-001907	PROFILE (WABASH AVENUE)		F.A.U. RTE. 8012	SECTION 21(I-3)	COUNTY SANGAMON	TOTAL SHEETS 147	SHEET NO. 27
PLOT SCALE = 40.0000' / IN.	CHECKED -	REVISED -	SCALE: 1" = 20'				SHEET NO. 27 OF 147 SHEETS	STA. TO STA.	CONTRACT NO. T2A02		
PLOT DATE = May-18-2009 03:17:32PM	DATE -	REVISED -					ILLINOIS FED. AID PROJECT				