

PLAN	SURVEYED	BY	DATE
	PLOTTED		
	ALIGNED		
	CHECKED		
	FILE NAME		
	NO.		

PROFILE	SURVEYED	BY	DATE
	GRADES CHECKED		
	STRUCTURE NOTATIONS CHKD		
	NO.		

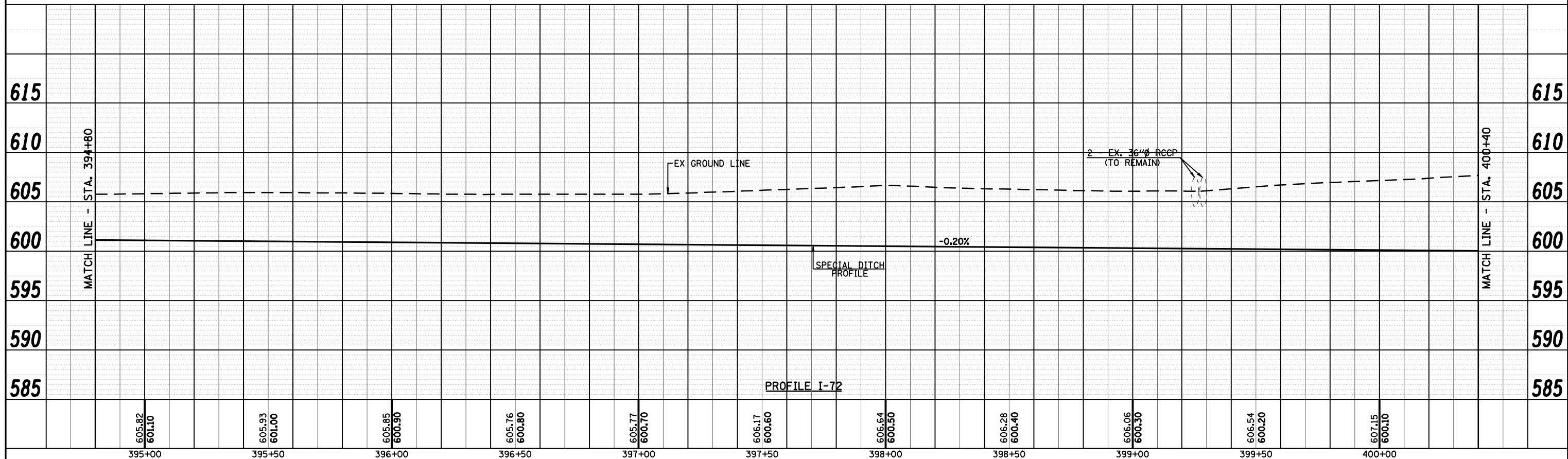
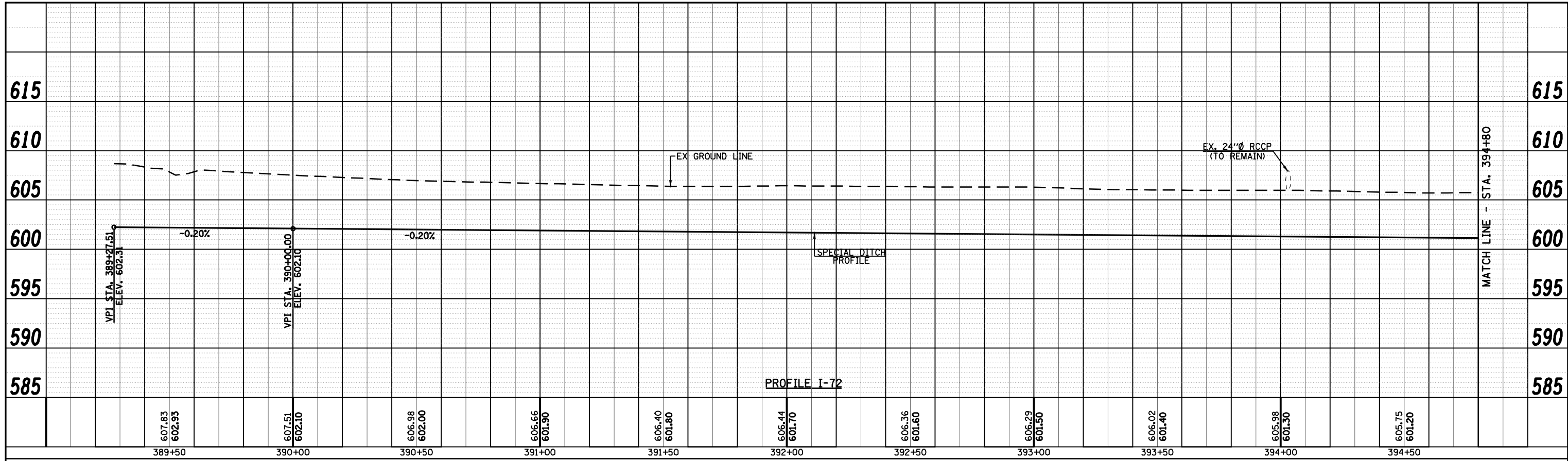

FILE NAME =	USER NAME = laughlinr1	DESIGNED -	REVISED -	Allen Henderson & Associates, Inc. Civil and Structural Engineers Springfield, IL 62703 Phone: (217)544-8033 IL Design Firm No. 184-001907	PROFILE (WATERWAY NO. 1 & I-72)			F.A.U. RTE.	SECTION	COUNTY	TOTAL SHEETS	SHEET NO.
c:\pwwork\pwwid007\LAUGHLINR1\0143507\0672\02-shit-profile-waterway 1-172.dgn	DRAWN -	REVISED -	8012					21(I-3)	SANGAMON	147	31	
PLOT SCALE = 40.0000' / IN.	CHECKED -	REVISED -	CONTRACT NO. 72A02									
PLOT DATE = May-18-2009 03:17:41PM	DATE -	REVISED -	ILLINOIS FED. AID PROJECT									

SCALE: 1" = 20' SHEET NO. 31 OF 147 SHEETS STA. TO STA.