

| | |
|--------------|----------|
| DATE | |
| BY | |
| NO. | |
| FINAL SURVEY | SURVEYED |
| NOTE BOOK | PLOTTED |
| NO. | TEMPLATE |
| | AREAS |
| | CHECKED |

| | |
|-----------------|----------|
| DATE | |
| BY | |
| NO. | |
| ORIGINAL SURVEY | SURVEYED |
| NOTE BOOK | PLOTTED |
| NO. | TEMPLATE |
| | AREAS |
| | CHECKED |

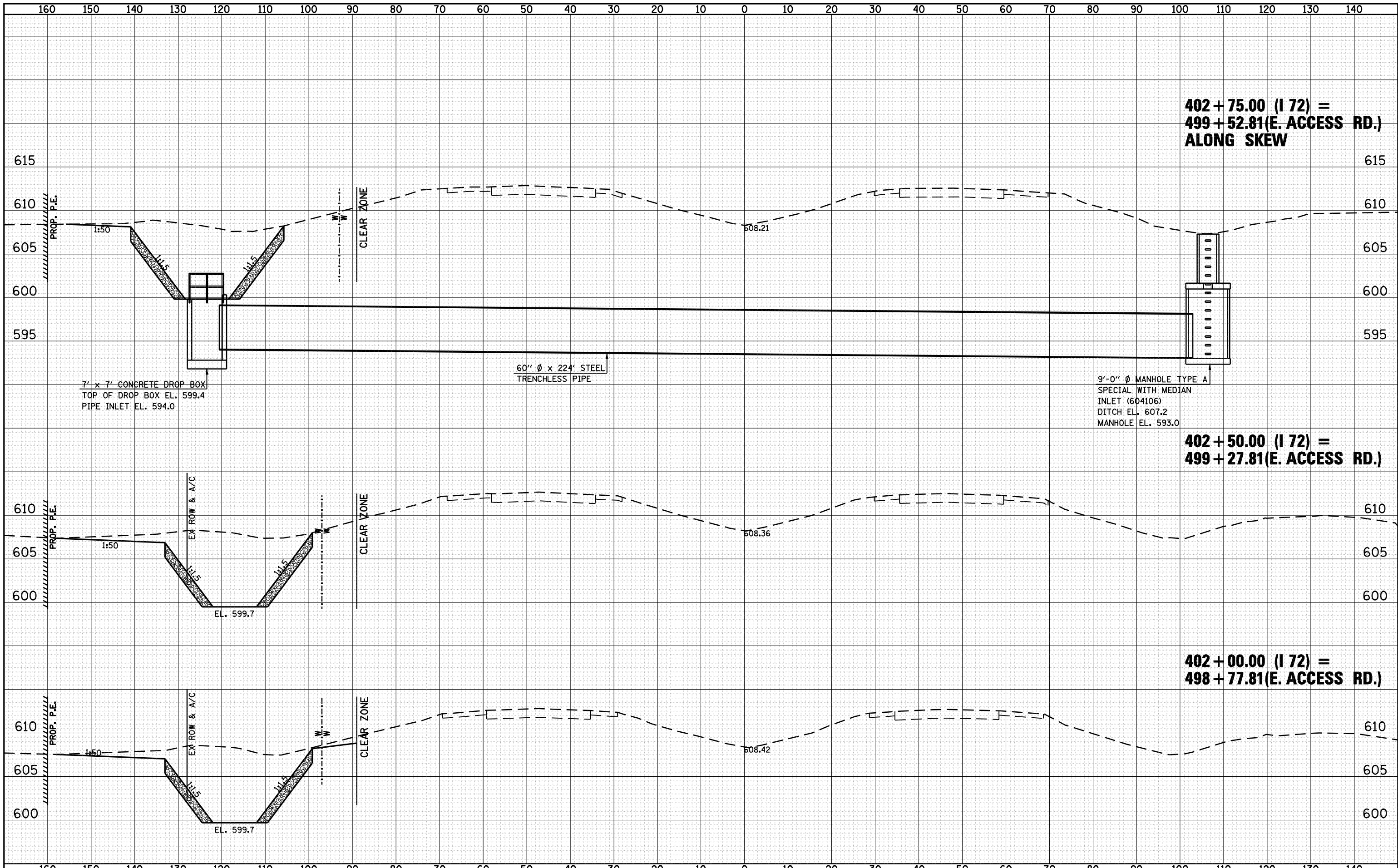

**402 + 75.00 (I 72) =
499 + 52.81(E. ACCESS RD.)
ALONG SKEW**

**402 + 50.00 (I 72) =
499 + 27.81(E. ACCESS RD.)**

**402 + 00.00 (I 72) =
498 + 77.81(E. ACCESS RD.)**

| | | | | | | | | | | |
|---|------------------------------------|------------|----------|--|--|---|---------|----------|--------------|-----------|
| FILE NAME = | USER NAME = laughlinr1 | DESIGNED - | REVISD - | <p>Allen Henderson & Associates, Inc. Civil and Structural Engineers Springfield, IL 62703 Phone: (217)544-8033 IL Design Firm No. 184-001907</p> | <p align="center">CROSS SECTIONS (WATERWAY NO. 1, I 72 & EAST ACCESS ROAD)</p> | F.A.U. R.T.E. | SECTION | COUNTY | TOTAL SHEETS | SHEET NO. |
| o:\pwork\PWIDOT\LAUGHLINRL\d0143507\0672A02 | sh-t-xasht-172 r.t.dgn | DRAWN - | REVISD - | | | 8012 | 21(I-3) | SANGAMON | 147 | 106 |
| | PLOT SCALE = 20.0000' / IN. | CHECKED - | REVISD - | | | CONTRACT NO. 72A02 | | | | |
| | PLOT DATE = May-18-2009 03:23:08PM | DATE - | REVISD - | | | FED. ROAD DIST. NO. ILLINOIS FED. AID PROJECT | | | | |