

CCC&G REMOVAL AND REPLACEMENT - VARIOUS LOCATIONS  
TO BE DETERMINED BY THE ENGINEER

BLACK AVE TO N PEORIA RD	
NB 99+56 TO 101+77	5 FOOT
SB 99+56 TO 101+77	0 FOOT

EXIST. CURVE C1028  
 PI STA. = 102+47.18  
 $\Delta = 34^\circ 02' 44''$  (RT)  
 D = 20° 00' 49"  
 R = 286.28'  
 T = 87.65'  
 L = 170.11'  
 E = 13.12'  
 e = -----  
 T.R. = -----  
 S.E. RUN = -----  
 P.C. STA. = 101+59.53  
 P.T. STA. = 103+29.64

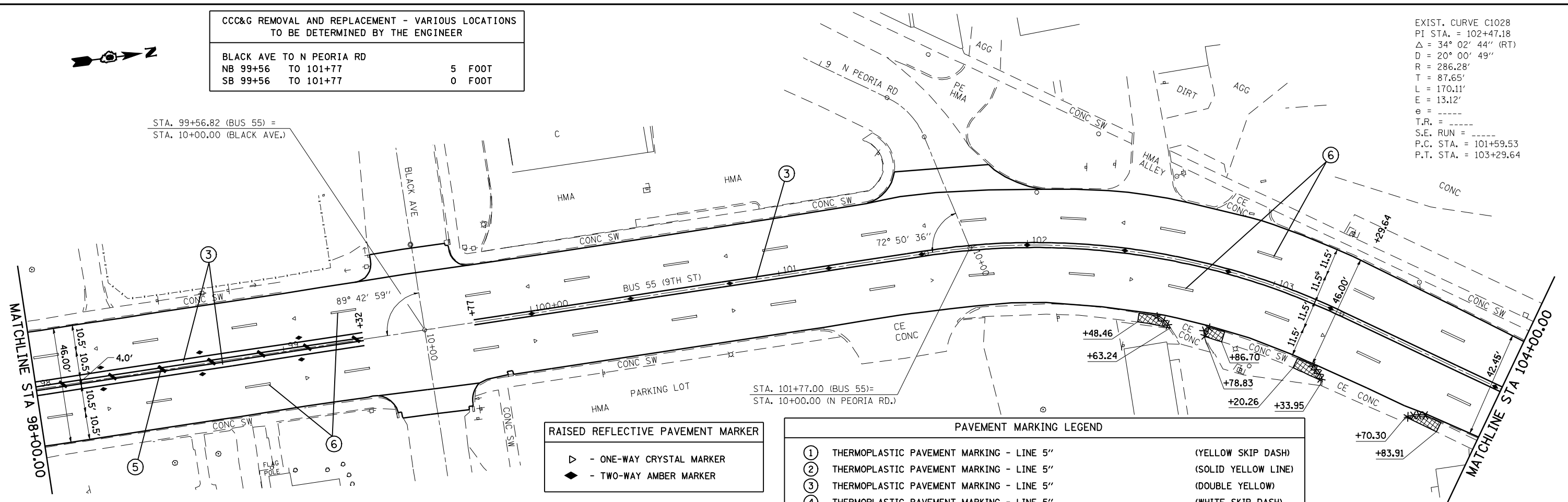

**RAISED REFLECTIVE PAVEMENT MARKER**

- ▷ - ONE-WAY CRYSTAL MARKER
- ◆ - TWO-WAY AMBER MARKER

**PAVEMENT MARKING LEGEND**

①	THERMOPLASTIC PAVEMENT MARKING - LINE 5"	(YELLOW SKIP DASH)
②	THERMOPLASTIC PAVEMENT MARKING - LINE 5"	(SOLID YELLOW LINE)
③	THERMOPLASTIC PAVEMENT MARKING - LINE 5"	(DOUBLE YELLOW)
④	THERMOPLASTIC PAVEMENT MARKING - LINE 5"	(WHITE SKIP DASH)
⑤	THERMOPLASTIC PAVEMENT MARKING - LINE 12"	(SOLID YELLOW LINE)
⑥	PREFORMED PLASTIC PAVEMENT MARKING, TYPE B - INLAID - LINE 5"	(WHITE SKIP DASH)
⑦	PREFORMED PLASTIC PAVEMENT MARKING, TYPE B - INLAID - LINE 6"	(SOLID WHITE LINE)
⑧	PREFORMED PLASTIC PAVEMENT MARKING, TYPE B - INLAID - LINE 24"	(WHITE STOP BARS)
⑨	PREFORMED PLASTIC PAVEMENT MARKING, TYPE B - INLAID - LETTERS AND SYMBOLS	(WHITE ARROWS)

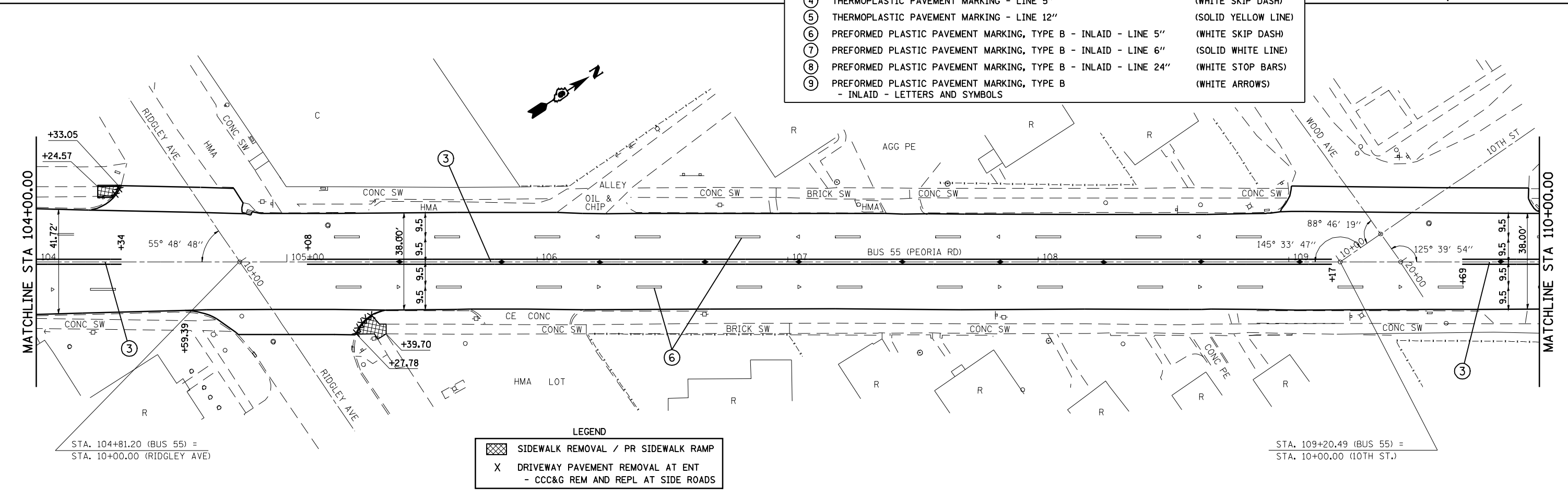

**LEGEND**

- ▨ SIDEWALK REMOVAL / PR SIDEWALK RAMP
- X DRIVEWAY PAVEMENT REMOVAL AT ENT - CCC&G REM AND REPL AT SIDE ROADS