

SECTION 18, T15N, R5W, 3rd PM

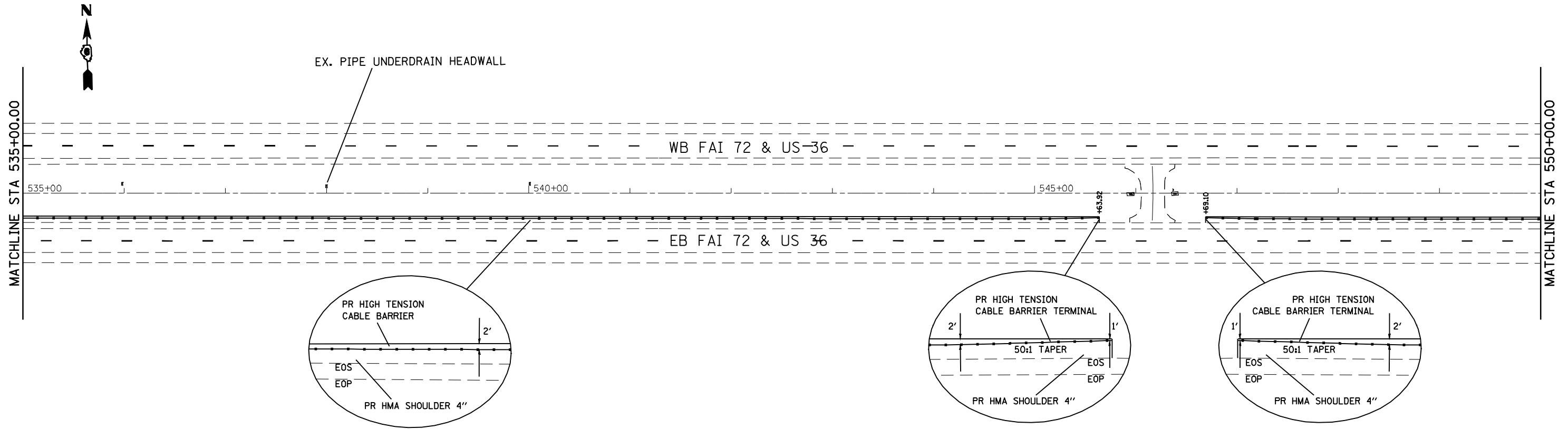

SECTION 18, T15N, R5W, 3rd PM

SECTION 17, T15N, R5W, 3rd PM

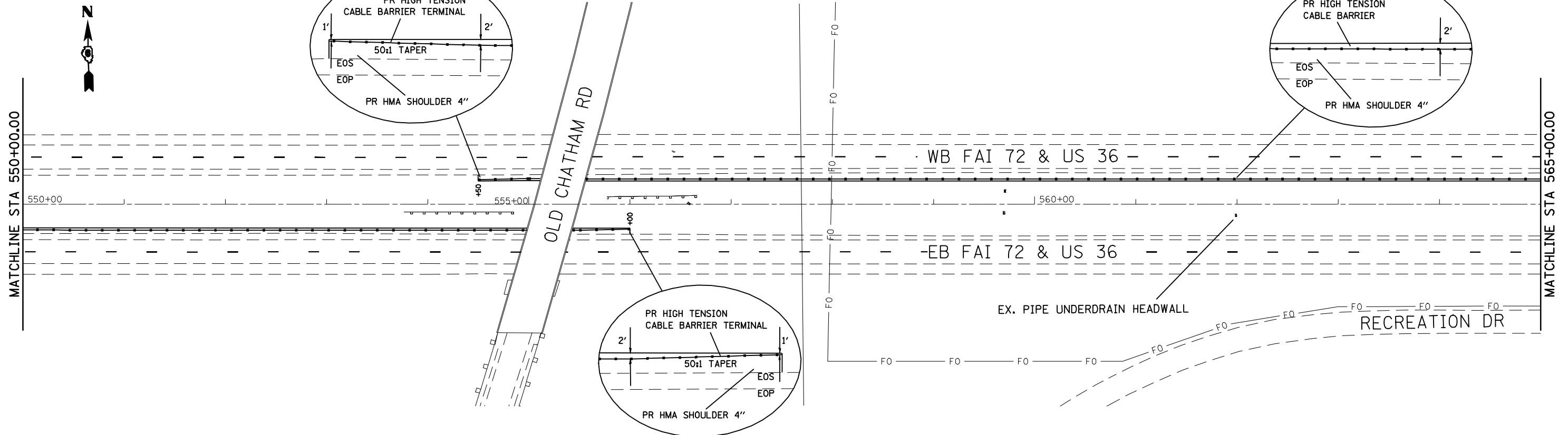

| | | | |
|--|------------------------------------|-----------------|-----------|
| FILE NAME = | USER NAME = laughlinr1 | DESIGNED - BKL | REVISED - |
| er\pwwork\PWIDOT\LAUGHLINRL\0128581\0672C77-sh-t-DBLPLN1.dgn | | DRAWN - BKL | REVISED - |
| | PLOT SCALE = 100.0000' / IN. | CHECKED - JPM | REVISED - |
| | PLOT DATE = May-07-2009 08:13:19AM | DATE - 04/10/09 | REVISED - |

STATE OF ILLINOIS
DEPARTMENT OF TRANSPORTATION

PLAN SHEET

SCALE: 1" = 50' SHEET NO. OF SHEETS STA. TO STA.

| F.A.I. RTE. | SECTION | COUNTY | TOTAL SHEETS | SHEET NO. |
|--------------------|---------|----------|---------------------------|-----------|
| 72 | * | SANGAMON | 100 | 12 |
| CONTRACT NO. 72C77 | | | ILLINOIS FED. AID PROJECT | |