

F.A.S. RTE.	SECTION	COUNTY	TOTAL SHEETS	SHEET NO.
731	(1)I-1	MACOUPIN	8	1
		ILLINOIS	CONTRACT NO. 72C91	

STATE OF ILLINOIS
DEPARTMENT OF TRANSPORTATION
DIVISION OF HIGHWAYS

PLANS FOR PROPOSED
CONTRACT MAINTENANCE

- INDEX OF SHEETS**
- 1 COVER SHEET
 - 2 GENERAL NOTES /MIX REQUIREMENTS
 - 3 SUMMARY OF QUANTITIES
 - 4 TYPICAL CROSS SECTIONS
 - 5-8 PLAN LAYOUT SHEETS

LIST OF STANDARDS

000001-05	701311-03
701001-02	701326-03
701006-03	701901-01
701011-02	780001-02
701301-03	

FAS ROUTE 731 (SCOTTVILLE ROAD)
SECTION (1)I-1
PROJECT
PROPOSED BITUMINOUS SHOULDERS, BOTH SIDES OF RDWY.
MACOUPIN COUNTY
C-96-086-09

D-96-086-09

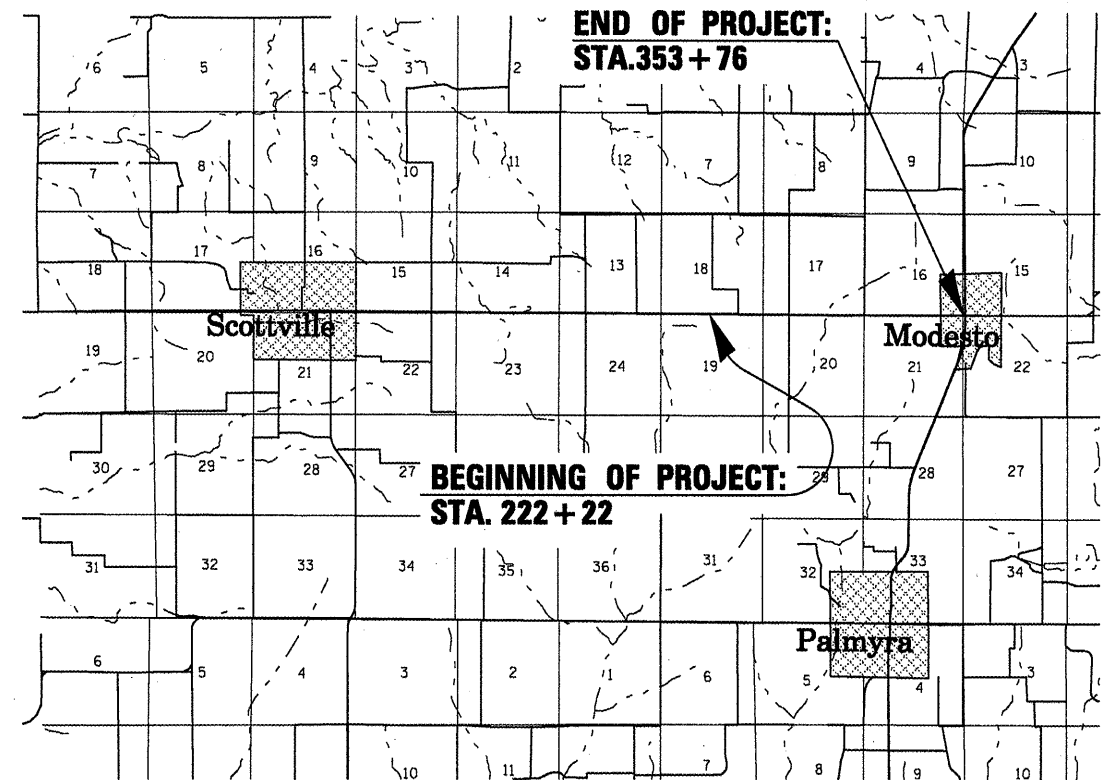

LOCATION MAP

GROSS LENGTH = 13,154 FT. = 2.491 MILES_S
NET LENGTH = 13,154 FT. = 2.491 MILES

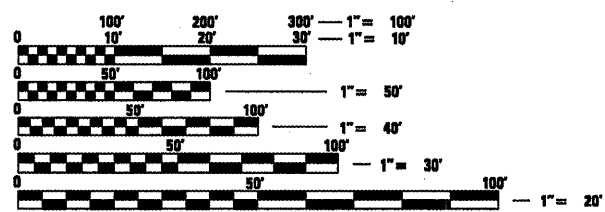
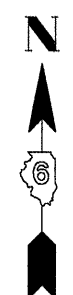

FULL SIZE PLANS HAVE BEEN PREPARED USING STANDARD ENGINEERING SCALES. REDUCED SIZED PLANS WILL NOT CONFORM TO STANDARD SCALES. IN MAKING MEASUREMENTS ON REDUCED PLANS, THE ABOVE SCALES MAY BE USED.

J.U.L.I.E.
JOINT UTILITY LOCATION INFORMATION FOR EXCAVATION
1-800-992-0123
OR 811

STATE OF ILLINOIS
DEPARTMENT OF TRANSPORTATION
DIVISION OF HIGHWAYS

SUBMITTED MAY 21 2009
Reg. E. Dumb
DEPUTY DIRECTOR OF HIGHWAYS, REGION ENGINEER

June 26 2009
Charles G. Ingersoll
ENGINEER OF DESIGN AND ENVIRONMENT

June 26 2009
Christine M. Reed
DIRECTOR OF HIGHWAYS, CHIEF ENGINEER

PRINTED BY THE AUTHORITY
OF THE STATE OF ILLINOIS

PROJECT ENGINEER: SAL MADONIA (217) 782-4761
SQUAD LEADER: MARCUS BRUCE (217) 524-0946

CONTRACT NO. 72C91