

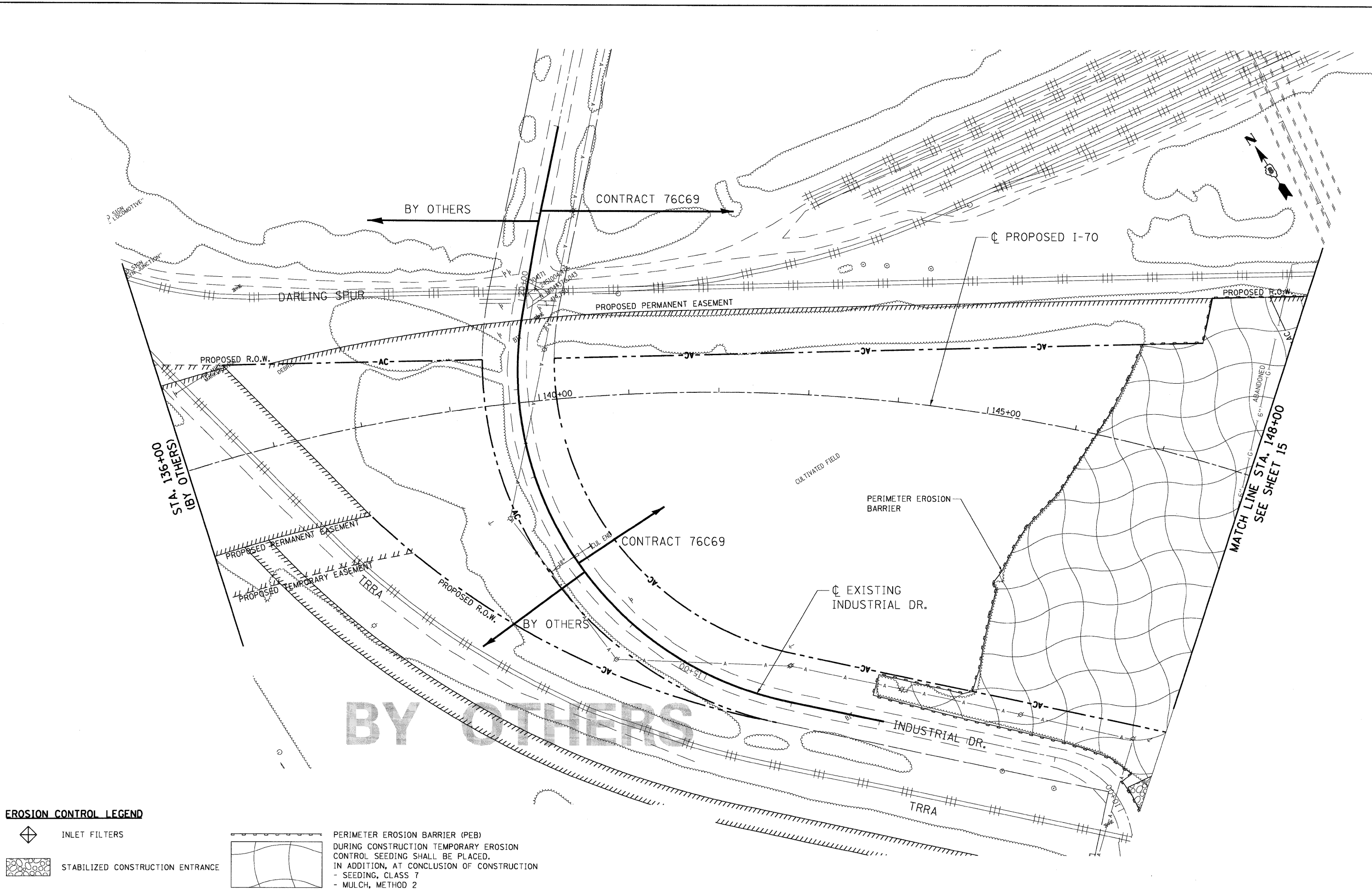

\ORCON\PROJECTS\LDON\136C69\DWG\136C69\_01\_I-70\_CON\_N\ORCON\_01\_LAYOUT.DWG, \ORCON\_01\_LAYOUT.DWG, \ORCON\_01\_LAYOUT.DWG, \ORCON\_01\_LAYOUT.DWG, \ORCON\_01\_LAYOUT.DWG, \ORCON\_01\_LAYOUT.DWG  
 5/12/2009 14:49:25 BONDPLD F:\001\2008\136C69\01\_COMMON\136C69\_01\_TEMP\TEMP.DWG, \ORCON\_01\_LAYOUT.DWG, \ORCON\_01\_LAYOUT.DWG, \ORCON\_01\_LAYOUT.DWG, \ORCON\_01\_LAYOUT.DWG



**EROSION CONTROL LEGEND**

-  INLET FILTERS
-  STABILIZED CONSTRUCTION ENTRANCE
-  PERIMETER EROSION BARRIER (PEB)  
 DURING CONSTRUCTION TEMPORARY EROSION CONTROL SEEDING SHALL BE PLACED.  
 IN ADDITION, AT CONCLUSION OF CONSTRUCTION  
 - SEEDING, CLASS 7  
 - MULCH, METHOD 2

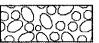
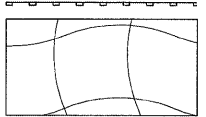
**TENG** TENG & ASSOCIATES, INC.  
 ENGINEERS/ARCHITECTS/PLANNERS  
 CHICAGO, ILLINOIS

FILE NAME =	USER NAME = \$USER\$	DESIGNED - JB	REVISED -
#FILE#		DRAWN - JB	REVISED -
	PLOT SCALE = \$SCALE\$	CHECKED - ACL	REVISED -
	PLOT DATE = \$DATE\$	DATE - 05/15/09	REVISED -

**STATE OF ILLINOIS**  
**DEPARTMENT OF TRANSPORTATION**  
 I-70 CONNECTION

<b>EROSION AND          SEDIMENT CONTROL PLAN</b> <b>STA. 136+00 TO STA. 148+00</b>			
SCALE: 1"=50'	SHEET NO. OF SHEETS	STA. TO STA.	

F.A.P. RTE.	SECTION	COUNTY	TOTAL SHEETS	SHEET NO.
998	82-IDM-2	ST. CLAIR	21	14
FED. ROAD DIST. NO.		ILLINOIS FED. AID PROJECT		

CONTRACT NO. 76C69